



Tuesday, April 15, 2025

LOCATION

Property Address642 N New St
Bethlehem, PA 18018-3904

Subdivision

CountyNorthampton County, PA

PROPERTY SUMMARY

Property TypeCommercial
Land UseMixed, Office & Apts
Improvement TypeResidential
Square Feet3459

GENERAL PARCEL INFORMATION

Parcel ID/Tax IDP6NE1D 4 50204
Alternate Parcel ID4762-03-8768-5980
MunicipalityBethlehem City
District/Ward
2020 Census Trct/Blk108/3
Assessor Roll Year2024

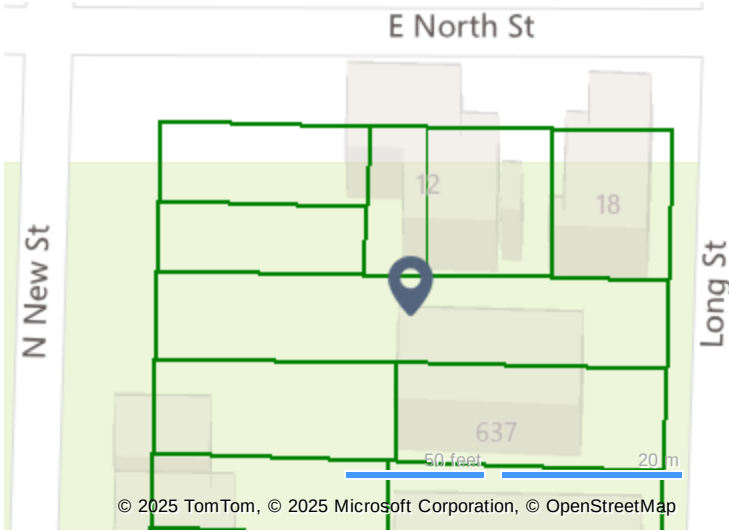

CURRENT OWNER

Name642 N New LLC
Mailing Address2663 Lynnwood Dr
Nazareth, PA 18064-8419

SCHOOL ZONE INFORMATION

Thomas Jefferson Elementary School0.5 mi
Elementary: Pre K to 5Distance
Northeast Middle School0.9 mi
Middle: 6 to 8Distance
Liberty High School0.5 mi
High: 9 to 12Distance

SALES HISTORY THROUGH 03/10/2025

Date	Amount	Buyer/Owners	Seller	Instrument	No. Parcels	Book/Page Or Document#
6/12/2020	\$1	642 N New LLC	Kish Joseph Jr	Warranty Deed		2020-1/127926 2020014729
7/25/2005	\$1	Kish Joseph Jr				2005-1/278283
10/16/2001	\$1	Kish Joseph Jr & Kathryn S				

TAX ASSESSMENT

Appraisal	Amount	Assessment	Amount	Jurisdiction	Rate
Appraisal Year	2024	Assessment Year	2024	City Of Bethlehem	19.64
Appraised Land	\$65,800	Assessed Land	\$32,900	County Of Northampton	10.8
Appraised Improvements	\$67,800	Assessed Improvements	\$33,900	Bethlehem Area School District	59.99
Total Tax Appraisal	\$133,600	Total Assessment	\$66,800		
		Exempt Amount			
		Exempt Reason			

TAXES

Tax Year	City Taxes	County Taxes	SSD Taxes	Total Taxes
2025	\$1,311.95	\$721.44	\$4,007.33	\$6,040.72

2024	\$1,311.95	\$721.44	\$4,007.33	\$6,040.72
2023	\$1,278.55	\$721.44	\$3,887.76	\$5,887.75
2022	\$1,278.55	\$721.44	\$3,904.46	\$5,904.45
2021	\$1,278.55	\$788.24	\$3,858.37	\$5,925.16
2020	\$1,217.10	\$788.24	\$3,752.16	\$5,757.49
2019	\$1,217.10	\$788.24	\$3,758.17	\$5,763.50
2018	\$1,172.34	\$788.24	\$3,738.80	\$5,699.38
2017	\$1,145.62	\$781.56	\$3,643.94	\$5,571.12
2016	\$1,145.62	\$788.24	\$3,507.67	\$5,441.53
2014	\$1,061.45	\$694.72	\$3,406.13	\$5,162.30

MORTGAGE HISTORY				
Date	Loan Amount	Borrower	Lender	Book/Page or Document#
06/12/2020	\$260,000	642 N New LLC	People First Federal Credit Union	2020-1/127931 2020014730

PROPERTY CHARACTERISTICS: BUILDING				
Building # 1				
Type	Residential	Condition		Units
Year Built	1900	Effective Year		Stories
BRs		Baths	F H	Rooms
Total Sq. Ft.		3,459		
Building Square Feet (Living Space)			Building Square Feet (Other)	
- CONSTRUCTION				
Quality		Roof Framing		
Shape		Roof Cover Deck		
Partitions		Cabinet Millwork		
Common Wall		Floor Finish		
Foundation		Interior Finish		
Floor System		Air Conditioning		
Exterior Wall		Heat Type		
Structural Framing		Bathroom Tile		
Fireplace		Plumbing Fixtures		
- OTHER				
Occupancy		Building Data Source		

PROPERTY CHARACTERISTICS: EXTRA FEATURES	
No extra features were found for this parcel.	

PROPERTY CHARACTERISTICS: LOT			
Land Use	Mixed, Office & Apts	Lot Dimensions	
Block/Lot		Lot Square Feet	6,369
Latitude/Longitude	40.623297°/-75.377906°	Acreage	0.146

PROPERTY CHARACTERISTICS: UTILITIES/AREA			
Gas Source	Public	Road Type	Paved/Sidewalk
Electric Source	Public	Topography	Level
Water Source	Public	District Trend	
Sewer Source	Public	School District	Bethlehem Area School District
Zoning Code *	Cb-Commercial Business		
Owner Type			

* Verify with Township

LEGAL DESCRIPTION

Subdivision	Plat Book/Page
Block/Lot	District/Ward
Description	Block: 4 /Lot: 5 /School District: 02-Bethlehem Area

FEMA FLOOD ZONES

Zone Code	Flood Risk	BFE	Description	FIRM Panel ID	FIRM Panel Eff. Date
X	Minimal		Area of minimal flood hazard, usually depicted on FIRMs as above the 500-year flood level.	42095C0307E	07/16/2014

© 2025 Courthouse Retrieval System, Inc. All Rights Reserved.
Information has not been verified and is not guaranteed. User should compare directly with county records.