

# 3193 FITZGERALD RD



*Industrial Space  
For Lease*

**+2,400**  
TOTAL AVAILABLE SF

**+600**  
OFFICE SF

**16'**  
CLEAR HEIGHT

Freestanding building  
with yard

Two (2) GL doors

Drive-thru capability

200 amp  
electrical services

Immediate occupancy

Competitive pricing

**PETER WINTERLING**  
916.730.7350  
peter.winterling@kidder.com  
LIC N° 00332375

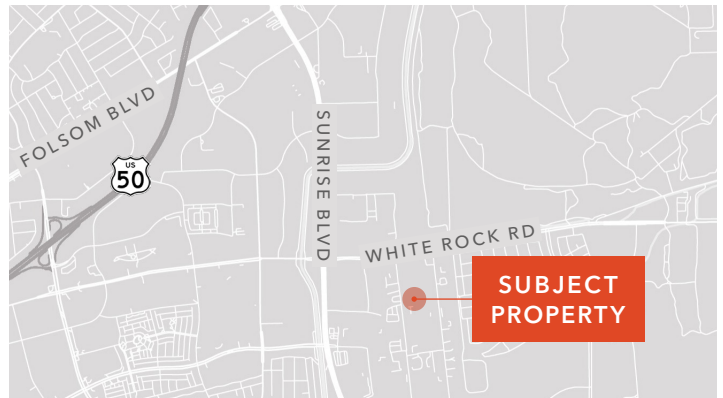

**KIDDER.COM**

This information supplied herein is from sources we deem reliable. It is provided without any representation, warranty, or guarantee, expressed or implied as to its accuracy. Prospective Buyer or Tenant should conduct an independent investigation and verification of all matters deemed to be material, including, but not limited to, statements of income and expenses. Consult your attorney, accountant, or other professional advisor.

# SITE PLAN

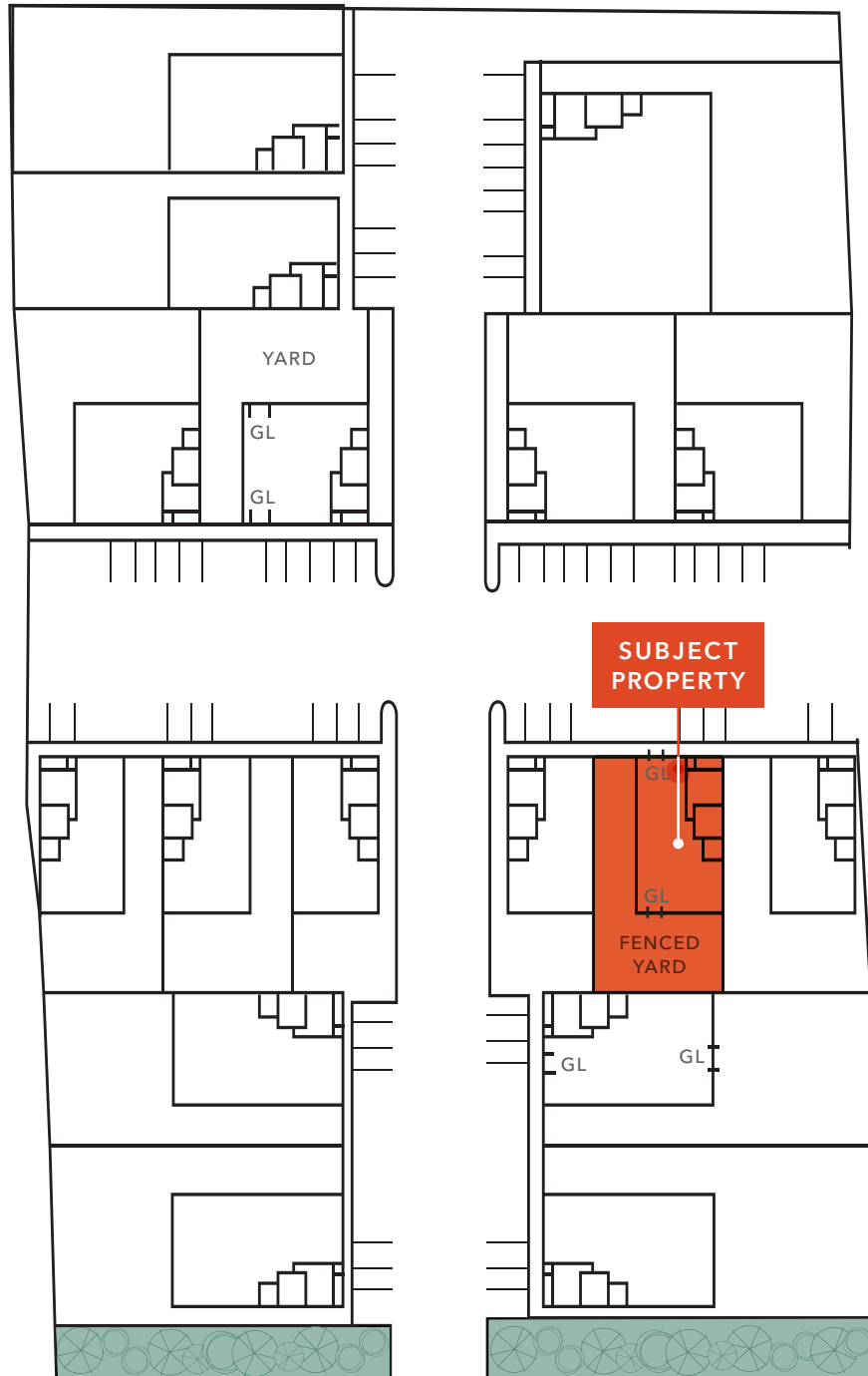

PETER WINTERLING 916.730.7350 | peter.winterling@kidder.com | LIC N° 00332375

[KIDDER.COM](http://KIDDER.COM)

This information supplied herein is from sources we deem reliable. It is provided without any representation, warranty, or guarantee, expressed or implied as to its accuracy. Prospective Buyer or Tenant should conduct an independent investigation and verification of all matters deemed to be material, including, but not limited to, statements of income and expenses. Consult your attorney, accountant, or other professional advisor.

