

VICINITY MAP
NTS

BUILDING DATA

PROPOSED BUILDING AREA:	213,585.00 SF.
OFFICE	810 SF.
MAINTENANCE	825 SF.
BUILDING 100	22,950 SF.
BUILDING 200	22,950 SF.
BUILDING 300	5,100 SF.
BUILDING 400	2,100 SF.
BUILDING 500	3,900 SF.
BUILDING 600	4,500 SF.
BUILDING 700	40,800 SF.
BUILDING 800	4,600 SF.
BUILDING 900	2,600 SF.
BUILDING 1000	47,500 SF.
BUILDING 1100	11,000 SF.
BUILDING 1200	19,800 SF.
BUILDING 1300	1,200 SF.

PROJECT DATA

PROPERTY OWNER:
SFI LAND LLC
1785 OAK ROAD
SNELLVILLE, GEORGIA 30078

DEVELOPER:
WOLLMOOR PROPERTIES, LLC
2220 GILLOWVILLE ROAD
ALBANY, GEORGIA 31707
ATTN: DUNCAN MOORE, JR.
229.349.3280

AUTHORIZED AGENT:
W&A ENGINEERING
2470 DANIELS BRIDGE RD. SUITE 161
ATHENS, GA 30606
706.310.0400

PHYSICAL ADDRESS: 505 OLYMPIC DRIVE
TAX PARCEL: 164 024H
GMD: 216 & 220
TOTAL PROJECT ACREAGE: 14.96 ACRES (### SF.)
CONTOUR INTERVAL: 2' FIELD RUN TOPO BY W&A ENGINEERING DATED MM/DD/YYYY.
BOUNDARY SURVEY: THIS DRAWING WAS PREPARED USING A W&A ENGINEERING TOPOGRAPHIC SURVEY FOR ----, DATED MM/DD/YYYY.
EXISTING ZONING: E-0 AND I
EXISTING USE: UNDEVELOPED
PROPOSED USE: SELF-STORAGE FACILITY
FLOOD PLAIN: A PORTION OF THIS PROPERTY LIES WITHIN THE FLOOD PLAIN ACCORDING TO FLOOD INSURANCE RATE MAP 13059C00260 DATED 4/2/2007.
THERE ARE STATE WATERS ONSITE, AND WITHIN 200' OF THE SITE.
THERE ARE WETLANDS DELINEATED ON SITE.
THIS PROPERTY DOES CONTAIN ENVIRONMENTAL AREAS AS DENOTED ON THE ATHENS-CLARKE COUNTY ENVIRONMENTAL MAP DATED 11/03/04.
WATER SUPPLY: ATHENS-CLARKE COUNTY PUBLIC UTILITIES DEPARTMENT
SEWAGE DISPOSAL: ATHENS-CLARKE COUNTY PUBLIC UTILITIES DEPARTMENT
SOLID WASTE: BY PRIVATE CONTRACT
UTILITIES: POWER, GAS, WATER, SEWER, TELEPHONE, CABLE TV
SITE DRAINAGE: CONCRETE CURB AND GUTTER AND COUNTY APPROVED PIPE WILL BE EMPLOYED TO COLLECT AND DIVERSIFY SURFACE WATER TO THE PROPOSED STORM WATER MANAGEMENT FACILITY.



W&A Engineering

CIVIL ENGINEERING • LANDSCAPE ARCHITECTURE
SURVEYING • SOIL AND ENVIRONMENTAL CONSULTING
TRAFFIC ENGINEERING • ECONOMIC DEVELOPMENT

2470 Daniels Bridge Road, Suite 161
Athens, GA 30606
P: (706) 310-0400 • F: (706) 310-0411
wengineering.com

ALL DRAWINGS SHALL REMAIN THE PROPERTY OF W&A ENGINEERING. THESE INSTRUMENTS OF SERVICE ARE TO BE USED SOLELY FOR THIS SPECIFIC PROJECT. W&A ENGINEERING SHALL RETAIN ALL LEGAL RIGHTS TO THE USE OF THE INSTRUMENTS OF SERVICE AND SHALL RETAIN FULL PROTECTION UNDER UNITED STATES COPYRIGHT LAW.

OLYMPIC DRIVE STORAGE
ATHENS-CLARKE COUNTY, GEORGIA
505 OLYMPIC DRIVE - 14.96 ACRES

DATE: 09.18.2018

REVISIONS

DATE	COMMENT

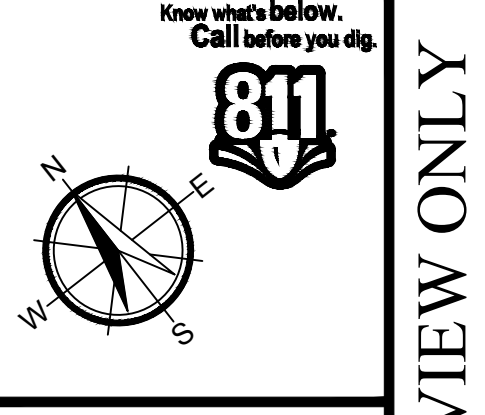

FOR REVIEW ONLY

18148

CONCEPT PLAN

CP08.0

SCALE 1" = 60'

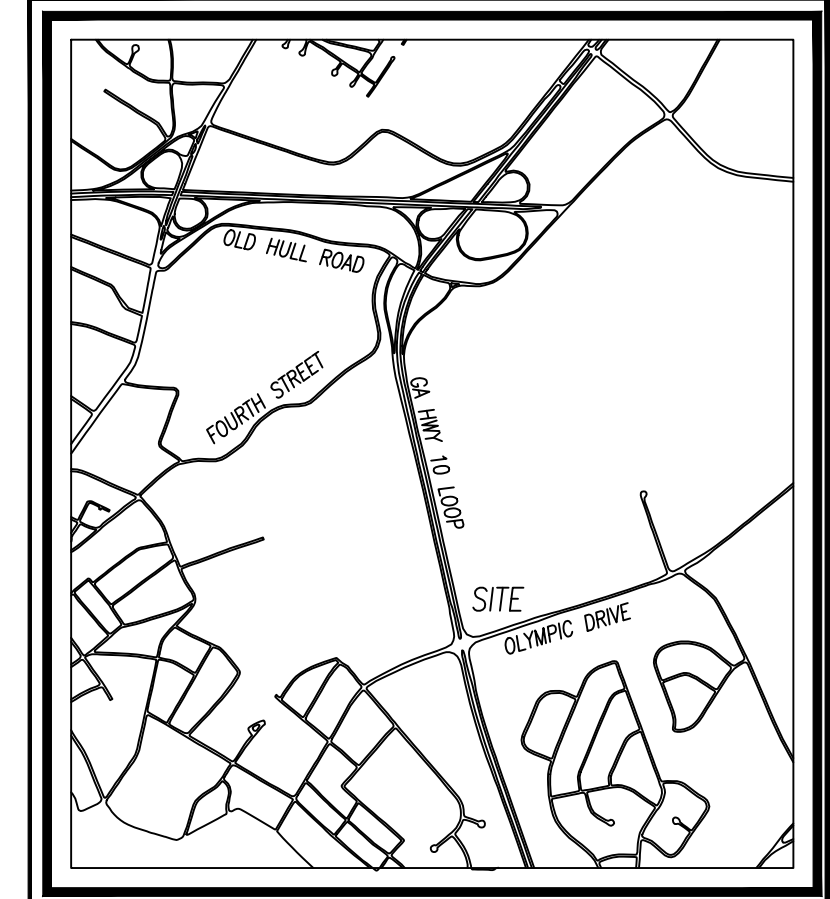
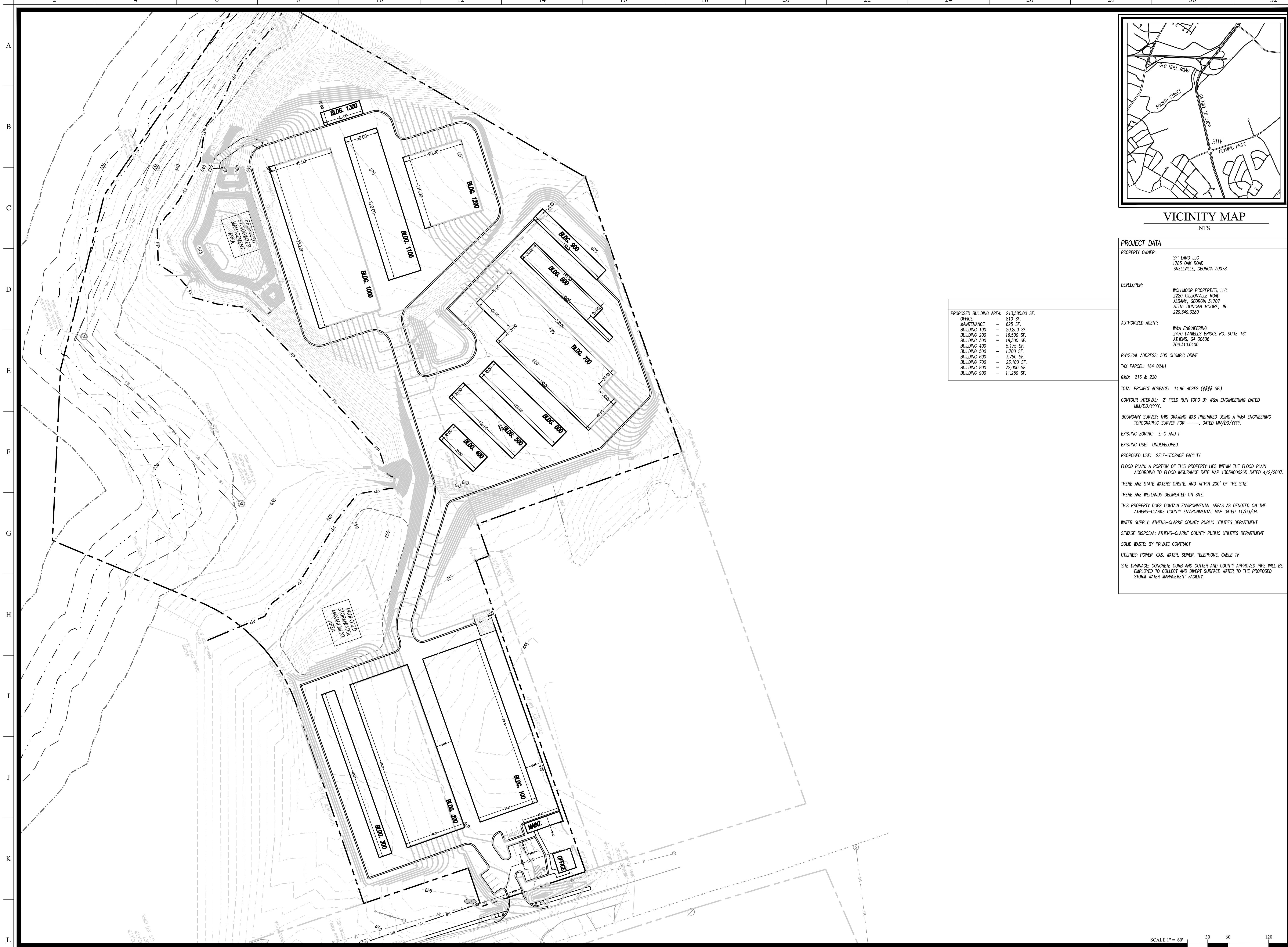

VICINITY MAP
NTS

PROPOSED BUILDING AREA:	213,585.00 SF.
OFFICE	810 SF.
MAINTENANCE	825 SF.
BUILDING 100	20,250 SF.
BUILDING 200	16,500 SF.
BUILDING 300	16,300 SF.
BUILDING 400	5,175 SF.
BUILDING 500	1,700 SF.
BUILDING 600	3,750 SF.
BUILDING 700	23,100 SF.
BUILDING 800	72,000 SF.
BUILDING 900	11,250 SF.

PROJECT DATA

PROPERTY OWNER: SFI LAND LLC
1785 OAK ROAD
SNELLVILLE, GEORGIA 30078

DEVELOPER: WOLLMOR PROPERTIES, LLC
2220 GILLOVILLE ROAD
ALBANY, GEORGIA 31707
ATTN: DUNCAN MOORE, JR.
229.349.3280

AUTHORIZED AGENT: W&A ENGINEERING
2470 DANIELS BRIDGE RD. SUITE 161
ATHENS, GA 30606
706.310.0400

PHYSICAL ADDRESS: 505 OLYMPIC DRIVE
TAX PARCEL: 164 024H
GMD: 216 & 220

TOTAL PROJECT ACREAGE: 14.96 ACRES (### SF.)
CONTOUR INTERVAL: 2' FIELD RUN TOPO BY W&A ENGINEERING DATED MM/DD/YYYY.

BOUNDARY SURVEY: THIS DRAWING WAS PREPARED USING A W&A ENGINEERING TOPOGRAPHIC SURVEY FOR ----, DATED MM/DD/YYYY.

EXISTING ZONING: E-0 AND I
EXISTING USE: UNDEVELOPED
PROPOSED USE: SELF-STORAGE FACILITY

FLOOD PLAIN: A PORTION OF THIS PROPERTY LIES WITHIN THE FLOOD PLAIN ACCORDING TO FLOOD INSURANCE RATE MAP 13059C00260 DATED 4/2/2007.

THERE ARE STATE WATERS ONSITE, AND WITHIN 200' OF THE SITE.
THERE ARE WETLANDS DELINEATED ON SITE.
THIS PROPERTY DOES CONTAIN ENVIRONMENTAL AREAS AS DENOTED ON THE ATHENS-CLARKE COUNTY ENVIRONMENTAL MAP DATED 11/03/04.

WATER SUPPLY: ATHENS-CLARKE COUNTY PUBLIC UTILITIES DEPARTMENT
SEWAGE DISPOSAL: ATHENS-CLARKE COUNTY PUBLIC UTILITIES DEPARTMENT
SOLID WASTE: BY PRIVATE CONTRACT
UTILITIES: POWER, GAS, WATER, SEWER, TELEPHONE, CABLE TV

SITE DRAINAGE: CONCRETE CURB AND GUTTER AND COUNTY APPROVED PIPE WILL BE EMPLOYED TO COLLECT AND DIVERSIFY SURFACE WATER TO THE PROPOSED STORM WATER MANAGEMENT FACILITY.



W&A Engineering

CIVIL ENGINEERING • LANDSCAPE ARCHITECTURE
SURVEYING • SOIL AND ENVIRONMENTAL CONSULTING
TRAFFIC ENGINEERING • ECONOMIC DEVELOPMENT

2470 Daniels Bridge Road, Suite 161
Athens, GA 30606
P: (706) 310-0400 • F: (706) 310-0411
wengineering.com

ALL DRAWINGS SHALL REMAIN THE PROPERTY OF W&A ENGINEERING. THESE INSTRUMENTS OF SERVICE ARE TO BE USED SOLELY FOR THIS SPECIFIC PROJECT. W&A ENGINEERING SHALL RETAIN ALL LEGAL RIGHTS TO THE USE OF THE INSTRUMENTS OF SERVICE AND SHALL RETAIN FULL PROTECTION UNDER UNITED STATES COPYRIGHT LAW.

OLYMPIC DRIVE STORAGE
ATHENS-CLARKE COUNTY, GEORGIA
505 OLYMPIC DRIVE - 14.96 ACRES

DATE: 07.30.2018

REVISIONS

DATE	COMMENT

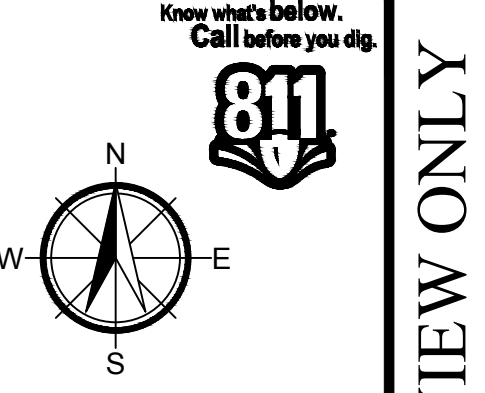

FOR REVIEW ONLY

18148

ROUGH GRADING

CP07.1

SCALE 1" = 60'