



# AVISON YOUNG

## Office Space For Sublease

15721 Park Row  
Floor 3 (Partial) | Floor 4 (Full)  
Houston, TX 77084

## Multiple floors available in Park Ten

- Size:  $\pm$  12,000 RSF on Floor 3
- Size: 24,831 RSF on Floor 4
- Quoted base rental rate: Negotiable
- Estimated operating expenses (2025): \$8.86/RSF
- Tenant improvement allowance: As-Is
- Term: Through December 31, 2029
- Furniture available



## Building amenities:



Onsite conference center



Indoor and outdoor tenant collaboration areas



Grab & Go kiosk

**Get more  
information**

**Josh Morrow**  
Principal  
+1 713 304 0393

[avisonyoung.com](https://avisonyoung.com)

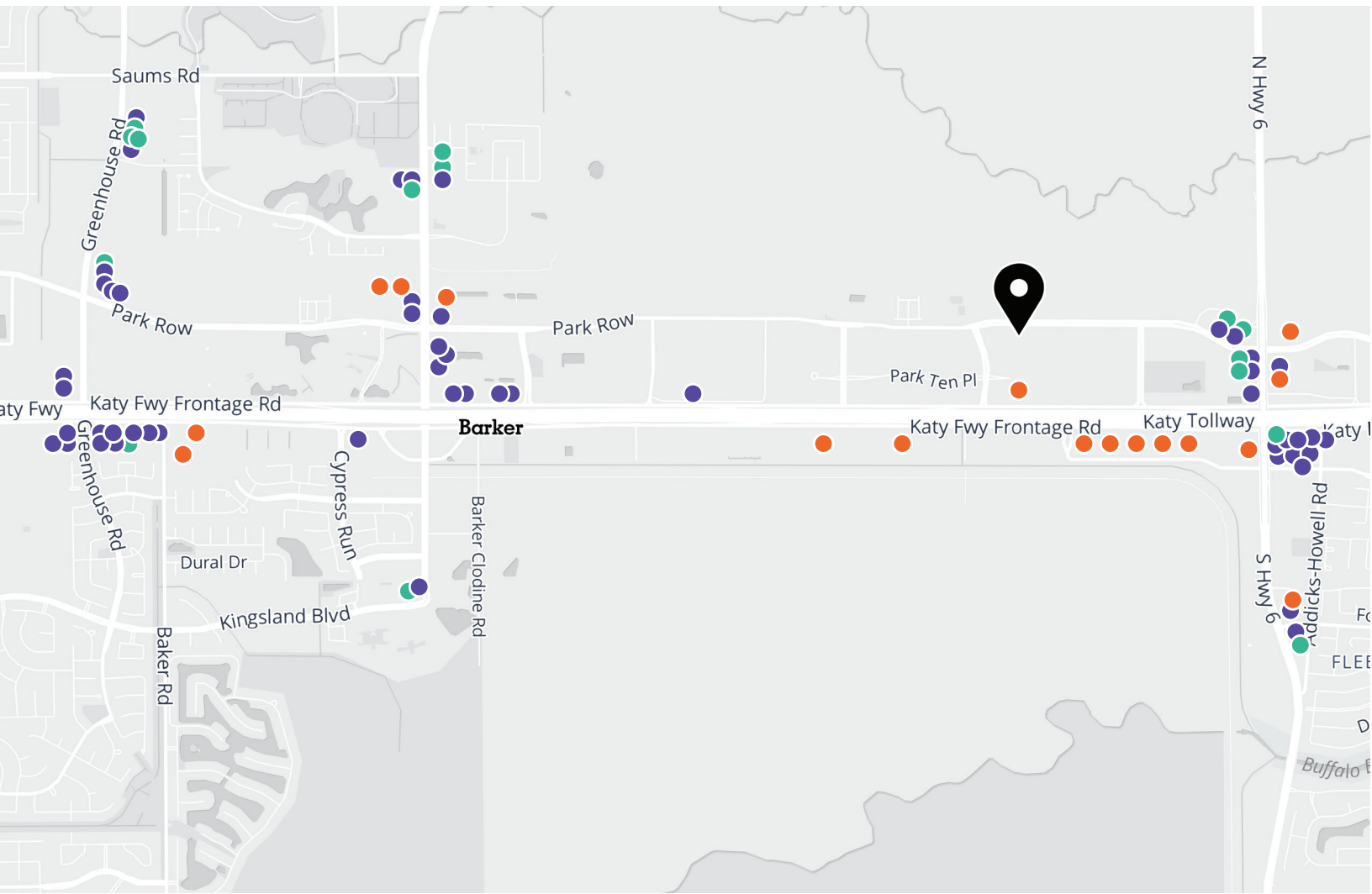

● RESTAURANT    ● RETAIL    ● HOTEL

<p><b>100+</b></p> <p>restaurant options</p>	<p><b>60+</b></p> <p>retail options</p>	<p><b>18</b></p> <p>lodging options</p>
--	---	---

Get more  
information

**Josh Morrow**  
Principal  
+1 713 304 0393

[avisonyoung.com](http://avisonyoung.com)

# Office Space For Sublease

15721 Park Row, Houston, TX 77084

## Floor 3

± 12,000 RSF

- 12 private offices
- 54 cubicles
- 3 conference rooms
- 2 huddle rooms/offices
- 1 breakroom



Get more  
information

**Josh Morrow**  
Principal  
+1 713 304 0393

[avisonyoung.com](http://avisonyoung.com)



## Floor 4 24,831 RSF

18 private offices  
142 cubicles  
4 conference rooms  
2 break rooms  
2 copy rooms

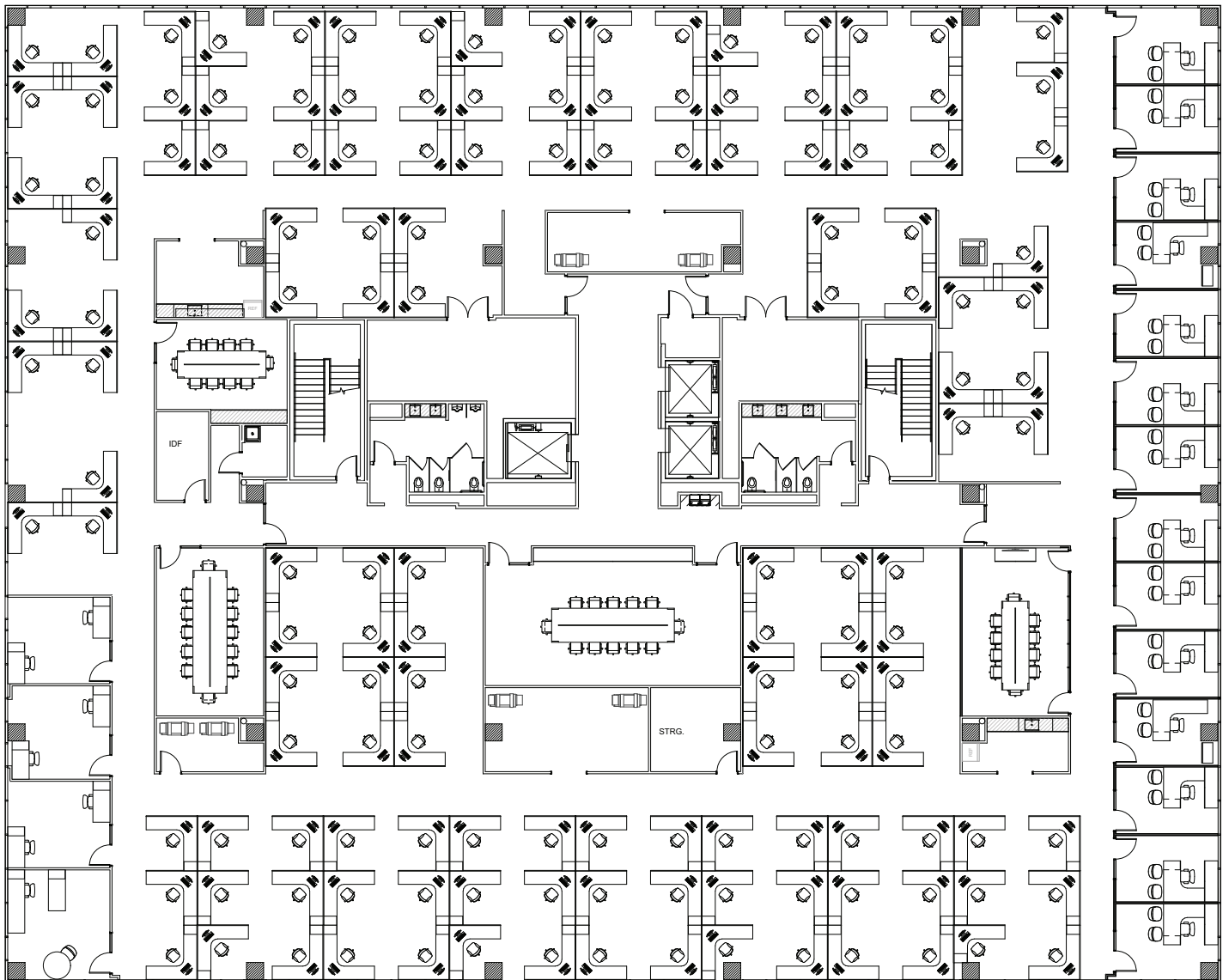

**Get more  
information**

**Josh Morrow**  
Principal  
+1 713 304 0393

[avisonyoung.com](http://avisonyoung.com)

## Office Space For Sublease

15721 Park Row, Houston, TX 77084



**Get more  
information**

**Josh Morrow**  
Principal  
+1 713 304 0393

[avisonyoung.com](http://avisonyoung.com)

© 2025 Avison Young - Texas, LLC. Information contained herein was obtained from sources deemed reliable and, while thought to be correct, have not been verified. Avison Young does not guarantee the accuracy or completeness of the information presented, nor assumes any responsibility or liability for any errors or omissions therein.