



CUSHMAN &  
WAKEFIELD



## OFFICE SPACE FOR LEASE

# MOUNTAIN VIEW CORPORATE CENTER I

756 EAST WINCHESTER / SALT LAKE CITY, UT

## *HIGH PROFILE, CLASS A PROPERTY*

- Excellent secured, underground parking
- High profile, Class A building
- Immediate access to I-215
- Close to restaurants, banks, business services and shopping
- I-215 visibility
- Abundant window lines provide for great natural light
- Great location with unmatched freeway visibility
- 2,353 RSF to 14,817 RSF Available
- **\$27.00/RSF, Full Service**

### CONTACT

**Dana Baird, CCIM**  
Executive Managing Director  
+1 801 303 5526  
dana.baird@cushwake.com

**Mike Richmond**  
Executive Managing Director  
+1 801 303 5434  
mike.richmond@cushwake.com

170 South Main Street, Suite 1600  
Salt Lake City, UT 84101  
+1 801 322 2000  
**cushmanwakefield.com**



# MOUNTAIN VIEW CORPORATE CENTER I

756 EAST WINCHESTER / SALT LAKE CITY, UT

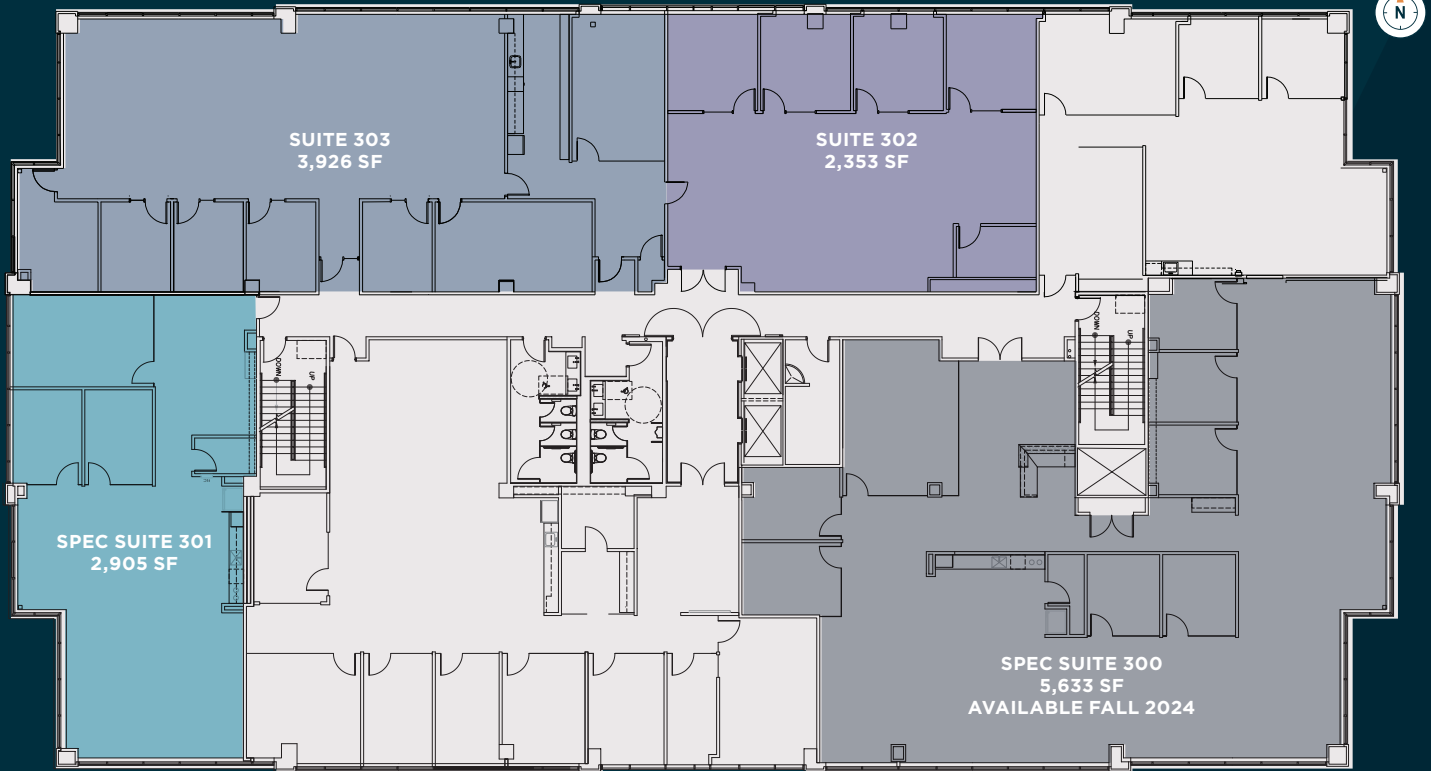

THIRD FLOOR



## CONTACT

**DANA BAIRD, CCIM**  
 Executive Managing Director  
 +1 801 303 5526  
 dana.baird@cushwake.com

**MIKE RICHMOND**  
 Executive Managing Director  
 +1 801 303 5434  
 mike.richmond@cushwake.com

