

Old Augusta Commerce Center



Building 3 | Effingham County

1301 Logistics Parkway, Savannah, GA



Building 3 | Property specifications

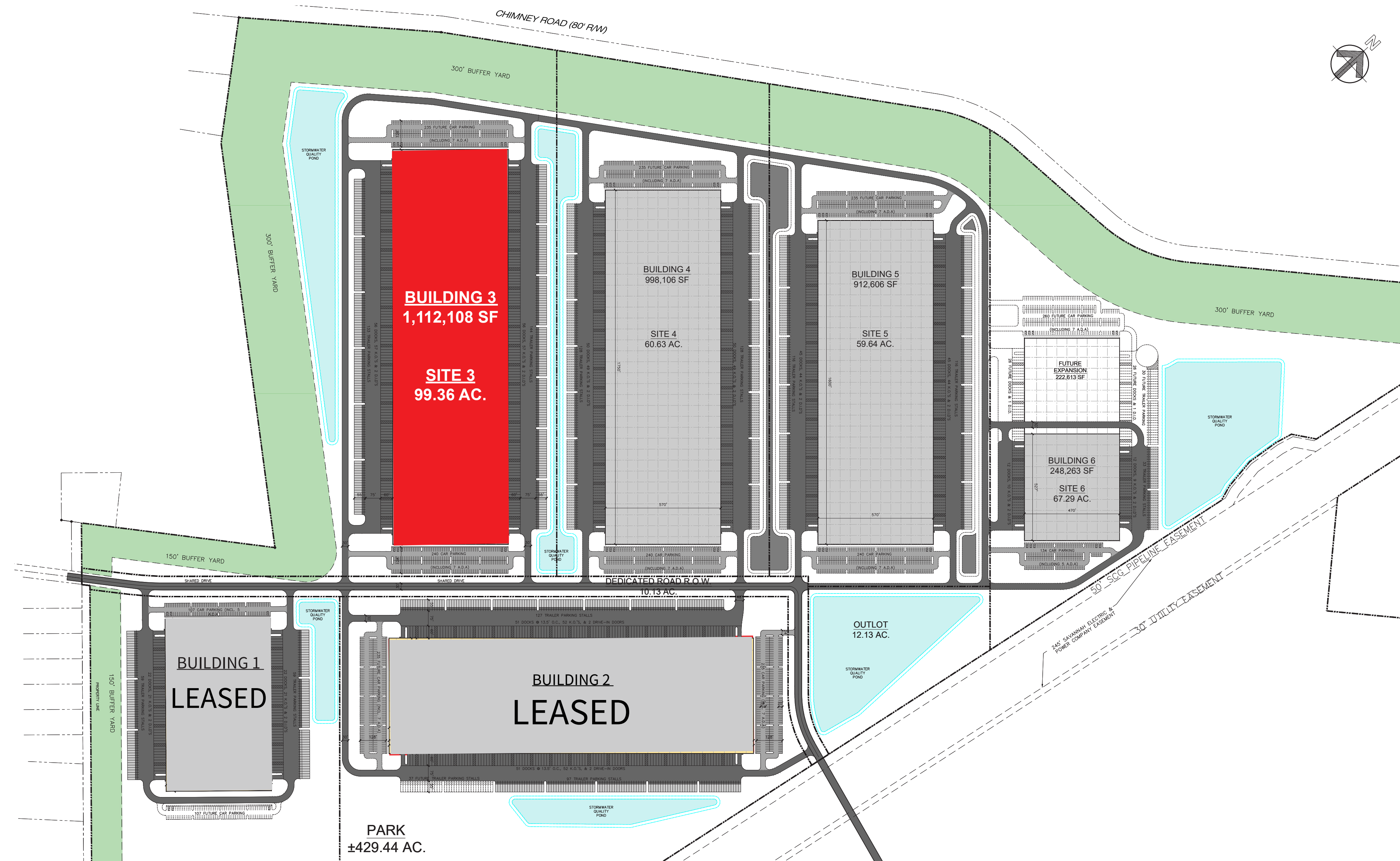

Building size	+/- 1,112,108
Available s.f.	+/- 1,112,108
Building dimensions	1950' x 570'
Column spacing	54' X 50'
Speed bay	60'
Truck court depth	190'
Clear height	40'
Trailer parks	277
Auto parks	240
Docks	226
Levelers	112 with 40,000 lb capacity
Drive in doors	4
Sprinkler	ESFR
Power	4,000 amps 480v 3 phase
Slab	7" unreinforced
Warehouse lighting	25 FC LEDs @ 36"
Office s.f.	2,012 spec
Warehouse finish	White box

Old Augusta Commerce Center

Building 3 Effingham County

1301 Logistics Parkway,
Savannah, GA





Old Augusta Commerce Center

Building 3 Effingham County

1301 Logistics Parkway,
Savannah, GA