

For Sale or Lease

CBRE

# Offices at North Penn

15266 Lleytons Court | Oklahoma City, Oklahoma 73134



**Amy Dunn, CCIM**  
First Vice President  
+1 405 209 3656  
amy.dunn@cbre.com

**Stuart Graham**  
Senior Vice President  
+1 405 607 6027  
stuart.graham@cbre.com



## 15266 Lleytons Court Now Available!

### Property Overview

Garden style office buildings are conveniently located just north of NW 150th Street and Pennsylvania Avenue. It offers a great location with close proximity to the Kilpatrick Turnpike and local restaurant venues. The garden office spaces feature premium finishes throughout.

Traffic Counts	
NW 150th	15,692 ADT
Pennsylvania Avenue	22,550 ADT

### Availability Details

- + (8) Garden Office Buildings  
- 2,500± SF, per building
- + Class 'A' Office Space
- + **Sale Price: \$689,000.00 per building**
- + **Lease Rate: \$21.00 PSF NNN**

2023 Demographics	1 Mile	3 Miles	5 Miles
Population	12,975	77,764	176,090
Households	6,097	32,945	74,396
Avg. Household Income	\$87,358	\$101,771	\$94,815
Daytime Employment	4,230	34,996	86,695



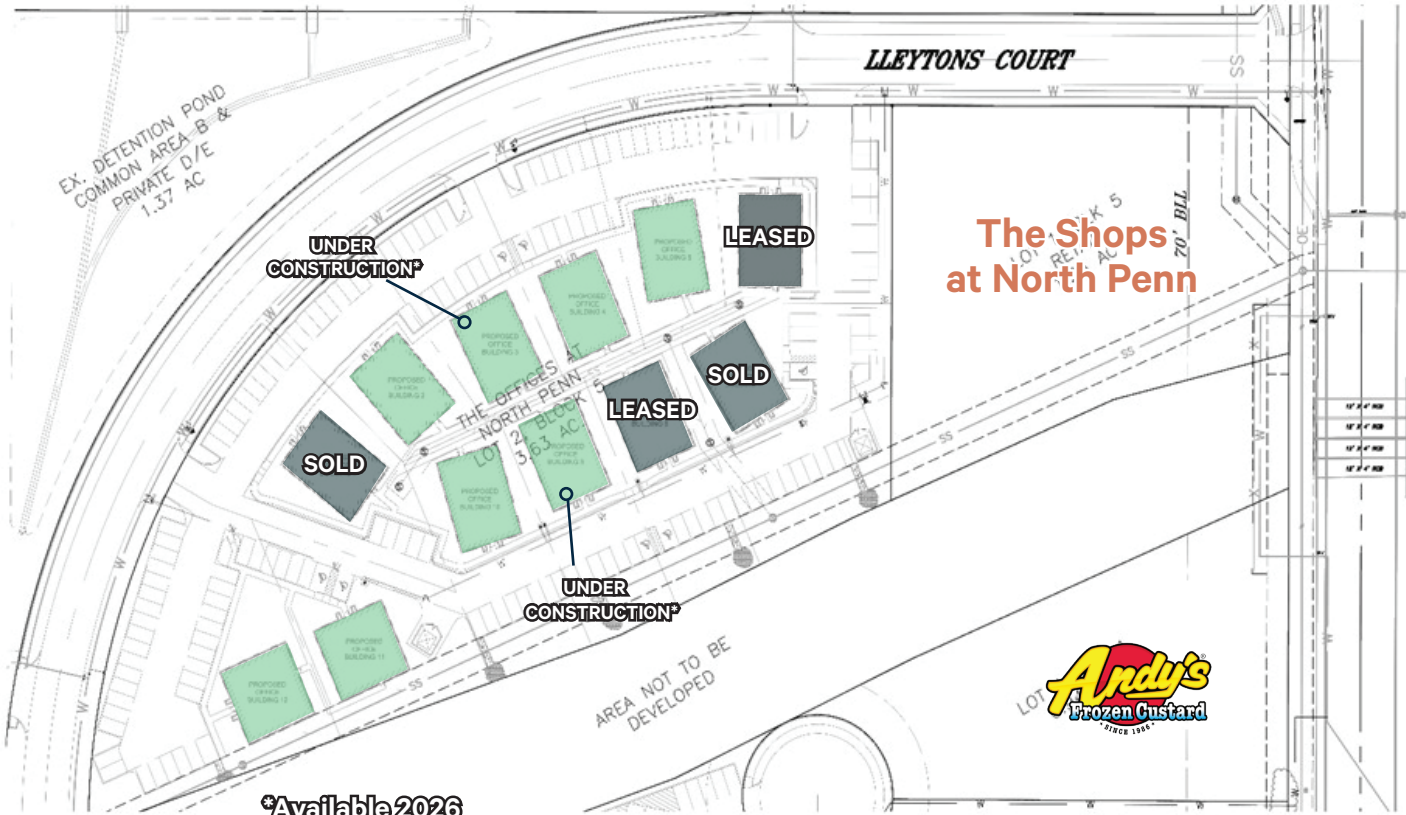

Asking Price:  
**\$689,000**

Lease Rate:  
**\$21.00 PSF NNN**

\*Available 2026

**Amy Dunn, CCIM**  
First Vice President  
+1 405 209 3656  
amy.dunn@cbre.com

**Stuart Graham**  
Senior Vice President  
+1 405 607 6027  
stuart.graham@cbre.com

