

501 S COLTRANE RD

EDMOND, OK 73034



PROPERTY DESCRIPTION

Located just South of 2nd and Coltrane this building is in a booming part of town. This property features approximately 14 covered parking spaces. Great local ownership.

LOCATION DESCRIPTION

Located on Coltrane Street just south of 2nd Street in Edmond. One mile west of I-35.

OFFERING SUMMARY

Suite B:	±1,489 RSF \$14.00 SF/yr with 3% annual increases
-----------------	---

Suite C:	±6,640 RSF \$14.00 SF/yr with 3% annual increases
-----------------	---

***Both suites can be leased together for a total of ±8,129 RSF**

Building Size:	±15,004 SF
-----------------------	------------

Tenant pays utilities.

Landlord pays taxes, insurance, water, landscape maintenance and repairs

TOM FIELDS

tfields@priceedwards.com

O: 405.239.1205

501 S COLTRANE RD

EDMOND, OK 73034

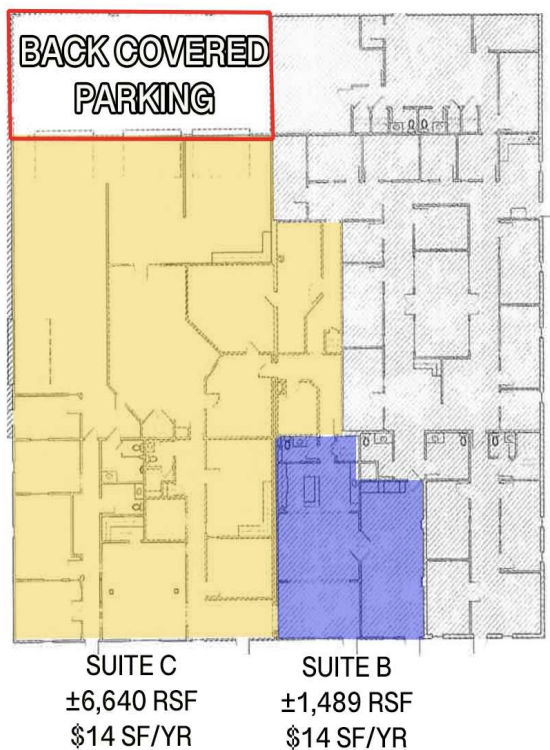

TOM FIELDS

tfields@priceedwards.com

O: 405.239.1205