

1817 N INDIANAPOLIS BOULEVARD

Whiting, Indiana



SECOND-GENERATION DRIVE THRU RESTAURANT



RETAIL OPPORTUNITY

1817 N INDIANAPOLIS BOULEVARD



Address

1817 N Indianapolis Blvd
Whiting, Indiana

Features

- Second-Generation Drive Thru in Whiting Indiana
- 30 surface-parking spaces
- Pylon Signage
- Within 2 miles of the Illinois border

Availability

+/- 2,860 SF

Area Retailers



Little Caesars



Demographics

	1 Miles	3 Mile	5 Miles
POPULATION	10,565	38,205	132,040
HOUSEHOLDS	4,493	14,138	49,830
AVG HOUSEHOLD INCOME	\$80,264	\$83,964	\$68,391
DAYTIME POPULATION	11,239	33,730	121,203

1817 N INDIANAPOLIS BOULEVARD

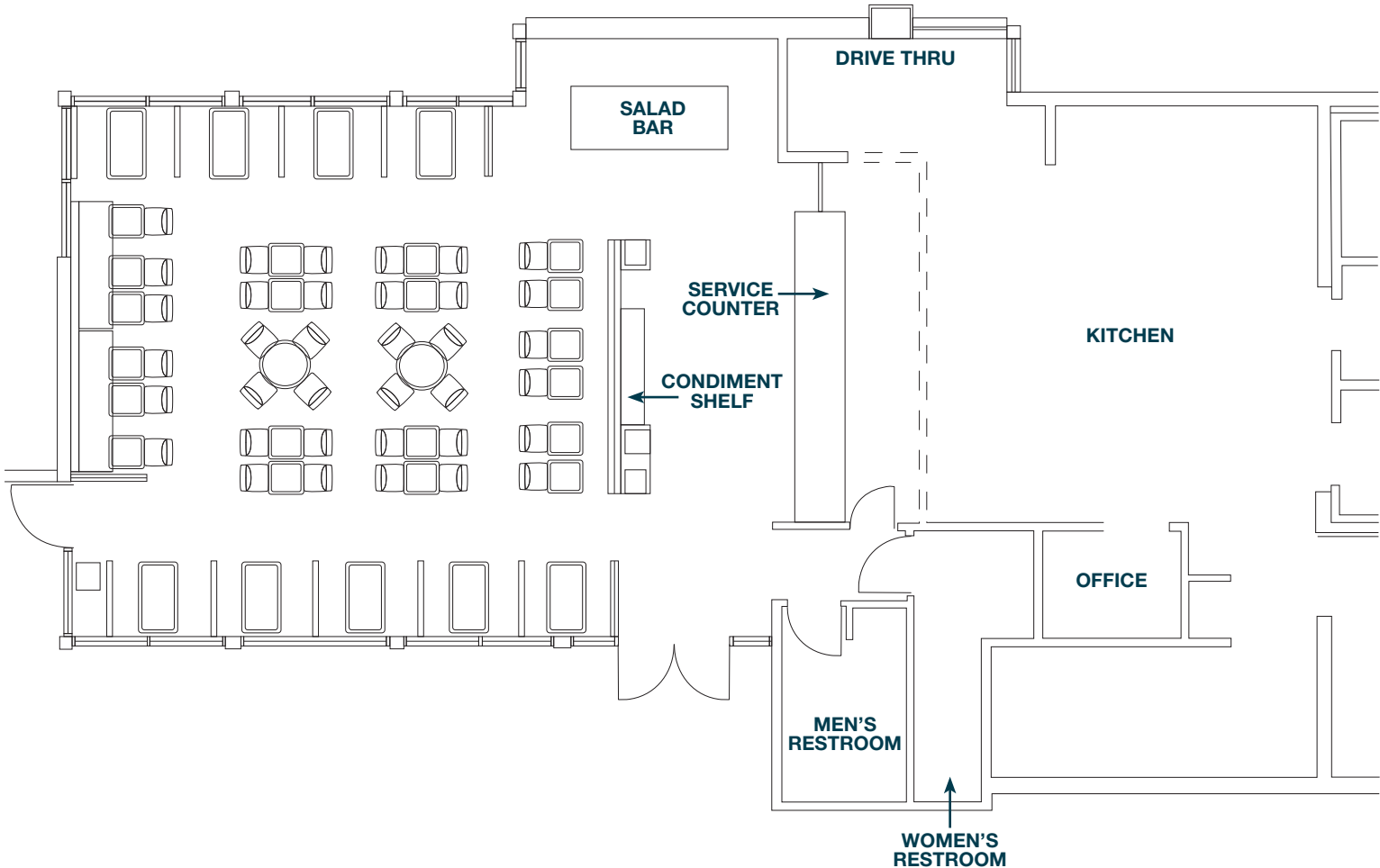

Available Spaces

+/- 2,860 SF



1817 N INDIANAPOLIS BOULEVARD



AREA MAP



1817 N INDIANAPOLIS BOULEVARD

Whiting, Indiana



Westin Kane

Mid-America Real
Estate Corporation
T: 630.954.7447
F: 630.954.7304
WKane@MidAmericaGrp.com

Ryan Hicks

Mid-America Real
Estate Corporation
T: 630.954.7326
F: 630.954.7302
RHicks@MidAmericaGrp.com

Rick Drogosz

Mid-America Real
Estate Corporation
T: 630.954.7339
RDrogosz@MidAmericaGrp.com



410 N. Michigan Avenue
Suite 1100
Chicago, Illinois 60611
630.954.7300
MidAmericaGrp.com