



  
**Lang Tree**  
*Lake Norman*

| NOW LEASING OFFICE SPACE |

Mooresville, NC

# BUILDING H1-4



105 Landings Drive | Mooresville, NC

## PROPERTY FACTS

- Waterfront mixed use development with regional draw
- Excellent access and visibility
- Located directly at new I-77 exit 31
- 90,000 vehicles per day on I-77
- Adjacent to multiple shopping and dining options
- Ample parking



## BUILDING FACTS

- 2 stories of office above retail
- Adjacent deck for parking
- Stairs and elevator available to access top floor
- Excellent signage opportunities with frontage on Langtree Rd.
- Significant TIA for credit tenants



# BUILDING H FLOORPLAN

SUITE	BUILDING H	SQ
201-202	AVAILABLE SOON	4,138 SF
203-206	AVAILABLE	8,044 SF
301	AVAILABLE	12,582 SF

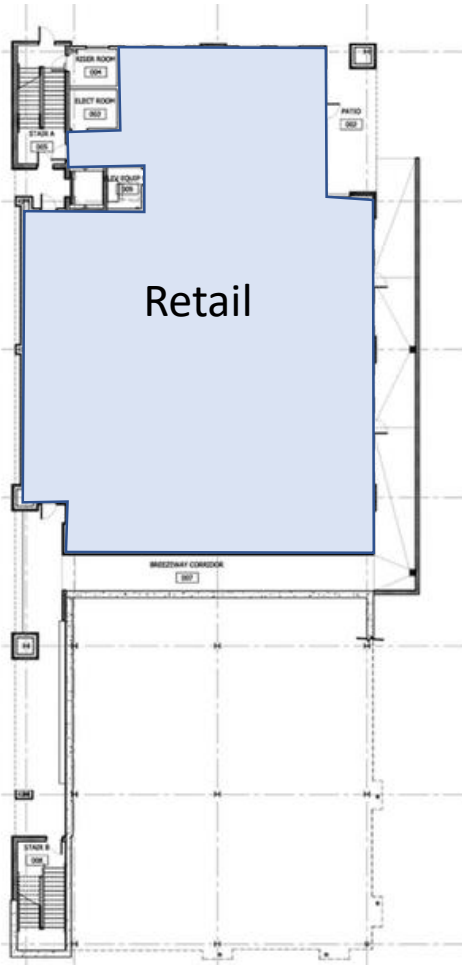

First Floor

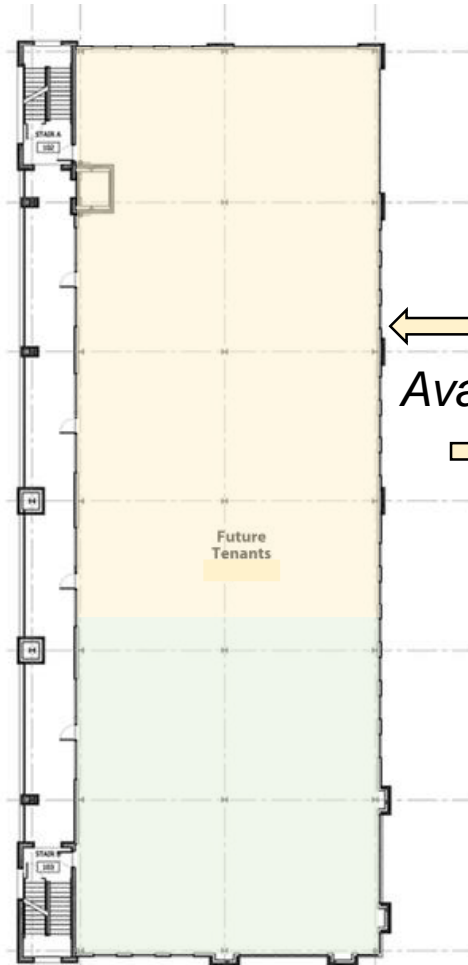

Second Floor



Third Floor

← Available →