

3129 W. Sunset Blvd

Retail | Restaurant
The Flat Iron





Overview.

3129 W Sunset Blvd presents a rare opportunity to take over a second-generation restaurant and bar space with a full liquor CUB on one of Silver Lake's main thoroughfares. The area is densely populated and offers exceptional walkability to a strong mix of dining, shopping, and service-oriented destinations.

Located within The FlatIron Building, the newest addition to Sunset Row, the property sits among a curated lineup of local favorites, emerging brands, trend-forward retailers, and notable culinary concepts—helping shape a highly social, pedestrian-friendly corridor in one of Los Angeles' most vibrant neighborhoods.

In addition to its restaurant and bar potential, this opportunity would also be ideal for an anchor retail operator seeking approximately 3,766 SF, or for two smaller retailers looking for spaces under 2,000 SF each.



3129
Sunset



Sunset — Row

The FlatIron building is the newest addition to Sunset Row, an expanding retail and dining destination, in Silver Lake. The property joins a great lineup of local shops, emerging brands, trend forward labels and culinary experiences into a walkable, social center on Sunset Blvd in one of LA's most vibrant neighborhoods.



Additional Ample Parking Access Located at:

- 3201 Sunset Blvd
- 3225 Sunset Blvd
- 3300 Sunset Blvd







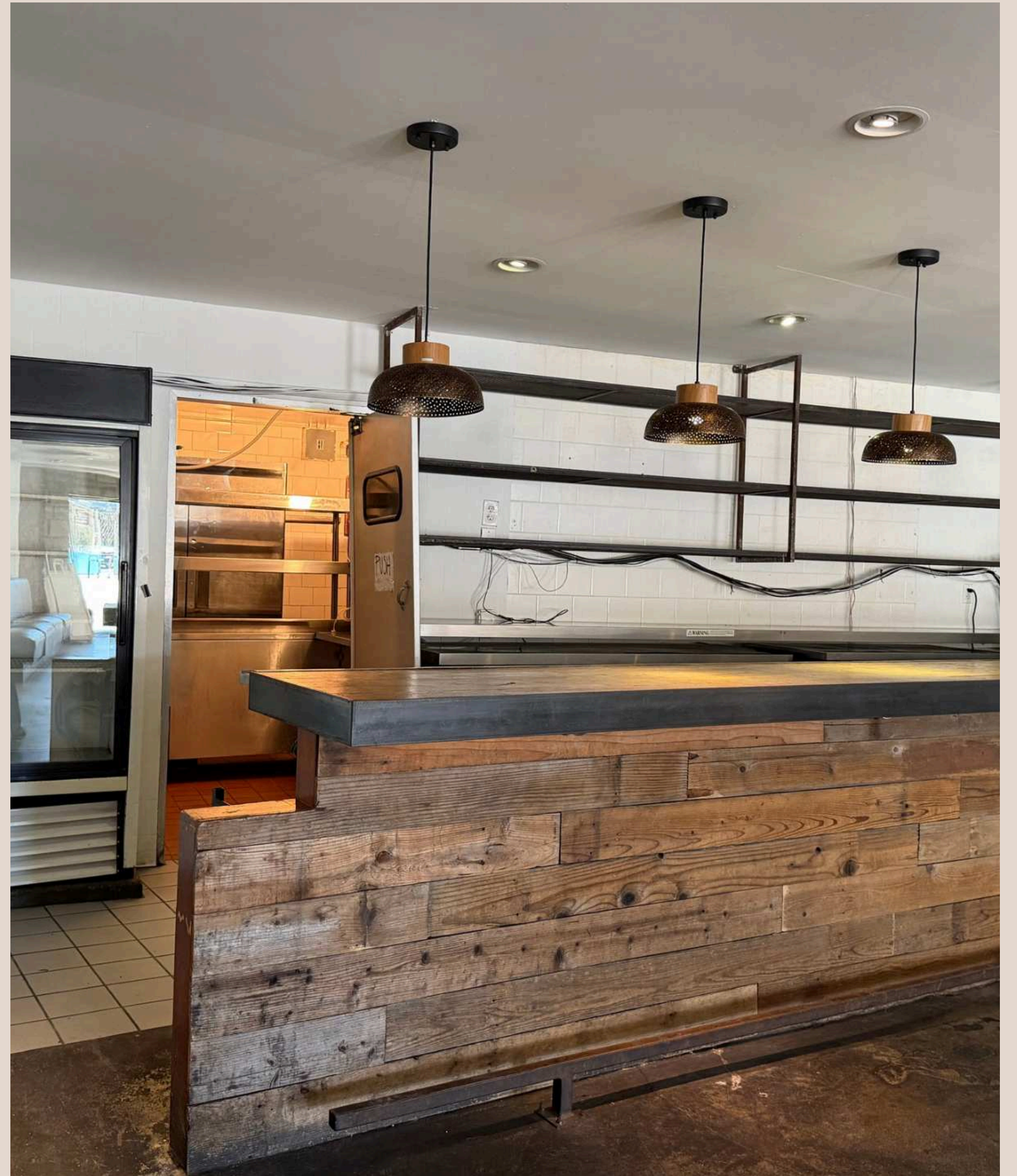

Specs.

This is more than a space, it's an opportunity to become the newest addition to Sunset Row, a curated collection of best-in-class retail, dining, and lifestyle experiences.

- 3,766 sf
- Type 47 liquor license available for purchase
- CUB for full liquor
 - Mon-Friday: 11am-11pm
 - Saturday: 9:30am-11pm
- Seating capacity: 88
- Fully equipped kitchen
- Two retail opportunities facing Sunset
- Parking available within the Sunset Row project

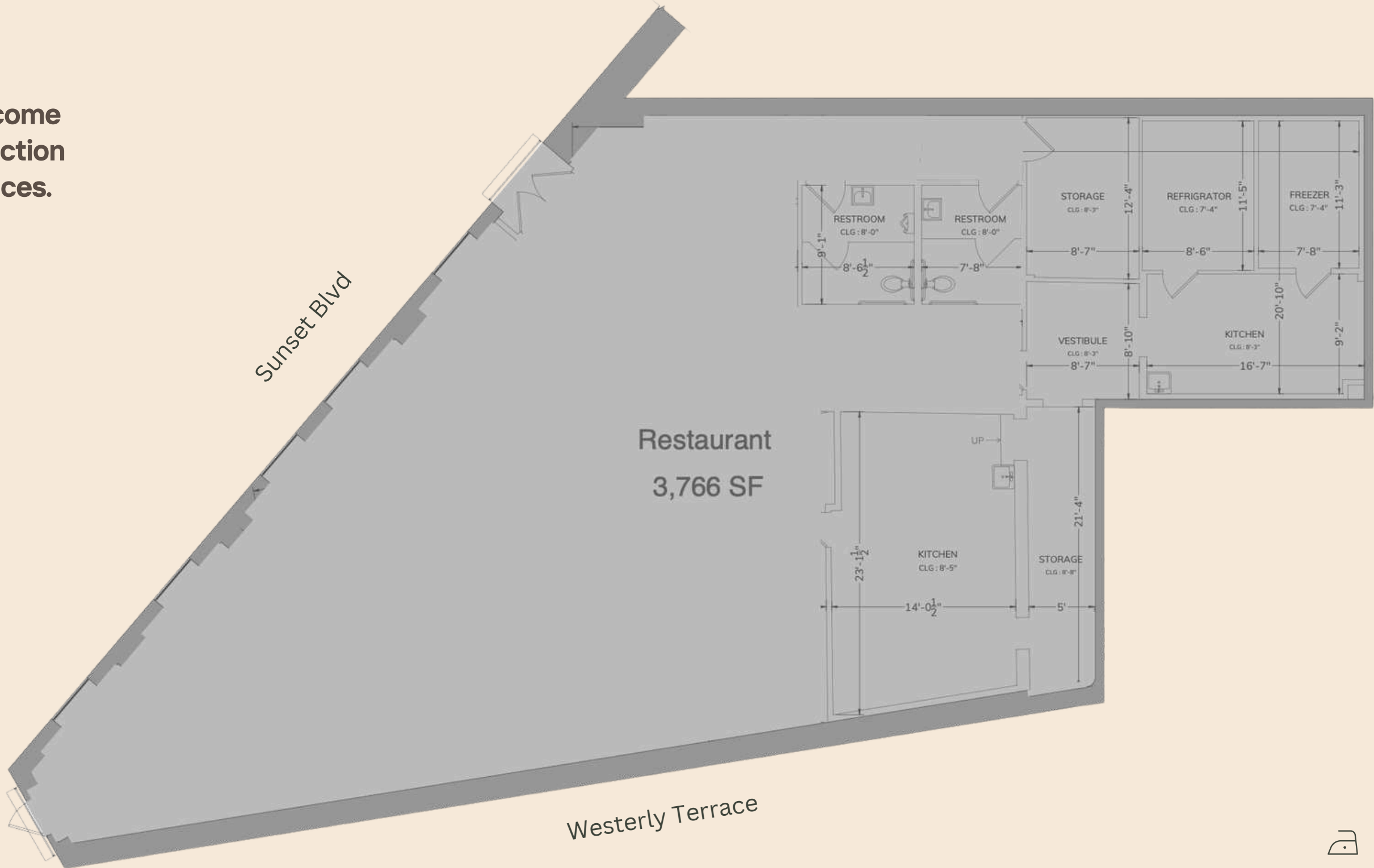

Demised.

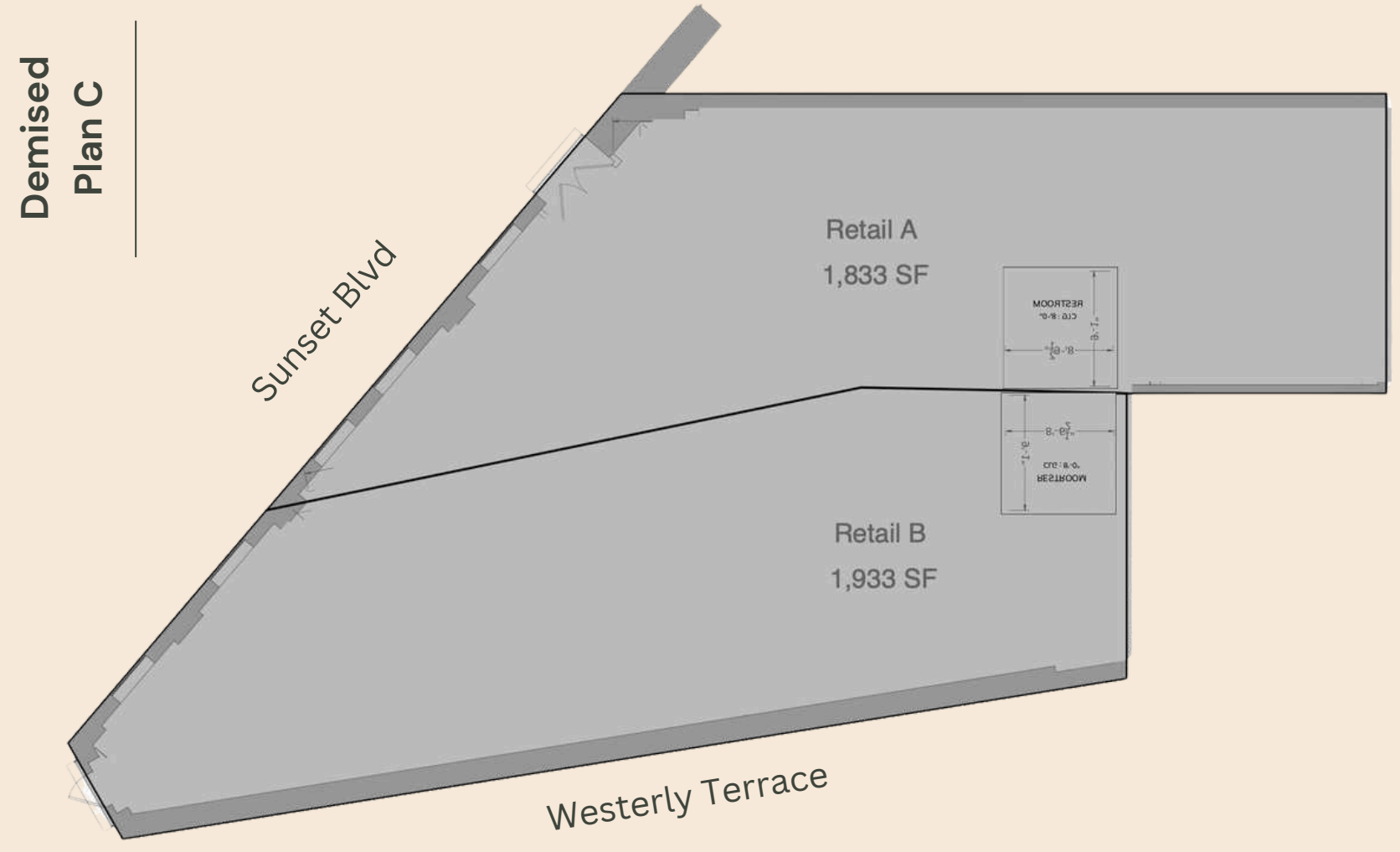
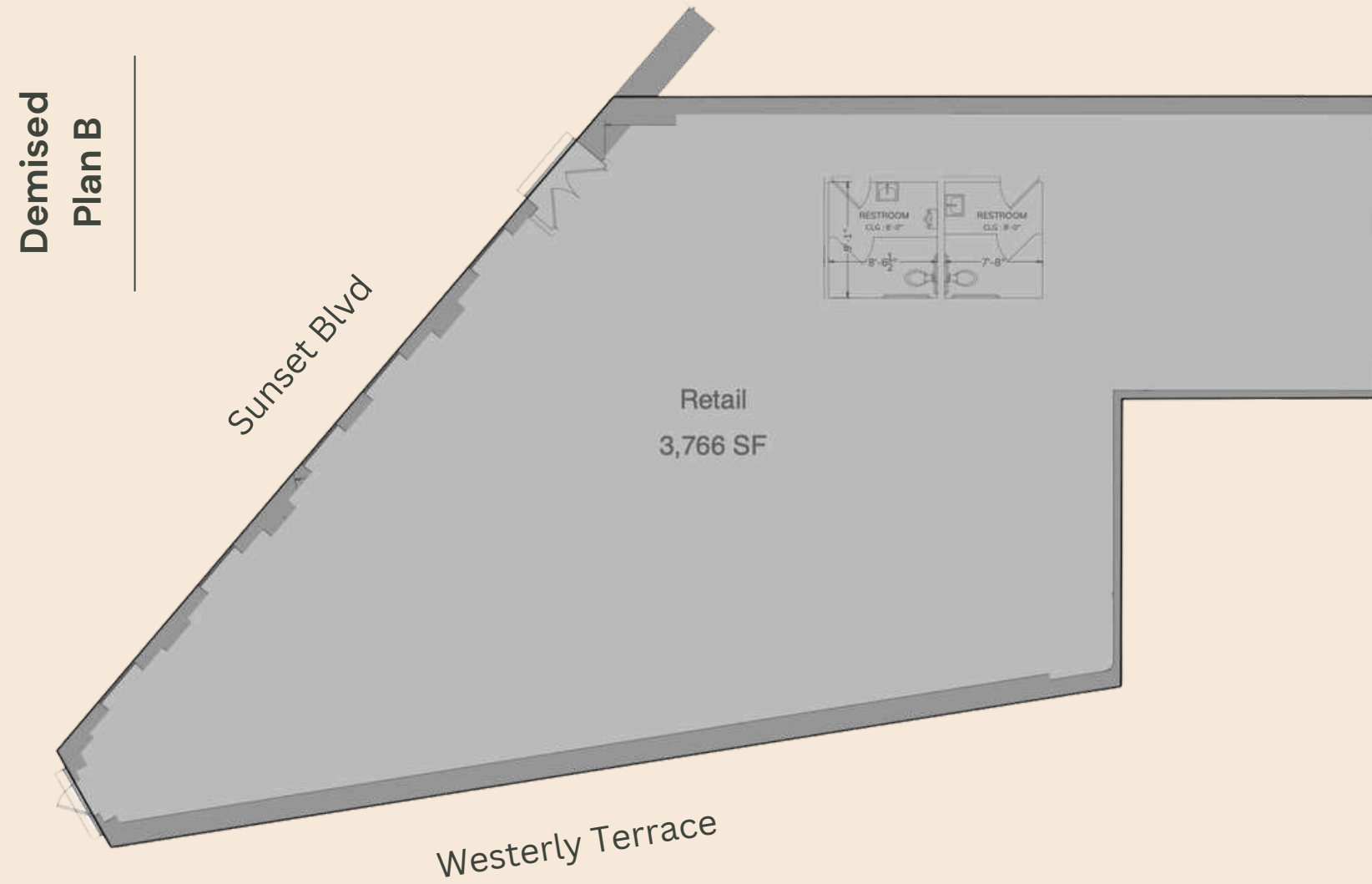

Plan B

3,776 SF on prime Sunset Blvd, the space offers exceptional visibility and signage opportunity, making it ideally suited for an anchor retail operator seeking a flagship location.

Plan C

Retail A offers approximately 1,833 SF and Retail B offers approximately 1,933 SF, presenting an excellent opportunity for a boutique retailer, ice cream operator, coffee concept, or other complementary neighborhood focused retail use.

Neighboring Tenants.

Silver Lake has long been a creative and artistic neighborhood drawing first-rate brands to the area including DS & DURGA, New Balance, Baggu, Malin + Goetz, Loquat, Heavy Handed, Dayglow, and many more.

**DS&D
URGA**

 **Dayglow**

A K I L A

BAGGU

new balance

3129
Sunset



Contact info

LORENA TOMB

213.277.7247 x 1

Lorena@urbanlimere.com

BRE# 01894475

JULIE CHAVEZ

213.277.7247 x 6

Julie@urbanlimere.com

BRE # 02053293

