

Downtown San Rafael Executive Office Space for Lease

1108 Fifth Avenue
San Rafael, CA

One space available
2,985± sf
Plentiful on-site parking

\$2.95 per Sq. Ft. per Month, Full Service



KEEGAN & COPPIN COMPANY, INC.
ONCOR INTERNATIONAL
Commercial Real Estate Services

Matthew Storms, Partner

CA License #: 01233478

101 Larkspur Landing Circle, Suite 112 • Larkspur, CA 94939

(415) 461-1010 ext. 123 • Fax (415) 925-2310

mstorms@keegancoppin.com

Suite 2A Floor Plan

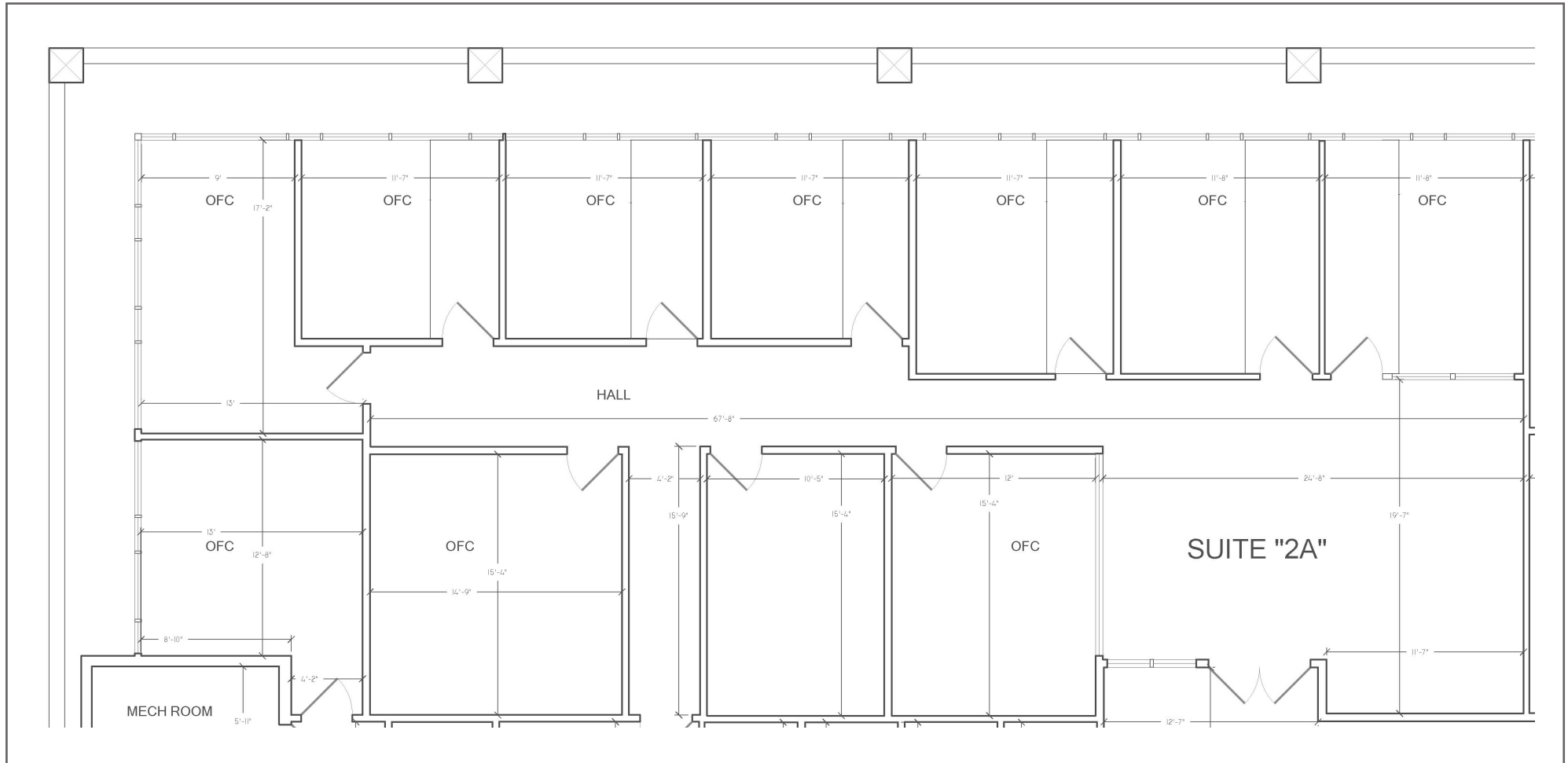

KEEGAN & COPPIN COMPANY, INC.
ONCOR INTERNATIONAL
Commercial Real Estate Services

Matthew Storms, Partner

CA License #: 01233478

101 Larkspur Landing Circle, Suite 112 • Larkspur, CA 94939

(415) 461-1010 ext. 123 • Fax (415) 925-2310

mstorms@keegancoppin.com

The above information, while not guaranteed, has been secured from sources we believe to be reliable. Submitted subject to error, change or withdrawal. An interested party should verify the status of the property and the information herein.

Property Information

User Space:	Office	Rentable Space:	2,985± SF
Address:	1108 Fifth Avenue San Rafael, CA 94901	Rent:	\$2.95 psf
Available Parking:	On-Site	Total Building sf:	20,606± SF
		Zoning:	5/M R/O

Description of Premises - Features:

The Westamerica Bank building in downtown San Rafael on the corner of Fifth Avenue at B Street. This three-story office building provides ample on-site parking and is elevator served.

SUITE	±SIZE	DESCRIPTION
2A	2,985± sf	10 Private Offices, Conference Room and Reception.

Lease Terms:

Five-year lease preferred. Full Service. Annual CPI increases. Base year for operating expenses.

Description of Location - Area:

Excellent location in downtown San Rafael, within walking distance to all amenities. Minutes to Highway 101.



KEEGAN & COPPIN COMPANY, INC.
ONCOR INTERNATIONAL
Commercial Real Estate Services

Matthew Storms, Partner

CA License #: 01233478

101 Larkspur Landing Circle, Suite 112 • Larkspur, CA 94939

(415) 461-1010 ext. 123 • Fax (415) 925-2310

mstorms@keegancoppin.com