

FOR LEASE: DOWNTOWN SPACE AVAILABLE

ReNew Wichita – Historic Retail & Office Opportunities

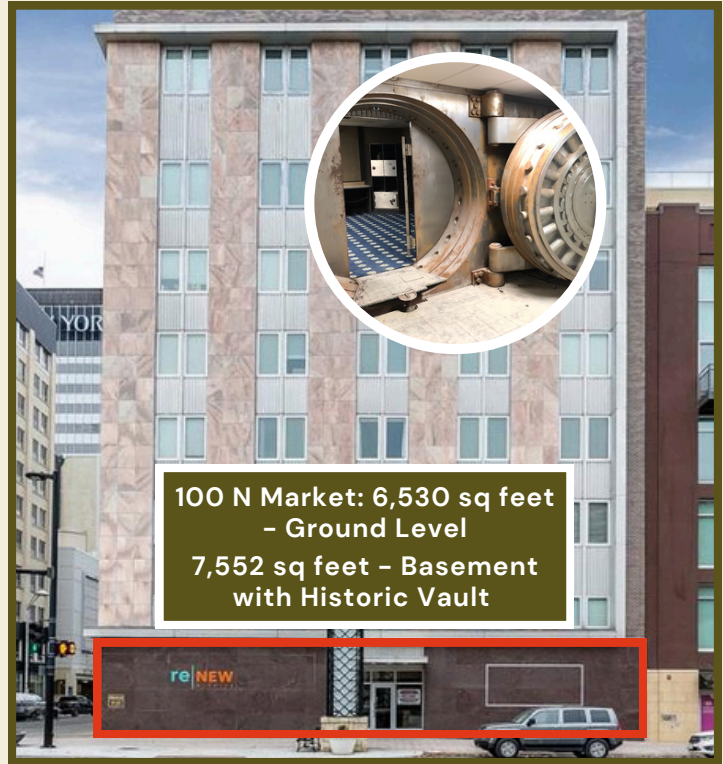
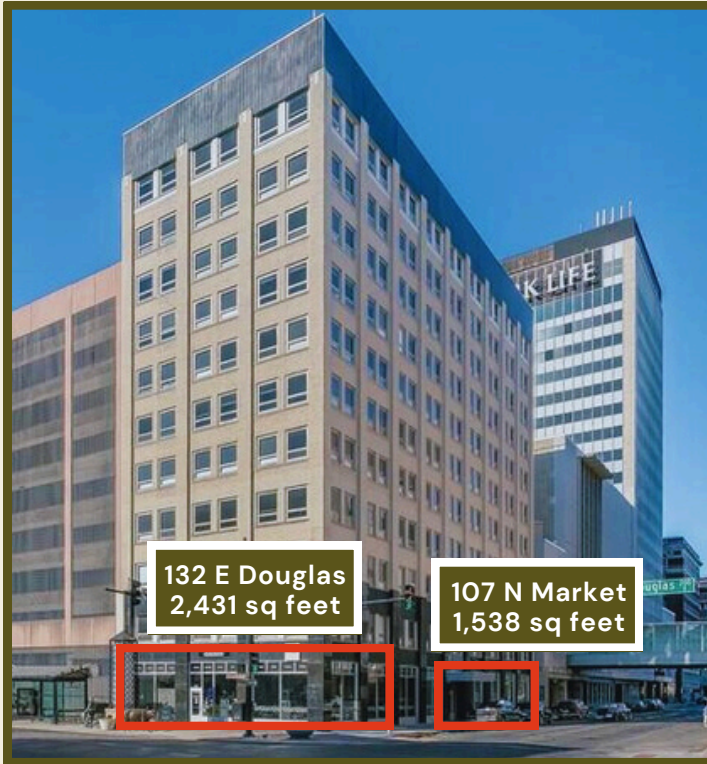

PROPERTY DETAILS

Lease Rate: \$16–\$18 per sq foot

Available Spaces:

- 100 N Market: 6,530 sq feet – historic bank with vault located in basement
- 100 N Market*: 7,552 sq feet – Basement Space
- 132 E Douglas: 2,431 sq feet
- 107 N Market: 1,538 sq feet

*Can be leased separately or together with main level

Stephanie Wise, President

316.461.9206

stephanie@commercialcollectivere.com

PROPERTY HIGHLIGHTS

Historic office or retail space available in the newly-renovated ReNew Wichita. Right in the heart of Downtown Wichita, this location offers 240 luxury apartments on the floors above, valet parking, and event space available to tenants on a first come, first serve basis. **Come join the luxury of ReNew and the vibrancy of Downtown Wichita!**

Bailey Vaughn

316.619.8731

bailey@commercialcollectivere.com

616 E 1st St N, Wichita, KS 67202

commercialcollectivere.com

FOR LEASE: DOWNTOWN SPACE AVAILABLE

ReNew Wichita – Historic Retail & Office Opportunities



EXCHANGE PLACE APARTMENTS

BITTING BUILDING
101 NORTH MARKET
WICHITA, KANSAS

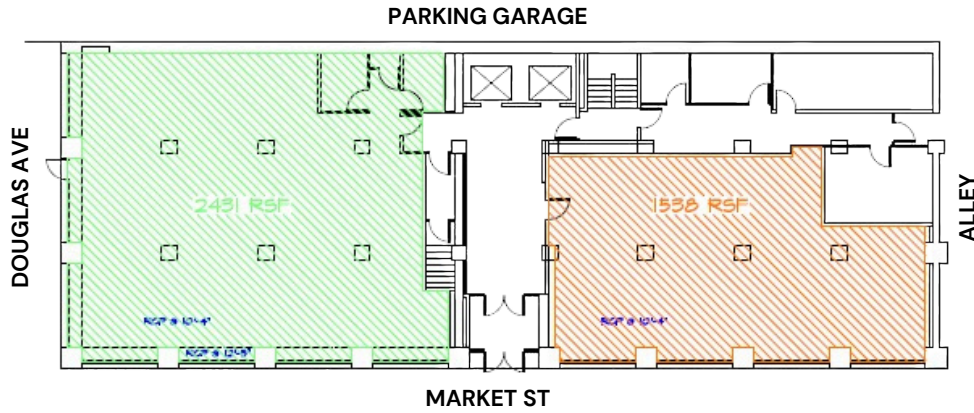

1ST FLOOR
3,969 RSF TOTAL



1ST FLOOR
7,040 RSF TOTAL

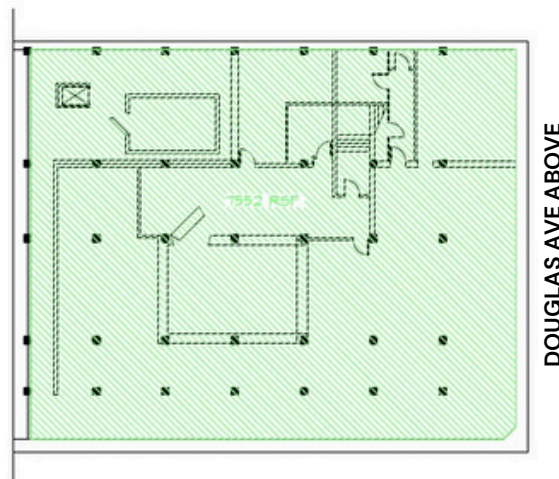

BASEMENT FLOOR
7,552 RSF TOTAL

FOR LEASE: DOWNTOWN SPACE AVAILABLE

ReNew Wichita – Historic Retail & Office Opportunities



AREA DEMOGRAPHICS

15,720

TRAFFIC
COUNT

103,858

POPULATION
(3 MILES)

92,738

TOTAL EMPLOYED
(3 MILES)

35

MEDIAN AGE
(3 MILES)

\$71,991

AVERAGE HH
INCOME (3 MILES)

616 E 1st St N, Wichita, KS 67202

commercialcollectivere.com