

# PEARL CITY PLAZA SITE PLAN

739 KAMEHAMEHA HWY.  
PEARL CITY, HI 96782

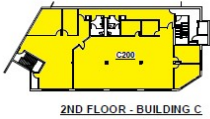

Contact AJ Hasan at (808)393-4720

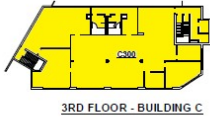

UNIT	TENANT NAME	SF
<b>BUILDING A</b>		
A101	MONEY MART	873 SF
A102	AVAILABLE	724 SF
A103	CORN ONOZ HAWAII	242 SF
A104	SALON D	375 SF
A105	HAWAIIAN HOLY SMOKES	852 SF
A205	ROLAND NISHIOKA DMD	1,222 SF
A206	AVAILABLE	603 SF
A207	KARL ERIC PHILLIPS	586 SF
A208	BLEND HOUSE STUDIO	1,009 SF
<b>BUILDING B</b>		
B90	Sally's	1,476 SF
B100	AVAILABLE	1,800 SF
B101	AVAILABLE	2,711 SF
B102	BROWS BY JEEYONCESLAY	1,397 SF
B102A	SMOKELESS HAWAII	408 SF
B103	THE GLAM BAR	903 SF
B104	KUMON	901 SF
B105	Bark Avenue Grooming Co, Dog Salon	905 SF
B106	BUTTON UP CAFE	1,962 SF
<b>BUILDING C</b>		
C100	Sally's	312 SF
C101	Sally's	2,802 SF
C104	Sally's	1,171 SF
C200	AVAILABLE	4,472 SF
C300	AVAILABLE	4,471 SF
<b>BUILDING W</b>		
W300		
AMG KUSTOMS		1,203 SF
OVERHANG		83 SF
		1,286 SF
W301		
HAWAII SURFBOARD BUILDERS		794 SF
HAWAII SURFBOARD BUILDERS (MEZZANINE)		307 SF
OVERHANG		55 SF
		1,156 SF
W303		
GT AUTO TECH		828 SF
GT AUTO TECH (MEZZANINE)		265 SF
OVERHANG		57 SF
		1,151 SF
W304		
TINT GARAGE		2,375 SF
TINT GARAGE (MEZZANINE)		338 SF
OVERHANG		118 SF
		2,831 SF
W305A		
HAWAII CUSTOM CARS		1,048 SF
HAWAII CUSTOM CARS (MEZZANINE)		338 SF
OVERHANG		57 SF
		1,441 SF
W305B		
VACANT		1,110 SF

1. This exhibit is diagrammatic. It is intended only for the purpose of indicating the location of the demised premise within the project. It does not purport to show the exact or final location of columns, walls, stairways or other Architectural, Structural, Mechanical, or Electrical elements. The landlord reserves the right to eliminate, to add and to make changes to the sizes and/or locations of such elements as may be required from time to time.  
2. The tenant, the Tenant's Architect & the Tenant's contractor have complete and total responsibility to verify all conditions and dimensions, and all utility connection points, in the field before starting any design, documentation & construction work.