

**For Lease: 6,160 S.F. Industrial Garage/Warehouse  
Units 4 & 5  
1420 & 1426 W. 38<sup>th</sup> Street, Chicago, IL 60609**



- Site Size:** Part of larger multi-tenant building.
- Office:** 922 s.f. (14.9%). West – 714 s.f. private, general office or lunchroom (counter, cabinets, Sink), 2 restrooms, central HVAC, mechanical room w/janitorial sink, epoxy floors. East – 208 s.f. private with electric heat/air conditioning, epoxy floor.
- Loading:** Five (5) 12' x 14' drive-in doors w/electric openers.
- Storage Lofts-Free Extra 1,354 Square Footage:**  
Both lofts have concrete floors with 125 p.s.f. floor load.  
West—714 s.f. access by forklift and metal staircase with landing.  
East—640 s.f. access by forklift only; no stairs.
- Ceiling Height:** 15' clear
- Power:** 400 amp—240 volt, 3-phase (two-200 amp services)
- Parking:** 17 cars in fenced, paved and secured lot that is locked each night.
- Lease Rate/Price:** \$7,000 month (\$13.64 s.f.) modified gross.
- Comments:** Trench type floor drains with triple basin sewer system; good natural light with 8 skylights and 6-3' x 3' high located wall windows; 1 ceiling air exhaust fan, 2 wall mount exhaust fans with louvered air intake vents; 3 natural gas fired unit heaters (shop) with 4 ceiling fans; extensive airline distribution; 400 watt metal halide lighting; locking security gates at each drive-in door for fresh air; T-8 fluorescent lighting; Comcast and AT&T internet available.

**For Lease: 6,160 S.F. Total**  
 1420 W. 38th Street, Chicago, IL 60609  
 Unit 5—3,080 S.F.  
 1426 W. 38th Street, Chicago, IL 60609  
 Unit 4—3,080 S.F.

NOTE: THIS DRAWING NOT TO SCALE.

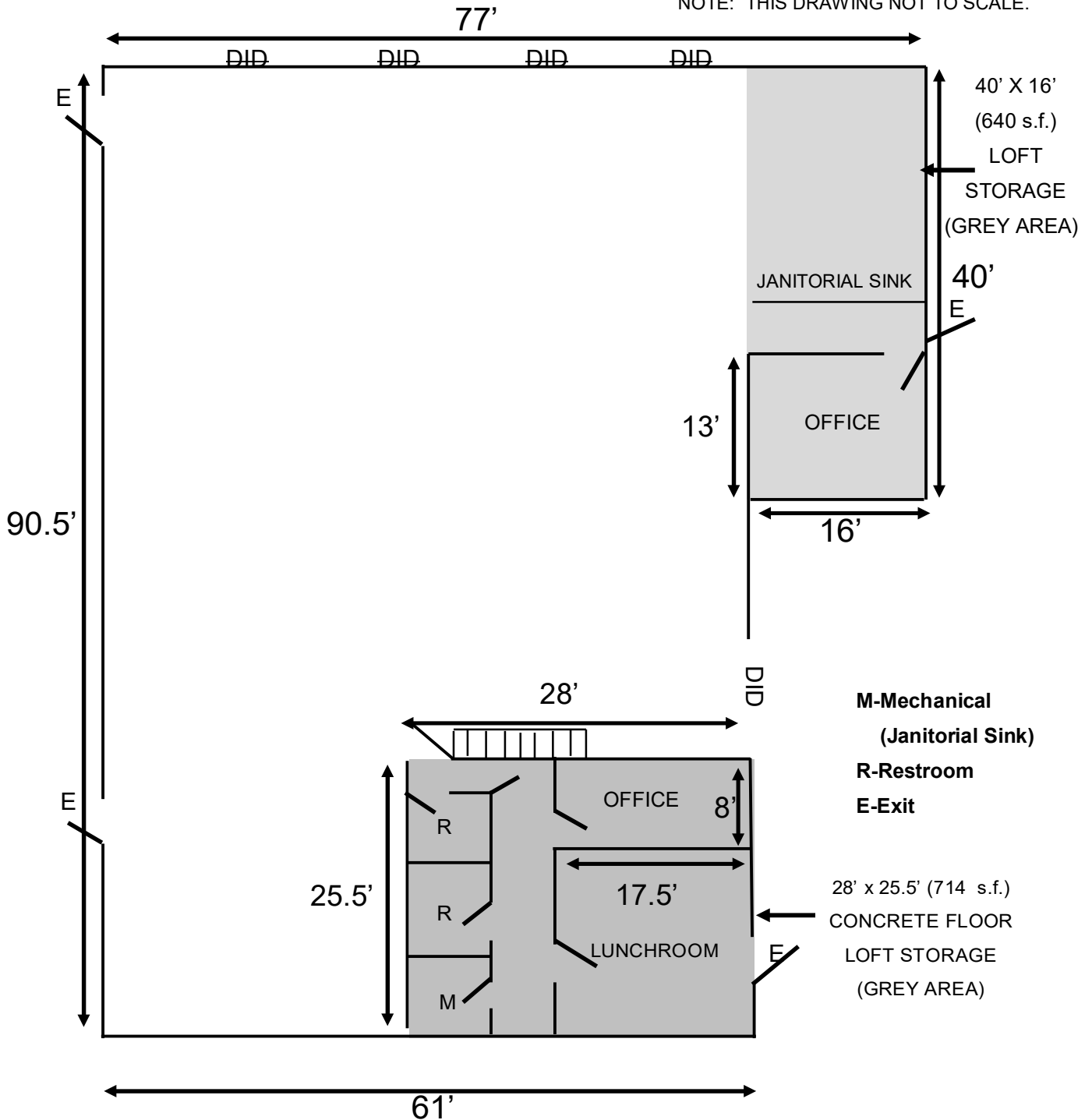

The Polivka Group, LLC Andrew Polivka Direct: 630-564-0017 apolivka@thepolivkagroup.com

All information herein is from sources deemed reliable but not guaranteed accurate. Subject to errors, omissions, and to change of price and terms, prior sale or lease, all without notice.