



ARES
INDUSTRIAL
MANAGEMENT

CHEYENNE CROSSING

3778 W. CHEYENNE AVENUE, SUITE 100, NORTH LAS VEGAS, NV 89032

FOR LEASE | ±19,497 SF Available | Warehouse / Office



JERRY DOTY, SIOR

+1 702 836 3735

jerry.doty@colliers.com

License # NV-S.0172045

PAUL SWEETLAND, SIOR

+1 702 836 3750

paul.sweetland@colliers.com

License # NV-S.0043604

MORGAN ELSON

+1 702 836 3710

morgan.elson@colliers.com

License # NV-S.0184877

DEVELOPED BY



ARES
INDUSTRIAL
MANAGEMENT

Property FEATURES

- High image design with mature landscaping
- Concrete tilt-up construction, built 2020
- Rear loading
- Floor slab: 7" thick, 4500 PSI
- ±52' x ±60" column
- spacing at docks
- ±250 Amps 277/480V, 3-phase, 4 wire
- ESFR sprinklers
- 2% skylights
- ±110' building depth
- Dock and grade level loading
- ±180' truck court
- ±60' concrete dock apron
- Evaporative cooled warehouse
- Auto parking: 90 spaces
- Zoning: M-1 (City North Las Vegas)
- Warehouse LED lighting

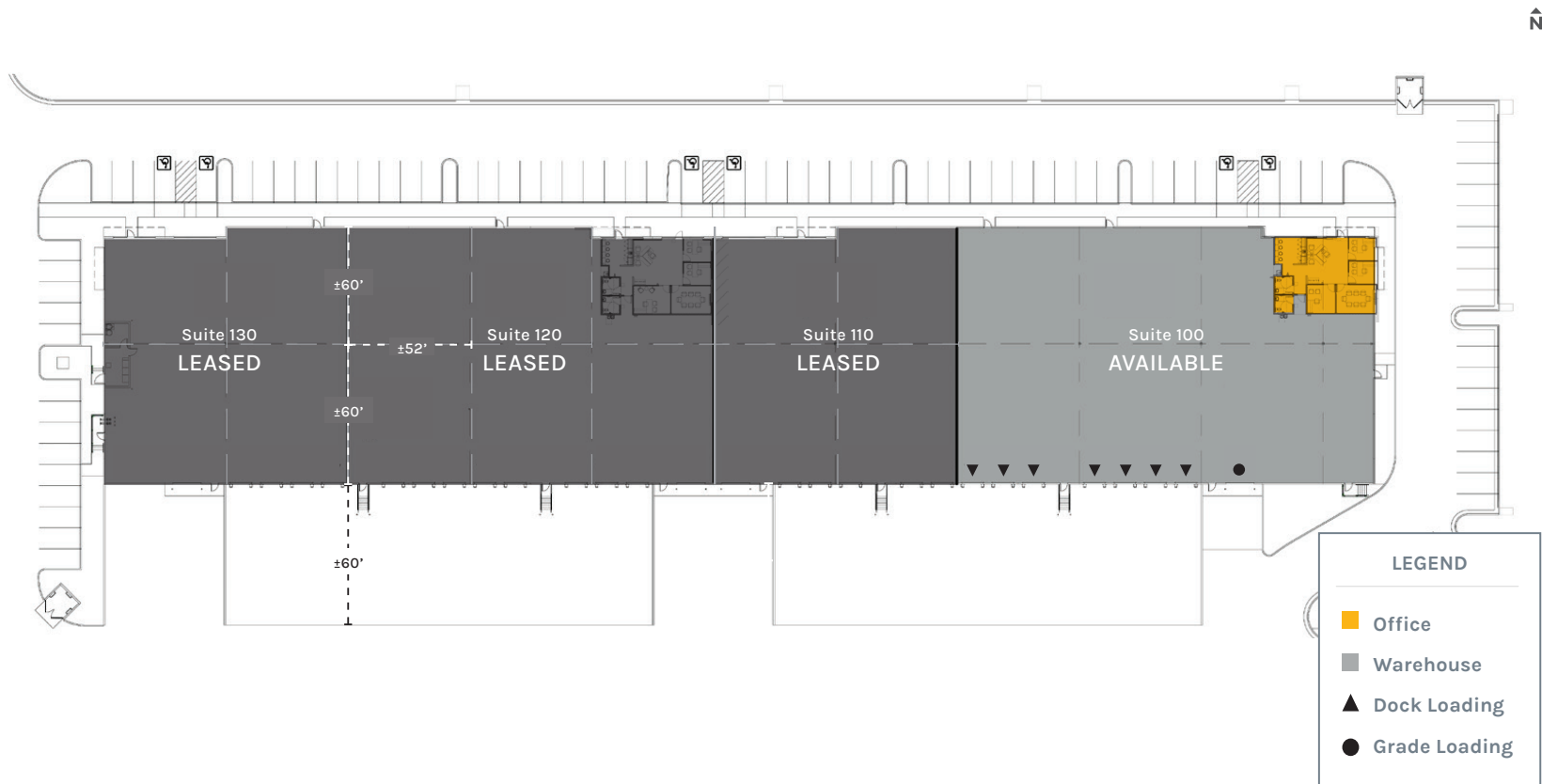



ARES
INDUSTRIAL
MANAGEMENT

Property
LOCATION

CHEYENNE CROSSING

3778 W. CHEYENNE AVENUE, SUITE 100, NORTH LAS VEGAS, NV 89032



ARES
INDUSTRIAL
MANAGEMENT

ABOUT ARES MANAGEMENT CORPORATION

Ares Management Corporation (NYSE: ARES) is a leading global alternative investment manager offering clients complementary primary and secondary investment solutions across the credit, private equity, real estate and infrastructure asset classes. We seek to provide flexible capital to support businesses and create value for our stakeholders and within our communities. By collaborating across our investment groups, we aim to generate consistent and attractive investment returns throughout market cycles. For more information, please visit www.aresmgmt.com.



JERRY DOTY, SIOR

+1 702 836 3735

jerry.doty@colliers.com

License # NV-S.0172045

PAUL SWEETLAND, SIOR

+1 702 836 3750

paul.sweetland@colliers.com

License # NV-S.0043604

MORGAN ELSON

+1 702 836 3710

morgan.elson@colliers.com

License # NV-S.0184877

DEVELOPED BY



**ARES
INDUSTRIAL
MANAGEMENT**