

522 FAXON ROAD N. | NORWOOD YOUNG AMERICA

RETAIL/OFFICE/MEDICAL FOR LEASE



High profile location off Hwy 212 in Norwood Young America

- Zoned C-2 General Commercial-bring your ideas!
- 985 SF / 1,520 SF (2,505 SF combined) & single offices available
- Improvement allowance available for qualified tenants
- 1.09 acre lot; 36+ parking stalls
- Large monument signage
- Building expansion possible

Ted LaFave 612.875.3858
tlafave@grandrea.com
www.grandrea.com

GRAND
REAL ESTATE ADVISORS

522 FAXON ROAD N. | NORWOOD YOUNG AMERICA

RETAIL/OFFICE/MEDICAL FOR LEASE



BUILDING INFORMATION

Building SF: 3,474 SF

Available SF: 2,505 SF

Gross Rent: \$18.00/SF Negotiable
(+utilities/meter)

Gross Rent-
Single Office: \$375/month

Signage: Monument

Parking: 36+ stalls

Lot Size: 1.09 acres

Year Built: 1980

Improvements: Renovated common
areas. Turn-key unit
buildout available.



RETAIL/OFFICE/MEDICAL FOR LEASE

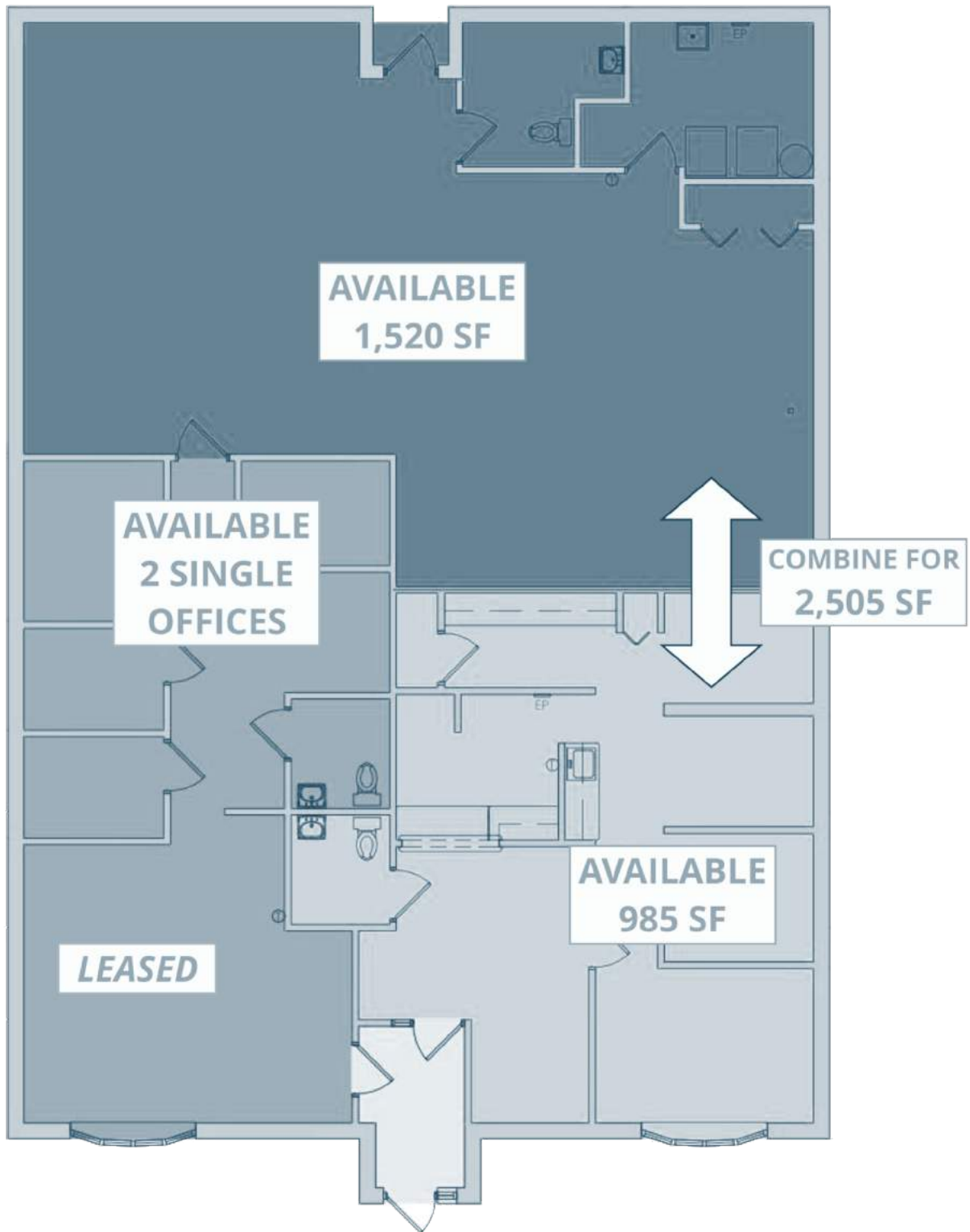

522 FAXON ROAD N. | NORWOOD YOUNG AMERICA

RETAIL/OFFICE/MEDICAL FOR LEASE

