



Property Description

A 26,939 square foot, "L-shaped" strip center built in 1999. This one-story, retail center is constructed of brick veneer with retail glass fronts. The center sits on 2.64 acres with ample parking, and easy access from S.W. 19th Street and the I-35 Service Road. High visibility and class "A" curb appeal. Riverwalk's traffic counts are well over 90,000 VPD. The City of Moore's average household income in both a three and five mile radius is in excess of the national average.

Property Highlights

- RETAIL SPACE AVAILABLE
- 2,853 SF (MOL)
- \$20.00 PSF
- Pylon Signage
- High Traffic Count Area
- Ample Parking
- Great Visibility

Offering Summary

Lease Rate:	\$20 SF/yr (NNN)
Available SF:	2,853 SF
Building Size:	26,939 SF

Demographics	1 Mile	5 Miles	10 Miles
Total Households	3,187	49,950	166,457
Total Population	7,893	123,609	408,724
Average HH Income	\$75,902	\$81,874	\$64,280

RICK PRITCHETT, CCIM

405.605.0831

rick@precorreality.com



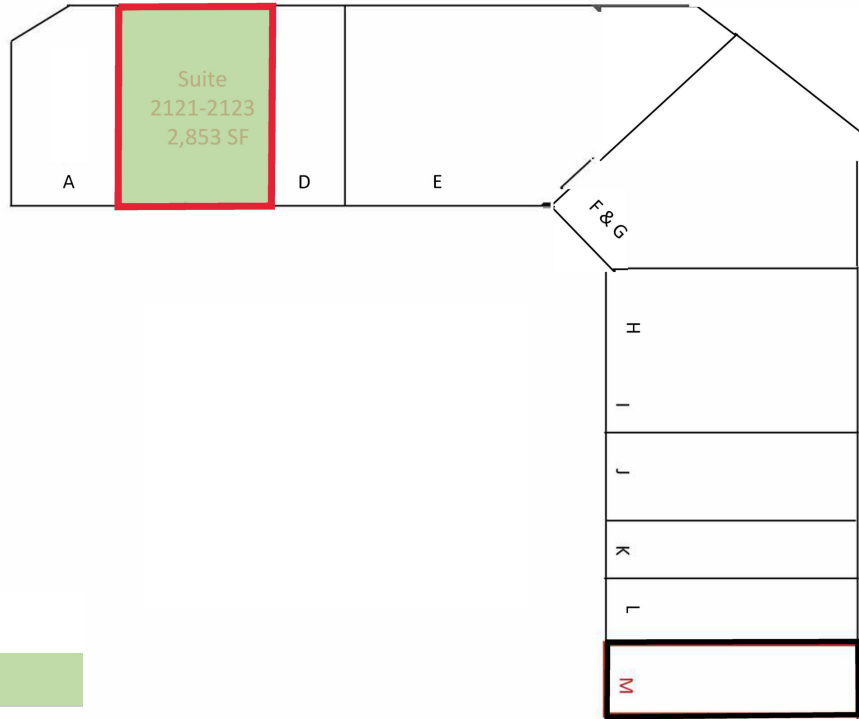

Legend

Available

Lease Information

Lease Type:	NNN	Lease Term:	36 months
Total Space:	2,853 SF	Lease Rate:	\$20 SF/yr

Available Spaces

Suite	Tenant	Size	Type	Rate	Description
2121-2123	Available	2,853 SF	NNN	\$20.00 SF/yr	-

RICK PRITCHETT, CCIM

405.605.0831

rick@precorreality.com



PRECOR
REALTY ADVISORS

PRECOR REALTY ADVISORS, INC | 825 N. BROADWAY, SUITE 300, OKLAHOMA CITY, OK 73102 | 405.605.0825 | PRECORREALTY.COM

The information above has been obtained from sources believed reliable. While we do not doubt its accuracy, PrecorRuffin, LLC has not verified it and makes no guarantee, warranty or representation about it. It is your responsibility to independently confirm its accuracy.

For Lease

2121-2123 Riverwalk Drive

RIVERWALK PLAZA 2121-2123

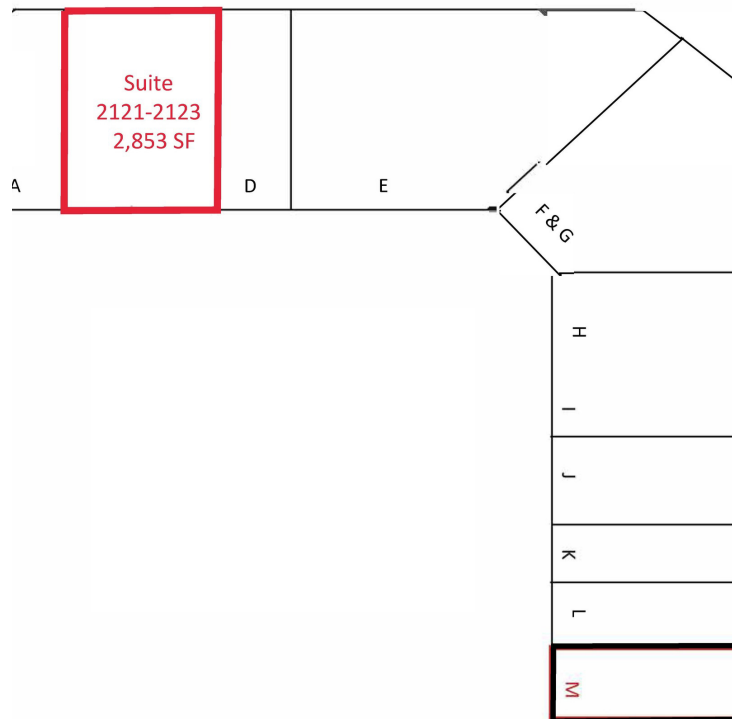

RICK PRITCHETT, CCIM

405.605.0831

rick@precorrealty.com



PRECOR REALTY ADVISORS, INC | 825 N. BROADWAY, SUITE 300, OKLAHOMA CITY, OK 73102 | 405.605.0825 | PRECORREALTY.COM

The information above has been obtained from sources believed reliable. While we do not doubt its accuracy, PrecorRuffin, LLC has not verified it and makes no guarantee, warranty or representation about it. It is your responsibility to independently confirm its accuracy.

For Lease

2121-2123 Riverwalk Drive

RIVERWALK PLAZA 2121-2123

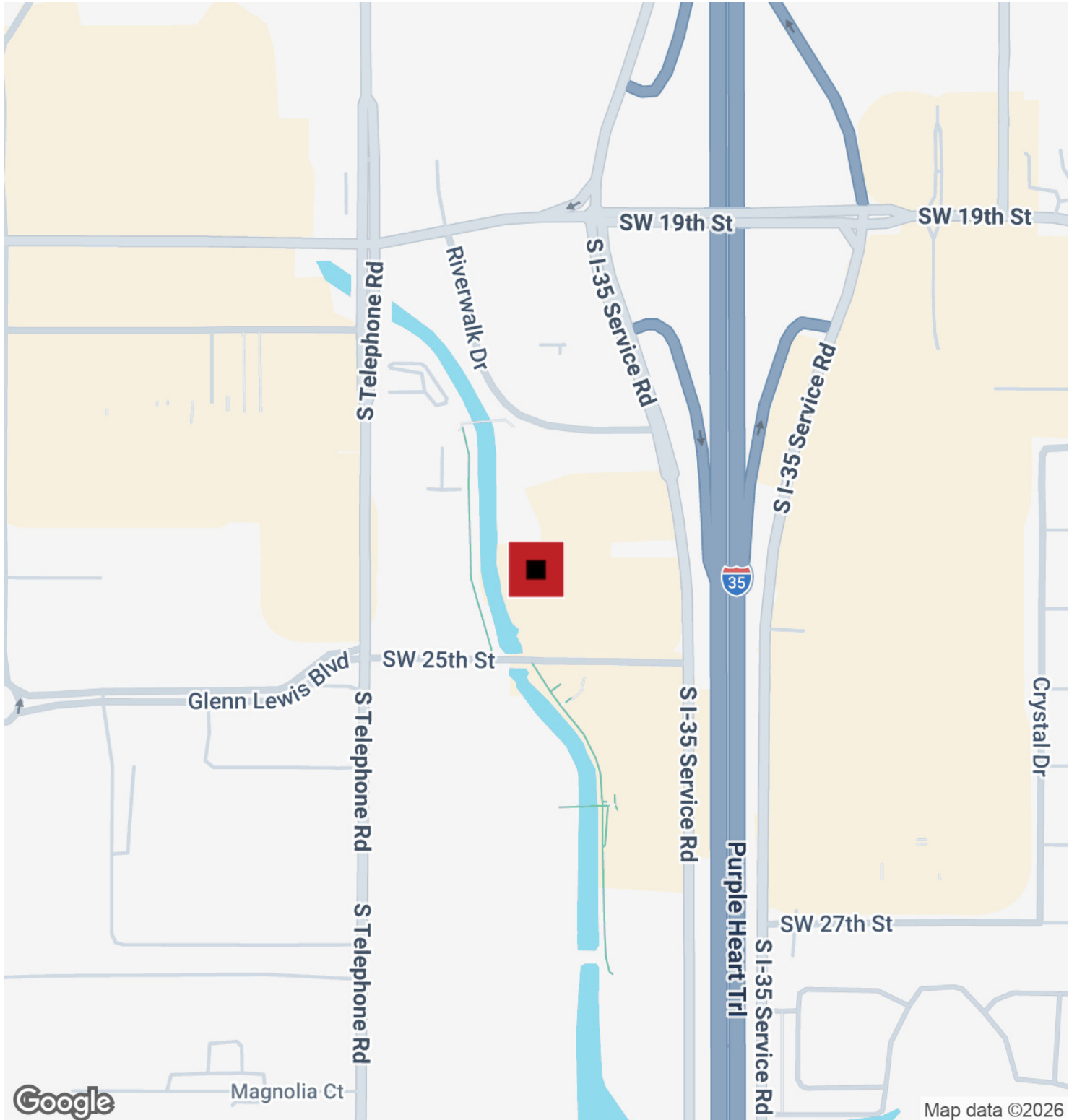

RICK PRITCHETT, CCIM

405.605.0831

rick@precorrealty.com



PRECOR
REALTY ADVISORS

PRECOR REALTY ADVISORS, INC | 825 N. BROADWAY, SUITE 300, OKLAHOMA CITY, OK 73102 | 405.605.0825 | PRECORREALTY.COM

The information above has been obtained from sources believed reliable. While we do not doubt its accuracy, PrecorRuffin, LLC has not verified it and makes no guarantee, warranty or representation about it. It is your responsibility to independently confirm its accuracy.