

Cocoa Multi-Tenant Retail/Office

817 Dixon Blvd, Cocoa, FL 32922



LOCATION DETAILS

Adjacent to the McDonald's on Dixon Blvd, a quarter mile southwest of N Cocoa Blvd/US-1.

Nearby retailers include Big Lots, Tractor Supply, and Subway at Byrd Plaza. Less than a 10-minute drive from I-95, and only 5-minutes from the Beachline Expressway (SR 528)/A1A intersection, offering easy access throughout Florida's Space Coast region.

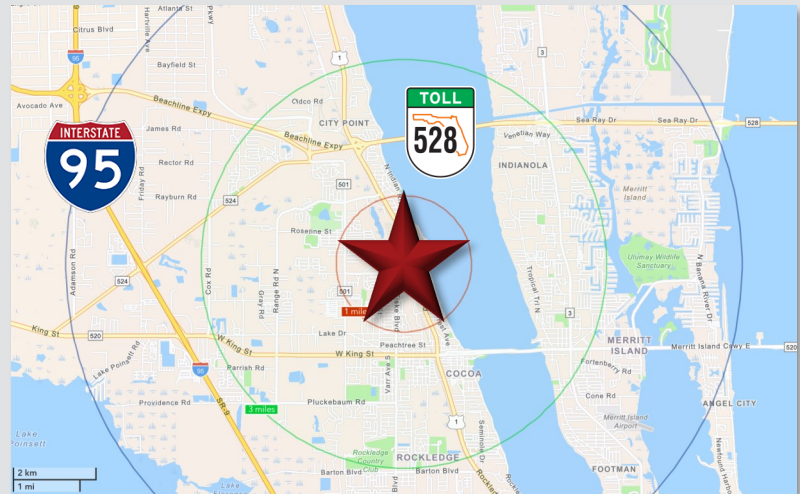

PROPERTY DETAILS

- **±15,572 SF** 2-Story Multi-Tenant Retail/Office
 - **Recently renovated** in 2020
 - Second floor is **wheelchair accessible** at ground level through the main entrance
- **±1.05 AC** with 304' frontage on Dixon Blvd
- Zoned for Neighborhood Commercial with the city of Cocoa
- Monument signage available
- **37 Shared parking spaces**

2023 DEMOGRAPHICS	1-MILE	3-MILE	5-MILE
Population	7,526	73,192	206,658
Average HH Income	\$73,685	\$90,846	\$102,300
Median HH Income	\$57,311	\$68,553	\$72,935

CONTACT FOR MORE INFORMATION

Rebecca Craddock
(407) 227-1197

Shellie Sevor, JD
(321) 377-1928

RebeccaR@palkiper.com Shellie@palkiper.com

Cocoa Multi-Tenant Retail/Office

817 Dixon Blvd, Cocoa, FL 32922

SUITE 103A

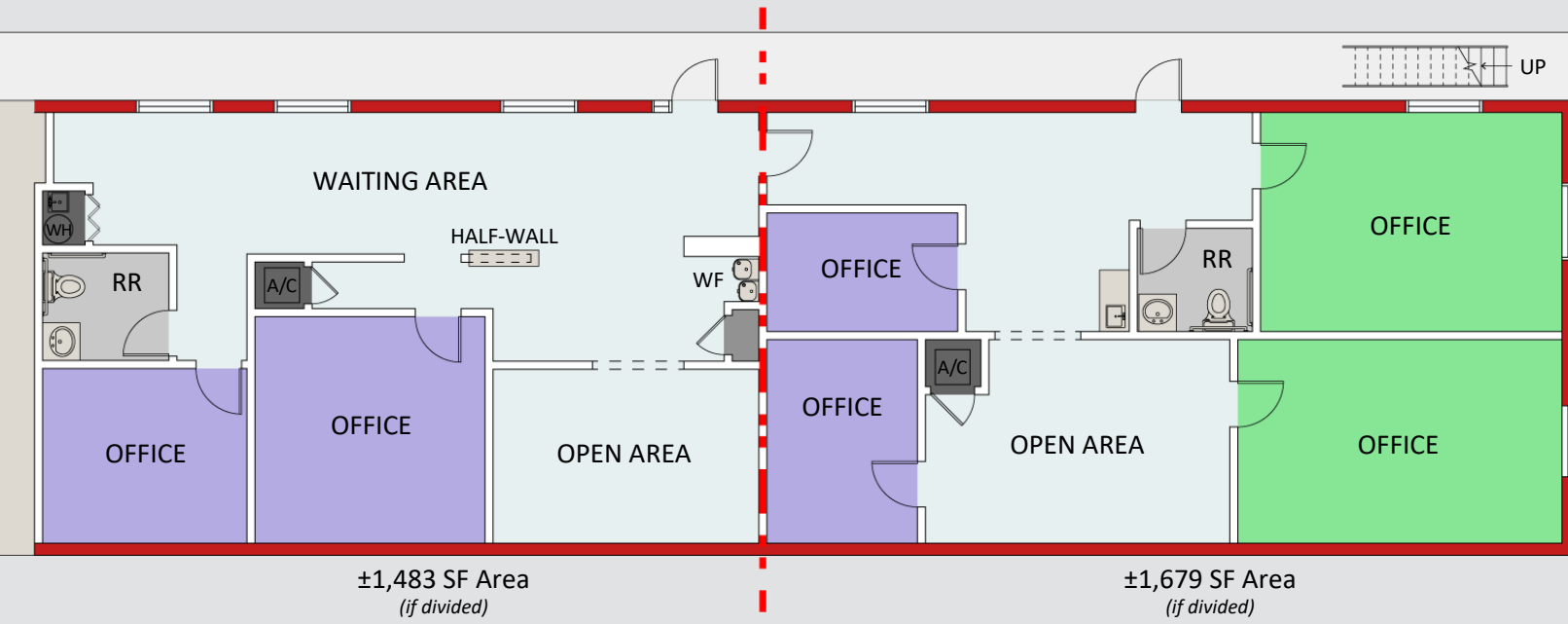

NOT TO SCALE

Illustrated for marketing purposes only.
Layout and furnishes may vary.
Subject to continued revisions.

POSSIBLE DIVISION

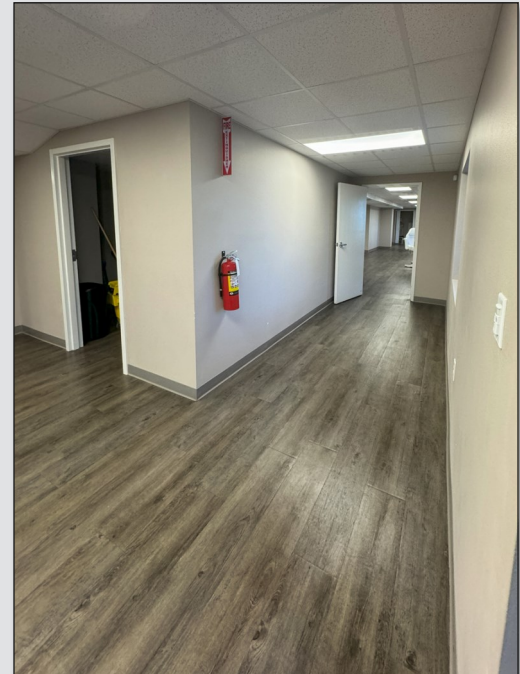

CONTACT FOR MORE INFORMATION

Rebecca Craddock

(407) 227-1197

RebeccaR@palkiper.com

Shellie Sevor, JD

(321) 377-1928

Shellie@palkiper.com

Cocoa Multi-Tenant Retail/Office

817 Dixon Blvd, Cocoa, FL 32922

 **Palkiper**
Commercial Real Estate Services
Licensed Real Estate Broker

SUITE 103A



CONTACT FOR MORE INFORMATION

Rebecca Craddock

(407) 227-1197

RebeccaR@palkiper.com

Shellie Sevor, JD

(321) 377-1928

Shellie@palkiper.com