

16,646 RSF Lab Suite Available

3624 Market Street
Philadelphia, PA



Lab/Office Space for Lease

- Move-in Ready Lab Suite
- 7 Fume hoods
- Autoclave/Washroom
- Cold storage room
- Tissue culture
- Floor-to-ceiling glass overlooking uCity Square campus

Leasing Contact

Paul Garvey

215 963 4013

paul.garvey@cushwake.com

Brian Young

215 963 4155

brian.young@cushwake.com



16,646 RSF Lab Suite Available

3624 Market Street

Philadelphia, PA

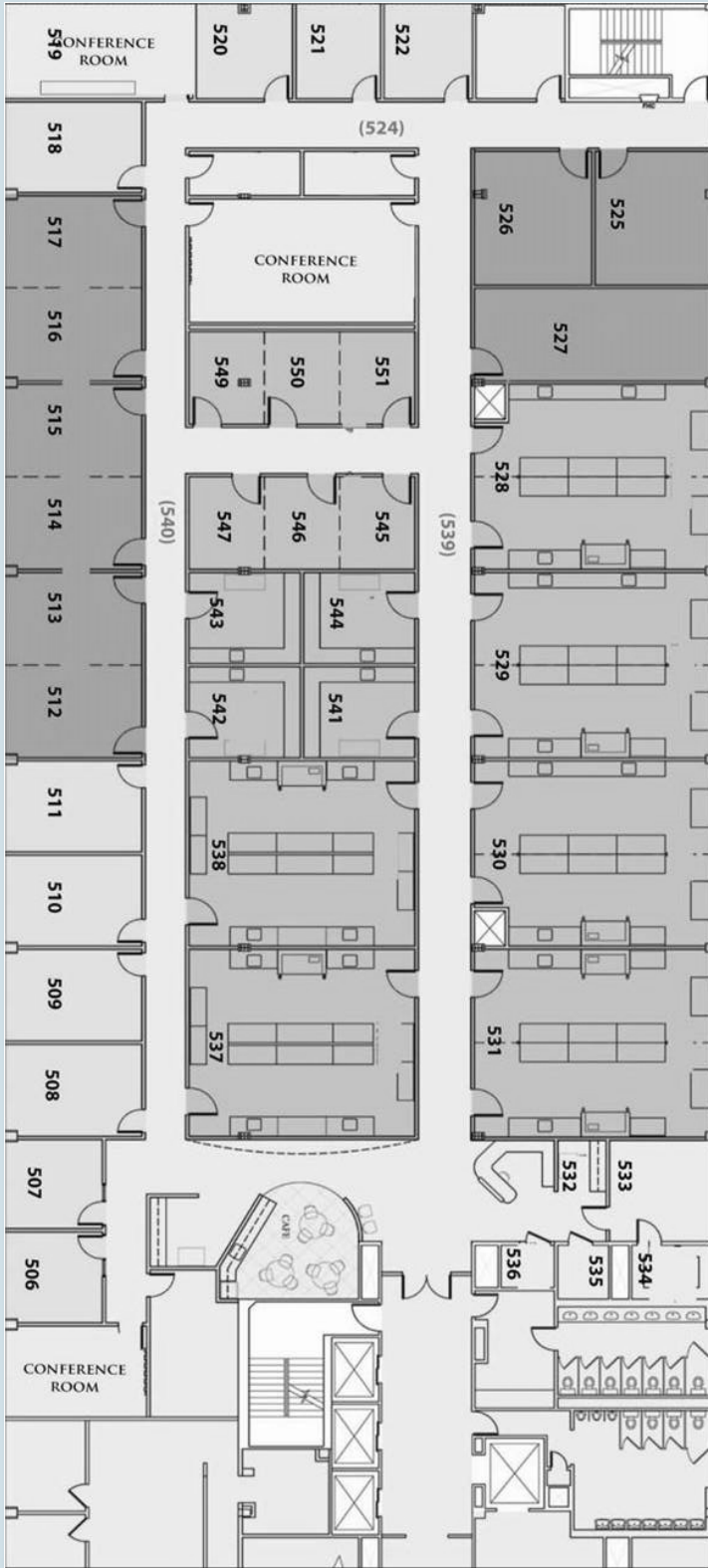

About 3624 Market Street

3624 is a 209,000 square foot Class A lab building in the center of uCity Square. This lab suite is move-in ready and well designed to accommodate a wide range of academic and commercial lab uses.

3624 sits across the street from the Quorum convening space at 3675 Market Street.

16,646 RSF Lab Suite Available

3624 Market Street
Philadelphia, PA



Rooted in the Vibrant Fabric of the University City Neighborhood

3624 Market provides access to uCity Square's rich array of **beautiful neighborhoods, tenant amenity spaces, and dynamic ground floor retail.**

Innovation is a contact sport. uCity Square is part of an active 24/7 community designed to create ample opportunities for employee engagement and serendipitous interaction.

100+

acres of park
and public spaces

200+

restaurants

70%+

of businesses
locally owned



16,646 RSF Lab Suite Available

3624 Market Street
Philadelphia, PA



A Welcoming Community of Growing Companies

With over over **200 life science companies** in the community, tenant benefit from the cluster of talent, innovation, and resources. uCity Square is the hub of cell and gene therapy discovery and development.

