

31 Graystone Street
Warwick, RI

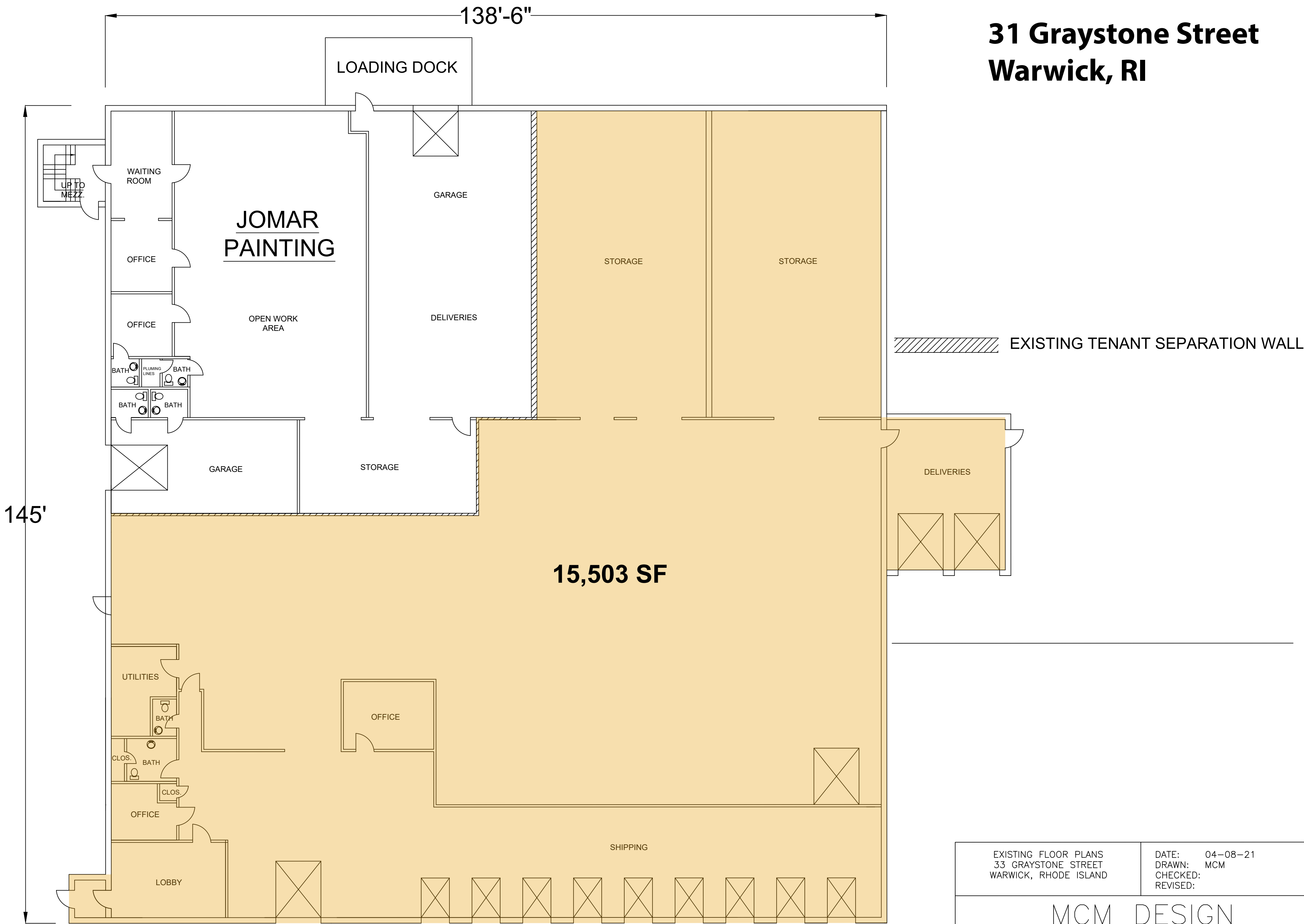

EXISTING FLOOR PLAN

SCALE: $\frac{3}{32}$ " = 1'- 0"

EXISTING FLOOR PLANS 33 GRAYSTONE STREET WARWICK, RHODE ISLAND		DATE: 04-08-21 DRAWN: MCM CHECKED: REVISED:	
MCM DESIGN ARCHITECTURAL DESIGN & CONSULTANT RESIDENTIAL/COMMERCIAL PLANNING			
MCM PROJECT NO.		SHEET NO. A-1	