

**At Intersection of I-26 and
Proximity to I-526**

6555 Fain Street
North Charleston, SC 29406



50,000 - 177,000 SF

Infill Warehouse Space



CBRE



6555 Fain

Property Highlights

- + Manufacturing/warehouse building located in close proximity to the Charleston International Airport
- + Zoned Light Industrial
- + Excellent access to I-26 and I-526
- + 3-Phase, 480V power throughout
- + 100% wet sprinkler system
- + Ample Laydown
- + 25' – 40' Column Spacing
- + 19' – 24' Clear Height
- + Ample Parking

Available Spaces

For Sublease

- + 51,541 SF
- + Available through April 2027
- + 1,500 SF Office Space
- + Suite C: 20,400 SF
 - + 4 Dock High Doors
- + Suite D: 31,141 SF
 - + 4 Dock High Doors
 - + 2 Drive-In Doors

For Lease

- + ± 50,000 - 177,000 SF
- + Up to 18,240 SF Office Space
- + 2 Dock High Doors
- + 4 Drive-In Doors

Floor Plan

±50,000 - 177,00 SF



 51,541 SF
FOR SUBLEASE

 50,000 - 125,980 SF
FOR LEASE

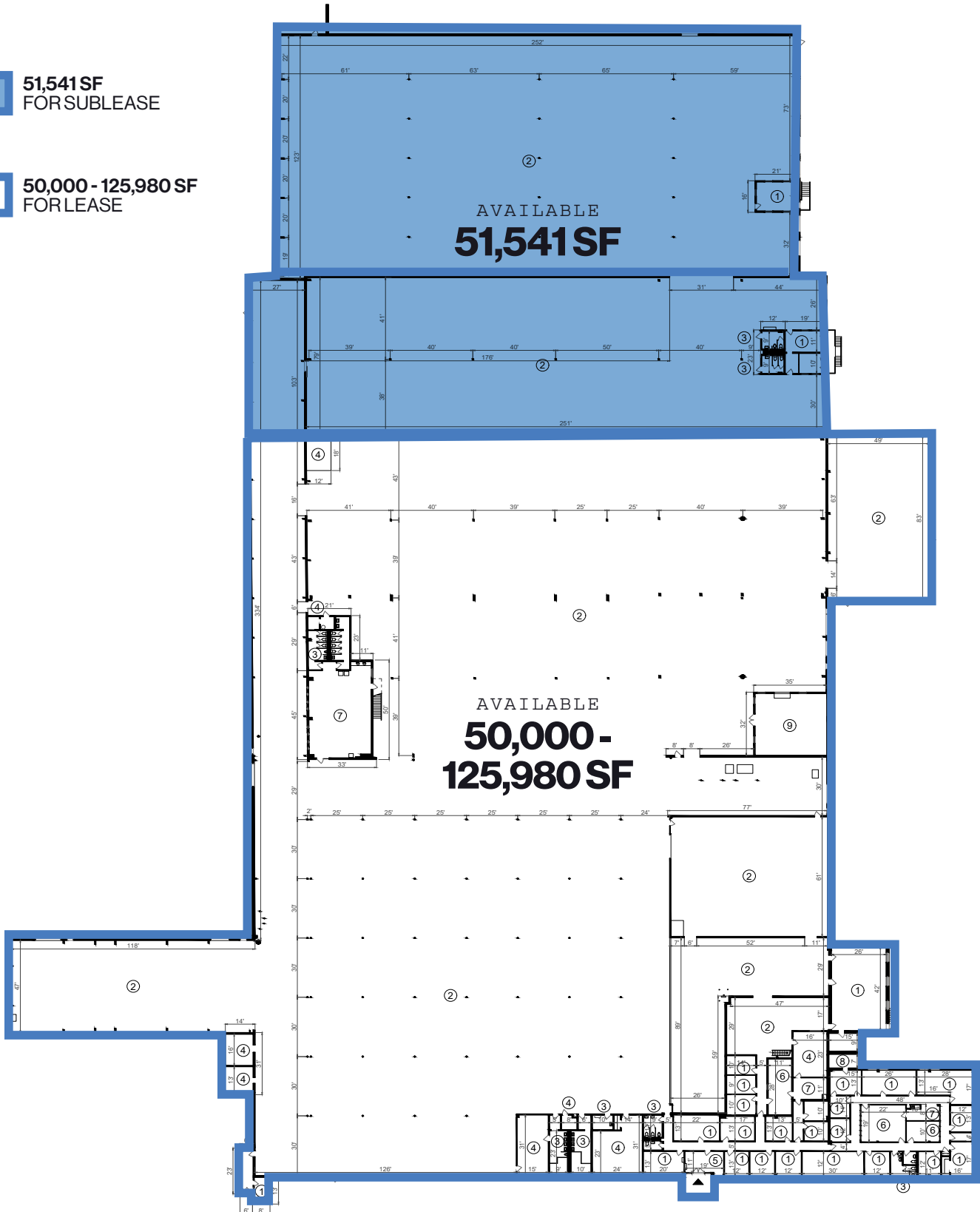

Aerial Map

Ingress/Egress

26

26

Fain Street



Eagle Drive

SPACE A
50,000 - 125,980 SF

SPACE C
20,400 SF

SPACE D
31,141 SF

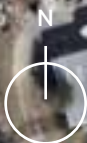

Area Map

Strategic Location

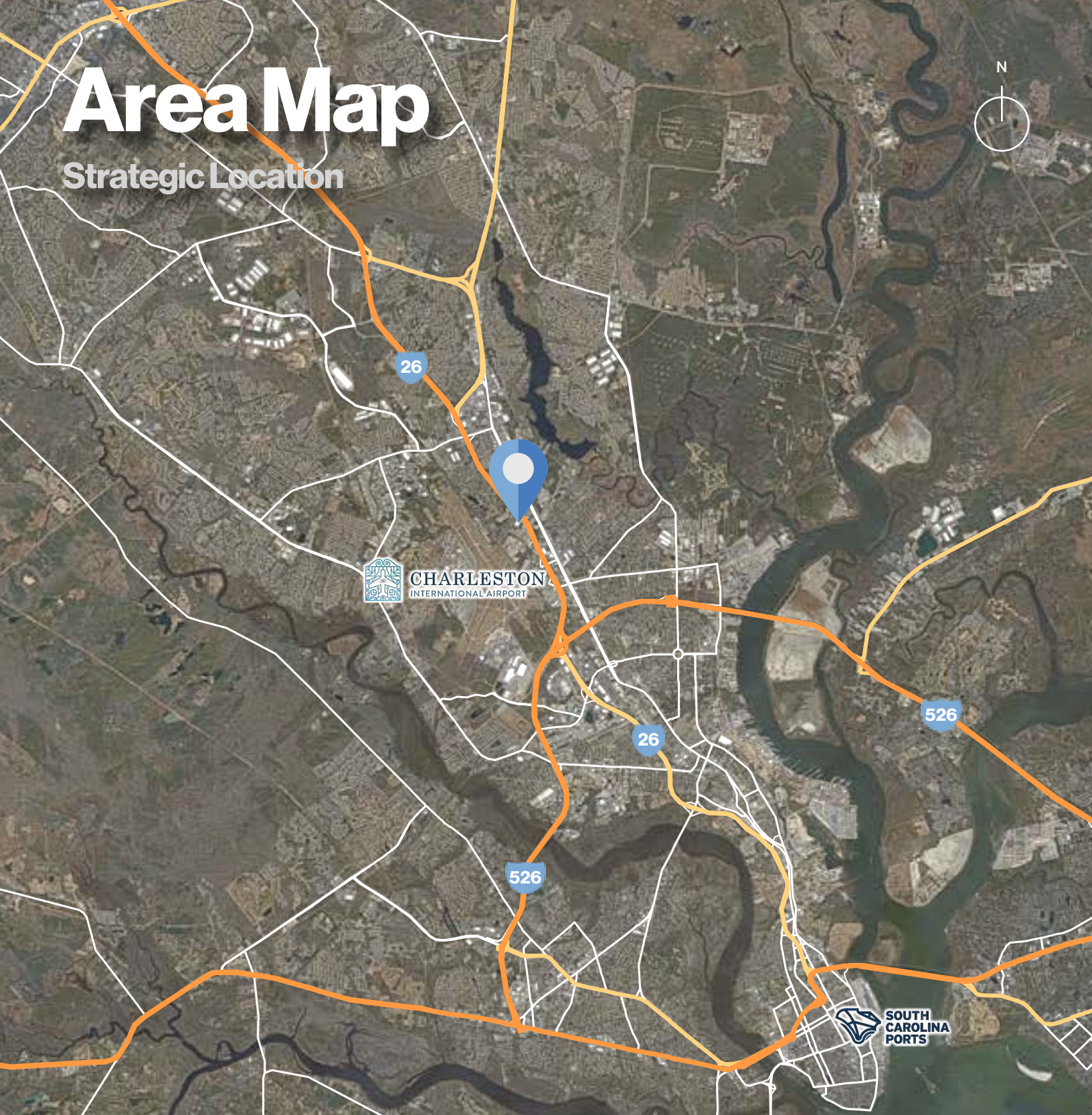

KEY DISTANCES

I-26 (Exit 211)

Less than 1 mile
2 mins

I-526 (Exit 18)

2.5 miles
7 mins

Charleston Int'l Airport

4.9 miles
11 mins

Charleston CBD

12.2 miles
20 mins

Port of Charleston

12.8 miles
21 mins

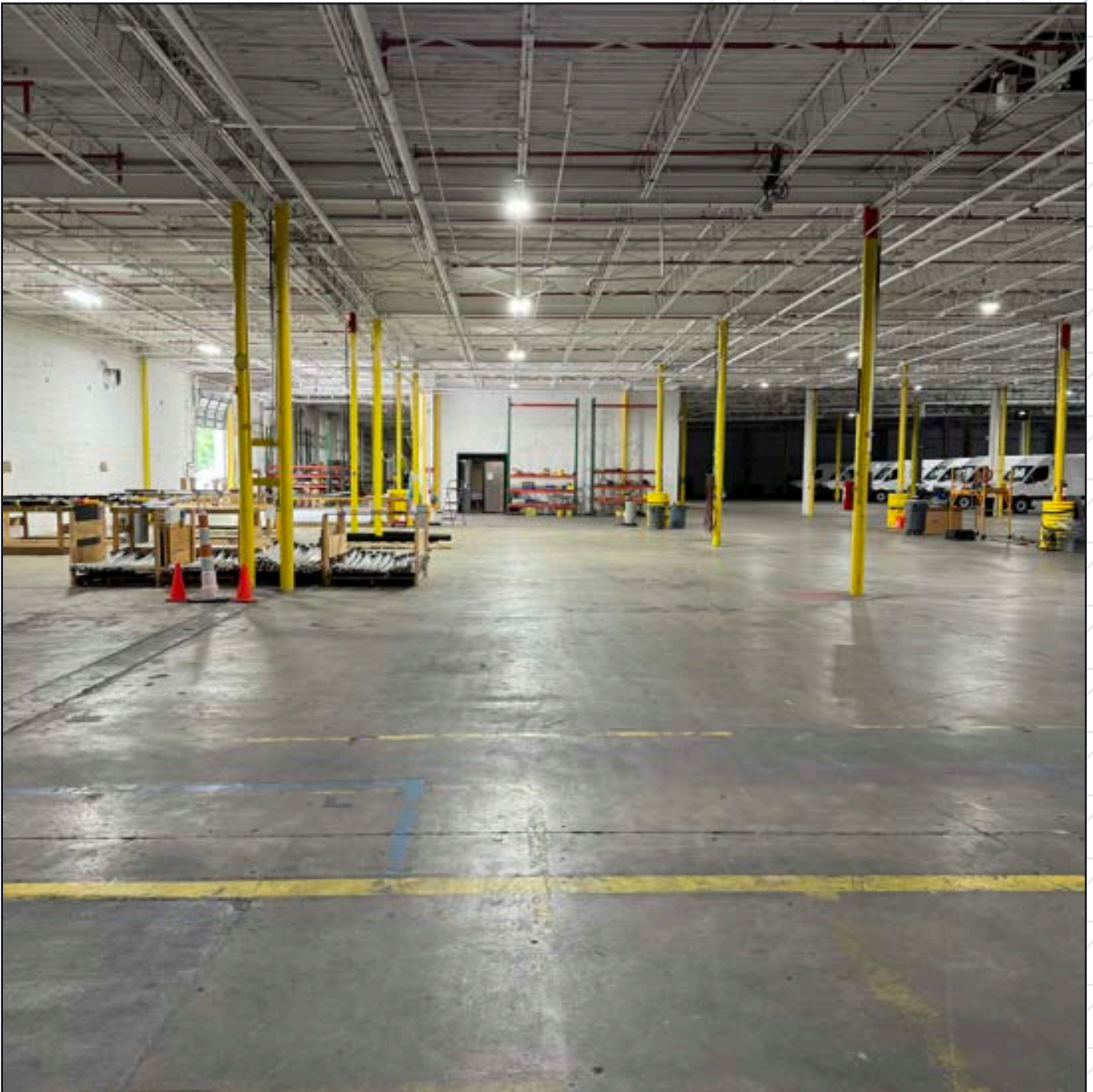

Contact Us

Robert Barrineau
Senior Vice President

+1843 270 7851
robert.barrineau@cbre.com

Brendan Redeyoff, SIOR
Senior Vice President

+1843 793 8839
brendan.redeyoff@cbre.com

Tim Raber, SIOR
Vice President

+1843 720 3555
tim.raber@cbre.com

© 2024 CBRE, Inc. All rights reserved. This information has been obtained from sources believed reliable but has not been verified for accuracy or completeness. CBRE, Inc. makes no guarantee, representation or warranty and accepts no responsibility or liability as to the accuracy, completeness, or reliability of the information contained herein. You should conduct a careful, independent investigation of the property and verify all information. Any reliance on this information is solely at your own risk. CBRE and the CBRE logo are service marks of CBRE, Inc. All other marks displayed on this document are the property of their respective owners, and the use of such marks does not imply any affiliation with or endorsement of CBRE. Photos herein are the property of their respective owners. Use of these images without the express written consent of the owner is prohibited.