

remailed
10/11/22

Dwayn Boos
On-Site Sewage Facilities
101 W. Main St, Mail Unit #9
Fredericksburg, TX 78624

On-Site Sewage Facility

Edwin Vale, Jr.
PO Box 460
Florence, Tx 76527

PERMIT #8906

Property Location: 820 Old San Antonio Rd Fredericksburg, Tx

GILLESPIE COUNTY, TEXAS

This serves to notify all persons that the on-site sewage facility owned by the above has satisfied design, construction, and installation requirements of the Texas Commission on Environmental Quality (TCEQ) and Gillespie County. This Gillespie County On-Site Sewage Facility Permit is issued for the operation of the above-identified on-site sewage facility.

ANY MODIFICATIONS TO THE STRUCTURE, SYSTEM COMPONENTS, OR CHANGES OF OWNERSHIP MAY REQUIRE A NEW PERMIT. The owner must notify this office of the aforementioned changes.

600GPD / WEEK = 12-BEDROOMS SIZED AT 100 GAL / BED (6 UNITS)
PLUS LAUNDRY 400 GALLONS PER WEEK, WEEKLY
FLOW IS 4000 GALLONS PER WEEK (571.43 GALLON PER DAY)

Title 30 of the Texas Administrative Code, Chapter 285 Order Adopting Rules of Gillespie County, Texas For On-Site Sewage Facilities requires an on-going maintenance contract for an aerobic surface application OSSF.

Inspector and Gillespie County Designated Representatives:

Dwayn C Boos

Dwayn C Boos OS0011257

Linda A Page OS0036695

10/10/2022 Date



GILLESPIE COUNTY
Permit Application for On-Site Sewage Facility

(Permit application is good for 1 year from purchase date.)

Permit # 8906 Date: 8-18-2022 Fee: \$600-

Reason For Permit (Circle one): New Construction System Replacement System Repair

Name of Landowner: Vale Jr. Edwin H.

Mailing Address: P.O. Box 460 Florence TX 76527

Daytime Phone Number(s): 254-394-3740 Cell Number(s): 254-394-3740

***Email Mandatory eviedalan1@gmail.com

Physical Address/Location of new Septic System: 820 Old San Antonio Rd
Fredericksburg TX 78624 ***GATE CODE: 1199

Legal Description: Gillespie CAD Property ID #: 2246 Volume _____ Page _____ Instrument# _____

Subdivision Name: _____ Lot#: _____ Blk _____ Phase _____ Tract _____
 or
 Abstract: 488 Survey Name and #: W O MER

Total Acreage: 15.02 Private Well Public Well (Supplier's Name): _____

Name & License # of person installing the Septic System: Mack Holland OS# 6223

Email: mack.holland@gmail.com Cell #: 512-748-2101

Information on a Single Family Residence: House Mobile Home Manufactured
 Total Square Footage of Living Area: <1500 <2500 <3500 <4500 or _____
 # of bedrooms 12, # of bathrooms (Full) 20 (Half) 0. Does it have or will it have water saving devices such as low flush toilets, reduced flow shower heads or faucets, pressure reducing valves and/or faucet aerators: Y or N Water Softener (Demand Initiated Regeneration): Y or N
 Is the water softener plumbed separate from the OSSF: Y or N

Information on a Non-Single Family Residence or Commercial/Institutional Facility (including Multi-Family residences) Describe usage:

12 BEDROOMS FOR THE 6 UNITS & LAUNDRY FOR BOTH EAST & WEST SIDE ON WEST OSSF (400 GALLONS/WEEK)

I certify that the above statements are true and correct to the best of my knowledge. Authorization is hereby given to Gillespie County OSSF Department to enter upon the above described property for the purpose of soil/site evaluation and investigation of an on-site sewage facility.

Eddie Vale 8-19-22
 (Signature of Landowner) (Date)

Office Use Only:
 Daily wastewater usage rate: Q= 600 (gallons/day) 600 GPD, WEEKLY AVERAGE/DAY
 Site Evaluation 1,600 GPD ON 3 DAYS OF THE WEEK, SEE DESIGN
 Planning Materials submitted by: Installer P.E. R.S.
 Development Plans required for Subdivisions, Manufactured Housing Communities, Multi-Unit Residential Development, Business Parks, or other similar uses (i.e. B&B Rental, R.V. Park)
 Floodplain and/or Development Permit # 2548-22
 For Aerobic Treatment units and non-standard treatment (if applicable):
 Affidavit to the Public
 Two-year Maintenance Contract 180D/YR
 AUTHORIZATION to CONSTRUCT
 DR: Dwayne C Boos DATE: Sept 2, 2022

WEST PHASE 1

PHASE 1
WEST

Certification of Approval

Final Inspection PERMIT # 8906

Date: 10/10/2022 Approved by: Dwain C. Boos

I. Sewer (House Drain) 3" Sch 40 4" Sch 40 Other: Sch 80 (BETWEEN UNITS)
 Slope of sewer pipe to tank minimum of 1/8"/ft.
 Cleanouts every <100' and within 5' of 90° bends

II. Treatment: Conventional Tanks Aerobic Other: _____

TANKS SIZE AND COMPARTMENTS	SERIAL#	RISERS	MANUFACTURER
1. <u>1000/5</u>	<u>913223</u>	Y/N	<u>Buchanan</u>
2. <u>1750/5</u>	<u>91522</u>	Y/N	<u>"</u>
3. <u>1750/5</u>	<u>915221</u>	Y/N	<u>"</u>
4. <u>A800</u>	<u>NA</u>	Y/N	<u>"</u>

III. Disposal Field: Conventional Gravel Leaching Chambers (Brand) _____
 Low-Pressure Pipe Mounds Gravel-Less Pipe Pressure Emitters (drip)
 ET Beds Other: _____

Subsurface Disposal:

LENGTH OF TRENCH	WIDTH	HEIGHT OF MEDIA	CREDIT	AREA LENGTH X CREDIT
1. _____ ft.	_____ ft.	_____ ft.	_____	_____ Sq.ft.
2. _____ ft.	_____ ft.	_____ ft.	_____	_____ Sq.ft.
3. _____ ft.	_____ ft.	_____ ft.	_____	_____ Sq.ft.

IV. Surface Disposal (Application):
 Loading Rate: 0.064 Area Required in Sq. ft. _____
 Area Designed in Sq. ft. 9,650
 Timer installed Y/N
 Anti-siphon Hole used Y/N
 Check valve used Y/N

V. Map of System: GPS UTM 14 R _____ **Not to Scale**

SEE DESIGN

E.Q. TANKS DOSE 5 GALLON PER MINUTES
 RUN TIME = 5 MINUTES (5 MINUTES X 5 gal/min = 25 gal DOSE)
 OFF TIME = 1 HOUR
 MAX DOSE PER DAY = 600 GALLONS
 NIGHT SPRAY
 COMPRESSOR Hi blow HP 120 # 1221 005581

820 OLD SAN ANTONIO ROAD IN GILLESPIE COUNTY, TEXAS
 ABS A0488 W O MERRIWETHER #36, 15.02 ACRES

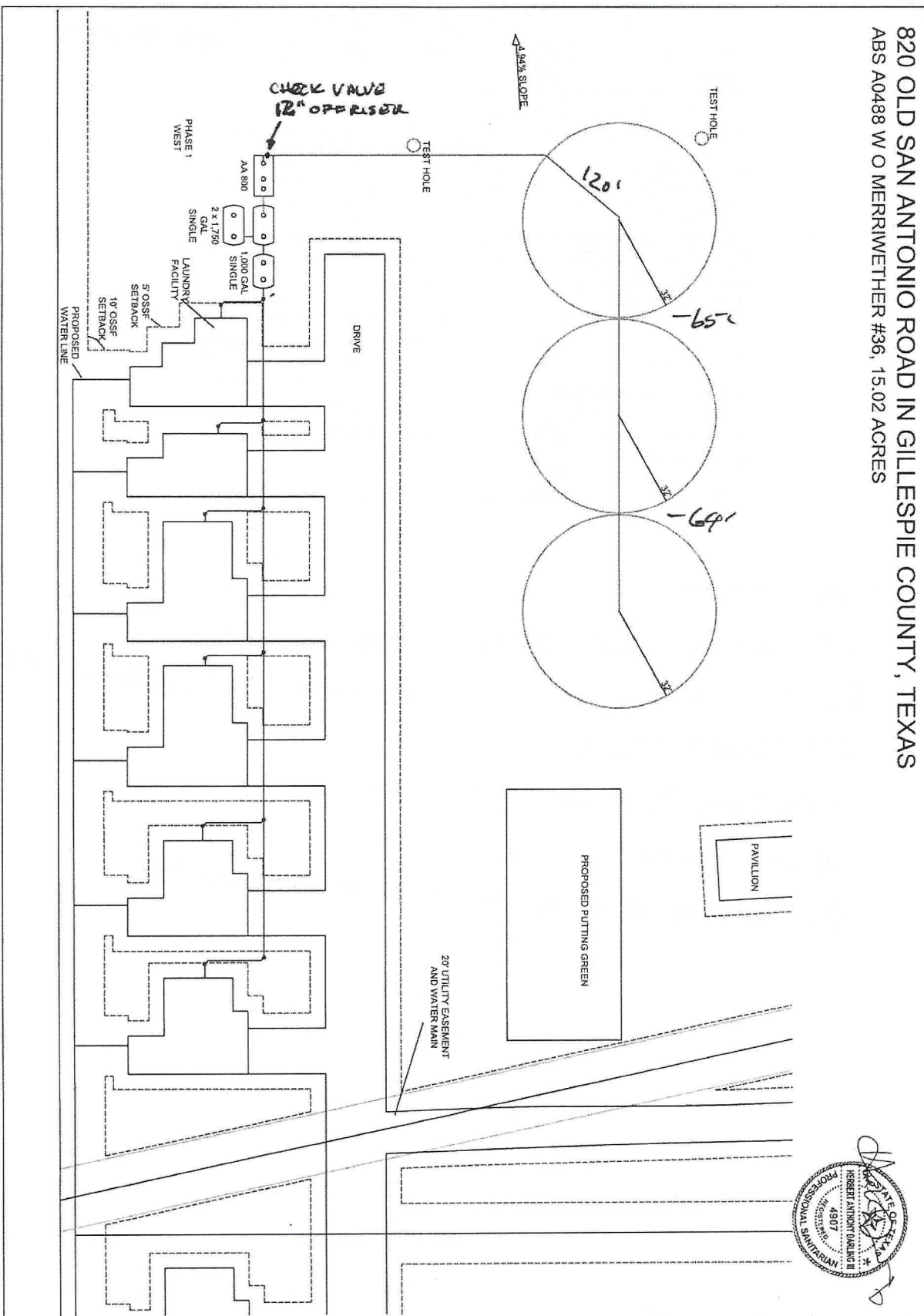

HILL COUNTRY SEPTIC AND ENVIRONMENTAL, LLC
 432 WINDING HOLLOW LANE, GEORGETOWN, TEXAS 78628
 (512) 775-0338 hdarling@hcseptic.com

DESIGNED BY: HDARLING
 DATE: 08/15/2022
 ADDRESS: 820 OLD SAN ANTONIO RD

SCALE
 1" = 30'

REVISIONS:
 08/30/2022

820 OLD SAN ANTONIO ROAD IN GILLESPIE COUNTY, TEXAS
 ABS A0488 W O MERRIWETHER #36, 15.02 ACRES

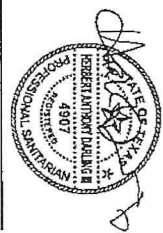
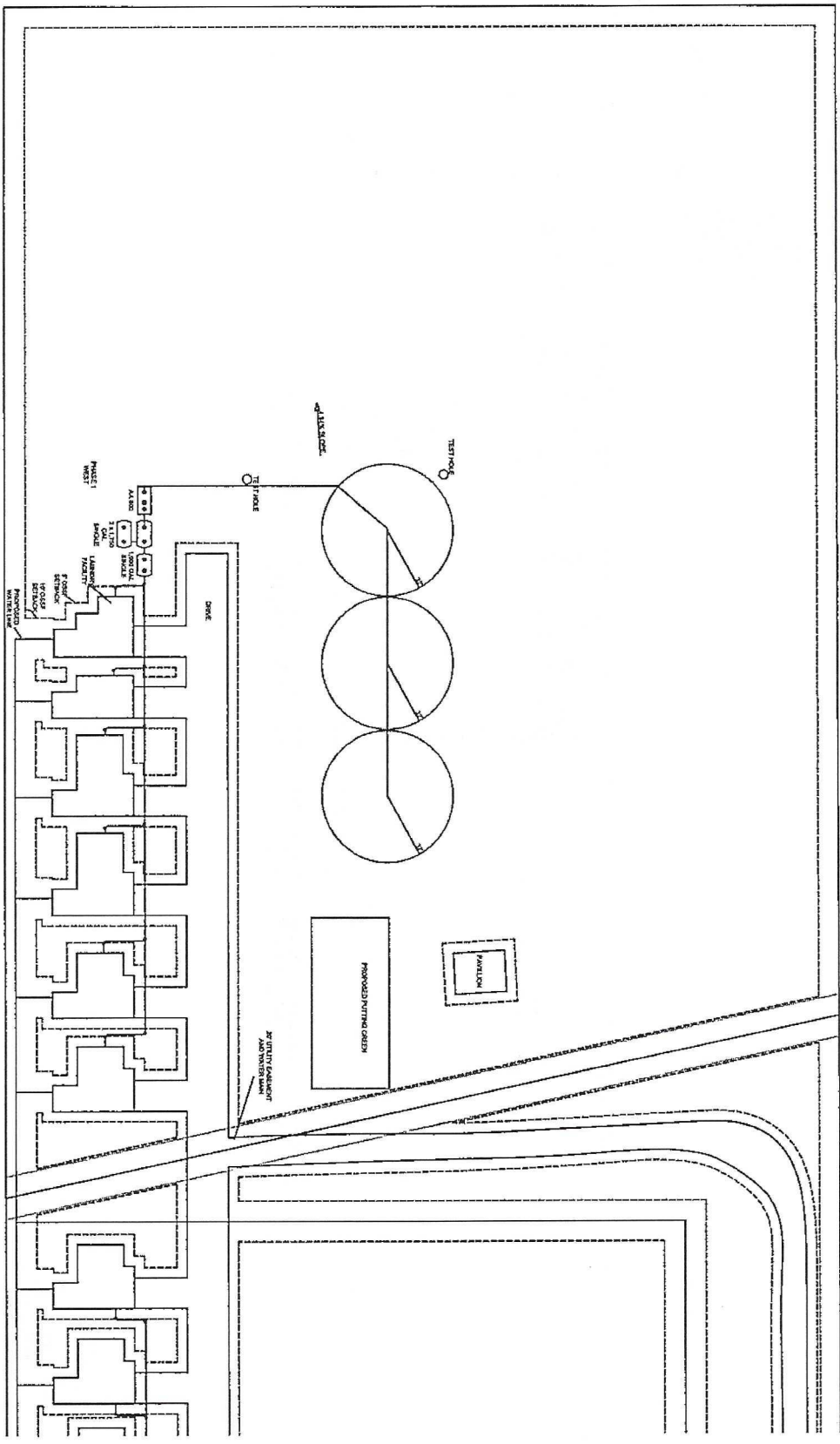

HILL COUNTRY SEPTIC AND ENVIRONMENTAL, LLC
 432 WINDING HOLLOW LANE, GEORGETOWN, TEXAS 78628
 (512) 775-0338 hdarling@hcseptic.com

DESIGNED BY: HDARLING
 DATE: 08/15/2022
 ADDRESS: 820 OLD SAN ANTONIO RD

SCALE
 1" = 50'

REVISIONS:

820 OLD SAN ANTONIO ROAD IN GILLESPIE COUNTY, TEXAS
ABS A0488 W O MERRIWETHER #36, 15.02 ACRES

WEST
PHASE

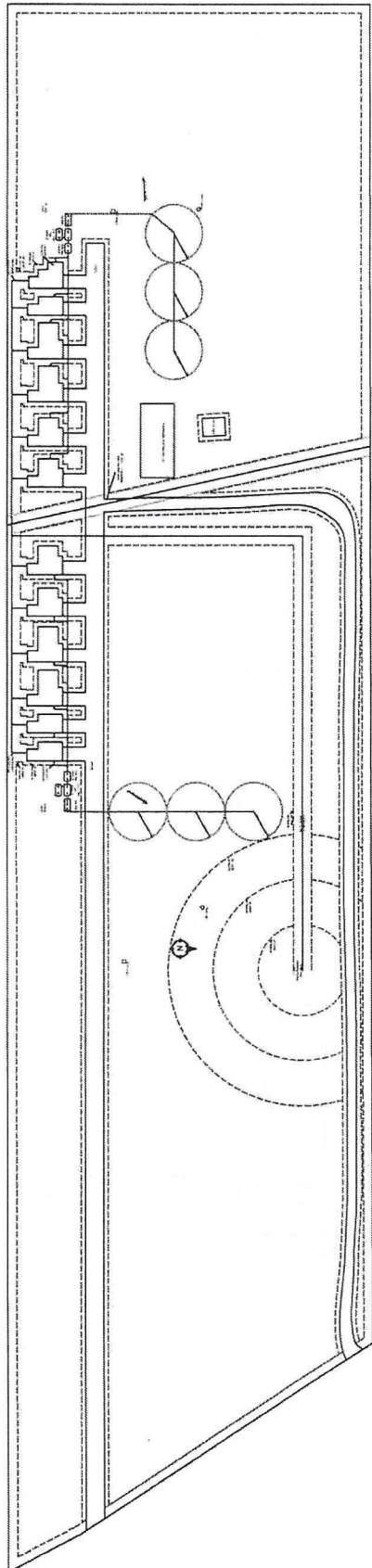

HILL COUNTRY SEPTIC AND ENVIRONMENTAL, LLC 432 WINDING HOLLOW LANE, GEORGETOWN, TEXAS 78628 (512) 775-0338 hdarling@hcseptic.com	DESIGNED BY: HDARLING DATE: 08/15/2022 ADDRESS: 820 OLD SAN ANTONIO RD	NOT TO SCALE	REVISIONS: 08/30/2022
--	--	--------------	--------------------------

820 OLD SAN ANTONIO ROAD IN GILLESPIE COUNTY, TEXAS
 ABS A0488 W O MERRIWETHER #36, 15.02 ACRES

E.O. Tank Weekly Average Size for 600 GPD

THIS DESIGN IS FOR PHASE ONE OF A MULTI-PHASE PROJECT CONSISTING OF RENTAL CABINS. THE CABINS WILL BE OCCUPIED THREE DAYS A WEEK. THE CABINS SPAN FROM ONE TO THREE BEDROOM UNITS WITHOUT A KITCHEN. THE LAUNDRY FACILITY ONSITE WILL NOT BE MADE AVAILABLE TO GUESTS AND IS TO BE USED FOR HOUSEKEEPING PURPOSES ONLY ONCE PER WEEK.

EACH CABIN HAS A DESIGNED FLOW OF 100 GPD PER BEDROOM. PHASE ONE IS SPLIT INTO TWO SIDES BY THE WATER MAIN EASEMENT RUNNING THROUGH THE PROPERTY. EACH SIDE, REFERRED TO ON THE DESIGN AS "PHASE 1 EAST" AND "PHASE 1 WEST", CONSISTS OF TWELVE BEDROOMS. THE LAUNDRY FACILITY IS ON PHASE 1 WEST, WITH A MAX FLOW RATE OF 1,600 GPD, WHILE PHASE 1 EAST IS 1,200 GPD.

THREE DAYS AT 1,200 GPD EACH GIVES A TOTAL WEEKLY FLOW OF 3,600 GALLONS, AVERAGED OUT TO 514.29 GPD FOR PHASE 1 EAST WHILE THE WEEKLY FLOW OF 4,000 GALLONS, AVERAGES OUT TO 571.43 GPD FOR PHASE 1 WEST. IN ORDER TO TAKE A CONSERVATIVE APPROACH, EACH SYSTEM IS SIZED TO TREAT AN AVERAGE OF 600 GPD. THE TREATMENT AND DISPOSAL UNITS FOR PHASE 1 EAST AND PHASE 1 WEST ARE IDENTICAL. TREATMENT CONSISTS OF A BUCHANAN SEPTIC TANKS 1,000 GALLON SINGLE COMPARTMENT TRASH TANK, TWO BUCHANAN SEPTIC TANKS 1,750 GALLON SINGLE COMPARTMENT TANKS MANFOLDED TOGETHER AS AN EQUALIZATION TANK, AND AN AQUA AIRE AA800-00110 ATU WITH AN ATTACHED 1,096 GALLON PUMP TANK.

DUAL LIBERTY LE41 PUMPS WILL DOSE THE ATU HOURLY (24 TIMES A DAY) AT 5 GPM DELIVERING UP TO 25 GALLONS PER DOSE USING AN R/R ALT-DT-LA CONTROL PANEL. A STA-RITE DOMINATOR 20DOM51214" SUBMERSIBLE PUMP IN THE PUMP TANK WILL DELIVER THE EFFLUENT THROUGH 1" SCH40 PVC TO THREE 32" RADIUS K-RAIN PROPULSUS ROTORS IN THE FILED OPERATED BY AN ECOLOGICAL TANKS, INC. MODEL 203 CONTROL PANEL.

Q = 1200

Q = 1600 GPD

SITE SUMMARY PH 1 EAST		SITE SUMMARY PH 1 WEST	
NO. BEDROOMS	12	NO. BEDROOMS	12
WATER SAVING DEVICES	YES	WATER SAVING DEVICES	YES
SOIL TYPE	CLASS IV	SOIL TYPE	CLASS IV
FLOODPLAIN	NO	FLOODPLAIN	NO
EDWARDS AQUIFER RECHARGE ZONE	NO	EDWARDS AQUIFER RECHARGE ZONE	NO
RECHARGE FEATURES WITHIN 100'	NO	RECHARGE FEATURES WITHIN 100'	NO
WATER SOURCE	PUBLIC	WATER SOURCE	PUBLIC

- INSTALLER SHALL INSTALL THE OSSF IN ACCORDANCE WITH TCEQ AND LOCAL GOVERNMENT CODES
- THE OWNER OR CONTRACTOR IS RESPONSIBLE FOR IDENTIFYING ALL PROPERTY LINES, EASEMENTS, WELLS, AND OTHER RELATED IMPROVEMENTS EITHER ACTUAL OR PROPOSED AND VERIFY THAT THE SEPTIC SYSTEM INSTALLATION DOES NOT VIOLATE ANY REGULATION OR LAW.
- PVC FROM THE CABINS TO THE TANK SHALL BE SCH40 STANDARD AND HAVE A MINIMUM OF 1/8" PER FOOT OF FALL, AND THE LINE SHALL CONTAIN A 3/4" SCHED TWO-WAY CLEANOUT WITHIN 3' OF THE STRUCTURE TO THE TANK AS NECESSARY
- ALL OSSF COMPONENTS MUST MAINTAIN A MINIMUM 10' SETBACK TO ANY WATER LINE
- THERE SHALL BE NOTHING IN THE SURFACE APPLICATION AREA WITHIN TEN FEET OF THE SPRINKLERS WHICH WOULD INTERFERE WITH THE UNIFORM APPLICATION OF EFFLUENT
- BARE AREAS AND EXPOSED ROCK SHALL BE BACKFILLED WITH IMPORTED CLASS II OR III TOPSOIL TO AN ADEQUATE DEPTH TO SUPPORT VEGETATION IN THE SURFACE APPLICATION AREA
- VEGETATION IN THE SURFACE APPLICATION AREA SHALL BE CAPABLE OF GROWTH BEFORE SYSTEM START-UP

DESIGN CALCULATIONS

ABSORPTIVE AREA = Q/Ra
 Q = 600.00 GALLONS
 Ra = 0.064 GPD
 A = 9,375.00 SF

REQUIRED AREA = 9,375.00 SF
 DESIGNED AREA = 9,650.97 SF
 *CALCULATIONS ARE THE SAME FOR PH 1 EAST AND PH 1 WEST



NO. OF NOZZLES	3
RADIUS	32'
ROTATION	360°
AREA PER NOZZLE	3,216.99 SF
TOTAL AREA	9,650.97 SF

HILL COUNTRY SEPTIC AND ENVIRONMENTAL, LLC
 432 WINDING HOLLOW LANE, GEORGETOWN, TEXAS 78628
 (512) 775-0338 hdarling@hcseptic.com

DESIGNED BY: HDARLING
 DATE: 08/15/2022
 ADDRESS: 820 OLD SAN ANTONIO RD

NOT TO SCALE

REVISIONS:
 08/30/2022

820 OLD SAN ANTONIO ROAD IN GILLESPIE COUNTY, TEXAS
 ABS A0488 W O MERRIWETHER #36, 15.02 ACRES



- ① PUMP HOUSE
- ② 4.5" K-RAIN PROPULS CLEAR BORE ROTOR
- ③ 4" PUMP HOUSING PORT
- ④ 4" PUMP HOUSING PORT
- ⑤ 4" PUMP HOUSING PORT
- ⑥ 4" PUMP HOUSING PORT
- ⑦ 4" PUMP HOUSING PORT
- ⑧ 4" PUMP HOUSING PORT
- ⑨ 4" PUMP HOUSING PORT

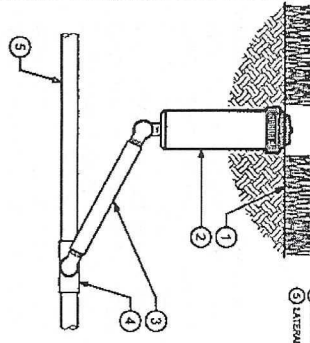

K-RAIN PROPULS ROTOR WITH 4" POP-UP

- MODEL NO. 11003
- MODEL HAS A PURPLE TOP TO INDICATE WASTEWATER USE ONLY
- LOW ANGLE 12° NOZZLES TO BE USED AT ALL TIMES

LOW ANGLE PERFORMANCE DATA

NOZZLE	PRESSURE (PSI)	RADIUS (FT.)	FLOW (GPM)
# 1.0	30/40/50/60	22/24/26/28	1,2/1.7/1.8/2.0
# 3.0	30/40/50/60	29/32/35/37	3.0/3.4/3.5/3.8
# 4.0	30/40/50/60	31/34/37/38	3.4/3.9/4.1/4.7
# 6.0	40/50/60/70	38/40/42/44	6.5/7.3/8.0/8.6

PUMP HEAD CALCULATIONS:
 OPERATING HEAD: 92.40'

OPERATING HEAD - A
 PRESSURE REGULATOR SHALL BE SET TO MAINTAIN A PRESSURE OF 40 PSI IN THE DRAINFIELD

FRICITION LOSS CALCULATIONS
 PH 1 EAST:
 TOTAL SYSTEM HEAD:
 PH 1 EAST: 104.20'
 PH 1 WEST: 118.64'

SUPPLY LINE NO.	LENGTH	PIPE DIAMETER	FLOW (GPM)	FITTINGS	HEAD LOSS
1	81.33'	1"	9.3	90° TEE	4.6'
2	64.50'	1"	6.2	TEE	1.7'
3	64.50'	1"	3.1	90°	0.5'
TOTAL	210.33'	N/A	N/A	N/A	6.8'

SUPPLY LINE NO.	LENGTH	PIPE DIAMETER	FLOW (GPM)	FITTINGS	HEAD LOSS
1	128.40'	1"	9.3	90° 2 x 45° TEE	7.1'
2	64.50'	1"	6.2	TEE	1.7'
3	64.50'	1"	3.1	90°	0.5'
TOTAL	257.40'	N/A	N/A	N/A	9.3'

OWNER GUIDANCE

- USE OF WATER SOFTENERS CAN DAMAGE SYSTEM COMPONENTS AND VOID SYSTEM WARRANTY
- ONLY FLUSH ITEMS INTENDED FOR SEPTIC USE
- USE OF GARAGE DISPOSALS IS PROHIBITED
- DISPOSAL OF GREASE INTO THE SYSTEM IS PROHIBITED
- KEEP THE SPRAY AREA FREE OF OBSTRUCTIONS
- KEEP DISPOSAL AREA MOVED AND IN GOOD OPERATING CONDITION
- IT IS RECOMMENDED TO PUMP THE PRETREATMENT TANK EVERY TWO TO THREE YEARS TO AVOID SOLID BUILD UP
- IT IS RECOMMENDED TO PUMP THE PRETREATMENT TANK EVERY TWO TO THREE YEARS TO AVOID SOLID BUILD UP
- THE OWNER IS RESPONSIBLE FOR MAINTAINING APPROPRIATE GROUND COVER IN THE DISPOSAL AREA INCLUDING OVERSEEDING WITH SEASONAL GRASSES DURING WINTER MONTHS
- IF ANY PROBLEMS PERSIST, CONTACT YOUR MAINTENANCE PROVIDER OR LICENSED CERTIFIED TECHNICIAN.

PUMP SELECTION CRITERIA:

PHASE 1 EAST:
 9.3 GPM AT 104.20' HEAD
 PHASE 1 WEST:
 9.3 GPM AT 118.64' HEAD

PUMP SELECTION:
 STA-RITE DOMINATOR
 MODEL NO: 20DDM05121 4"
 SUBMERSIBLE PUMP
 PUMP PERFORMANCE: 20 GPM

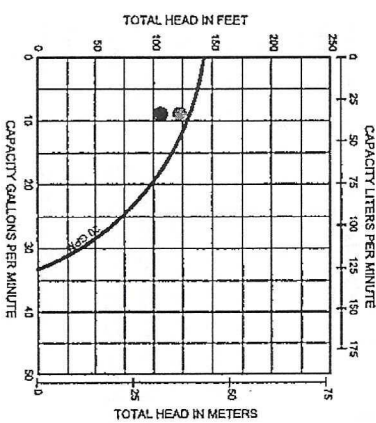

- PHASE 1 EAST
- PHASE 1 WEST

SERVICE AGREEMENT AND AFFIDAVIT

- MUST BE PROVIDED BY THE INSTALLER
- MUST MEET TCEQ REQUIREMENTS FOR TESTING
- REQUIREMENTS AND SAMPLE COLLECTION
- MUST MEET THE MINIMUM REQUIREMENTS REQUIRED BY TCEQ
- AND THE LOCAL PERMITTING AUTHORITY
- AN AFFIDAVIT DETAILING THE USE OF SURFACE SPRAY WASH BE FILED IN THE COUNTY CLERK'S OFFICE



HILL COUNTRY SEPTIC AND ENVIRONMENTAL, LLC
 432 WINDING HOLLOW LANE, GEORGETOWN, TEXAS 78628
 (512) 775-0338 hdarling@hcseptic.com

DESIGNED BY: HDARLING
 DATE: 08/15/2022
 ADDRESS: 820 OLD SAN ANTONIO RD

NOT TO SCALE

REVISIONS:
 08/30/2022

820 OLD SAN ANTONIO ROAD IN GILLESPIE COUNTY, TEXAS
ABS A0488 W O MERRIWETHER #36, 15.02 ACRES

CONSTRUCTION NOTES:

- ALL COMPONENTS MUST BE AT LEAST 10' FROM ANY WATER LINE, PRIVATE OR PUBLIC
- ALL COMPONENTS MUST BE AT LEAST 100' FROM ANY PRIVATE WATER WELL AND 150' FROM ANY PUBLIC WATER WELL
- PIPING FROM THE HOUSE TO THE TANK SHALL CONTAIN A TWO-WAY CLEANOUT AND LINE MUST HAVE POSITIVE GRADE AT OR EXCEEDING 1/8" PER FOOT TO THE TANK
- THE TANK SHALL BE SET LEVEL WITHIN 1"
- THE TANK SHALL BE PLACED ON 4" OF SAND OR PEA GRAVEL, FREE OF ROCK LARGER THAN PEA GRAVEL.
- TANK DEPTH SHALL NOT EXCEED 12" UNLESS A RISER IS INSTALLED ON EACH CLEANOUT AND EXTENDS TO WITHIN 8" OF THE GROUND SURFACE
- ALL ACCESS RISERS WILL HAVE A SECONDARY PLUG CAP OR OTHER SUITABLE RESTRAINT BELOW THE RISER CAP TO PREVENT TANK ENTRY IF THE CAP IS UNKNOWNLY DAMAGED OR REMOVED
- THE RISER LID MUST BE PERMANENTLY FASTENED TO THE TANK, BE WATER TIGHT AT THE LID AND INTERFACE, AND HAVE A PADLOCK OR COVER THAT REQUIRES TOOLS OR BE RECESSED WITH A MINIMUM WEIGHT OF 65 LBS
- THE ALARM SHALL BE WIRED ON A SEPARATE CIRCUIT FROM THE PUMP
- ALL PIPING AND VALVE BOXES MUST BE PERMANENTLY COLORED PURPLE TO SIGNIFY RECLAIMED WATER

AquaAire SEWAGE TREATMENT SYSTEM
AA800-00110 ONE PIECE WITH LID

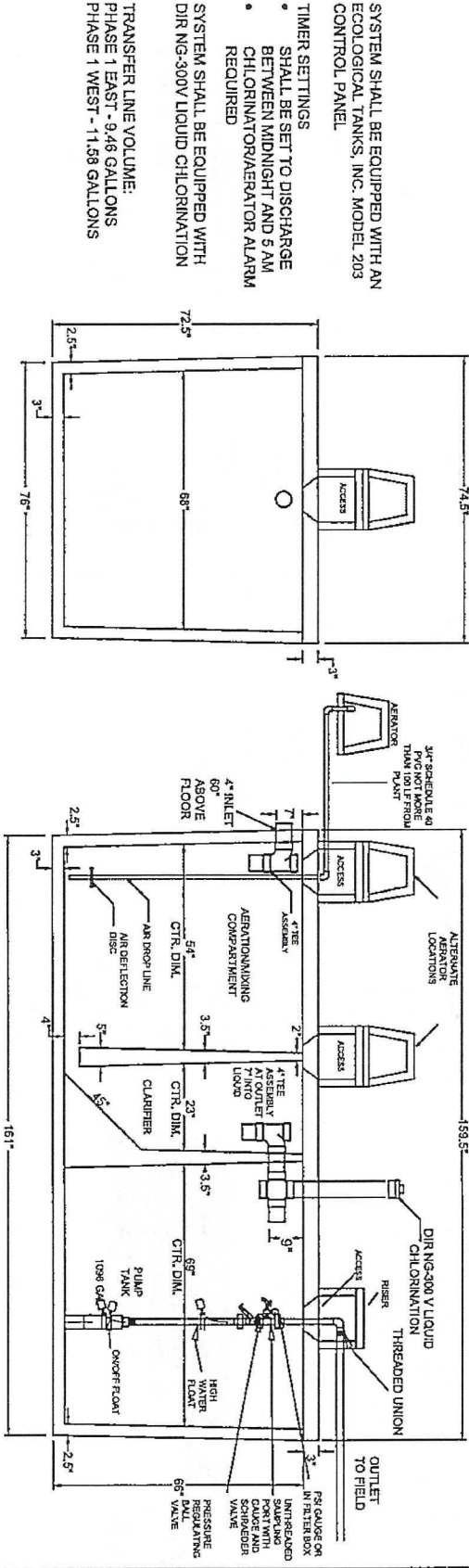

SYSTEM SHALL BE EQUIPPED WITH AN ECOLOGICAL TANKS, INC. MODEL 203 CONTROL PANEL

- TIMER SETTINGS**
- SHALL BE SET TO DISCHARGE BETWEEN MIDNIGHT AND 5 AM
 - CHLORINATOR/AERATOR ALARM REQUIRED

SYSTEM SHALL BE EQUIPPED WITH DIR NG-300V LIQUID CHLORINATION

TRANSFER LINE VOLUME:
 PHASE 1 EAST - 9,46 GALLONS
 PHASE 1 WEST - 11,58 GALLONS

18.27 GALLONS PER INCH (60.0" USABLE VOLUME)
 ALARM ON AT 46" ABOVE FLOOR (255.78 GALLONS ALARM VOLUME)
 START PUMP AT 9.0" ABOVE FLOOR (164.43 GALLONS)
 STOP PUMP AT 8.0" ABOVE FLOOR (146.16 GALLONS)

TOTAL DISCHARGE TIME
 • 600 GALLONS/9.3 GPM = 64.52 MINUTES



HILL COUNTRY SEPTIC AND ENVIRONMENTAL, LLC
 432 WINDING HOLLOW LANE, GEORGETOWN, TEXAS 78628
 (512) 775-0338 hdarling@hcseptic.com

DESIGNED BY: HDARLING
 DATE: 08/15/2022
 ADDRESS: 820 OLD SAN ANTONIO RD

NOT TO SCALE

REVISIONS:
 08/30/2022

820 OLD SAN ANTONIO ROAD IN GILLESPIE COUNTY, TEXAS
 ABS A0488 W O MERRIWETHER #36, 15.02 ACRES

E.O.

EQUALIZATION TANK SHALL BE EQUIPPED WITH AN R/R ALT-DT-LA CONTROL PANEL (OR EQUIVALENT)

- TIMER SETTINGS
 - SET TIME TO DELIVER TWENTY-FOUR EQUAL-DURATION DOSES LASTING 5 MINUTES EACH. EACH DOSE SHALL DELIVER 25 GALLONS. REST FOR 55 MINUTES.

TRANSFER LINE VOLUME: 8.68 GALLONS

- 60.34 GALLONS PER INCH (53.0" USABLE VOLUME)
- ALTERNATE PUMP ON AT 44" ABOVE FLOOR
- ALARM ON AT 43" ABOVE FLOOR (603.40 GALLONS ALARM VOLUME)
- PUMP ON AT 10.0" ABOVE FLOOR (603.40 GALLONS)

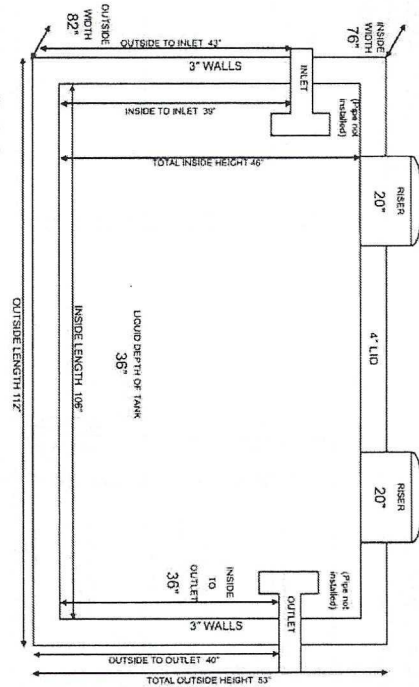

Buchanan Septic Tanks, Inc.
 P.O. Box 297 | 15648 Hwy. 29
 Buchanan Dam, TX 78609
 P: (512) 793-3100 | F: (512) 793-4047

1000 GALLON SINGLE COMPARTMENT
 LONG OVAL SEPTIC TANK
 27.77 GALLONS PER INCH

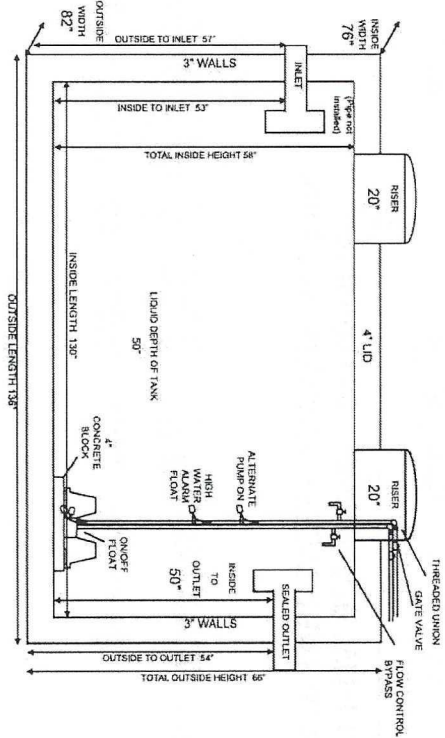

Buchanan Septic Tanks, Inc.
 P.O. Box 297 | 15648 Hwy. 29
 Buchanan Dam, TX 78609
 P: (512) 793-3100 | F: (512) 793-4047

1750 GALLON SINGLE COMPARTMENT
 LONG OVAL SEPTIC TANK
 33 GALLONS PER INCH

Liberty Pumps
 Pump Specifications
 LE40 Series
 4/10 HP Submersible Sewage Pump

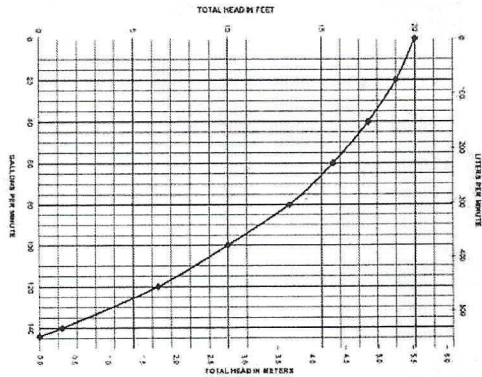

HILL COUNTRY SEPTIC AND ENVIRONMENTAL, LLC
 432 WINDING HOLLOW LANE, GEORGETOWN, TEXAS 78628
 (512) 775-0338 hdarling@hcseptic.com

DESIGNED BY: HDARLING
 DATE: 08/15/2022
 ADDRESS: 820 OLD SAN ANTONIO RD

NOT TO SCALE

REVISIONS:
 08/30/2022

OSSF Soil & Site Evaluation

Page ² (Soil & Site Evaluation)

Date Performed: 08/13/2022

Property Owner: Edwin H Vale Jr.

Site Location: 820 Old San Antonio Road Proposed Excavation Depth: _____

REQUIREMENTS: Fredericksburg, Texas 78624

At least two soil excavations must be performed on the site, at opposite ends of the proposed disposal area. Locations of soil borings or dug pits must be shown on the site drawing. For subsurface disposal, soil evaluations must be performed to a depth of at least two feet below the proposed disposal field excavation depth. For surface disposal, the surface horizon must be evaluated. Describe each soil horizon and identify any restrictive features on this form. Indicate depths where features appear.

Soil Boring Number: <u>2</u>					
Depth (Feet)	Texture Class	Gravel Analysis (If Applicable)	Drainage (Mottles/Water Table)	Restrictive Horizon	Observations
1 FT.	<u>Class III</u>	<u>Less than 30% Rock</u>	<u>None</u>	<u>None</u>	<u>Reddish Brown</u>
2 FT.					<u>Silty Clay Loam</u>
3 FT.					
4 FT.					
5 FT. <u>52"</u>					

Soil Boring Number: <u>3</u>					
Depth (Feet)	Texture Class	Gravel Analysis (If Applicable)	Drainage (Mottles/Water Table)	Restrictive Horizon	Observations
1 FT.	<u>Class III</u>	<u>Less than 30% Rock</u>	<u>None</u>	<u>None</u>	<u>Reddish Brown</u>
2 FT.					<u>Silty Clay Loam</u>
3 FT.					
4 FT.					
5 FT. <u>56"</u>					

FEATURES OF SITE AREA

Presence of 100 year flood zone Yes No
 Presence of upper water shed Yes No
 Presence of adjacent ponds, streams, water impoundments Yes No
 Existing or proposed water well in nearby area (within 150 feet) Yes No
 Ground Slope 4 1/2 %

I certify that the findings of this report are based on my field observations and are accurate to the best of my ability.

Chris A. Moreno
 (Signature of person performing evaluation)

08/13/2022
 (Date)

OS0037372 Site Evaluator
 Registration Number and Type

OSSF Soil & Site Evaluation

Page 1 (Soil & Site Evaluation)

Date Performed: 08/13/2022

Property Owner: Edwin H. Vale Jr.

Site Location: 820 Old San Antonio Road Proposed Excavation Depth: _____

REQUIREMENTS: Fredericksburg, Texas 78624

At least two soil excavations must be performed on the site, at opposite ends of the proposed disposal area. Locations of soil borings or dug pits must be shown on the site drawing. For subsurface disposal, soil evaluations must be performed to a depth of at least two feet below the proposed disposal field excavation depth. For surface disposal, the surface horizon must be evaluated. Describe each soil horizon and identify any restrictive features on this form. Indicate depths where features appear.

Soil Boring Number: <u>1</u>					
Depth (Feet)	Texture Class	Gravel Analysis (If Applicable)	Drainage (Mottles/Water Table)	Restrictive Horizon	Observations
1 FT.	<u>Class II</u>	<u>less than 3 1/2 %</u>	<u>None</u>	<u>None</u>	<u>Reddish/Brown</u>
2 FT.					<u>Silty Clay Loam</u>
3 FT.					
4 FT.					
<u>6.02'</u>					

Soil Boring Number: <u>N/A</u>					
Depth (Feet)	Texture Class	Gravel Analysis (If Applicable)	Drainage (Mottles/Water Table)	Restrictive Horizon	Observations
1 FT.					
2 FT.					
3 FT.					
4 FT.					
5 FT.					

FEATURES OF SITE AREA

Presence of 100 year flood zone Yes No
 Presence of upper water shed Yes No
 Presence of adjacent ponds, streams, water impoundments Yes No
 Existing or proposed water well in nearby area (within 150 feet) Yes No
 Ground Slope 4 1/2 %

I certify that the findings of this report are based on my field observations and are accurate to the best of my ability.

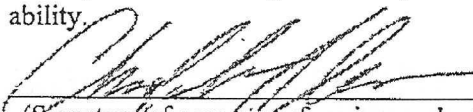
 (Signature of person performing evaluation)

08/13/2022
 (Date)

050037372 Site Evaluator
 Registration Number and Type

Site Location: 820 Old San Antonio Road
Fredericksburg, Texas 78624

Subsurface Disposal Surface Disposal

Schematic of Lot or Tract

Show:

- Compass North, adjacent streets, property lines, property dimensions, location of buildings, easements, swimming pools, water lines, and any other structures where known, all to scale.
- Location of existing or proposed water wells within 150 feet of the property.
- Indicate slope or provide contour lines from the structure to the farthest location of the proposed disposal field.
- Location of soil boring or excavation pits (show location with respect to a known reference point).
- Location of natural, constructed, or proposed drainage ways (ditches, streams, ponds, lakes, rivers, etc.), water impoundment areas, cut or fill bank, sharp slopes and breaks.

Lot Size: _____ or Acreage: 15.02
SITE DRAWING

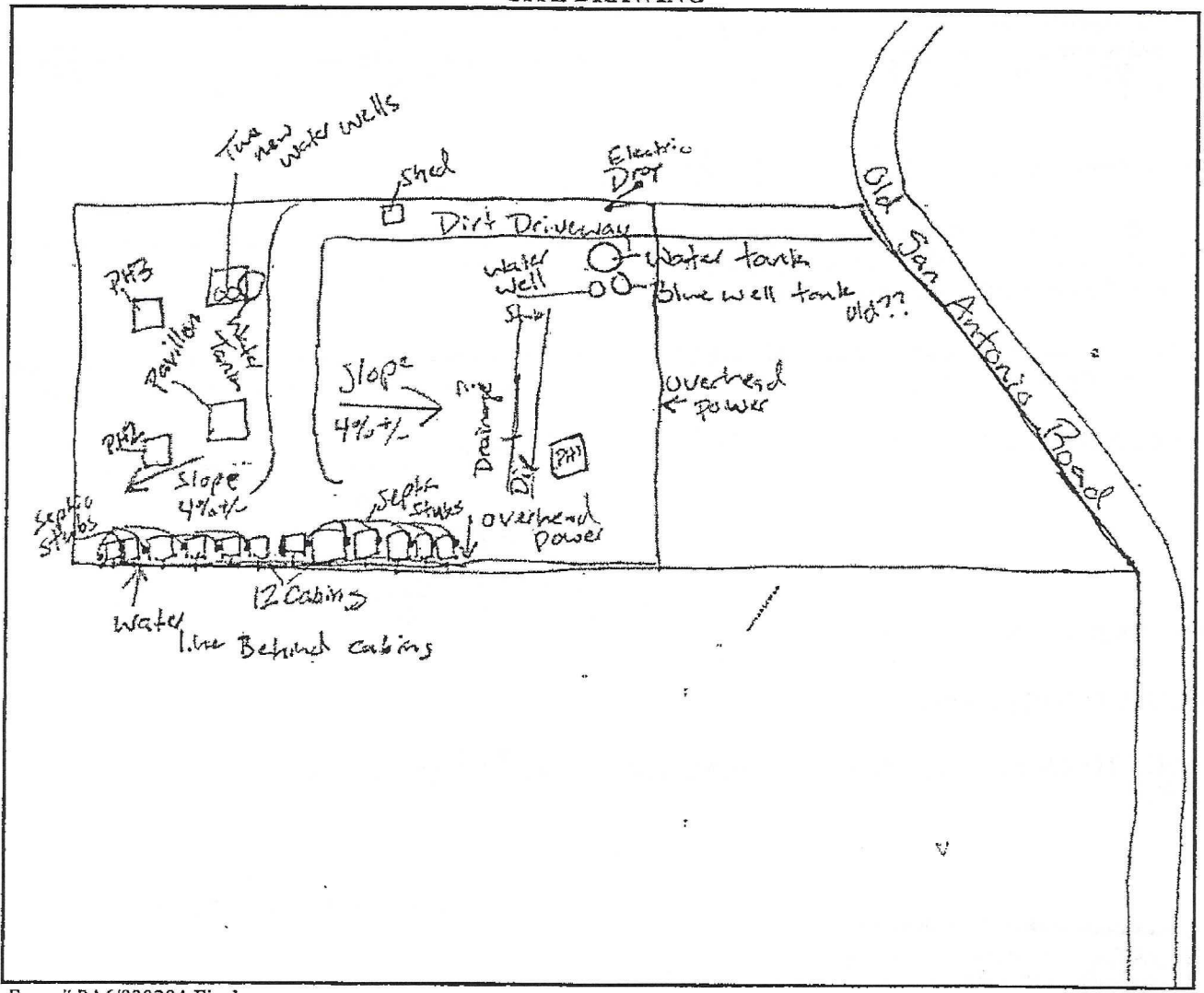



Edwin H. Vale Jr.
Legibly Print Landowner Name

TO THE PUBLIC

COUNTY OF GILLESPIE

AFFIDAVIT

§

COPY

THE STATE OF TEXAS

§

CERTIFICATION OF ON-SITE SEWAGE FACILITY REQUIRING MAINTENANCE

According to Texas Commission on Environmental Quality (TCEQ) Rules for On-Site Sewage Facilities, this document is filed in the Deed Records of Gillespie County, Texas.

I

The Texas Health and Safety Code, Chapter 366 authorizes the Texas Commission on Environmental Quality (TCEQ) to regulate On-Site Sewage Facilities (OSSFs). Additionally, the Texas Water Code (TWC), § 5.012 and §5.013, gives the Commission primary responsibility for implementing the laws of the State of Texas relating to water and adopting rules necessary to carry out its powers and duties under the TWC. The Commission, under the authority of the TWC and the Texas Health and Safety Code, requires owner(s) to provide notice to the public that certain types of OSSFs are located on specific pieces of property. To achieve this notice, the Commission requires a deed recording. Additionally, the owner must provide proof of the recording to the OSSF permitting authority. This recorded affidavit is not a representation or warranty by the Commission of the suitability of this OSSF, nor does it constitute any guarantee by the Commission that the appropriate OSSF was installed.

II

An OSSF requiring a maintenance contract, according to 30 Texas Administrative Code § 285.91 (12) will be installed on the property described as: (Attached Legal Description Exhibits). Or Subdivision Name ABS A-0488 w/o Merriwether
Lot # 820 Old San Antonio Rd # 36, 15.02 acres

The property is owned by: Edwin H. Vale Jr.

This OSSF shall be covered by a continuous service policy for the first two years. After the initial two-year service policy, the owner of an aerobic treatment system for a single-family residence shall either obtain a maintenance contract within 30 days or maintain the system personally.

Upon sale or transfer of the above-described property, the permit for the OSSF shall be transferred to the buyer or new owner. A copy of the planning materials for the OSSF can be obtained from the Gillespie County Sanitation Department.

WITNESSED BY MY HAND ON THIS 15th DAY OF August, 2022.

[Signature]
(Owner(s) Signature(s))

THE STATE OF TEXAS §

COUNTY OF GILLESPIE §

SWORN TO AND SUBSCRIBED BEFORE ME ON THIS 15th DAY OF August, 2022.

[Signature]
Notary Public in and for the State of Texas

