

300 SCHERMERHORN STREET

BETWEEN BOND & NEVINS STREETS | BOERUM HILL



300 SCHERMERHORN STREET

BETWEEN BOND & NEVINS STREETS | BOERUM HILL

PROPERTY DETAILS

SIZE: 6,000 SF Cellar

CEILING HEIGHT: 12'

POSSESSION: Arranged

ASKING RENT: Upon Request

TRANSPORTATION: 2 3 4 5 N Q R B D

HIGHLIGHTS

- Seeking full service spas
- Space includes: sauna, steam rooms, pool
- Situated at the base of a 245 room luxury hotel
- On-site parking garage
- Landlord to install seperate designated entrance
- Across the street from Chelsea Piers gym
- High foot traffic area in dense residential neighborhood
- Neighboring tenants include:
Whole Foods, Ace Hotel, Wonder, CityMD, Blick, Barclay's Center, Snipes, Burger King, Dunkin, Removery, & many more!



All information supplied in this marketing presentation and/or flyer is from sources deemed reliable and is furnished subject to errors, omissions, modifications, removal of listings from sale/lease and to any listing condition. Any square footage, dimensions, floor plans and/or technical data set forth are approximations and are subject to further elaboration/confirmation.



300 SCHERMERHORN STREET

BETWEEN BOND & NEVINS STREETS | BOERUM HILL

INTERIOR RENDERINGS:



300 SCHERMERHORN STREET

BETWEEN BOND & NEVINS STREETS | BOERUM HILL

INTERIORS:



300 SCHERMERHORN STREET

BETWEEN BOND & NEVINS STREETS | BOERUM HILL

FLOOR PLANS:
CELLAR - 6,000 SF

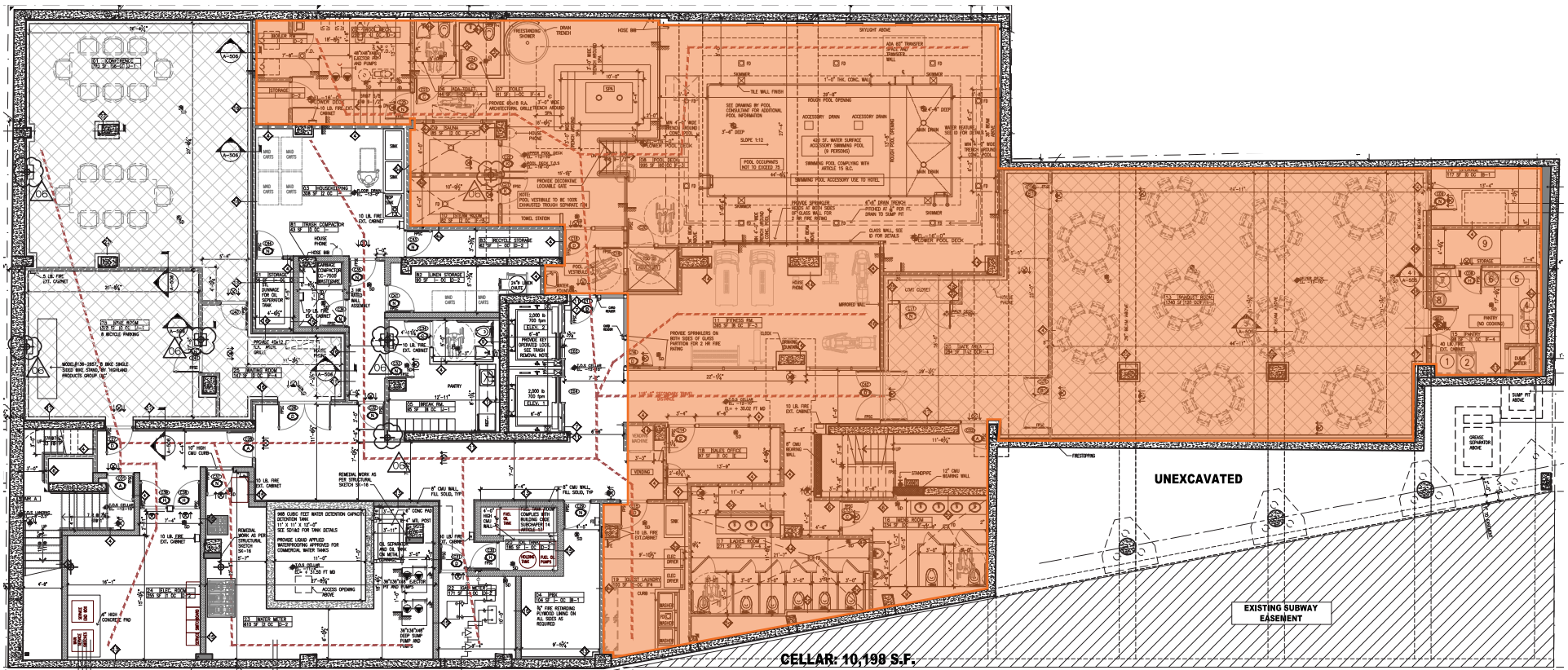

300 SCHERMERHORN STREET

BETWEEN BOND & NEVINS STREETS | BOERUM HILL

FOR MORE INFORMATION,
PLEASE CONTACT:

NOLAN WEINBERG

516.581.0203 | NWeinberg@ksrny.com

JEFF GEOGHEGAN

212.945.8984 | JeffG@ksrny.com



All information supplied in this marketing presentation and/or flyer is from sources deemed reliable and is furnished subject to errors, omissions, modifications, removal of listings from sale/lease and to any listing condition. Any square footage, dimensions, floor plans and/or technical data set forth are approximations and are subject to further elaboration/confirmation.