



PROPERTY DESCRIPTION

19,768 SF stand-alone single or multi-tenant building
Ability to Subdivide

PROPERTY HIGHLIGHTS

- Built in 2016
- Easy access to I-40/I-440/US-1/US-64
- Class A finishes
- Eco-friendly building
- 4.4/1000 parking
- Dimmable, LED lighting throughout
- State-of-the-Art 19-zone Daikin Variable Refrigerant Flow (VRV) HVAC
- Extensive Soundproofing (insulated offices and acoustic ceiling tiles throughout)
- 10' - 11' ceilings throughout
- Perforated roller shades throughout
- Modern breakroom with café and built-in seating
- Redundant AC units for server room
- Available signage visible from Cary Parkway
- Pre-wired and plumbed for easy conversion to medical use

Moss Withers, SIOR, MBA
mwithers@lee-associates.com
O: 919.576.2501
C: 919.810.2492

Karah Jennings McConnell
kjennings@lee-associates.com
O: 919.576.2502
C: 919.817.0705

All information furnished regarding property for sale, rental or financing is from sources deemed reliable, but no warranty or representation is made to the accuracy thereof and same is submitted to errors, omissions, change of price, rental or other conditions prior to sale, lease or financing or withdrawal without notice. No liability of any kind is to be imposed on the broker herein.

LOCATION DESCRIPTION

Office Building in Cary, North Carolina. Located at the intersection of Cary Parkway and US 1/Hwy. 64

OFFERING SUMMARY

Lease Rate:	\$29.50 SF/yr (Full Service)
Available SF:	4,768 RSF to 19,769 RSF
Building Size:	19,768 SF

Subdivision Option 1

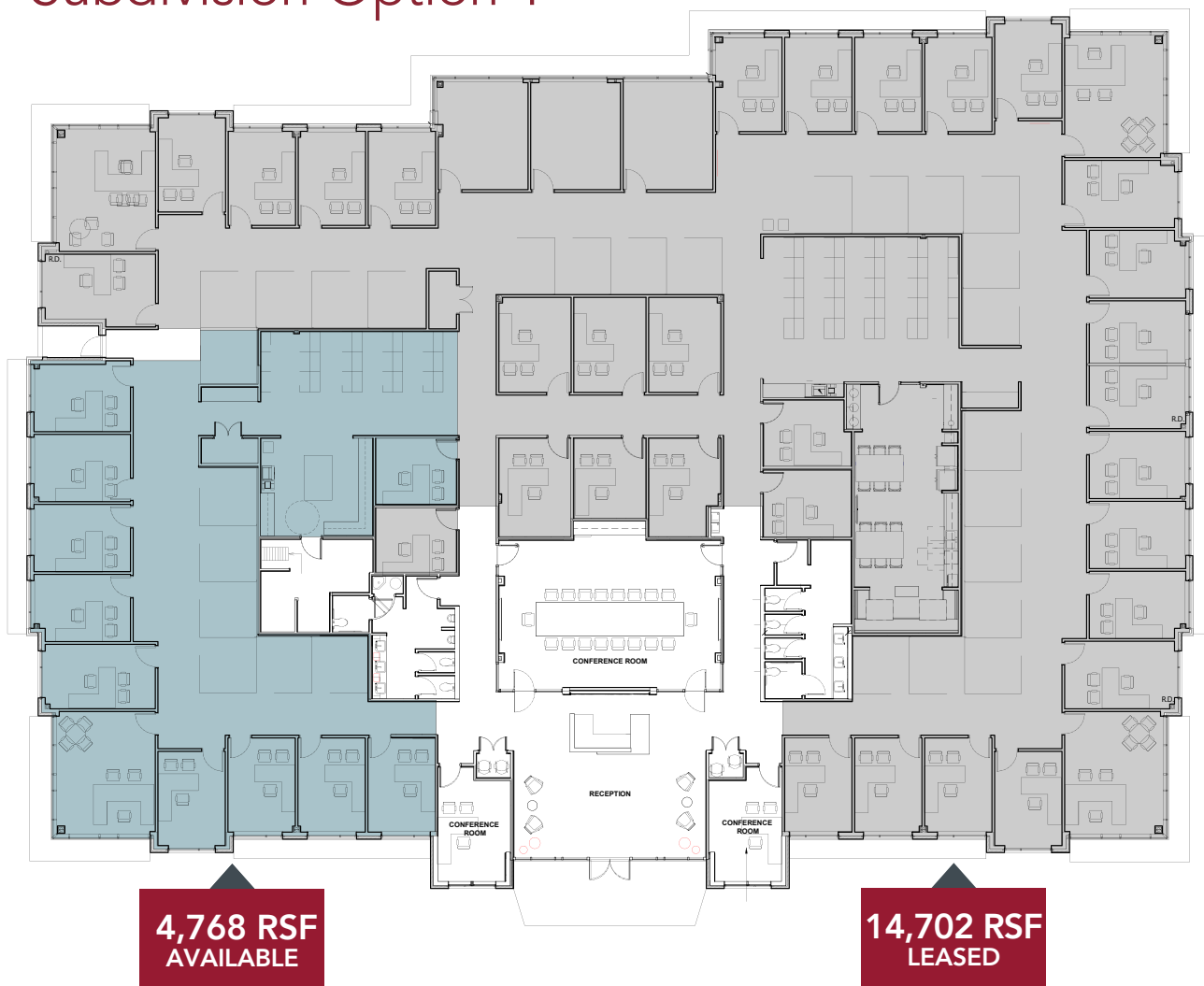

- If subdivided to a multi-tenant building:
 - Conference will be shared work space
 - Reception and restrooms will be shared common area
 - Depending on interior offices needed, suite size will range from 4,768 RSF to 6,360 RSF

Moss Withers, SIOR, MBA
mwithers@lee-associates.com
O: 919.576.2501
C: 919.810.2492

Karah Jennings McConnell
kjennings@lee-associates.com
O: 919.576.2502
C: 919.817.0705

All information furnished regarding property for sale, rental or financing is from sources deemed reliable, but no warranty or representation is made to the accuracy thereof and same is submitted to errors, omissions, change of price, rental or other conditions prior to sale, lease or financing or withdrawal without notice. No liability of any kind is to be imposed on the broker herein.

Subdivision Option 2

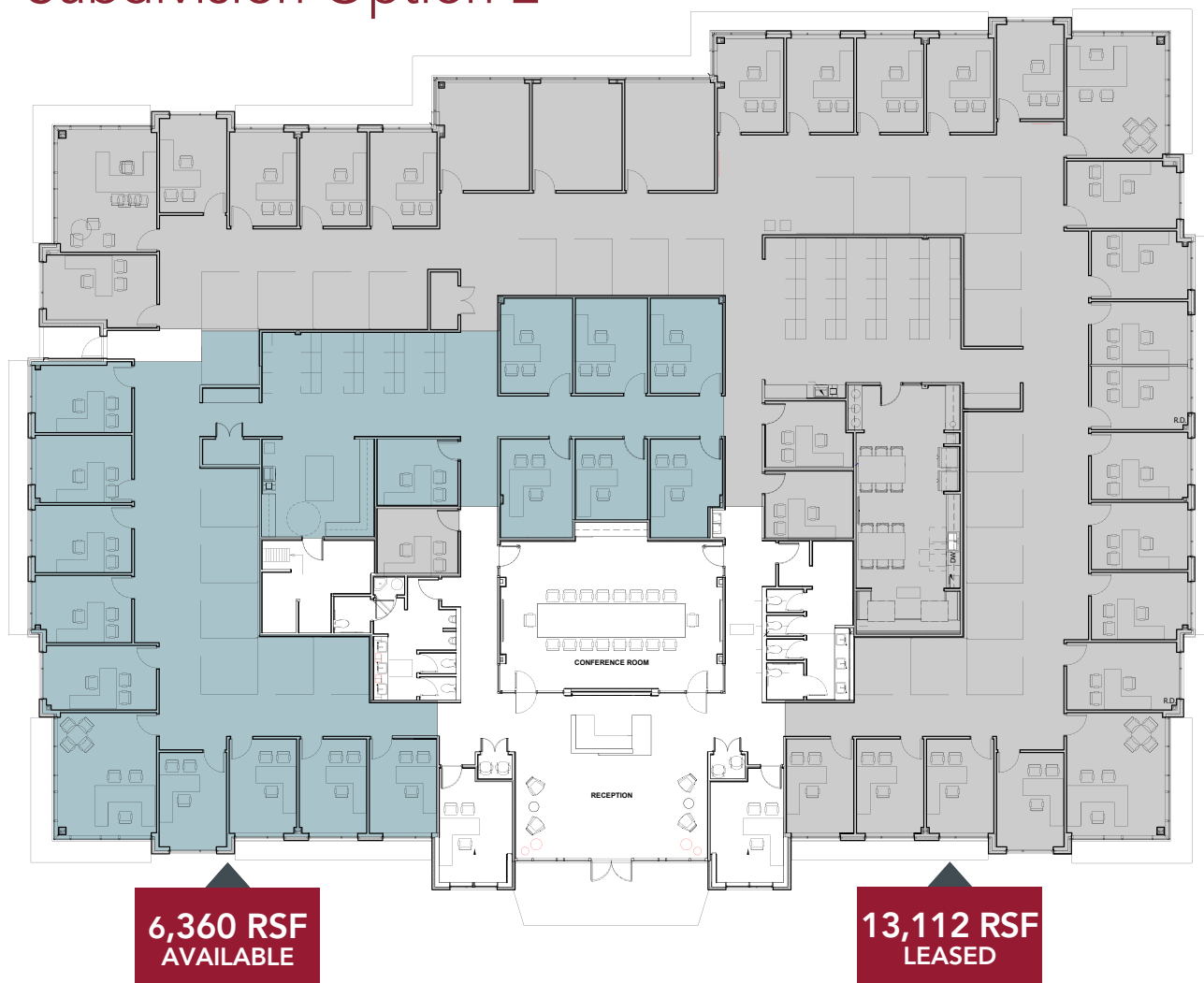

- If subdivided to a multi-tenant building:
 - Conference will be shared work space
 - Reception and restrooms will be shared common area
 - Depending on interior offices needed, suite size will range from 4,768 RSF to 6,360 RSF

Moss Withers, SIOR, MBA
mwithers@lee-associates.com
O: 919.576.2501
C: 919.810.2492

Karah Jennings McConnell
kjennings@lee-associates.com
O: 919.576.2502
C: 919.817.0705

All information furnished regarding property for sale, rental or financing is from sources deemed reliable, but no warranty or representation is made to the accuracy thereof and same is submitted to errors, omissions, change of price, rental or other conditions prior to sale, lease or financing or withdrawal without notice. No liability of any kind is to be imposed on the broker herein.

OFFICE FOR LEASE
106 PINEDALE SPRINGS WAY
Cary, NC 27511



Moss Withers, SIOR, MBA
mwithers@lee-associates.com
O: 919.576.2501
C: 919.810.2492

Karah Jennings McConnell
kjennings@lee-associates.com
O: 919.576.2502
C: 919.817.0705

All information furnished regarding property for sale, rental or financing is from sources deemed reliable, but no warranty or representation is made to the accuracy thereof and same is submitted to errors, omissions, change of price, rental or other conditions prior to sale, lease or financing or withdrawal without notice. No liability of any kind is to be imposed on the broker herein.

OFFICE FOR LEASE
106 PINEDALE SPRINGS WAY
Cary, NC 27511



Moss Withers, SIOR, MBA
mwithers@lee-associates.com
O: 919.576.2501
C: 919.810.2492

Karah Jennings McConnell
kjennings@lee-associates.com
O: 919.576.2502
C: 919.817.0705

All information furnished regarding property for sale, rental or financing is from sources deemed reliable, but no warranty or representation is made to the accuracy thereof and same is submitted to errors, omissions, change of price, rental or other conditions prior to sale, lease or financing or withdrawal without notice. No liability of any kind is to be imposed on the broker herein.

OFFICE FOR LEASE
106 PINEDALE SPRINGS WAY
Cary, NC 27511



Moss Withers, SIOR, MBA
mwithers@lee-associates.com
O: 919.576.2501
C: 919.810.2492

Karah Jennings McConnell
kjennings@lee-associates.com
O: 919.576.2502
C: 919.817.0705

All information furnished regarding property for sale, rental or financing is from sources deemed reliable, but no warranty or representation is made to the accuracy thereof and same is submitted to errors, omissions, change of price, rental or other conditions prior to sale, lease or financing or withdrawal without notice. No liability of any kind is to be imposed on the broker herein.

OFFICE FOR LEASE
106 PINEDALE SPRINGS WAY
Cary, NC 27511



Moss Withers, SIOR, MBA
mwithers@lee-associates.com
O: 919.576.2501
C: 919.810.2492

Karah Jennings McConnell
kjennings@lee-associates.com
O: 919.576.2502
C: 919.817.0705

All information furnished regarding property for sale, rental or financing is from sources deemed reliable, but no warranty or representation is made to the accuracy thereof and same is submitted to errors, omissions, change of price, rental or other conditions prior to sale, lease or financing or withdrawal without notice. No liability of any kind is to be imposed on the broker herein.

6/24/2018 12:00am - 6/25/2018 12:00am

Summary for time-period shown in graph

Energy Used	467 kWh	(approx. \$32.24 used)
Energy Generated	697 kWh	(approx. \$48.07 saved)
Net	229 kWh sold	(approx. \$15.83 earned)

Summary between 11/23/2016 3:13pm and now

Energy Used	496 MWh	(approx. \$34,249.45 used)
Energy Generated	358 MWh	(approx. \$24,717.30 saved)
Net	138 MWh bought	(approx. \$9,532.16 spent)

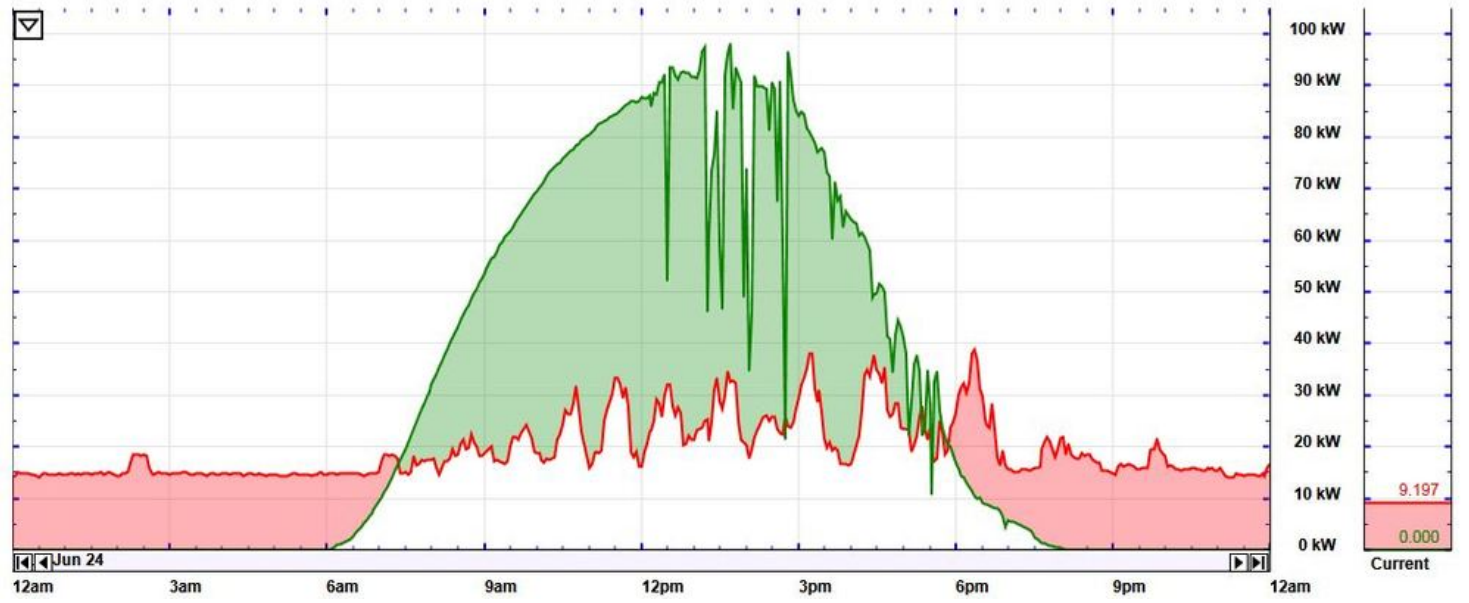

Moss Withers, SIOR, MBA
 mwithers@lee-associates.com
 O: 919.576.2501
 C: 919.810.2492

Karah Jennings McConnell
 kjennings@lee-associates.com
 O: 919.576.2502
 C: 919.817.0705

All information furnished regarding property for sale, rental or financing is from sources deemed reliable, but no warranty or representation is made to the accuracy thereof and same is submitted to errors, omissions, change of price, rental or other conditions prior to sale, lease or financing or withdrawal without notice. No liability of any kind is to be imposed on the broker herein.

OFFICE FOR LEASE
106 PINEDALE SPRINGS WAY
 Cary, NC 27511



Moss Withers, SIOR, MBA
 mwithers@lee-associates.com
 O: 919.576.2501
 C: 919.810.2492

Karah Jennings McConnell
 kjennings@lee-associates.com
 O: 919.576.2502
 C: 919.817.0705

All information furnished regarding property for sale, rental or financing is from sources deemed reliable, but no warranty or representation is made to the accuracy thereof and same is submitted to errors, omissions, change of price, rental or other conditions prior to sale, lease or financing or withdrawal without notice. No liability of any kind is to be imposed on the broker herein.

OFFICE FOR LEASE
106 PINEDALE SPRINGS WAY
 Cary, NC 27511



POPULATION

	1 MILE	3 MILES	5 MILES
Total population	7,339	64,975	149,192
Median age	43.1	38.7	36.4
Median age (Male)	41.3	37.1	35.6
Median age (Female)	45.2	40.1	37.0

HOUSEHOLDS & INCOME

	1 MILE	3 MILES	5 MILES
Total households	2,864	25,513	58,412
# of persons per HH	2.6	2.5	2.6
Average HH income	\$108,411	\$101,768	\$95,094
Average house value	\$278,774	\$330,690	\$316,806

* Demographic data derived from 2010 US Census

Moss Withers, SIOR, MBA
 mwithers@lee-associates.com
 O: 919.576.2501
 C: 919.810.2492

Karah Jennings McConnell
 kjennings@lee-associates.com
 O: 919.576.2502
 C: 919.817.0705

All information furnished regarding property for sale, rental or financing is from sources deemed reliable, but no warranty or representation is made to the accuracy thereof and same is submitted to errors, omissions, change of price, rental or other conditions prior to sale, lease or financing or withdrawal without notice. No liability of any kind is to be imposed on the broker herein.