

**2602 GENOA RED BLUFF | HOUSTON, TX 77034**

±88,609 SF AVAILABLE FOR LEASE



Shell complete now - Spec office under construction

**ROBERT MCGEE, SIOR** | *Principal* | [rmcgee@lee-associates.com](mailto:rmcgee@lee-associates.com) | C 713.410.9931

**TAYLOR SCHMIDT, SIOR, CCIM** | *Principal* | [tschmidt@lee-associates.com](mailto:tschmidt@lee-associates.com) | C 832.496.6518

**AUSTIN BARTULA** | *Associate* | [abartula@lee-associates.com](mailto:abartula@lee-associates.com) | C 713.818.6173

**ADKISSON GROUP**  
▪ DEVELOPMENT ▪

## PROPERTY OVERVIEW

- ±145,842 SF total
- ±88,609 SF available to occupy
- 2,631 SF spec office under construction now
- ±36' clear height
- Twenty (20) 9' X 10' dock-high doors
- One (1) 12' X 14' ramps/drive-up doors
- 26 trailer parking spaces
- 39 auto parking spaces
- 130' truck court
- ESFR sprinkler system
- 3-phase power / 1,000 amps
- 2.686337% tax rate
- Not located in floodplain
- Call brokers for pricing



**ROBERT MCGEE, SIOR** | *Principal* | rmcgee@lee-associates.com | C 713.410.9931  
**TAYLOR SCHMIDT, SIOR, CCIM** | *Principal* | tschmidt@lee-associates.com | C 832.496.6518  
**AUSTIN BARTULA** | *Associate* | abartula@lee-associates.com | C 713.818.6173

**ADKISSON GROUP**  
▪ DEVELOPMENT ▪

# SITE PLAN

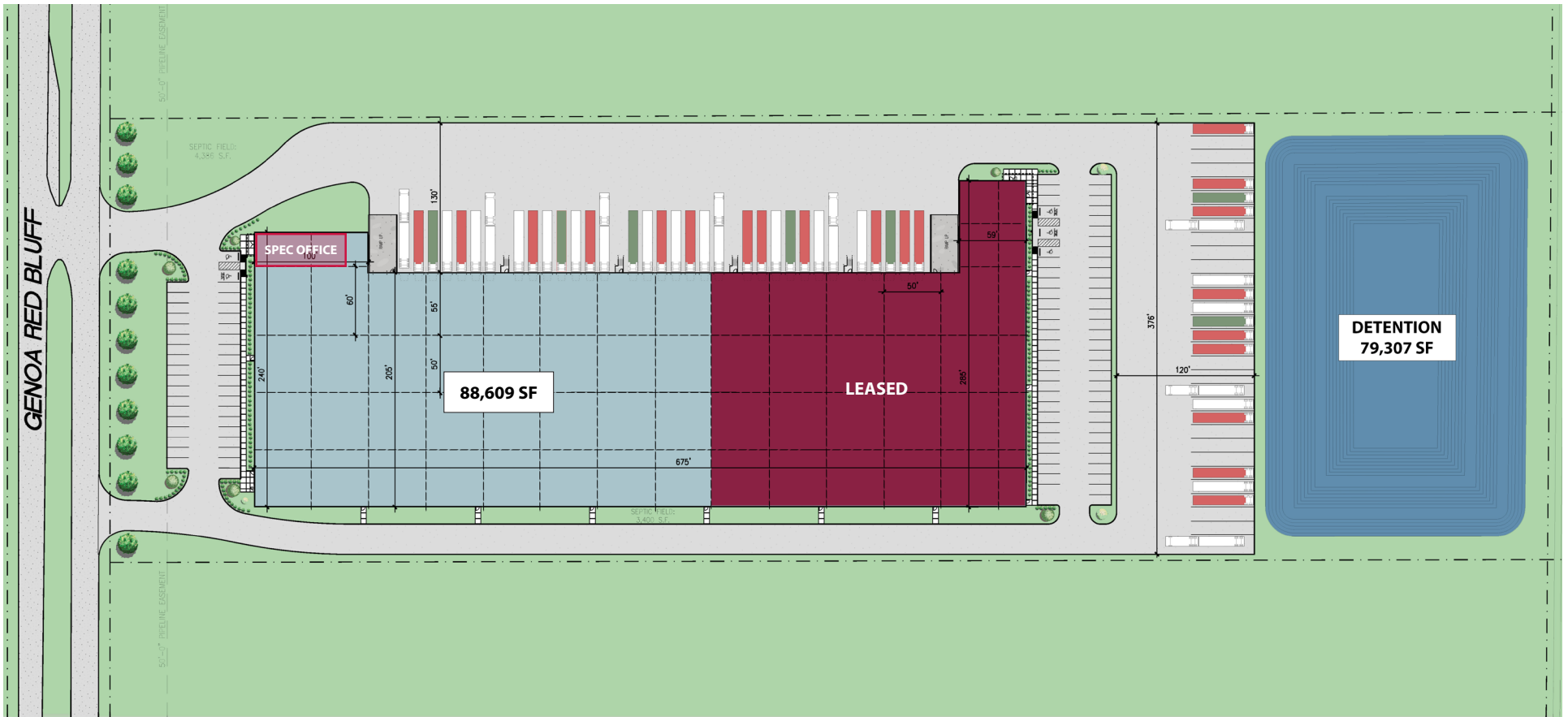

ROBERT MCGEE, SIOR | *Principal* | rmcgee@lee-associates.com | C 713.410.9931  
TAYLOR SCHMIDT, SIOR, CCIM | *Principal* | tschmidt@lee-associates.com | C 832.496.6518  
AUSTIN BARTULA | *Associate* | abartula@lee-associates.com | C 713.818.6173

**ADKISSON GROUP**  
DEVELOPMENT

# SPEC OFFICE PLAN

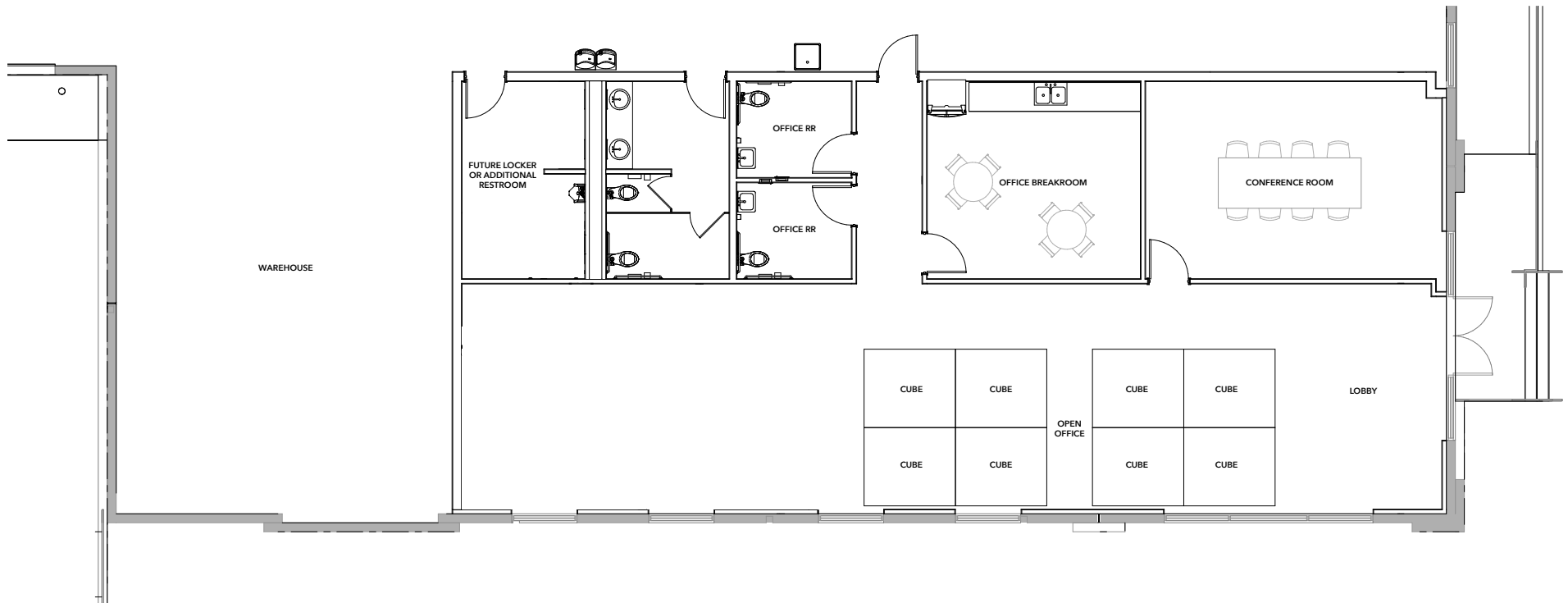

**ROBERT MCGEE, SIOR** | *Principal* | rmcgee@lee-associates.com | C 713.410.9931  
**TAYLOR SCHMIDT, SIOR, CCIM** | *Principal* | tschmidt@lee-associates.com | C 832.496.6518  
**AUSTIN BARTULA** | *Associate* | abartula@lee-associates.com | C 713.818.6173

**ADKISSON GROUP**  
DEVELOPMENT

# CORPORATE NEIGHBORS



ROBERT MCGEE, SIOR | *Principal* | rmcgee@lee-associates.com | C 713.410.9931  
TAYLOR SCHMIDT, SIOR, CCIM | *Principal* | tschmidt@lee-associates.com | C 832.496.6518  
AUSTIN BARTULA | *Associate* | abartula@lee-associates.com | C 713.818.6173

**ADKISSON GROUP**  
DEVELOPMENT

# TRUCK ROUTES

DESIGNATED HEAVY HAUL TRUCK ROUTES DIRECTLY TO PORT TERMINALS

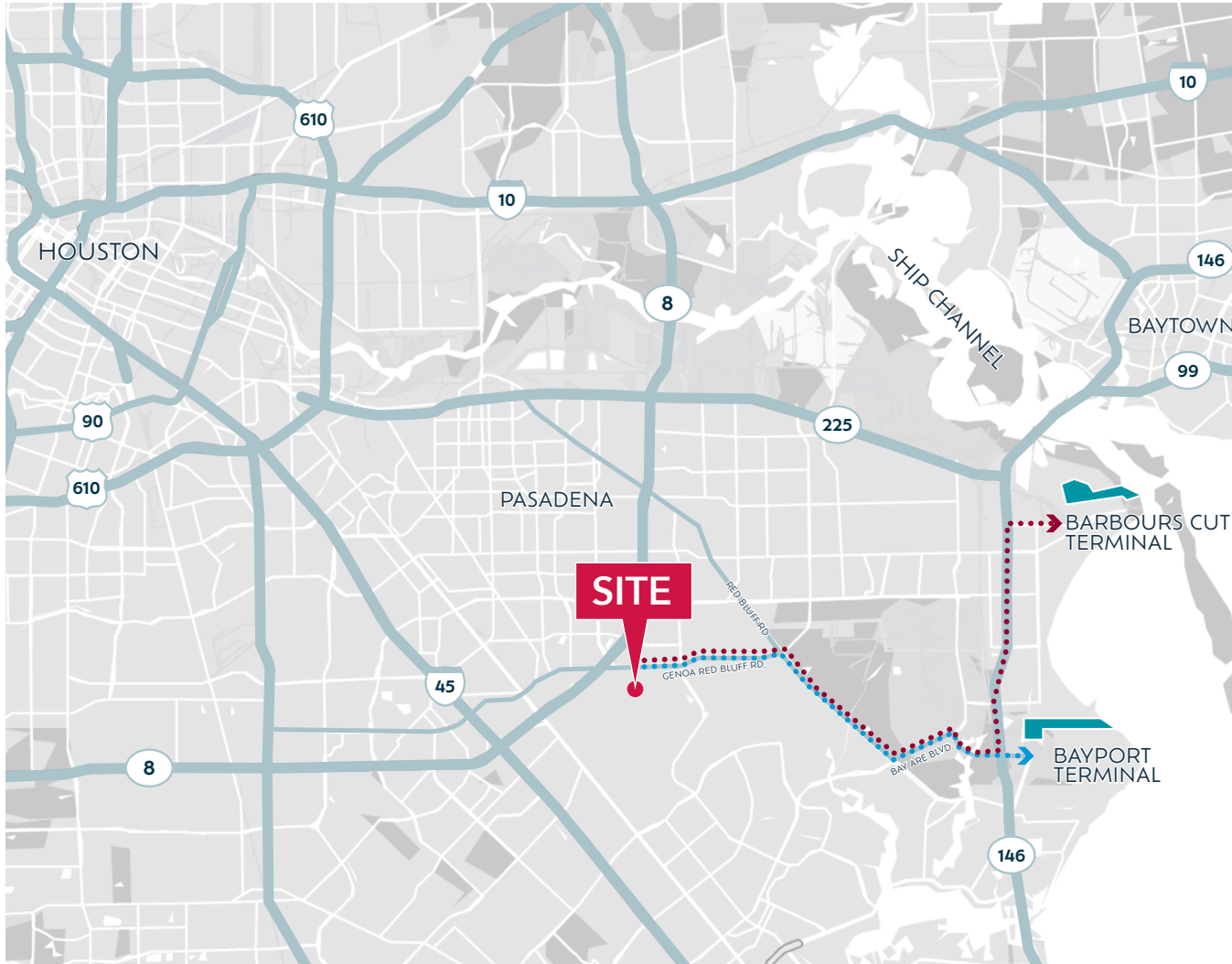

**From 2602 Genoa Red Bluff to Bayport Terminal**

(Via Red Bluff Rd. and Port Rd.)

11 MILES

21 MINUTES

**From 2602 Genoa Red Bluff to Barbours Cut Terminal**

(Via Genoa Red Bluff Rd. and W. Fairmont Pkwy.)

15 MILES

26 MINUTES

ROBERT MCGEE, SIOR | *Principal* | rmcgee@lee-associates.com | C 713.410.9931  
TAYLOR SCHMIDT, SIOR, CCIM | *Principal* | tschmidt@lee-associates.com | C 832.496.6518  
AUSTIN BARTULA | *Associate* | abartula@lee-associates.com | C 713.818.6173

**ADKISSON GROUP**  
DEVELOPMENT