



3614 Burnet Ave
East Syracuse, NY 13057

Industrial Building for Sale



Property Information

This industrial building is currently home to a commercial and residential renovation company. The building is equipped with three overhead doors and 16' ceilings in the warehouse side, and multiple offices/kitchenette on the office side. The .64 acre lot includes about 15 parking spaces.

Facts and Features

- 14,260 SF Building
- 15 Parking spaces
- Tax ID's: 010.-07-09.1; 010.-07-01.1; and 010.-07-02.1
- Built in 1957
- Three (3) overhead doors, 15' x 12', 12' x 10' and 12' x 8'
- .64 Acre Lot

Exclusive Agent:

Matt Funicello
Real Estate Salesperson

Office: 315-472-2020 ext. 105
Cell: 315-430-1827
Email: mattf@jfrealestate.com



Disclaimer: JF Real Estate has obtained the information above from sources we believe to be reliable. However, we have not verified its accuracy and make no guarantee, warranty, or representation about it. It is submitted subject to the possibility of errors, omissions, change of price, rental or other conditions, prior sale, lease or financing, or withdrawal without notice. We include projections, opinions, assumptions or estimates for example only, and they may not represent current or future performance of the property. You and your tax and legal advisors should conduct your own investigation of the property and transaction.

JF Real Estate
The Atrium
2 Clinton Square, Suite 120
Syracuse, NY 13202





Disclaimer: JF Real Estate has obtained the information above from sources we believe to be reliable. However, we have not verified its accuracy and make no guarantee, warranty, or representation about it. It is submitted subject to the possibility of errors, omissions, change of price, rental or other conditions, prior sale, lease or financing, or withdrawal without notice. We include projections, opinions, assumptions or estimates for example only, and they may not represent current or future performance of the property. You and your tax and legal advisors should conduct your own investigation of the property and transaction.

JF Real Estate
The Atrium
2 Clinton Square, Suite 120
Syracuse, NY 13202





Disclaimer: JF Real Estate has obtained the information above from sources we believe to be reliable. However, we have not verified its accuracy and make no guarantee, warranty, or representation about it. It is submitted subject to the possibility of errors, omissions, change of price, rental or other conditions, prior sale, lease or financing, or withdrawal without notice. We include projections, opinions, assumptions or estimates for example only, and they may not represent current or future performance of the property. You and your tax and legal advisors should conduct your own investigation of the property and transaction.

JF Real Estate
The Atrium
2 Clinton Square, Suite 120
Syracuse, NY 13202



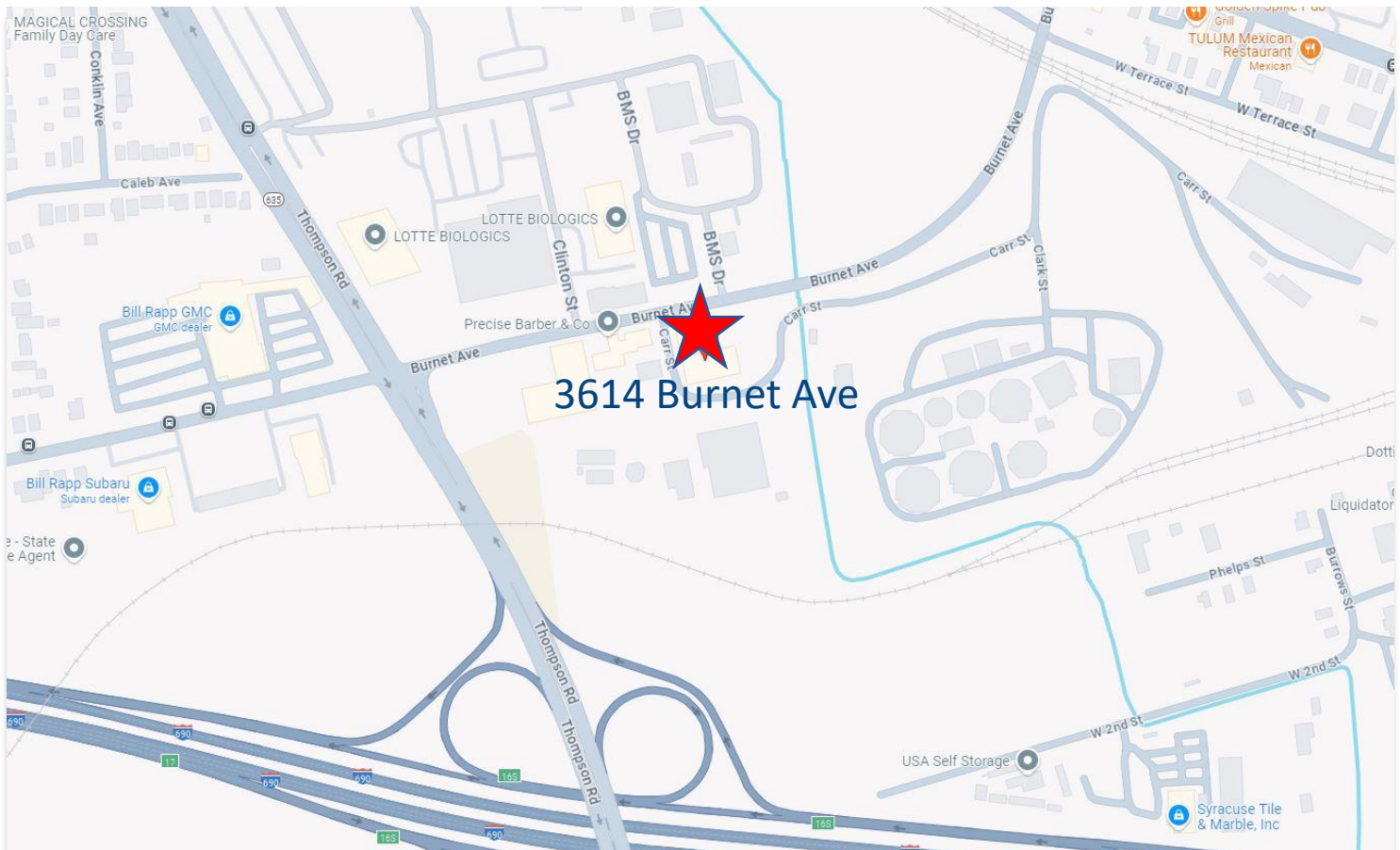
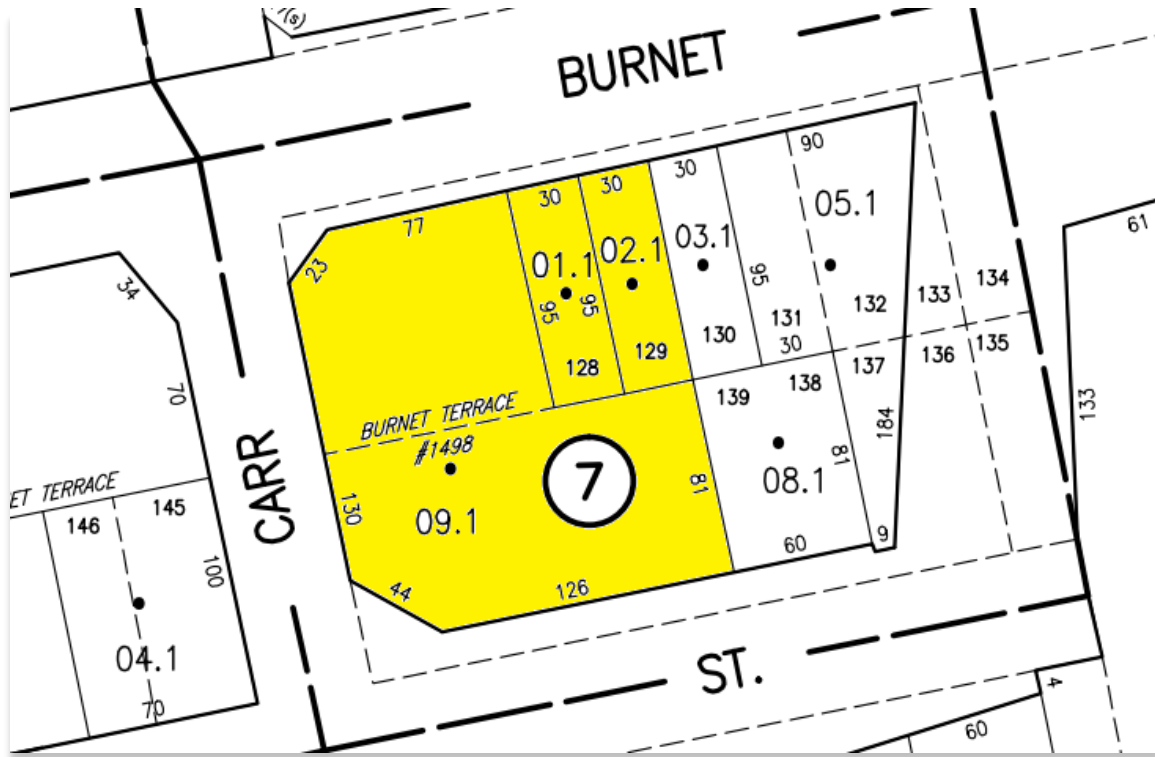

Disclaimer: JF Real Estate has obtained the information above from sources we believe to be reliable. However, we have not verified its accuracy and make no guarantee, warranty, or representation about it. It is submitted subject to the possibility of errors, omissions, change of price, rental or other conditions, prior sale, lease or financing, or withdrawal without notice. We include projections, opinions, assumptions or estimates for example only, and they may not represent current or future performance of the property. You and your tax and legal advisors should conduct your own investigation of the property and transaction.

JF Real Estate
The Atrium
2 Clinton Square, Suite 120
Syracuse, NY 13202

