



 **JLL** SEE A BRIGHTER WAY

For Sublease

±75,354 SF Available for Sublease in East Houston

8000 Market St | Houston, TX 77029

Sublease Features

- **Total Size:** ±75,354 SF
- **Office:** 2,215 SF
- **Warehouse:** 73,139 SF
- 19 Dock High Doors
- 1 Loading Ramp
- 100% Sprinklered
- 22' Clear Height
- Security Lighting / Fenced
- Infill Location with Excellent Access to I-10 and 610 Loop
- **Lease Expiration: 10/31/2029**
- **Available within 30 days**
- **Contact broker for lease rate**

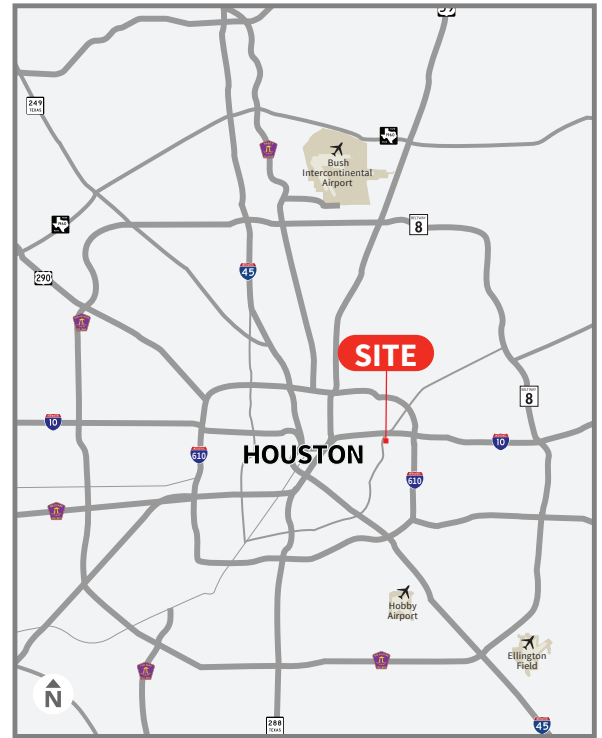

Site Plan

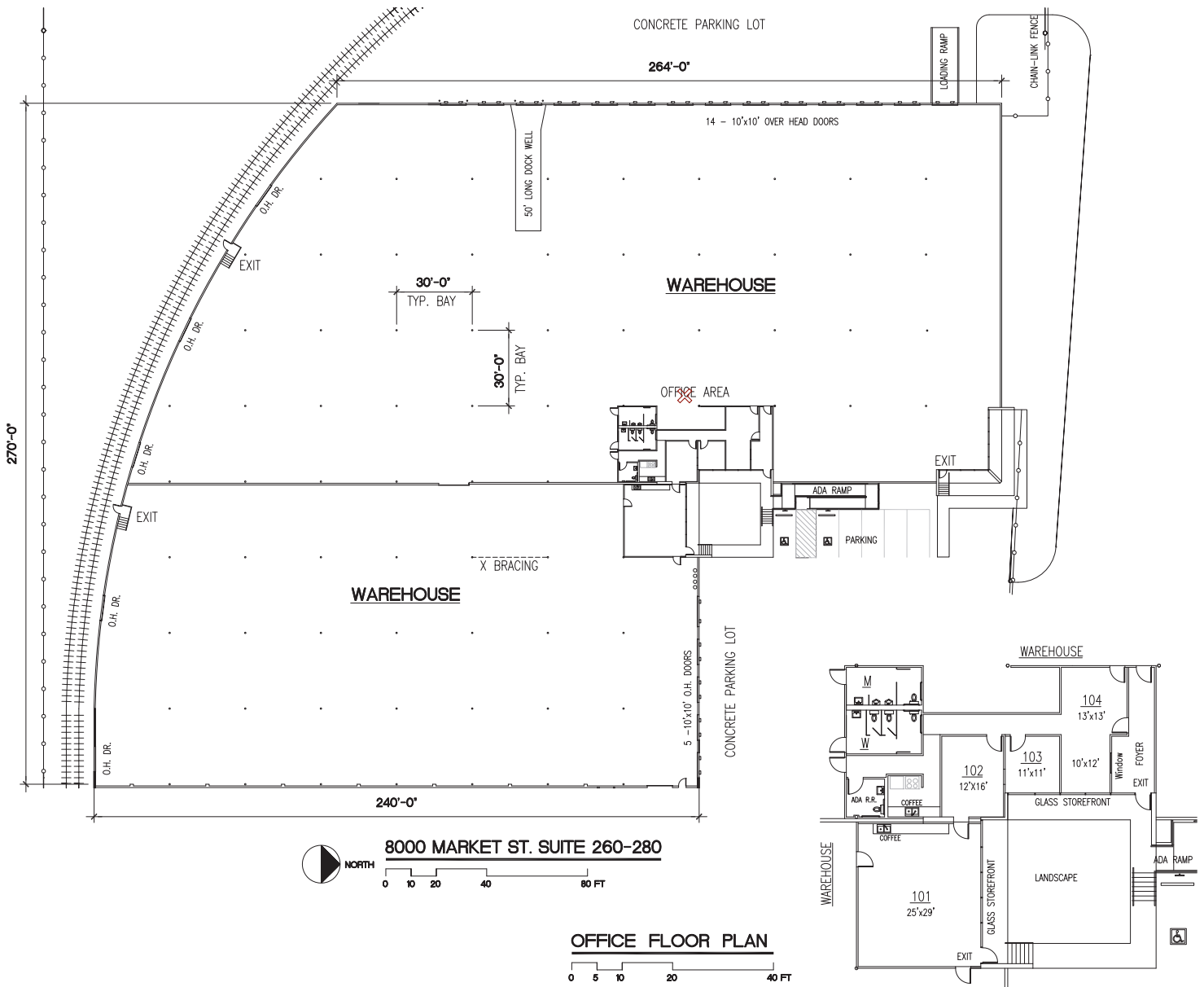

Up to ±75,354 SF Total Available



JLL

Ryan Fuselier
ryan.fuselier@jll.com
+1 713 888 4032

Carl Mueller
carl.mueller@jll.com
+1 713 425 1829

Katie Madden
katie.madden@jll.com
+1 713 818 1286

Although information has been obtained from sources deemed reliable, neither Owner nor JLL makes any guarantees, warranties or representations, express or implied, as to the completeness or accuracy as to the information contained herein. Any projections, opinions, assumptions or estimates used are for example only. There may be differences between projected and actual results, and those differences may be material. The Property may be withdrawn without notice. Neither Owner nor JLL accepts any liability for any loss or damage suffered by any party resulting from reliance on this information. If the recipient of this information has signed a confidentiality agreement regarding this matter, this information is subject to the terms of that agreement. ©2024 Jones Lang LaSalle IP, Inc. All rights reserved.