

FOR LEASE

# 18 ANTARES DRIVE

OTTAWA, ONTARIO



**QUBE PROPERTIES LTD.**

REAL ESTATE BROKERAGE  
255 MICHAEL COWPLAND DRIVE  
OTTAWA ON K2M 0M5

QU  
BE

# 18 ANTARES DRIVE

## ABOUT THE BUILDING

18 Antares is a 2-storey commercial building located in the West Ottawa Business park.

The building is in proximity to the Hunt Club and Antares Drive intersection and is easily accessible via public transit with OC Transit stops all along Antares Drive.

Centrally located and easily accessible to neighbourhoods like Riverside South, Merivale, Barrhaven and Manotick.

## ADDITIONAL INFORMATION

- Ground floor flex space in single storey portion of the building
- Double Doors in rear for loading
- **Utilities included** in Additional Rent
- Competitive Tenant Allowance Packages being offered



Demising option available  
(Net rent to be adjusted)



On-site parking



Proximity to YOW International  
Airport



Located in well-known  
established business park

**\$15.00**

Asking Net Rent

**\$12.00**

Add. Rent (est. 2024)

**SAMIZ SUNESARA**  
SALES REPRESENTATIVE  
(613) 413 2178  
[samiz@qubeproperties.com](mailto:samiz@qubeproperties.com)

**DAN DONNELLY**  
SALES REPRESENTATIVE  
(613) 302 7302  
[dan@qubeproperties.com](mailto:dan@qubeproperties.com)

**QUBE PROPERTIES LTD.**  
REAL ESTATE BROKERAGE  
255 MICHAEL COWPLAND DRIVE  
OTTAWA ON K2M 0M5





± 9,845 SF



10' Clear



200 Amp  
600 V  
3 Phase



Zoning:  
IG5

18 ANTARES DRIVE



# 18 ANTARES DRIVE

## FLOOR PLAN

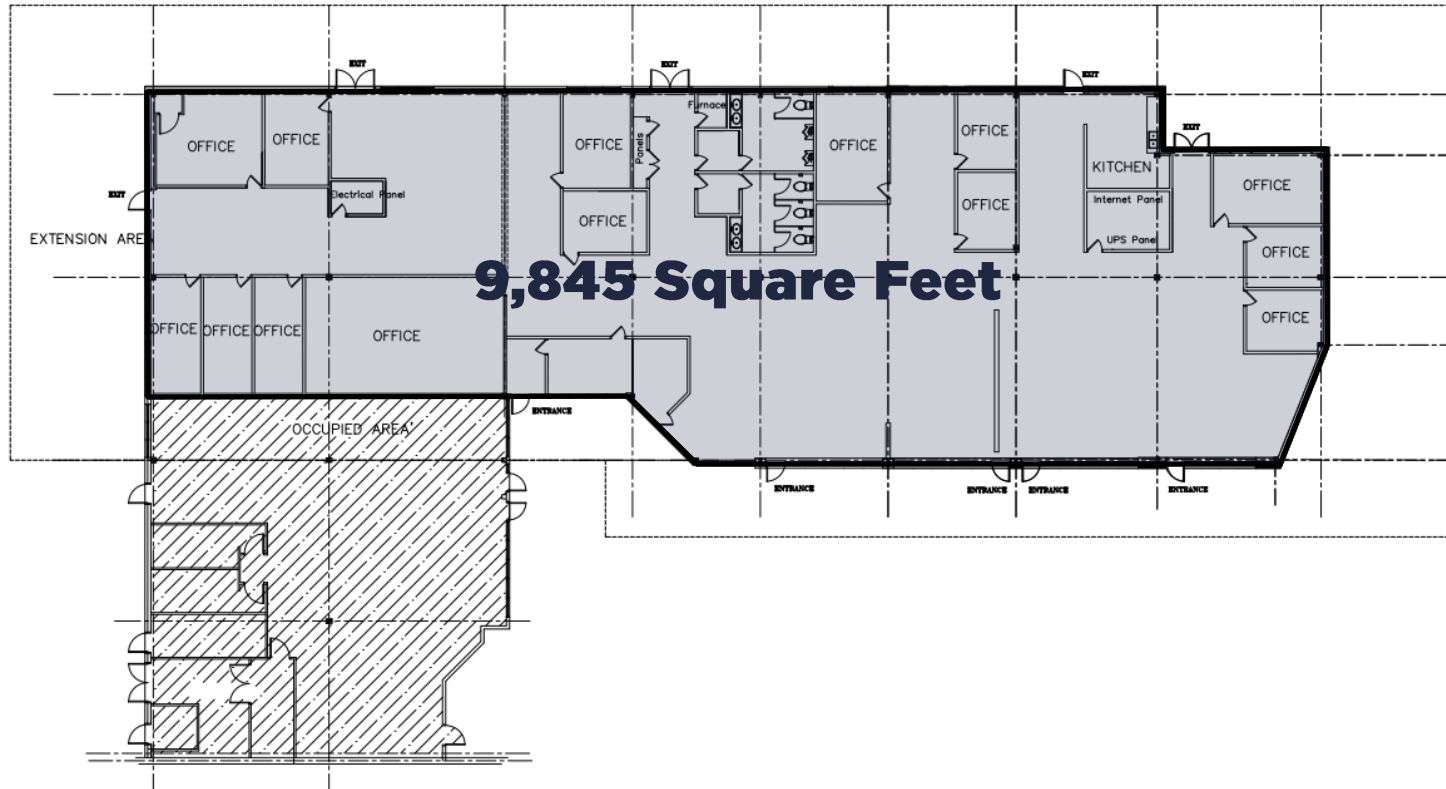

**SAMIZ SUNESARA**  
SALES REPRESENTATIVE  
(613) 663 9944  
[samiz@qubeproperties.com](mailto:samiz@qubeproperties.com)

**DAN DONNELLY**  
SALES REPRESENTATIVE  
(613) 302 7302  
[dan@qubeproperties.com](mailto:dan@qubeproperties.com)

**QUBE PROPERTIES LTD.**  
REAL ESTATE BROKERAGE  
255 MICHAEL COWPLAND DRIVE  
OTTAWA ON K2M 0M5



# QUBE

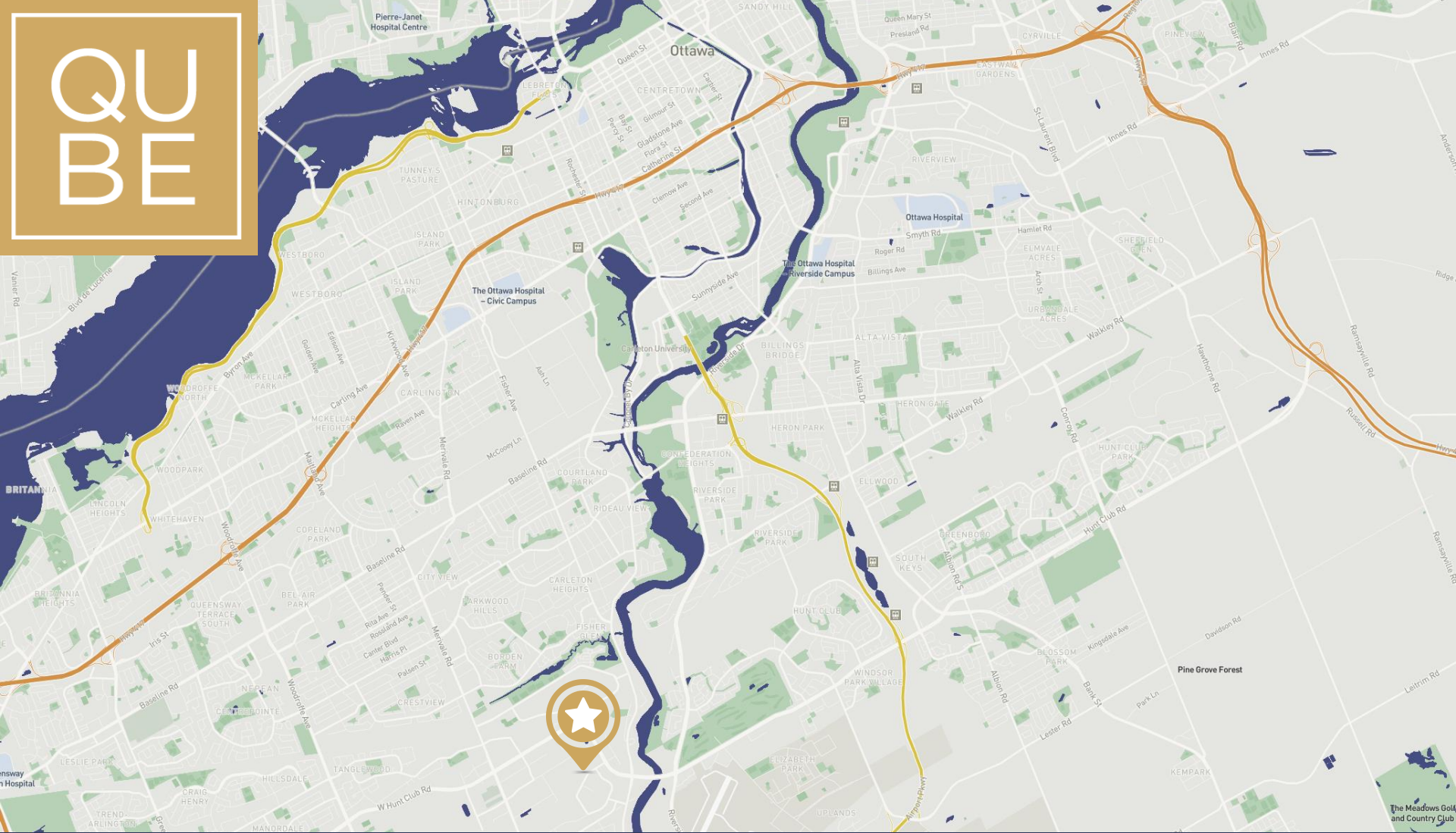

**SAMIZ SUNESARA**  
SALES REPRESENTATIVE  
(613) 663 9944  
[samiz@qubeproperties.com](mailto:samiz@qubeproperties.com)

**DANIEL DONNELLY**  
SALES REPRESENTATIVE  
(613) 302 7302  
[dan@qubeproperties.com](mailto:dan@qubeproperties.com)

# QUBE PROPERTIES

**QUBE PROPERTIES LTD.**

REAL ESTATE BROKERAGE  
255 MICHAEL COWPLAND DRIVE  
OTTAWA ON K2M 0M5

This disclaimer shall apply to Qube Properties Ltd, Real Estate Brokerage, and to all other divisions of the Corporation, to include all employees and independent contractors ("Qube"). The information set out herein, including, without limitation, any projections, images, opinions, assumptions and estimates obtained from third parties (the "Information") has not been verified by Qube, and Qube does not represent, warrant or guarantee the accuracy, correctness and completeness of the Information. Qube does not accept or assume any responsibility or liability, direct or consequential, for the Information or the recipient's reliance upon the Information. The recipient of the Information should take such steps as the recipient may deem necessary to verify the Information prior to placing any reliance upon the Information.