

For Lease

42,075 SF on 5.83 total acres

Ready for occupancy Q4 2024

1102 Avenue R, Grand Prairie, TX 75050



JLL

Caleb McCoy, SIOR
214 949 2084
caleb.mccoy@jll.com

JM Priddy
214 952 7283
jm.priddy@jll.com

Property specifications

- 42,075 SF available
- 5.83 total acres
- +/- 2,000 SF office
- Fully secured with chain link fence
- Additional paved storage
- (7) 10' x 10' Dock doors (4 with mechanical pit levelers)
- (1) 10' x 12' oversized ramp
- Power: 1200 Amps
- 18' Clear height
- T-4 Lighting with motion sensors
- Spec TI
 - Paint / Carpet in office
 - White box / LED Warehouse
 - Stripe truck court

Property images

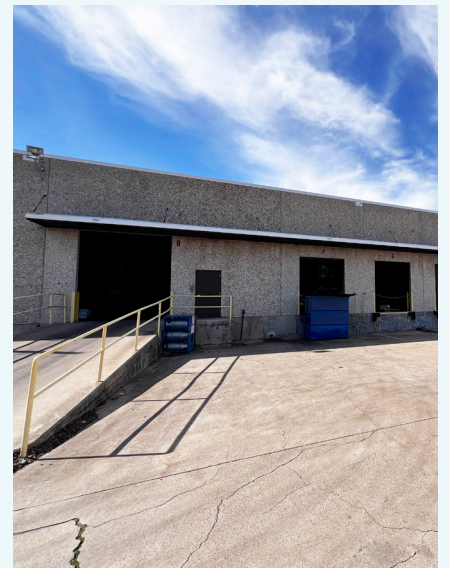

Site plan



SCALE: 3/32" = 1'-0"

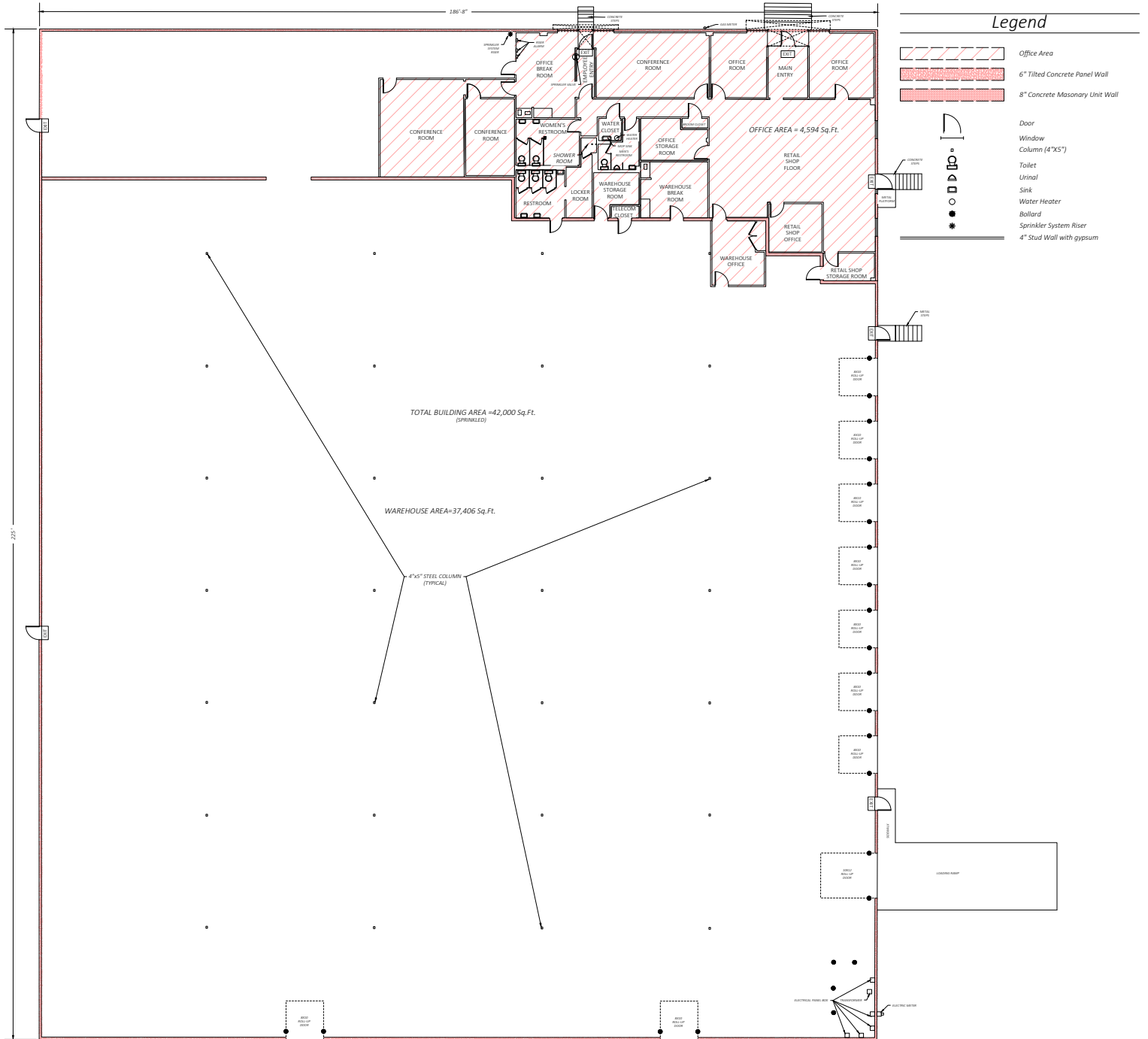

42,075 SF on 5.83 total acres

1102 Avenue R, Grand Prairie, TX 75050



JLL

Caleb McCoy, SIOR

214 949 2084

caleb.mccoy@jll.com

JM Priddy

214 952 7283

jm.priddy@jll.com