

For Sale

9,000 SF | \$1,295,000

Flex Space



BROCHURE | 900 W Chapel Rd Asheville, NC 28803

We obtained the information above from sources we believe to be reliable. However, we have not verified its accuracy and make no guarantee, warranty or representation about it. It is submitted subject to the possibility of errors, omissions, change of price, rental or other conditions, prior sale, lease or financing, or withdrawal without notice. We include projections, opinions, assumptions or estimates for example only, and they may not represent current or future performance of the property. You and your tax and legal advisors should conduct your own investigation of the property and transaction.



900 W Chapel Rd

Asheville, North Carolina 28803

Highly Flexible 9,000 SF Building In Prime South Asheville Location

900 West Chapel Road offers a rare opportunity just 150 feet from the signalized intersection at Hendersonville Rd (29,000 VPD) near Biltmore Forest. Formerly a kennel, the building has been cleaned out and reconfigured into a versatile two-level layout, upper level with front parking access and lower level with grade-level rear access and loading. Ideal for a wide range of commercial uses, the property features excellent visibility, strong traffic counts, and easy access to I-40 and I-240. Priced for a quick sale; all offers subject to court approval.

Offering Summary

Sale Price:	\$1,295,000
Building Size:	9,000 SF
Zoning:	HB
Lot Size:	0.27 Acres

For More Information

Jim Davis

O: 330 718 3311

jdavis@naibeverly-hanks.com | NC #292479

Nearby Retail

9,000 SF | \$1,295,000

Flex Space



BROCHURE | 900 W Chapel Rd Asheville, NC 28803

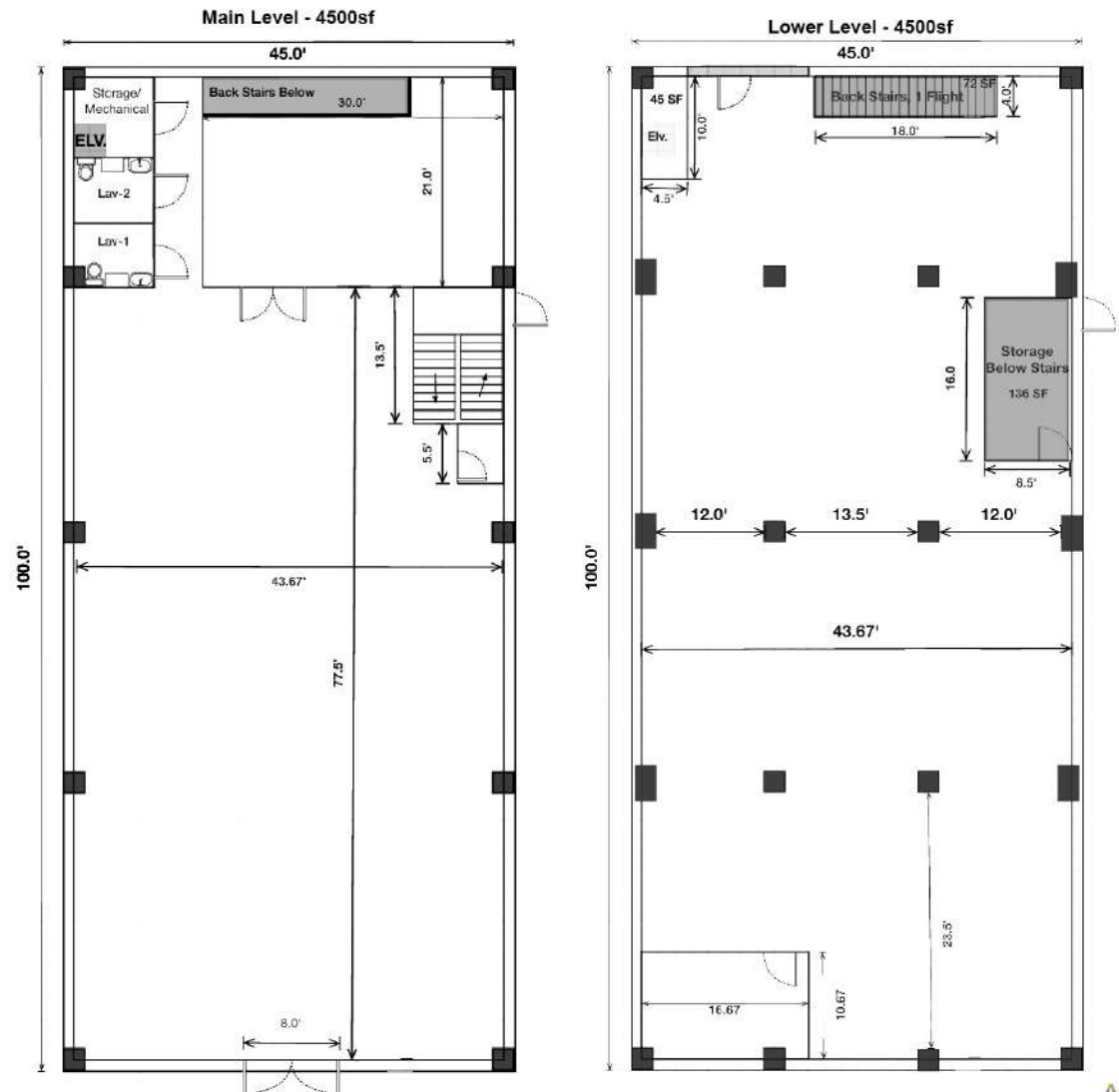



Interior Photos

9,000 SF | \$1,295,000

Flex Space



Demographics

9,000 SF | \$1,295,000

Flex Space

Population

	0.3 Miles	0.5 Miles	1 Mile
Total Population	647	1,800	4,309
Average Age	43	44	44
Average Age (Male)	42	42	42
Average Age (Female)	45	45	45

Households & Income

	0.3 Miles	0.5 Miles	1 Mile
Total Households	304	837	1,859
# of Persons per HH	2.1	2.2	2.3
Average HH Income	\$106,471	\$112,832	\$114,373
Average House Value	\$491,501	\$525,745	\$546,648

Demographics data derived from AlphaMap

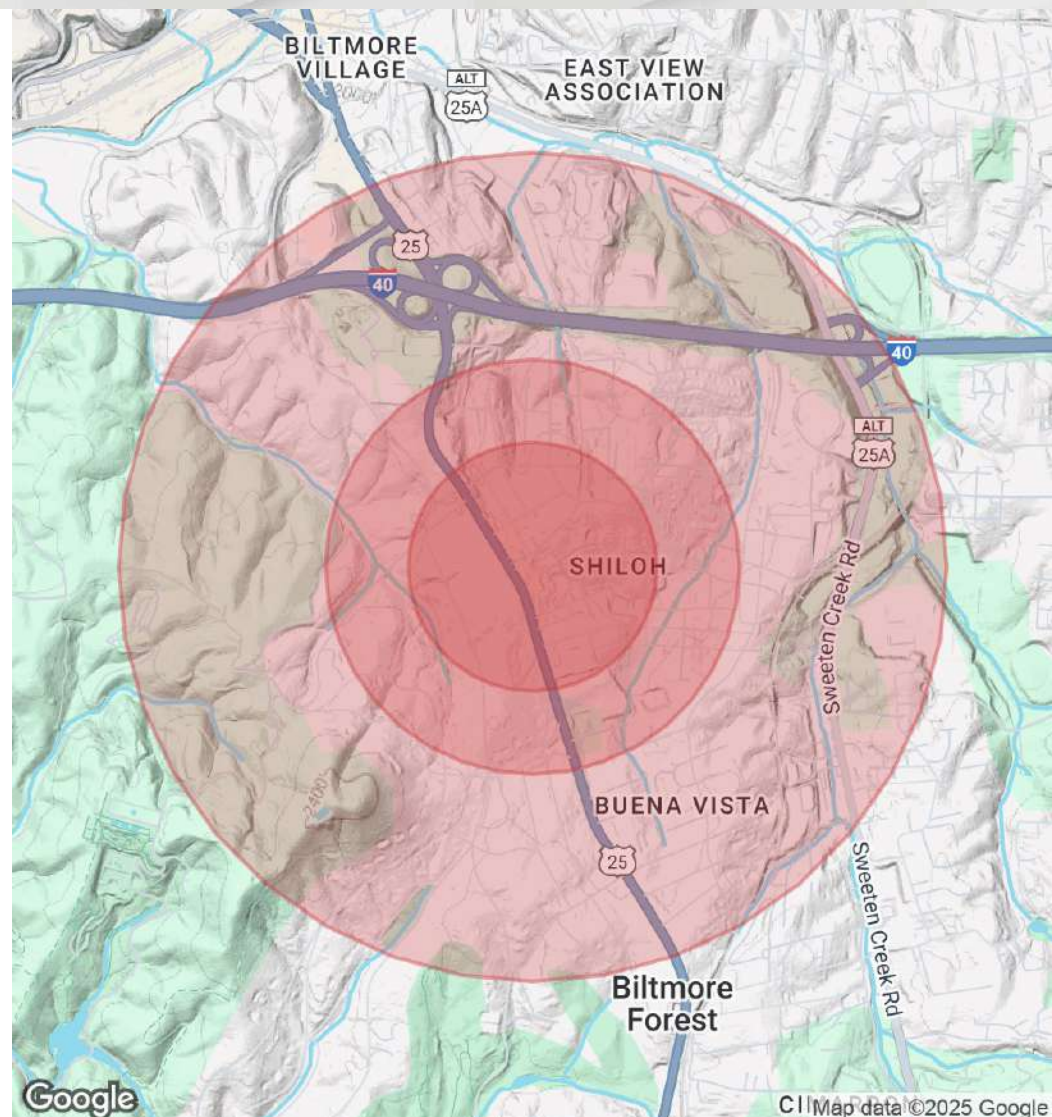

Jim Davis - Commercial Broker

NAI Beverly-Hanks | Broad River Capital

Member Associate, Society Of Industrial and Office Realtors

North Carolina Economic Development Association Member

Phone: 330-718-3311

Email: Jdavis@NAIBeverly-Hanks.com

