

RESTAURANT SPACE

WITH DRIVE THRU

FOR LEASE



1923 SOUTH COLLEGE STREET, AUBURN, ALABAMA

PENDING RELOCATION

Excellent real estate opportunity in one of Auburn's thriving retail corridors, surrounded by well known, established brands. With ± 30,992 cars per day on South College Street, this is a prime location. Building has an existing drive - thru.



FEATURES:

- Existing and equipped restaurant building
- Surface parking
- Drive thru lane

2,304 SF BUILDING SF*

0.95 ACRES PARCEL SIZE*



PRICE NOT DISCLOSED

Auburn
Opelika
Phenix City
Montgomery

MARKET



SITE MAP

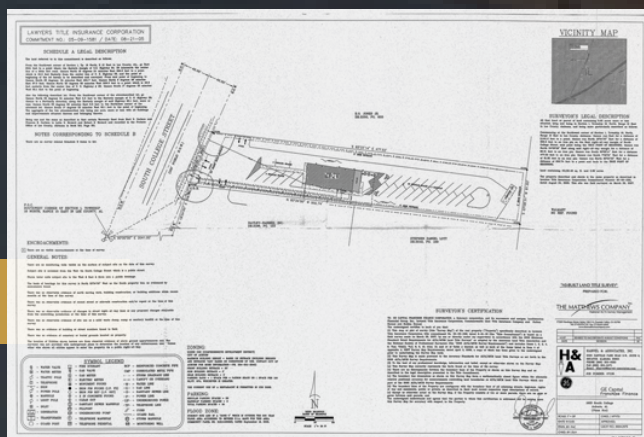

CONTACT

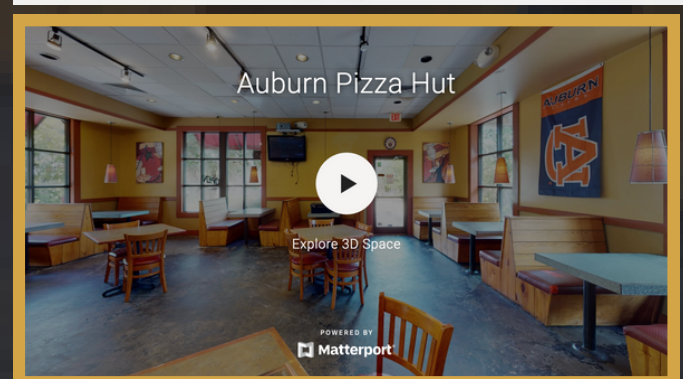

CLICK TO TAKE A VIRTUAL TOUR



ERNIE SMALLMAN

1025 1st Ave | Columbus, GA 31901 | 706-888-6651

<https://www.erniesmallman.com/>



706-888-6651 (Cell)
706-256-1500



ernie@erniesmallmancre.com



COLDWELL BANKER
KENNON, PARKER,
DUNCAN & DAVIS

FOR MORE INFORMATION

AUBURN, ALABAMA

Auburn isn't just one of the best college towns in the South; it's also a fantastic place to live. Auburn's prime location offers residents quick access to major cities like Huntsville and Atlanta, proximity to Chewacla State Park and is just a few hours away from the beach.

Nearby cities include LaGrange, Phenix City, and Opelika.

Moreover, the Auburn-Opelika area is one of the fastest-growing metros in the country and the second largest in the state.



<https://alabama.travel/places-to-go/cities-and-towns/auburn> | <https://livability.com/best-places/the-2020-top-100-best-places-to-live-in-america/auburn-0/> | <https://www.auburnalabama.org/industry-development/>

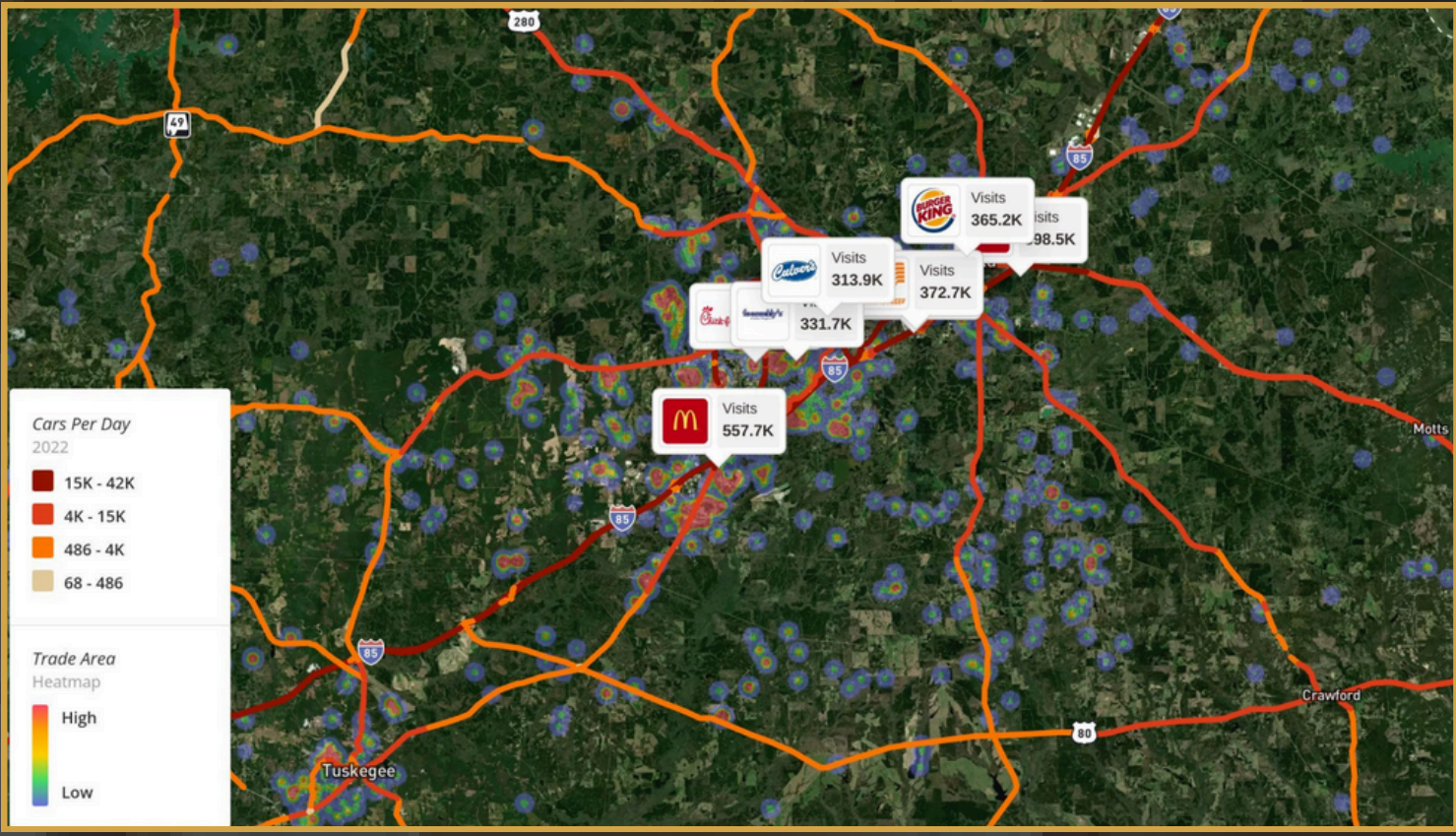

HIGH TRAFFIC COUNTS

MEDIAN HOUSEHOLD INCOME
\$54,700

MEDIAN PROPERTY VALUE
\$285,000

Auburn is located along Interstate 85 with exits less than a mile from their Technology Parks.

Atlanta's Hartsfield Jackson International Airport (ATL), the busiest and most efficient airport in the world, is an hour and a half drive from Auburn.

Auburn University Regional Airport (AUO) has runways of 5,265' x 100' and 4,002' x 75'.

The CSX Class I main line travels through Auburn, adjacent to their Industrial Park.

AUBURN IS SITUATED AT THE INTERSECTION OF 4 MAJOR METROS



FOR MORE INFORMATION



ERNIE SMALLMAN
1025 1st Ave | Columbus, GA 31901 | 706-888-6651

<https://www.erniesmallman.com/>

CONTACT

706-888-6651 (Cell)
706-256-1500

ernie@erniesmallmancre.com

