

**FOR  
LEASE**



**Kalmon Dolgin**  
**AFFILIATES INC.**

**251 Lombardy Street  
Brooklyn, NY 11222**

21,100 SF Land + 2,050 SF Shop  
& Office available for Lease in  
Greenpoint area.(23,150 SF Total)

**Ideal for: Trucking, Fleet  
business, Contractors, Towing  
Companies, Marble & Granite  
Companies & Many other  
Industrial Uses.**

### **Building Features**

- Office Area overlooks the land
- Land is paved & fenced.
- Drive-In Door to be installed to shop space.
- Located off of the Meeker Morgan Exit on the BQE.
- Wide Streets
- Longer Lease Options Available.
- M3 Zoning

### **For More Information**

**Please Contact Exclusive Broker:**

**Fred Rufrano**

**Kalmon Dolgin Affiliates**

**347-390-1127 Direct**

**Fred@Kalmondolgin.com**



**FOR  
LEASE**



**Kalmon Dolgin**  
**AFFILIATES INC.**

**251 Lombardy Street Brooklyn, NY 11222**

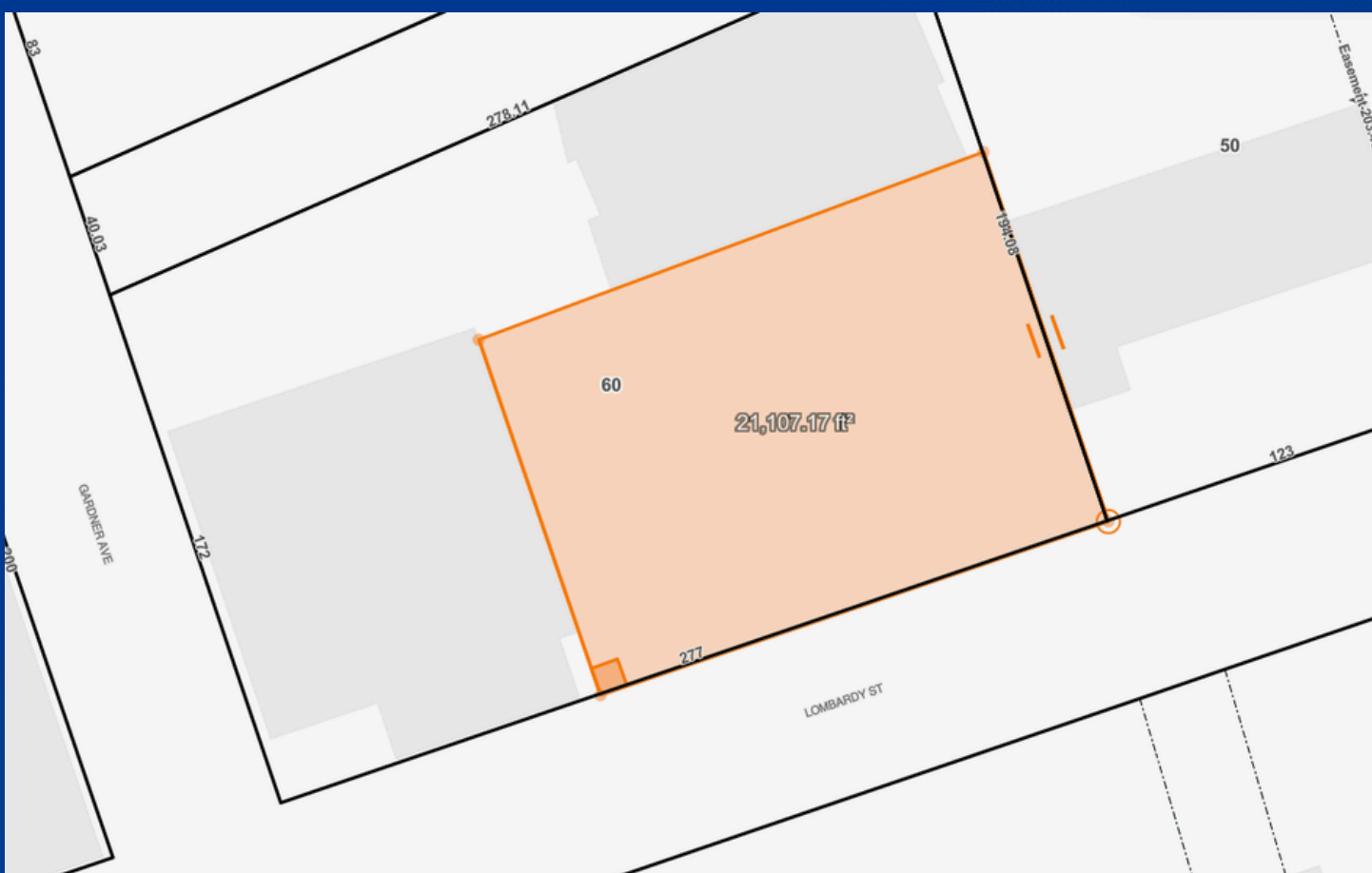

**Pricing Available Upon Request.**

**For More Information**  
**Please Contact Exclusive Broker:**

**Fred Rufrano**  
**Kalmon Dolgin Affiliates**  
**347-390-1127 Direct**  
**Fred@Kalmondolgin.com**