

FOR LEASE

WEST OGDEN INDUSTRIAL



MOUNTAIN WEST
COMMERCIAL REAL ESTATE

JEFFERY SORENSON

jsorenson@mwcre.com

direct 636.219.5642

[View Profile](#)

RAND SARGENT

rsargent@mwcre.com

direct 801.989.1600

[View Profile](#)

TAYLOR OGDEN

togden@mwcre.com

direct 801.750.6342

[View Profile](#)

PROPERTY DETAILS

9510 WEST 900 SOUTH, OGDEN, UT 84404

- 50,000 SF
- Divisible to 25,000 SF
- Clear height: 26'
- Power: 3-phase, 480v, 2,000 amp
- Six (6) ground level doors
- Two (2) stubbed rail spurs on site
- Ready for tenant improvements
- Potential yard available
- The first of three phases onsite

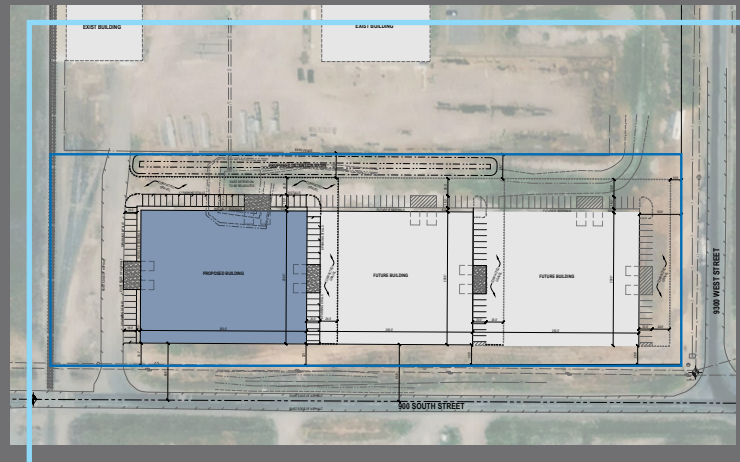

**FULL SERVICE
COMMERCIAL REAL ESTATE**

2015 W. Grove Pkwy., Ste J

Pleasant Grove, UT 84062

Office 385.233.9140

www.mwcre.com



MOUNTAIN WEST
COMMERCIAL REAL ESTATE

JEFFERY SORENSON

jsorenson@mwcre.com

direct 636.219.5642

[View Profile](#)

RAND SARGENT

rsargent@mwcre.com

direct 801.989.1600

[View Profile](#)

TAYLOR OGDEN

togden@mwcre.com

direct 801.750.6342

[View Profile](#)



**FULL SERVICE
COMMERCIAL REAL ESTATE**

2015 W. Grove Pkwy., Ste J

Pleasant Grove, UT 84062

Office 385.233.9140

www.mwcre.com

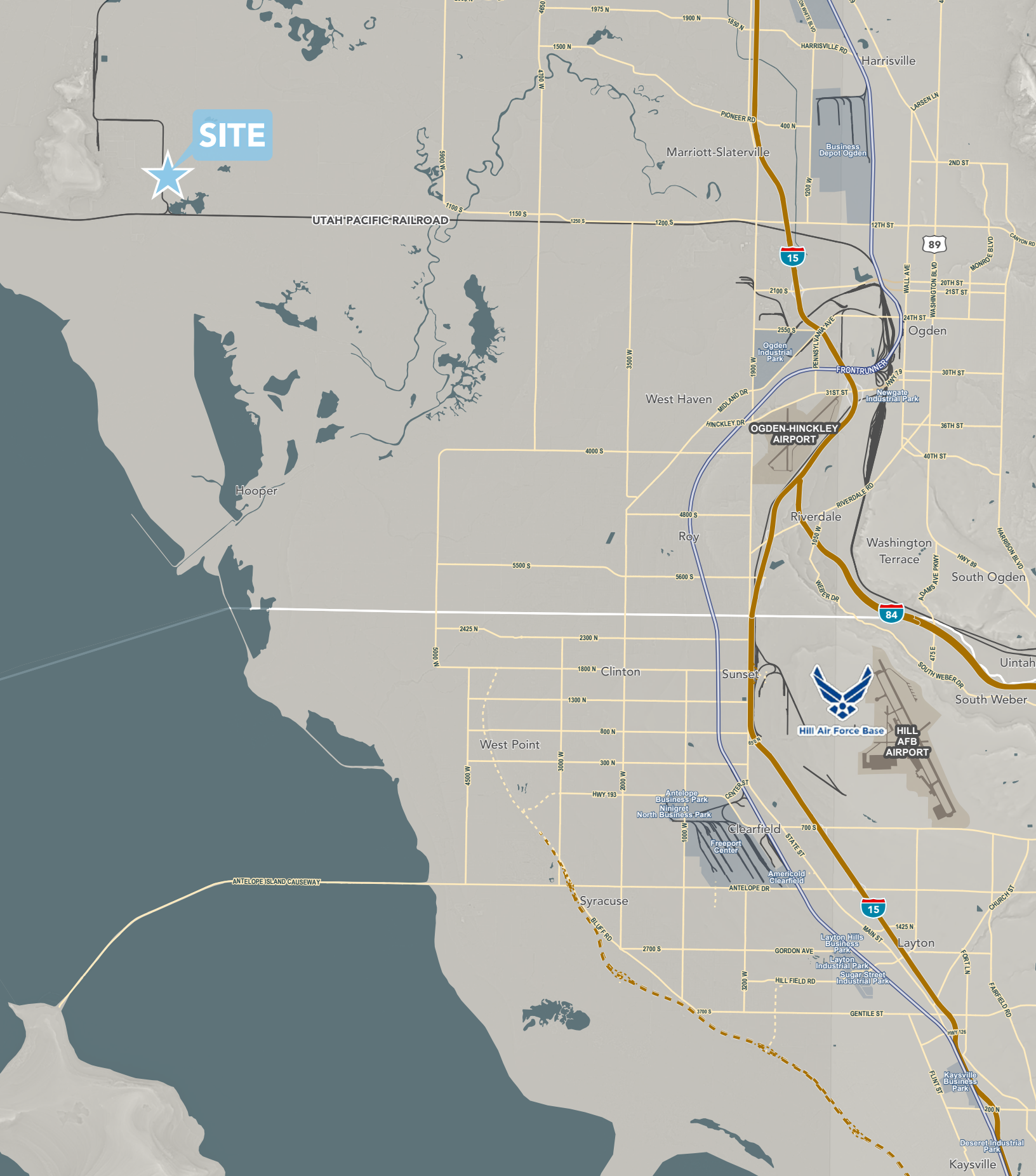

MOUNTAIN WEST
COMMERCIAL REAL ESTATE

JEFFERY SORENSON

jsorensen@mwcre.com
direct 636.219.5642
[View Profile](#)

RAND SARGENT

rsargent@mwcre.com
direct 801.989.1600
[View Profile](#)

TAYLOR OGDEN

togden@mwcre.com
direct 801.750.6342
[View Profile](#)

**FULL SERVICE
COMMERCIAL REAL ESTATE**

2015 W. Grove Pkwy., Ste J
Pleasant Grove, UT 84062
Office 385.233.9140
www.mwcre.com