

AVAILABLE FOR LEASE
WEST SHAW VILLAGE

2700-2784 W. SHAW AVENUE
FRESNO, CA



For information, please contact:

Kelsey McKenney

Retail California

t 559-447-6218

kelsey@retailcalifornia.com

CA RE Lic. #02217573

Coryne McKenney

Newmark Pearson Commercial

t 559-447-6239

cmckenney@pearsonrealty.com

CA RE Lic. #02200479

Troy McKenney

Newmark Pearson Commercial

t 559-447-6277

tmckenney@pearsonrealty.com

CA RE Lic. #00952671

Independently Owned and Operated | Corporate License #00020875

retailcalifornia.com | newmarkpearson.com | mckenneyinvestmentproperties.com



The distributor of this communication is performing acts for which a real estate license is required. The information contained herein has been obtained from sources deemed reliable but has not been verified and no guarantee, warranty or representation, either express or implied, is made with respect to such information. Terms of sale or lease and availability are subject to change or withdrawal without notice.

WEST SHAW VILLAGE - FRESNO, CA

PROPERTY INFORMATION	Availability:	Various		
	Corner Pad:	1.26± Acres (Ground Lease)		
	Suite 2712:	1,000± SF	Total Square Feet:	38,427± Total Square Feet
	Suite 2718:	1,295± SF	APN's:	415-052-49 (Fresno County)
	Suite 2730:	1,719± SF (Pending)	Lot Size:	4.00± Acres
	Suite 2744:	1,440± SF	Year Built:	1983
	Suite 2748:	1,656± SF		
	Lease Rate:	TBD		

NEARBY TENANTS

Tenants include Culichi Town Restaurant, Foster’s Donuts, Pete’s Teriyaki, Ewell’s Place, AT&T Wireless, All State Insurance, Shila Korean BBQ, Uncle Harry’s Bagels and Thai Wok & Cafe. The property is across the street from Target, Ross, Big 5 and many more national & local retailers.

TRAFFIC COUNTS

The center has exceptional visibility and signage available with high traffic counts at the intersection.

Marks Avenue @ Shaw Avenue	48,478 ± ADT (North & Southbound)
Shaw Avenue @ Marks Avenue	76,106 ± ADT (East & Westbound)
Total Visibility:	124,584 ± ADT (All Directions)

Source: Kalibrate TrafficMetrix 2025

- HIGHLIGHTS
- Great Visibility
 - Easy Access from Shaw Avenue & Marks Avenue
 - Adjacent to Major Retailers
 - Hard Corner Signalized Intersection
 - Signage Available on Monument Sign



The distributor of this communication is performing acts for which a real estate license is required. The information contained herein has been obtained from sources deemed reliable but has not been verified and no guarantee, warranty or representation, either express or implied, is made with respect to such information. Terms of sale or lease and availability are subject to change or withdrawal without notice.

WEST SHAW VILLAGE - FRESNO, CA

AVAILABILITY MAP

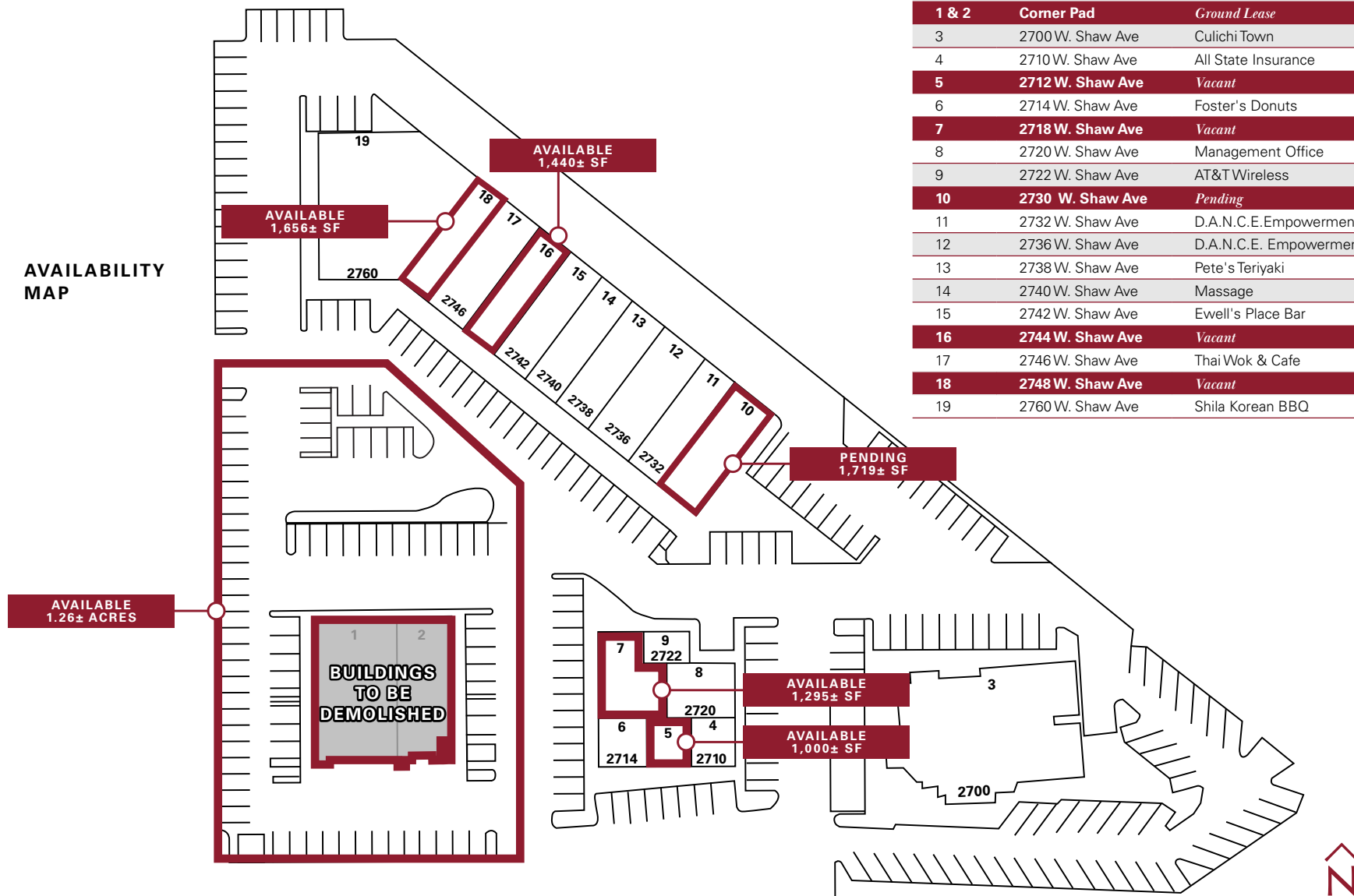

SITE PLAN
WITH STREET
ENTRY PATHS

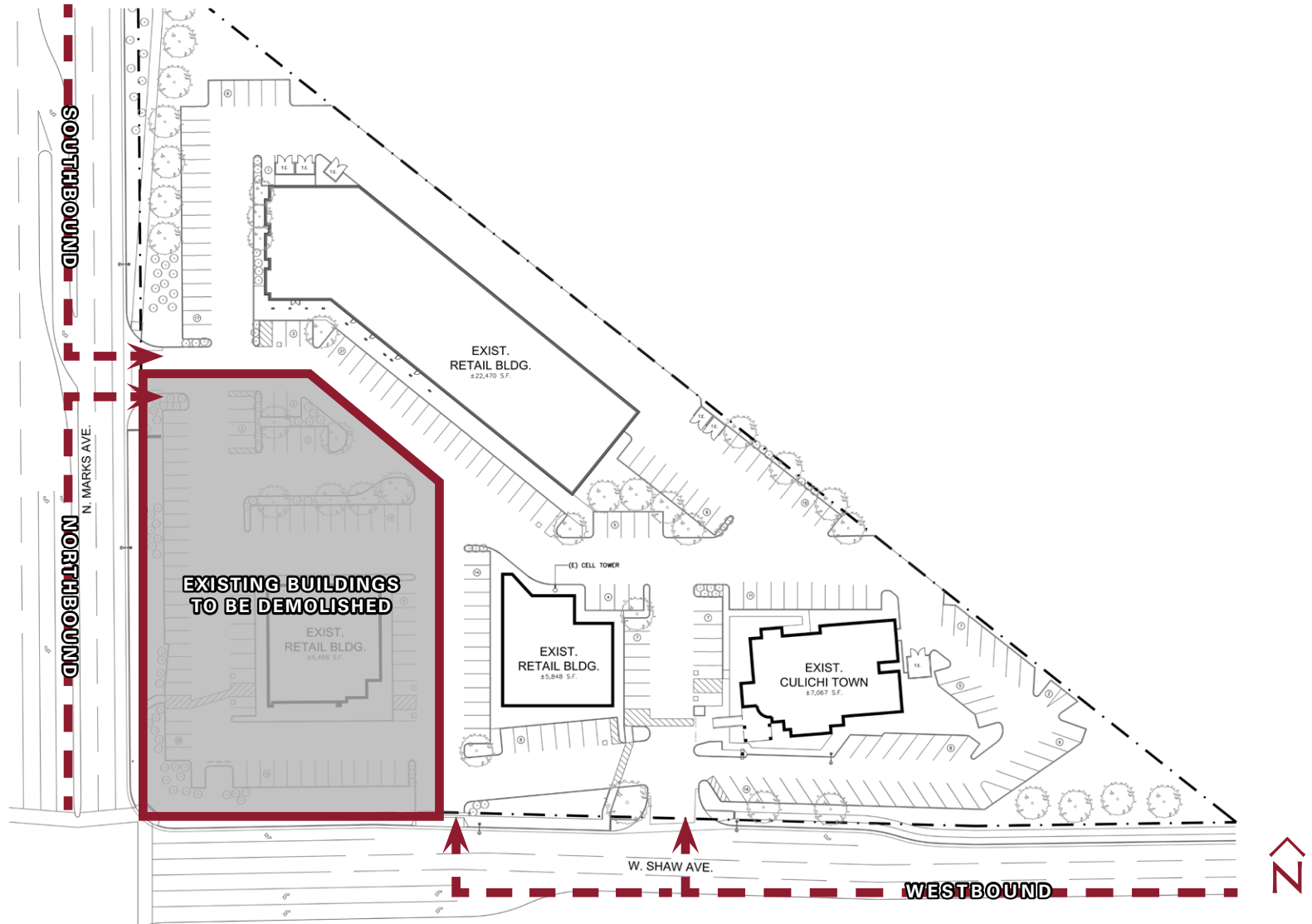

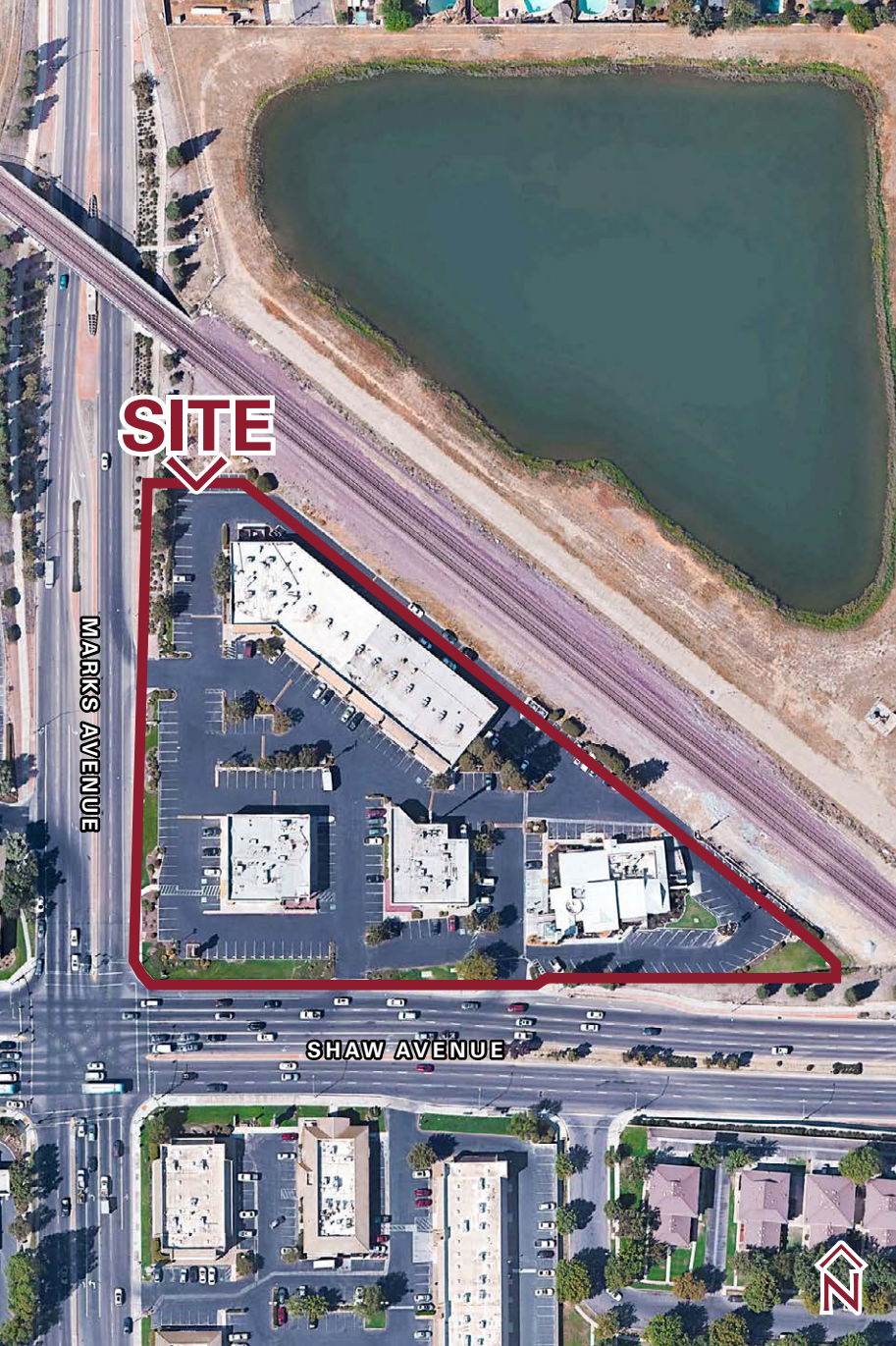

For information, please contact:

Kelsey McKenney

Retail California

t 559-447-6218

kelsey@retailcalifornia.com

CA RE Lic. #02217573

Coryne McKenney

Newmark Pearson Commercial

t 559-447-6239

cmckenney@pearsonrealty.com

CA RE Lic. #02200479

Troy A. McKenney

Newmark Pearson Commercial

t 559-447-6277

tmckenney@pearsonrealty.com

CA RE Lic #00952671



NEWMARK
PEARSON COMMERCIAL



Independently Owned and Operated | Corporate License #00020875

retailcalifornia.com | newmarkpearson.com | mckenneyinvestmentproperties.com

The distributor of this communication is performing acts for which a real estate license is required. The information contained herein has been obtained from sources deemed reliable but has not been verified and no guarantee, warranty or representation, either express or implied, is made with respect to such information. Terms of sale or lease and availability are subject to change or withdrawal without notice.