

FOR LEASE

15027 AURORA AVE N
SHORELINE, WA 98133

YCM PLAZA RETAIL



BRIAN SHIN 253.249.8011
brian.shin@tspmanagement.net

DAN YOO 206.359.1817
dan.yoo@tspmanagement.net

OFFICE 253.512.1000
marketing@tspmanagement.net

The information contained herein has been given to us by sources that we deem reliable. We have no reason to doubt its accuracy, but we do not guarantee it. Prospective buyers/tenants should carefully verify all information

TSPM



Central CHIROPRACTIC

15027

JAMES S. PARK D.C.

206-809-3520

ETHIOPIAN
COFFEE AND PASTRIES

ESPRESSO DRINKS



PUBLIC NOTICE

Address

15027 Aurora Ave N, Shoreline, WA 98133

Available SF

± 1,312 SF

Lease Price

\$28 SF + NNN

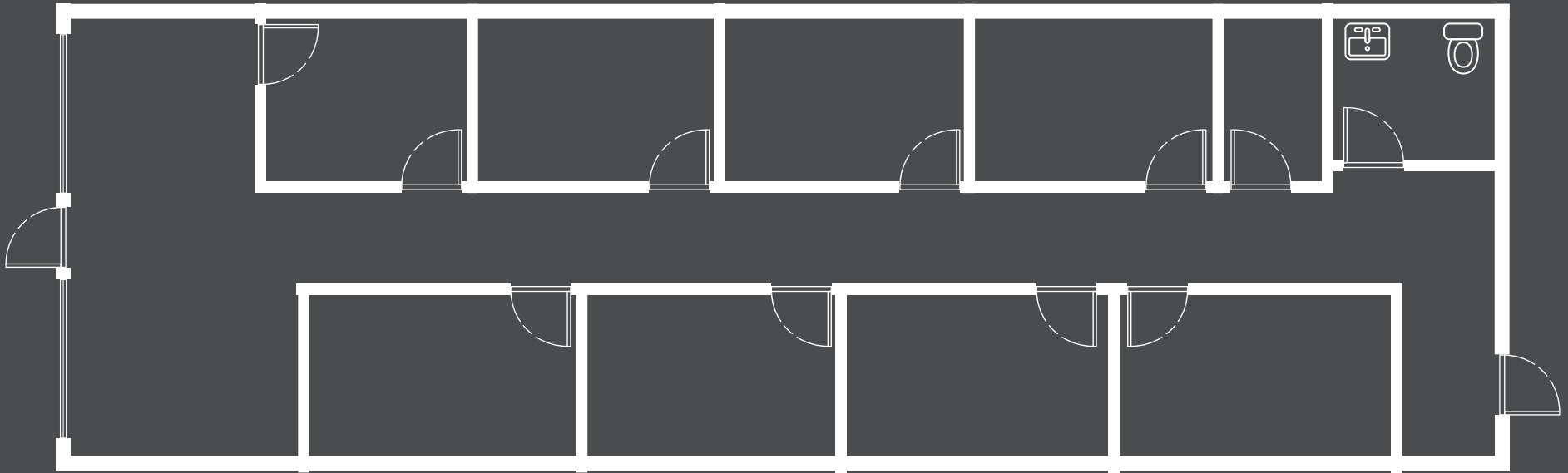

 [CLICK HERE FOR A VIRTUAL TOUR](#)

PROPERTY HIGHLIGHTS

Great Retail/Office space of 1,312 SF available for lease. Easy access to I-5, located on Aurora Ave with access to North and South directions. Interurban trail is right behind the property. Bus route direct E Line to downtown Seattle and up North. Great tenant mix. Please contact listing agents for details and showings.

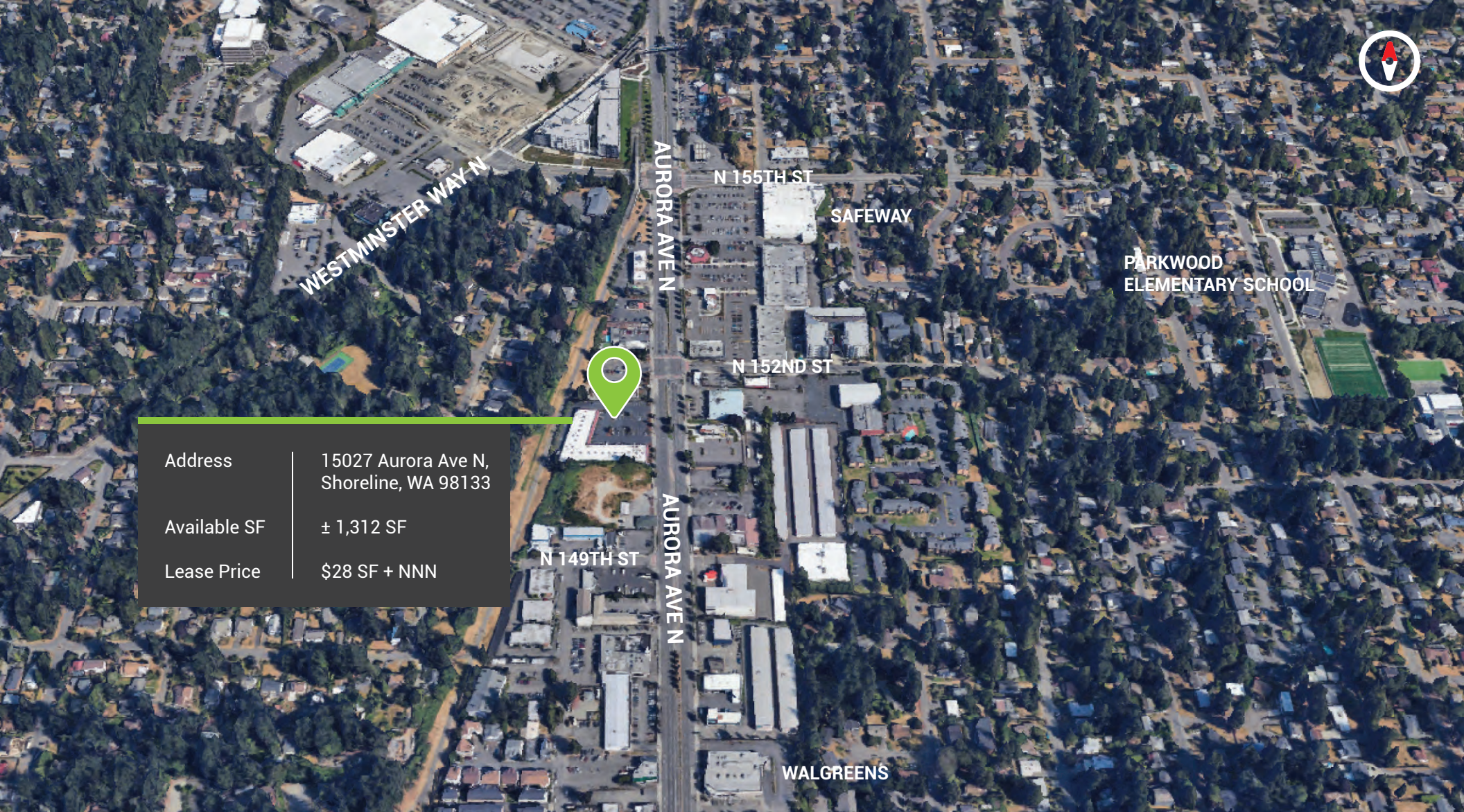

Address	15027 Aurora Ave N, Shoreline, WA 98133
Available SF	± 1,312 SF
Lease Price	\$28 SF + NNN

BRIAN SHIN 253.249.8011
brian.shin@tspmanagement.net

DAN YOO 206.359.1817
dan.yoo@tspmanagement.net

OFFICE 253.512.1000
marketing@tspmanagement.net

The information contained herein has been given to us by sources that we deem reliable. We have no reason to doubt its accuracy, but we do not guarantee it. Prospective buyers/tenants should carefully verify all information

TSPM