



TACO BELL

SUBWAY

ANYTIME FITNESS

Collinsville Bank
a division of Northway Community Bank

Mobil

SITE



PROJECT DETAILS

285 ALBANY TURNPIKE • 2.5 ACRES AVAILABLE FOR SALE OR LEASE

PROPERTY HIGHLIGHTS

- 2.5 Acres
- Flat land available for development
- Set back from main road
- Great site for daycare

DEMOGRAPHICS

| | 1 MILES | 3 MILES | 5 MILES |
|--------------------|----------|-----------|-----------|
| TOTAL POPULATION | 3,569 | 17,860 | 46,526 |
| DAYTIME POPULATION | 3,354 | 17,488 | 43,107 |
| MEDIAN HH INCOME | \$86,554 | \$147,568 | \$144,182 |
| HOUSEHOLDS | 1,578 | 6,834 | 18,538 |

DEVELOPABLE LAND

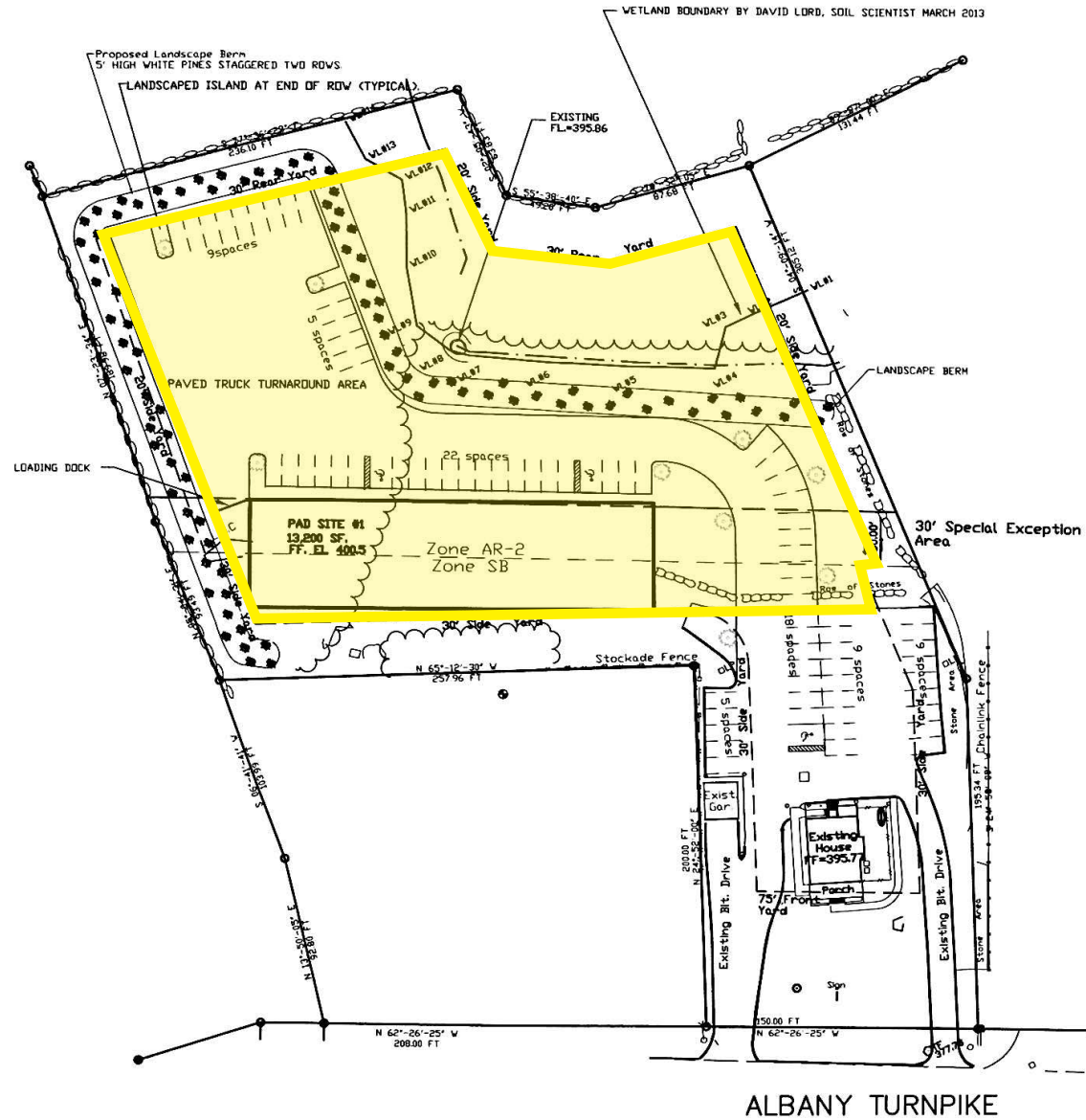





SUBWAY

ANY TIME FITNESS

Collinsville Bank

SITE

CANTON, CT

285 ALBANY TURNPIKE

2.5 ACRES AVAILABLE FOR SALE OR LEASE

MICHAEL ALBERICO

617.239.3605
MALBERICO@ATLANTICRETAIL.COM

MATT ANDREANA

860.808.6103
MANDREANA@ATLANTICRETAIL.COM



BOSTON
THE PRUDENTIAL CENTER
BOSTON, MA 02199
617.239.3600

ALBANY

ATLANTA

CHARLOTTE
LOS ANGELES

NEW YORK CITY

ORLANDO

PITTSBURGH

WEST PALM BEACH

WWW.ATLANTICRETAIL.COM

[LINKEDIN.COM/COMPANY/ATLANTIC-RETAIL-PROPERTIES](https://www.linkedin.com/company/atlantic-retail-properties)
 [INSTAGRAM.COM/ATLANTIC_RETAIL/](https://www.instagram.com/atlantic_retail/)

