

**GOBLE
PROPERTIES**

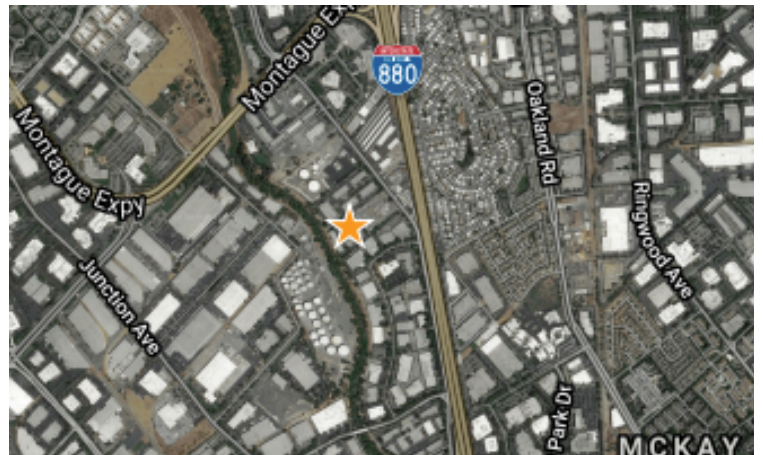

2365-E PARAGON DR. SAN JOSE, CA

R&D/FLEX For Lease
4,950 SF



**GOBLE
PROPERTIES**
GOBLEPROPERTIES.COM

Contact Us

408-452-1754

contact@gobleproperties.com

Unit Highlights

- 4,950 sq. ft.
- 2 Floors
- 1 Grade Level Roll Up Door
- 3 Restrooms (2 Downstairs, 1 Upstairs)
- Front Area/ Lobby + Conference Room, Kitchenette Area, 6 Offices (3 Downstairs, 3 Upstairs) + Flex Space. ***Walls can be demoed for more warehouse space***
- 200 amps
- 15ft clearance to water pipe in warehouse

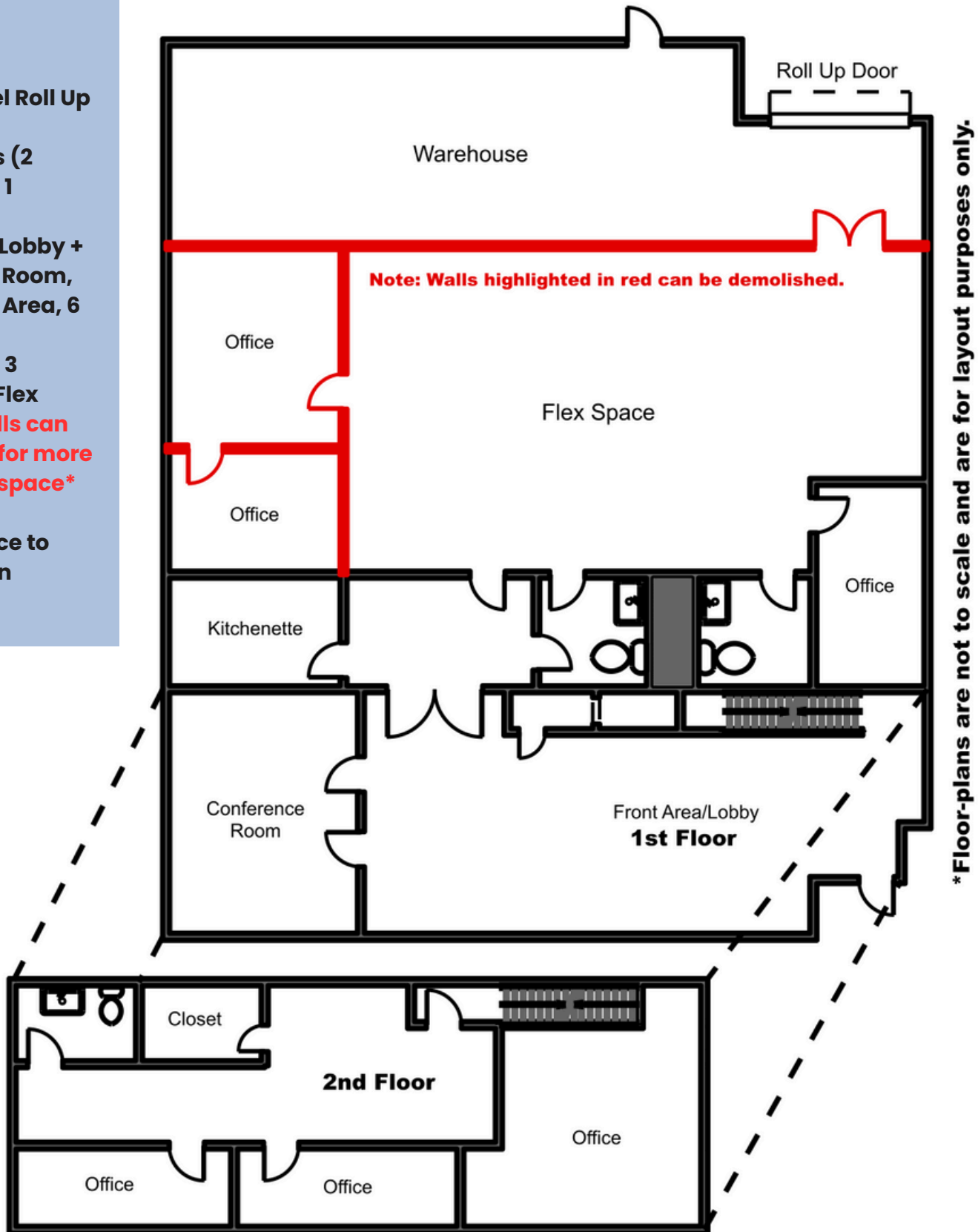



Contact Us

408-452-1754

contact@gobleproperties.com

