



FOR LEASE – 7,200+/- Sq. Ft. INDUSTRIAL WAREHOUSE 30A MILL STREET

Northern California's Premier Commercial Real Estate



The above information, while not guaranteed, has been secured from sources we believe to be reliable. This is not an offer to sell or lease and is subject to change or withdrawal. Any interested party should verify the status of the property and the information herein.



SITE SUMMARY

PRICING

| | |
|------------------|--------------------------|
| Base Rent Price: | \$1.15/Sq. Ft. Base Rent |
| | \$0.12/Sq. Ft. NNN Costs |

BUILDING

| | |
|------------------------------|---|
| Building Size: | 7,200+/- Sq. Ft. |
| Construction Type / Sliding: | Metal |
| Grade Level Loading Doors: | 2 (12' x 15') |
| Ceiling Height: | 13' to bottom of truss, 24' to peak of roof. Truss spacing 18' OC |
| Sprinklers: | Yes |
| Power: | 400 Amps 3-Phase |

SITE

| | |
|-----------------|-----------------------|
| APN: | 002-251-017 |
| Size: | 35,719+/- Acres |
| Zoning: | IL (Light Industrial) |
| Water & Sewer: | City of Healdsburg |
| Gas & Electric: | City of Healdsburg |



30A Mill Street

Approximately 7,200+/- sq. ft. metal industrial building, located 2 blocks from Healdsburg Square. The building features two grade-level roll-up doors at the rear and a glass store entry at the front. It is equipped with 400 amps of electrical power and is connected to a domestic sewer system. The clear span truss system eliminates columns, with a clear height of approximately 13 feet to the bottom of the truss and nearly 24 feet to the peak of the roof. All walls are insulated, not including the ceiling. The building is connected to fire suppression and is conditioned with gas ceiling-mounted heaters. The space includes two restrooms and an office on the lower level, along with a well-appointed office area on the second floor. IL zoning is rare in Healdsburg. The building and Plum Industrial Park are well-maintained, and signage is available at the park entrance.



SITE PLAN

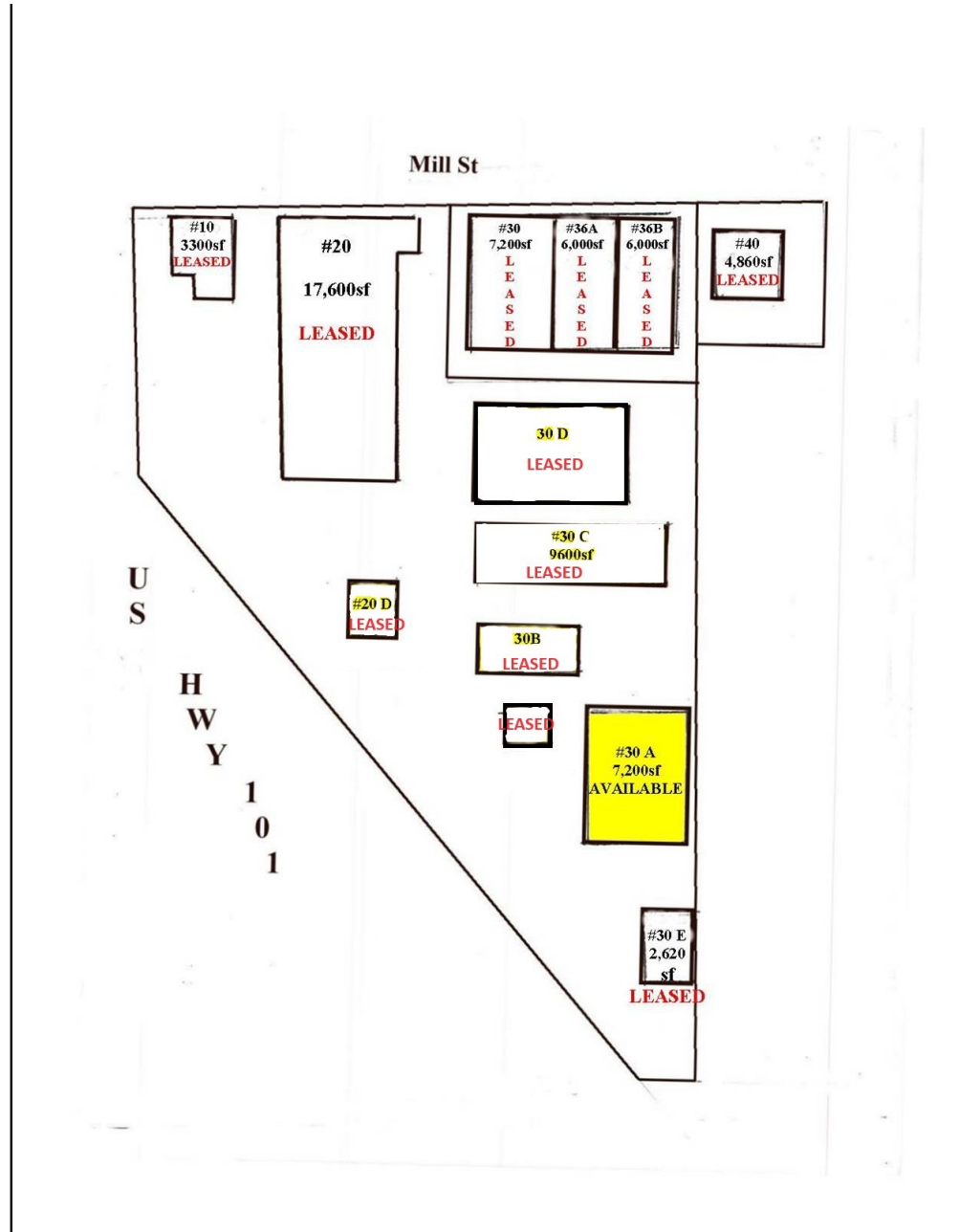

The above information, while not guaranteed, has been secured from sources we believe to be reliable. This is not an offer to sell or lease and is subject to change or withdrawal. Any interested party should verify the status of the property and the information herein.



PHOTOS



Exterior Entrance



Roll Up Door



Open Interior Space

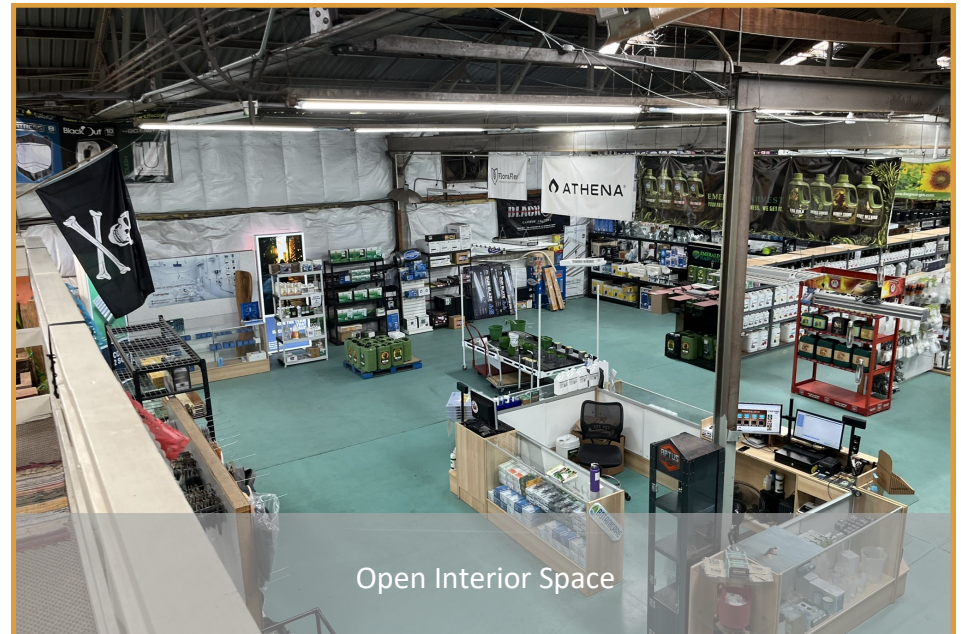

Open Interior Space

The above information, while not guaranteed, has been secured from sources we believe to be reliable. This is not an offer to sell or lease and is subject to change or withdrawal. Any interested party should verify the status of the property and the information herein.



STREET MAP

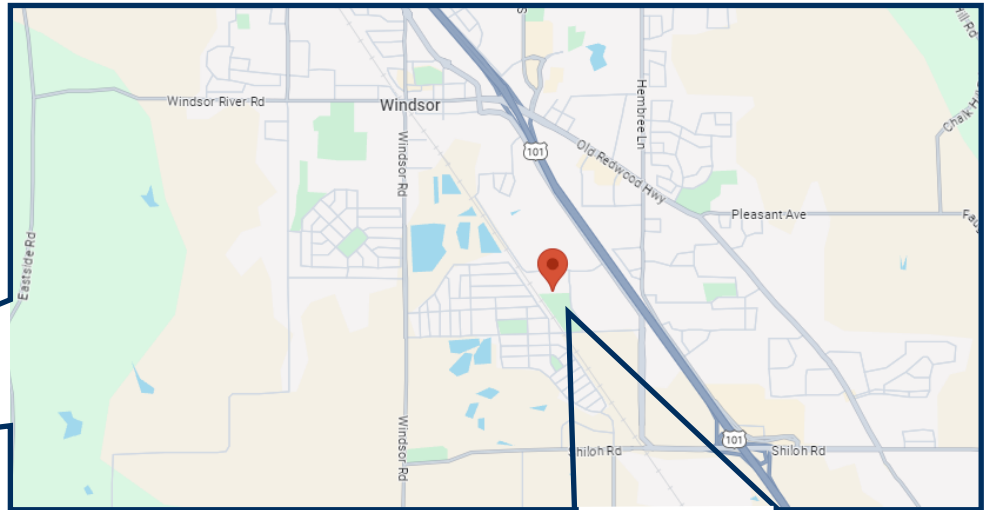
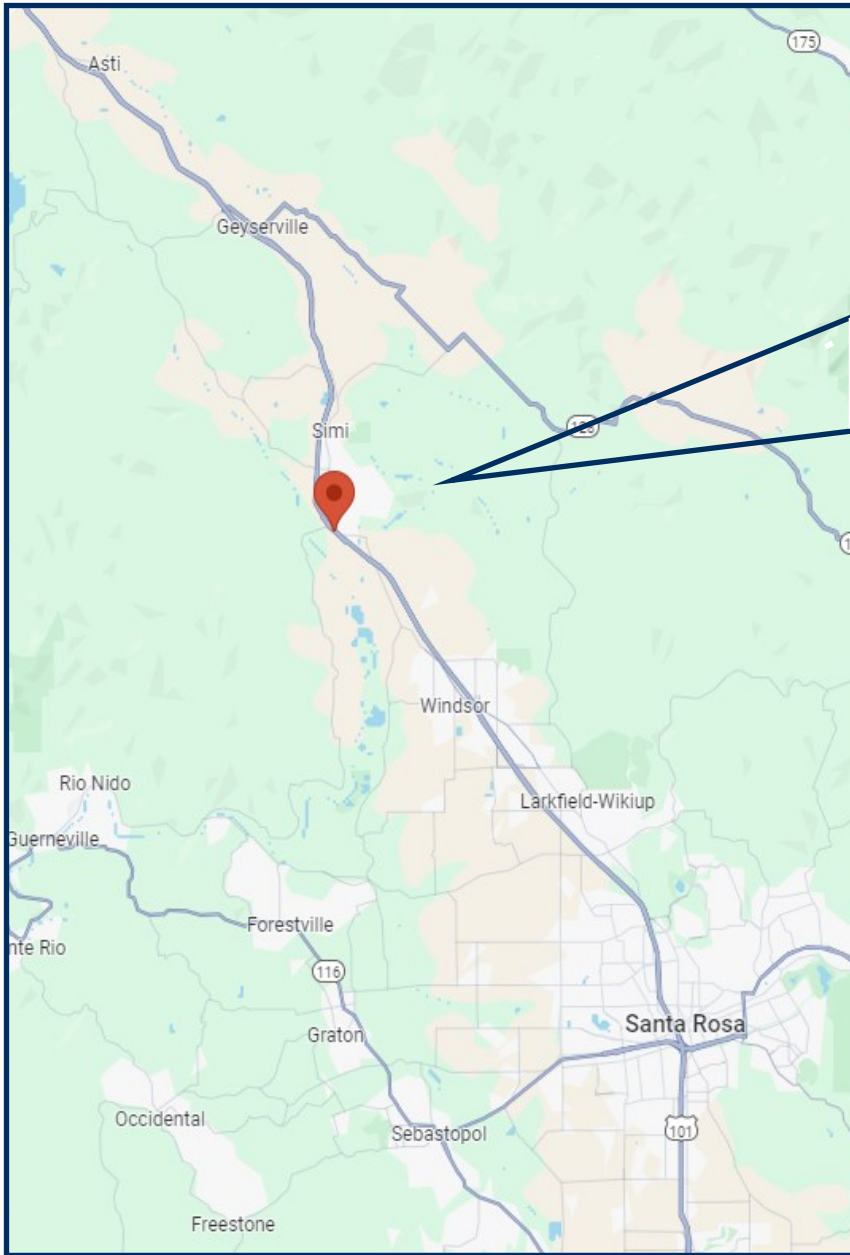

The above information, while not guaranteed, has been secured from sources we believe to be reliable. This is not an offer to sell or lease and is subject to change or withdrawal. Any interested party should verify the status of the property and the information herein.



BROKER TEAM



Nick Abbott, CCIM

CA BRE # 01357548

Direct: 707-529-1722

Office: 707-523-2700

Email: Nabbott@NorthBayProp.com



William Severi, CCIM, CPM

CA BRE # 01000344

Direct: 707-360-4455

Cell: 707-291-2722

Email: William@NorthBayProp.com

North Bay Property Advisors

Santa Rosa Office

2777 Cleveland Ave. Suite 110

Santa Rosa, CA 95403

707-523-2700

www.NorthBayProp.com



NORTHERN CALIFORNIA OFFICES

SANTA ROSA

NOVATO

SONOMA / NAPA

SAN JOSE

SACRAMENTO

WALNUT CREEK

SAN FRANCISCO