

FOR LEASE



2250 EAST 1ST STREET SUITE 100 (FORMER AT&T)

Grimes, Iowa 50111

Retail Space For Lease
2,100 +/- RSF

ANGIE TESSAU, CCIM, SIOR
515.707.6889
angiet@knapplc.com
Licensed in IA

KOREY BIRKENHOLTZ
515.480.6596
korey@knapplc.com
Licensed in IA

2250 EAST 1ST STREET FOR LEASE Suite 100

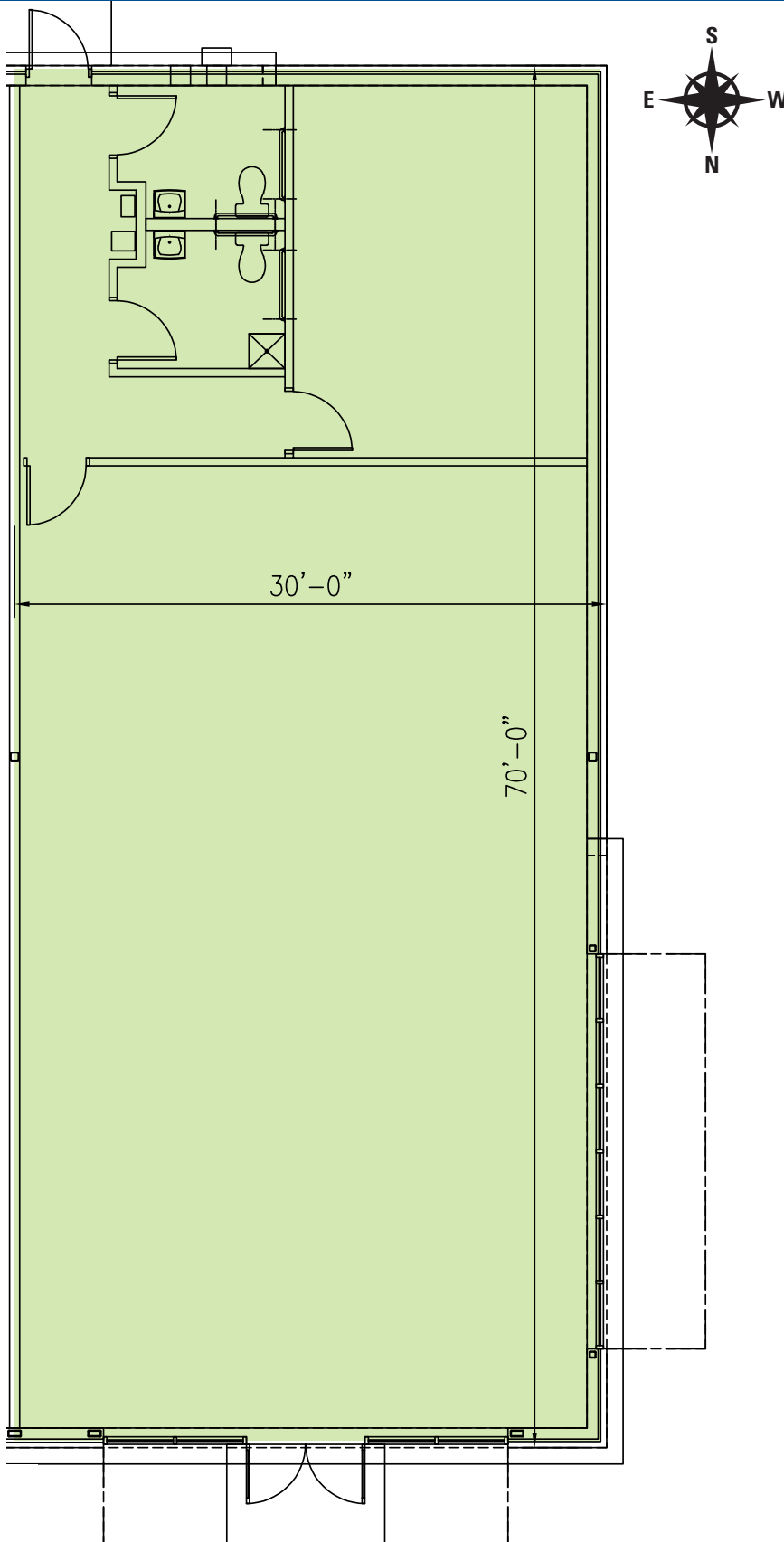

RETAIL SPACE

2,100+/- RSF

Available:

Immediately

Lease Rate:

\$28 PSF NNN

BUILDING HIGHLIGHTS

- End cap
- Abundant parking
- Anchored by Walmart
- Strong restaurant and retail sector
- Up-and-coming location
- Seconds from Hwy 141
- High visibility
- Building signage
- Local ownership with responsive property management
- High traffic counts

ANGIE TESSAU, CCIM, SIOR

angiet@knapplc.com

515.707.6889

Licensed in IA

KOREY BIRKENHOLTZ

korey@knapplc.com

515.480.6596

Licensed in IA

EAST 1ST STREET



2250 EAST 1ST STREET Suite 100



2250 East 1st Street is conveniently located along the flourishing 1st Street in Grimes and has easy access to Highway 141. The space was formerly a restaurant.



RETAIL SPACE



RESTAURANT SPACE



MANAGED BY KNAPP PROPERTIES



PARKING LOT



EXCELLENT LOCATION

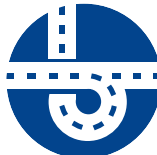

INTERSTATE ACCESS



GROCERY STORE NEARBY



GOLF COURSE NEARBY



C-STORE NEARBY



COFFEE SHOP NEARBY



SCHOOL NEARBY



SPORTSPLEX NEARBY

DEMOGRAPHICS

2250 EAST 1ST STREET

5 mile radius

INCOME



\$101,054

Median Household Income



\$284,156

Median Net Worth



\$297,933

Median Home Value



\$80,608

Median Disposable Income

EDUCATION



53%

Bachelor's/Grad/Prof Degree

BUSINESS



2,976

Total Businesses



48,592

Total Employees

KEY FACTS



80,716

Population



85,048

Total Daytime Population



38.2

Median Age



30,537

Households

TRAFFIC



21,800

East 1st Street

EMPLOYMENT



1.9%

Unemployment Rate

nearby ATTRACTIONS

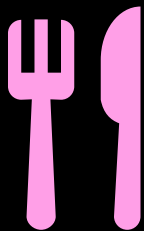

105

Restaurants



10

Bars and
Pubs



12

Coffee
Shops



11

Grocers



38

C-Stores



47

Retail
Shopping



22

Hotels



16

Attractions/
Entertainment

Average Annual Spend per Household on Eating Out



\$458

Breakfast



\$1,396

Lunch



\$2,359

Dinner

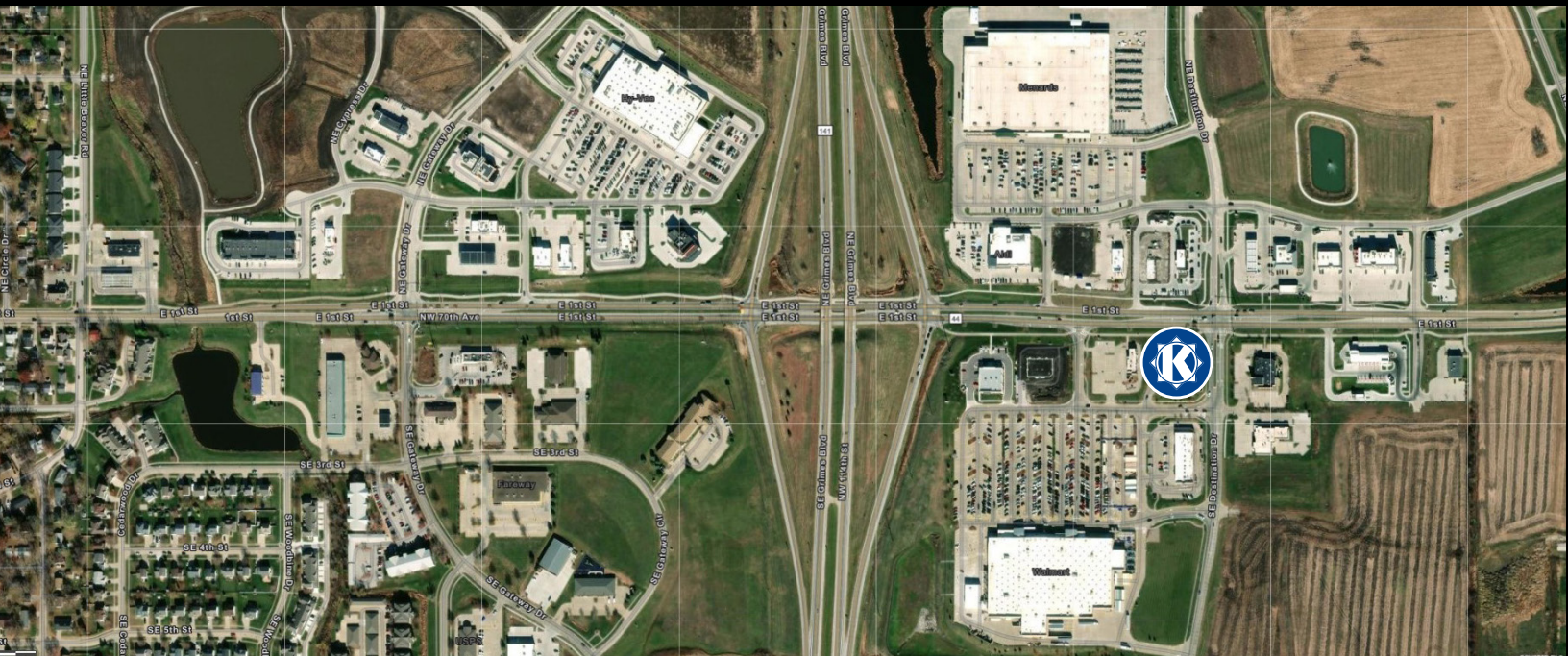



KNAPP
PROPERTIES



FOR LEASE **2250 EAST 1ST STREET**

Grimes, Iowa 50111



ANGIE TESSAU, CCIM, SIOR

515.707.6889

AngieT@KnappLC.com



KOREY BIRKENHOLTZ

515.480.6596

Korey@KnappLC.com

All interested parties acknowledge that neither Seller nor any of Seller's officers or directors, nor Seller's employees, agents, representatives, or any other person or entity acting on behalf of Seller (hereafter, such persons and entities are individually and collectively referred to as the "Seller"), have made any representations, warranties or agreements (express or implied) by or on behalf of Seller as to any matters concerning the Property, the economic results to be obtained or predicted, or the present use thereof or the suitability for the possible intended use of the Property. Any documents furnished by Seller relating to the Property shall be deemed furnished as a courtesy to any interested party but without warranty or representation from Seller. All work done in connection with preparing the Property for the uses intended by any interested party shall be obtained and paid for by, and shall be the sole responsibility of the interested party. All investigations of proposed governmental laws and regulations, including land use laws and regulations to which the Property may be subject, shall be based on the review and determination of the applicability and effect of such laws and regulations by the interested party. Seller makes no representations concerning such laws and regulations.