

This information has been secured from sources we believe are reliable, but we make no representations or warranties, expressed or implied, as to the accuracy of the information. References to condition, square footage or age are approximate. Buyer or Tenant acknowledges that they are relying on their own investigations and are not relying on provided reference information.

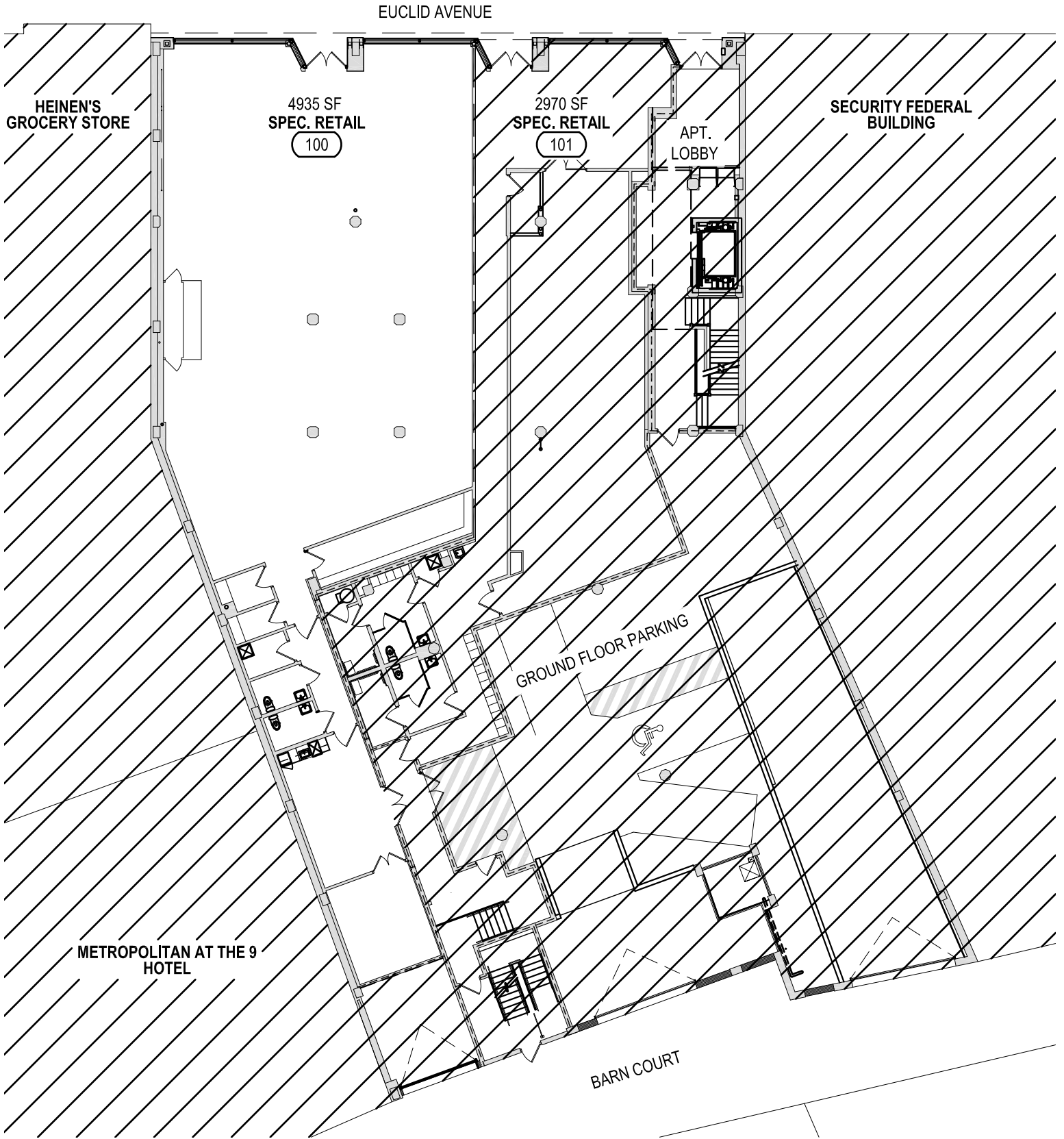

1020 EUCLID AVENUE  
CLEVELAND, OHIO 44115

**THE IVORY ON EUCLID**



FIRST FLOOR PLAN

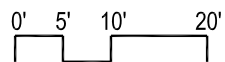

09 AUGUST 2023

**LD01**

This information has been secured from sources we believe are reliable, but we make no representations or warranties, expressed or implied, as to the accuracy of the information. References to condition, square footage or age are approximate. Buyer or Tenant acknowledges that they are relying on their own investigations and are not relying on provided reference information.

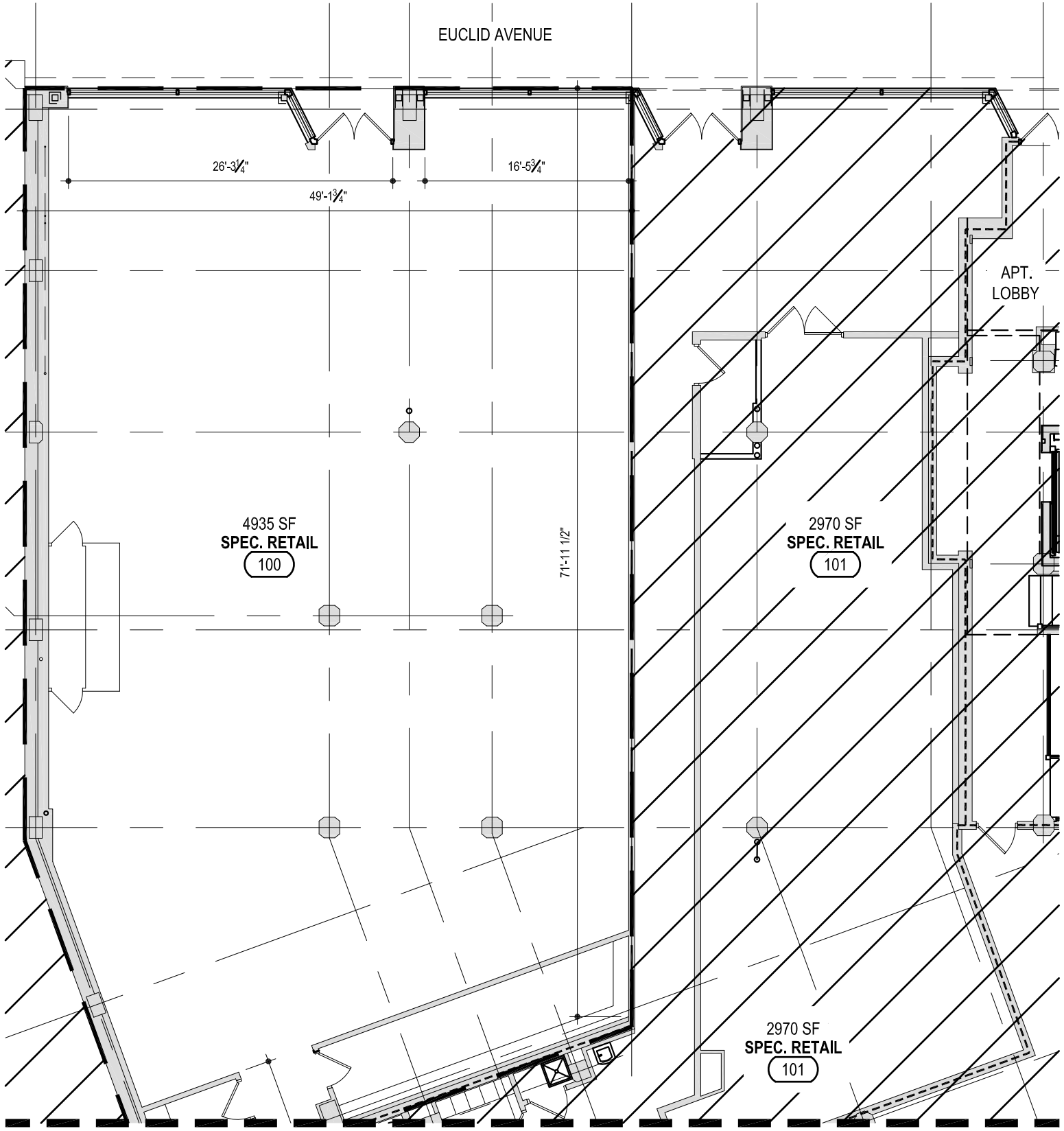

MATCHLINE LD02b



1020 EUCLID AVENUE  
CLEVELAND, OHIO 44115  
**THE IVORY ON EUCLID**



FIRST FLOOR PLAN  
0' 2'-6" 5' 10'

09 AUGUST 2023  
**LD02a**

This information has been secured from sources we believe are reliable, but we make no representations or warranties, expressed or implied, as to the accuracy of the information. References to condition, square footage or age are approximate. Buyer or Tenant acknowledges that they are relying on their own investigations and are not relying on provided reference information.

MATCHLINE LD02a

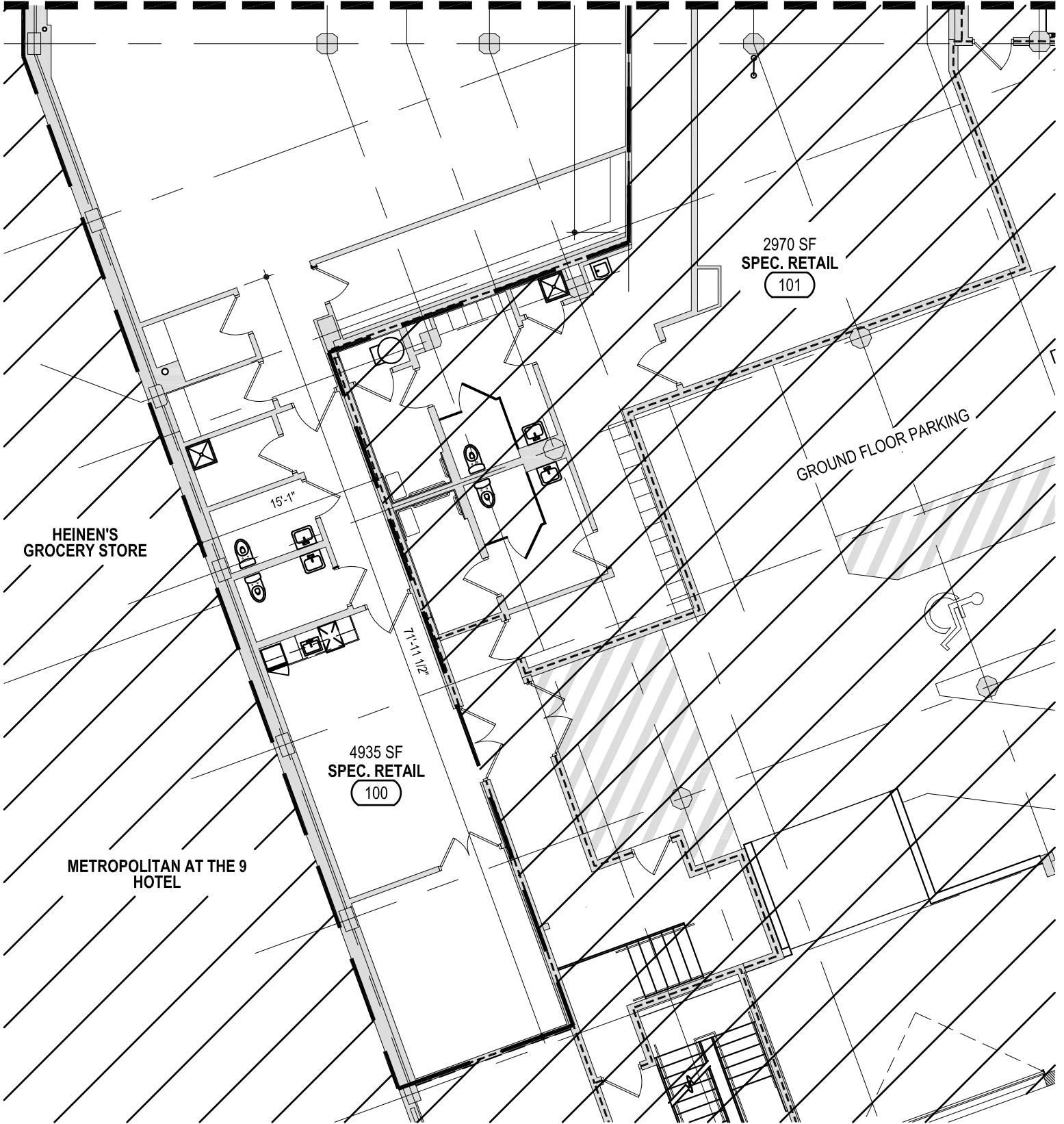

1020 EUCLID AVENUE  
CLEVELAND, OHIO 44115

THE IVORY ON EUCLID



FIRST FLOOR PLAN

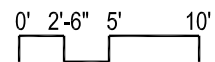

09 AUGUST 2023

LD02b