

**FOR LEASE**

Owned and Operated by



# Hayward Business Park

1495 Zephyr Avenue, Hayward, CA

**±23,424 SF**



**LEASING INFO  
& CONTACT**

**Greig Lagomarsino, SIOR**  
**Mark Maguire, SIOR**

(510) 433-5809 / [greig.lago@colliers.com](mailto:greig.lago@colliers.com)  
(510) 219-7854 / [mark.maguire@colliers.com](mailto:mark.maguire@colliers.com)



This is not an offer or acceptance of an offer to lease space. A lease will only be offered or made in a written agreement signed by landlord. No representation or warranty of any kind is made by landlord unless set forth in a written definitive lease executed by the landlord.

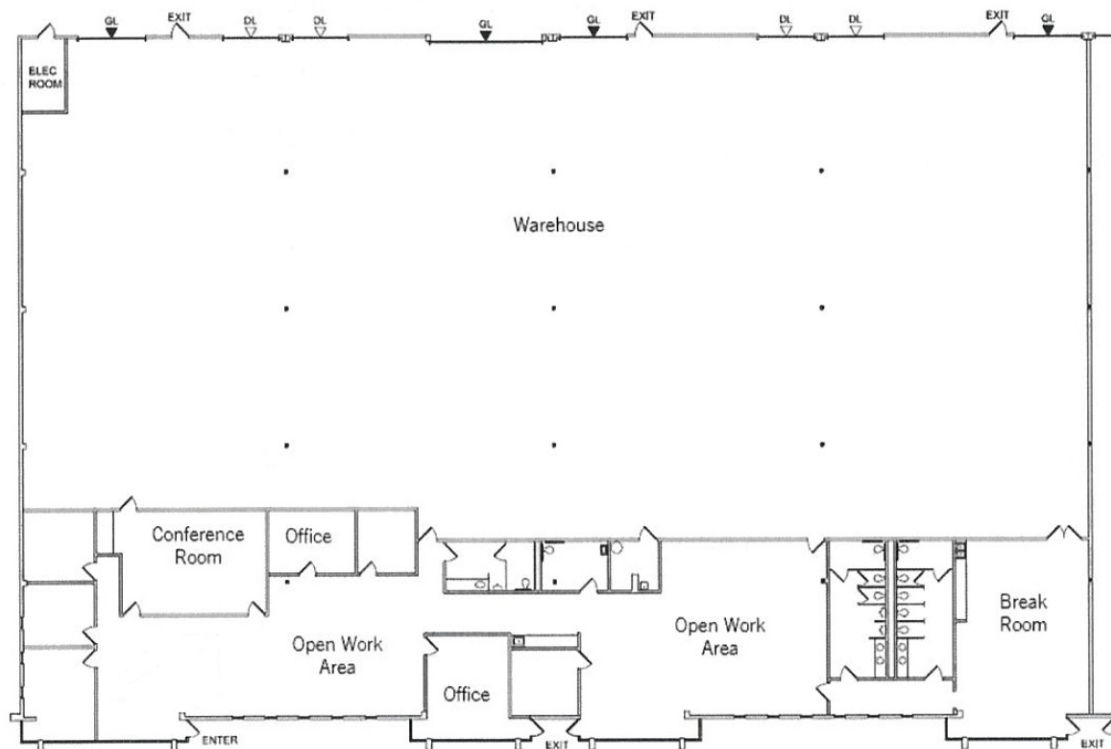

### Property Specifications:

- Corner unit
- ±30% office, balance warehouse space
- Four (4) dock-high doors
- Four (4) grade level doors
- ±18' clear height
- ±1,200 amps @ 120/208V (Tenant to confirm)
- Fully sprinklered
- Easy access to Hwy I-880

**Lease Rate: \$1.40/SF/Month, NNN**  
**(\$0.31/SF/Month, OPEX)**

**Available Now.**  
**Call Brokers for Touring Instructions.**

