

HERITAGE PARK SHOPPING CENTER



FOR LEASE

6160-6300 S. Saginaw Road & 6303-6333 Dort Highway/Grand Blanc, MI



RETAIL OPPORTUNITY

HERITAGE PARK SHOPPING CENTER



Address

6160-6300 S. Saginaw Road &
6303-6333 Dort Highway
Grand Blanc, MI 49439

Availability

949 - 4,462 SF
2.48 AC (Outlot)

Features

Heritage Park is Genesee County's dominant and only power center, boasting 535,000 square feet of retail space, anchored by Walmart, Sam's Club, and Kohl's. Heritage Park has a small shop and out parcel space available for lease. There are multiple ingress and egress points along Saginaw Road and Dort Highway, plus a traffic-controlled entrance. Other tenants include a drive-thru Panera Bread, Aldi, PetSmart, Sally Beauty, Leo's Coney Island, America's Best, and many more.

Co-Tenants



Demographics (2025)

	1 MILES	3 MILES	5 MILES
POPULATION	3,215	43,202	97,800
HOUSEHOLDS	1,316	18,732	41,490
AVG HOUSEHOLD INCOME	\$92,687	\$94,147	\$88,039
DAYTIME POPULATION	6,178	45,707	105,681

HERITAGE PARK SHOPPING CENTER

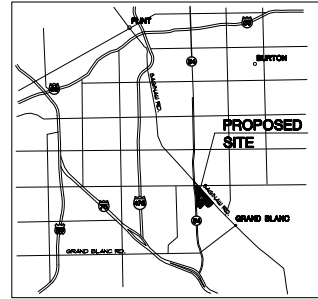
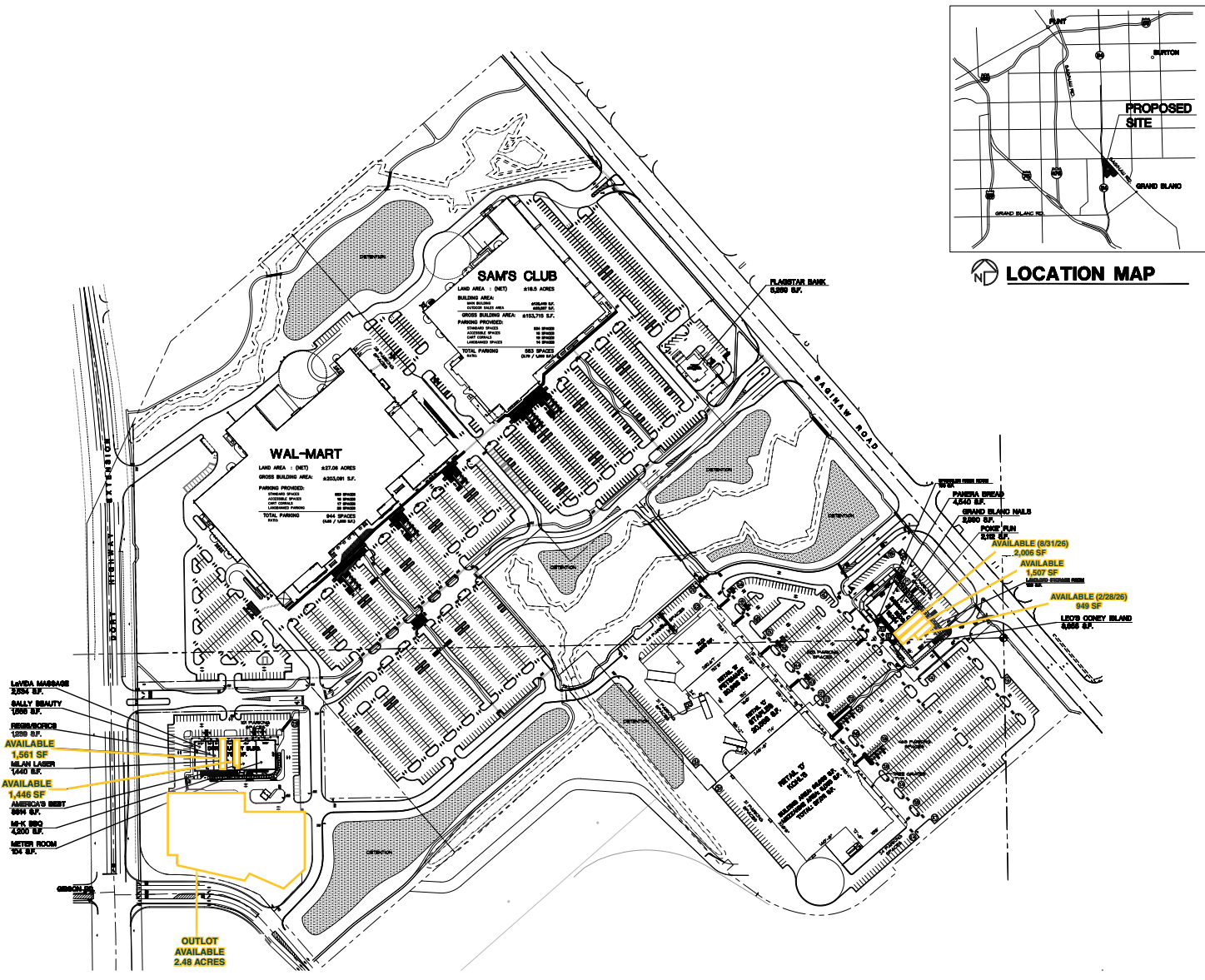

LOCATION MAP

Legend:

LOT 1	2,500 S.F.
LOT 2	2,500 S.F.
LOT 3	2,500 S.F.
LOT 4	2,500 S.F.
LOT 5	2,500 S.F.
LOT 6	2,500 S.F.
LOT 7	2,500 S.F.
LOT 8	2,500 S.F.
LOT 9	2,500 S.F.
LOT 10	2,500 S.F.
LOT 11	2,500 S.F.
LOT 12	2,500 S.F.
LOT 13	2,500 S.F.
LOT 14	2,500 S.F.
LOT 15	2,500 S.F.
LOT 16	2,500 S.F.
LOT 17	2,500 S.F.
LOT 18	2,500 S.F.
LOT 19	2,500 S.F.
LOT 20	2,500 S.F.
LOT 21	2,500 S.F.
LOT 22	2,500 S.F.
LOT 23	2,500 S.F.
LOT 24	2,500 S.F.
LOT 25	2,500 S.F.
LOT 26	2,500 S.F.
LOT 27	2,500 S.F.
LOT 28	2,500 S.F.
LOT 29	2,500 S.F.
LOT 30	2,500 S.F.
LOT 31	2,500 S.F.
LOT 32	2,500 S.F.
LOT 33	2,500 S.F.
LOT 34	2,500 S.F.
LOT 35	2,500 S.F.
LOT 36	2,500 S.F.
LOT 37	2,500 S.F.
LOT 38	2,500 S.F.
LOT 39	2,500 S.F.
LOT 40	2,500 S.F.
LOT 41	2,500 S.F.
LOT 42	2,500 S.F.
LOT 43	2,500 S.F.
LOT 44	2,500 S.F.
LOT 45	2,500 S.F.
LOT 46	2,500 S.F.
LOT 47	2,500 S.F.
LOT 48	2,500 S.F.
LOT 49	2,500 S.F.
LOT 50	2,500 S.F.
LOT 51	2,500 S.F.
LOT 52	2,500 S.F.
LOT 53	2,500 S.F.
LOT 54	2,500 S.F.
LOT 55	2,500 S.F.
LOT 56	2,500 S.F.
LOT 57	2,500 S.F.
LOT 58	2,500 S.F.
LOT 59	2,500 S.F.
LOT 60	2,500 S.F.
LOT 61	2,500 S.F.
LOT 62	2,500 S.F.
LOT 63	2,500 S.F.
LOT 64	2,500 S.F.
LOT 65	2,500 S.F.
LOT 66	2,500 S.F.
LOT 67	2,500 S.F.
LOT 68	2,500 S.F.
LOT 69	2,500 S.F.
LOT 70	2,500 S.F.
LOT 71	2,500 S.F.
LOT 72	2,500 S.F.
LOT 73	2,500 S.F.
LOT 74	2,500 S.F.
LOT 75	2,500 S.F.
LOT 76	2,500 S.F.
LOT 77	2,500 S.F.
LOT 78	2,500 S.F.
LOT 79	2,500 S.F.
LOT 80	2,500 S.F.
LOT 81	2,500 S.F.
LOT 82	2,500 S.F.
LOT 83	2,500 S.F.
LOT 84	2,500 S.F.
LOT 85	2,500 S.F.
LOT 86	2,500 S.F.
LOT 87	2,500 S.F.
LOT 88	2,500 S.F.
LOT 89	2,500 S.F.
LOT 90	2,500 S.F.
LOT 91	2,500 S.F.
LOT 92	2,500 S.F.
LOT 93	2,500 S.F.
LOT 94	2,500 S.F.
LOT 95	2,500 S.F.
LOT 96	2,500 S.F.
LOT 97	2,500 S.F.
LOT 98	2,500 S.F.
LOT 99	2,500 S.F.
LOT 100	2,500 S.F.

Heritage Park
 Grand Blanc, Troy, Michigan

ROGVOIJ ARCHITECTS
 2840 THIRTEEN MILE ROAD SUITE 200
 FARMINGTON HILLS, MI 48334
 (248) 855-1000
 (248) 855-0915 fax

developer:
 2840 THIRTEEN MILE ROAD SUITE 200
 FARMINGTON HILLS, MI 48334
 (248) 855-1000
 (248) 855-0915 fax

drawn:
 Lease Plan

DO NOT SCALE DRAWING
 Issue Date: 0 MAY 08
 Drawn: S.V.
 Checked: M.D.
 Approved: M.D.

No number: 03080
 sheet

HERITAGE PARK SHOPPING CENTER

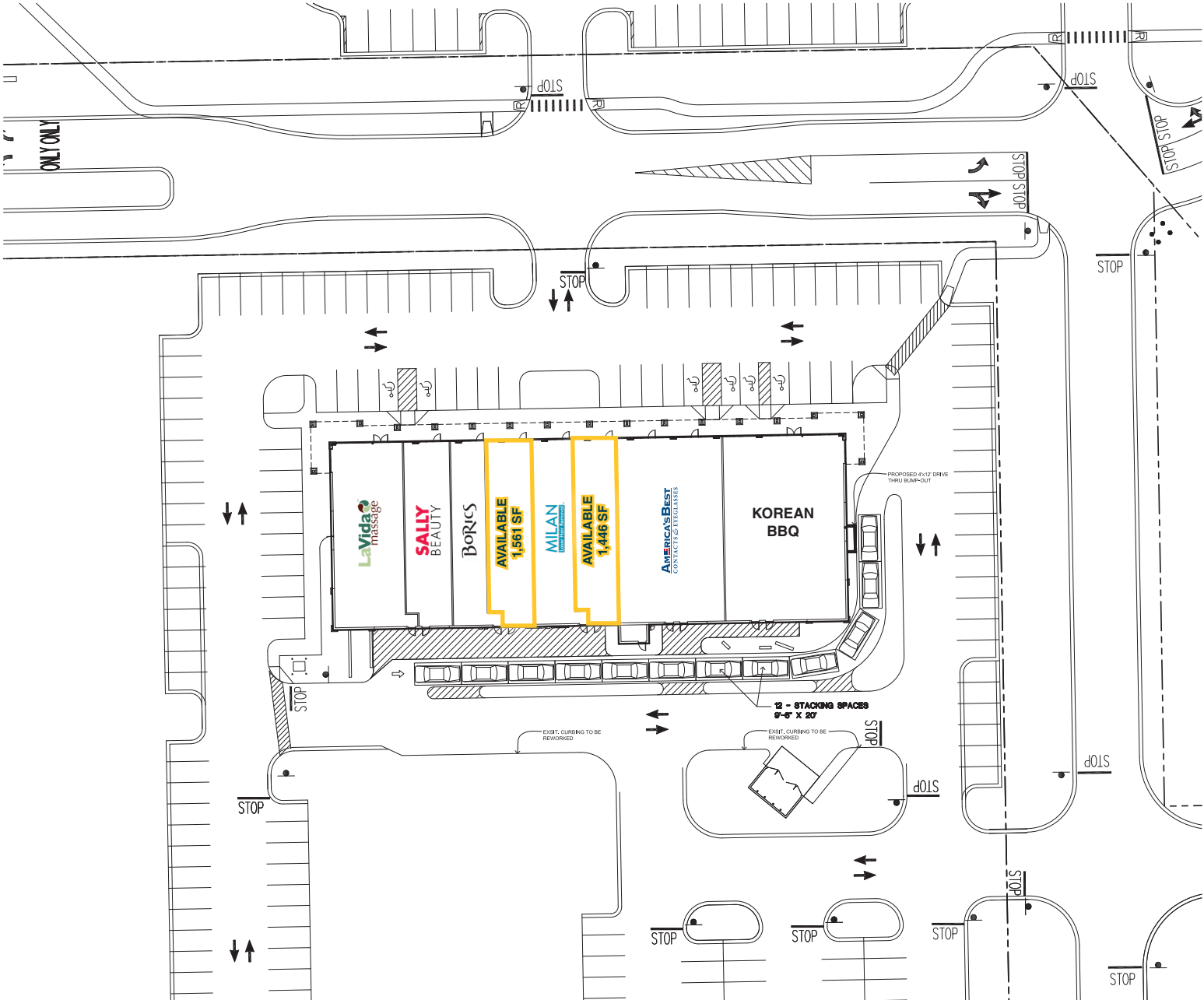

HERITAGE PARK SHOPPING CENTER



HERITAGE PARK SHOPPING CENTER



HERITAGE PARK SHOPPING CENTER



Eric
Unatin

Mid-America Real Estate -
Michigan, Inc.
T: 248.855.6800
EUnatin@MidAmericaGrp.com

Eric
Birnholtz

Mid-America Real Estate -
Michigan, Inc.
T: 248.855.6800
EBirnholtz@MidAmericaGrp.com



38500 Woodward Ave, Suite 100
Bloomfield Hills, Michigan 48304
248.855.6800
MidAmericaGrp.com

CONTACT