

1365 W. BUSINESS PARK DRIVE

FOR LEASE



PROPERTY DETAILS

1365 W. Business Park Drive, Ste. 100, Orem, Utah 84058

- For Lease: 5,050 sq. ft.
- Listing Price: \$23.50/Full Service
- The floor plan consists of seven hard wall-offices, one conference room, break room, open workspace and training facility
- Abundant parking
- Ideally located on the edge of Orem, Vineyard, and Provo
- Across from the UTA FrontRunner Station in Orem
- Quick access to I-15
- Minutes away from UVU

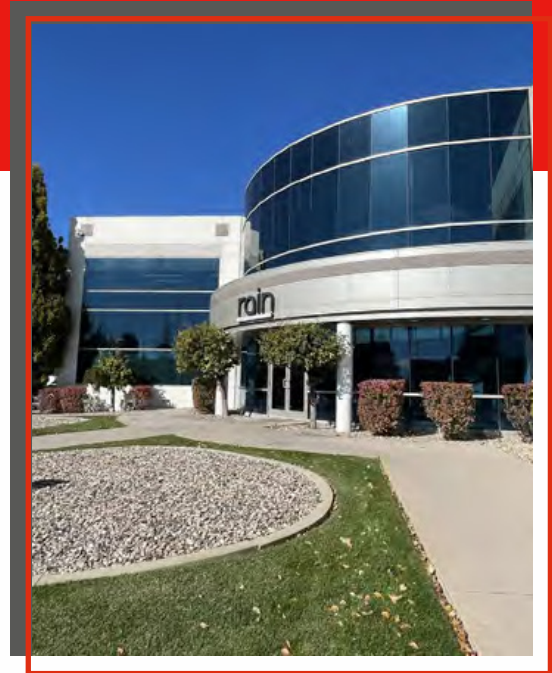

CODY BLACK

cody@summitutahcre.com

direct: 801.687.0094

office: 801.435.5005

[View Profile](#)

FULL SERVICE COMMERCIAL REAL ESTATE 1875 S State St. Suite 1000, P.O. Box 970432, Orem, UT 84097

1365 W. Business Park Drive

FLOOR PLAN

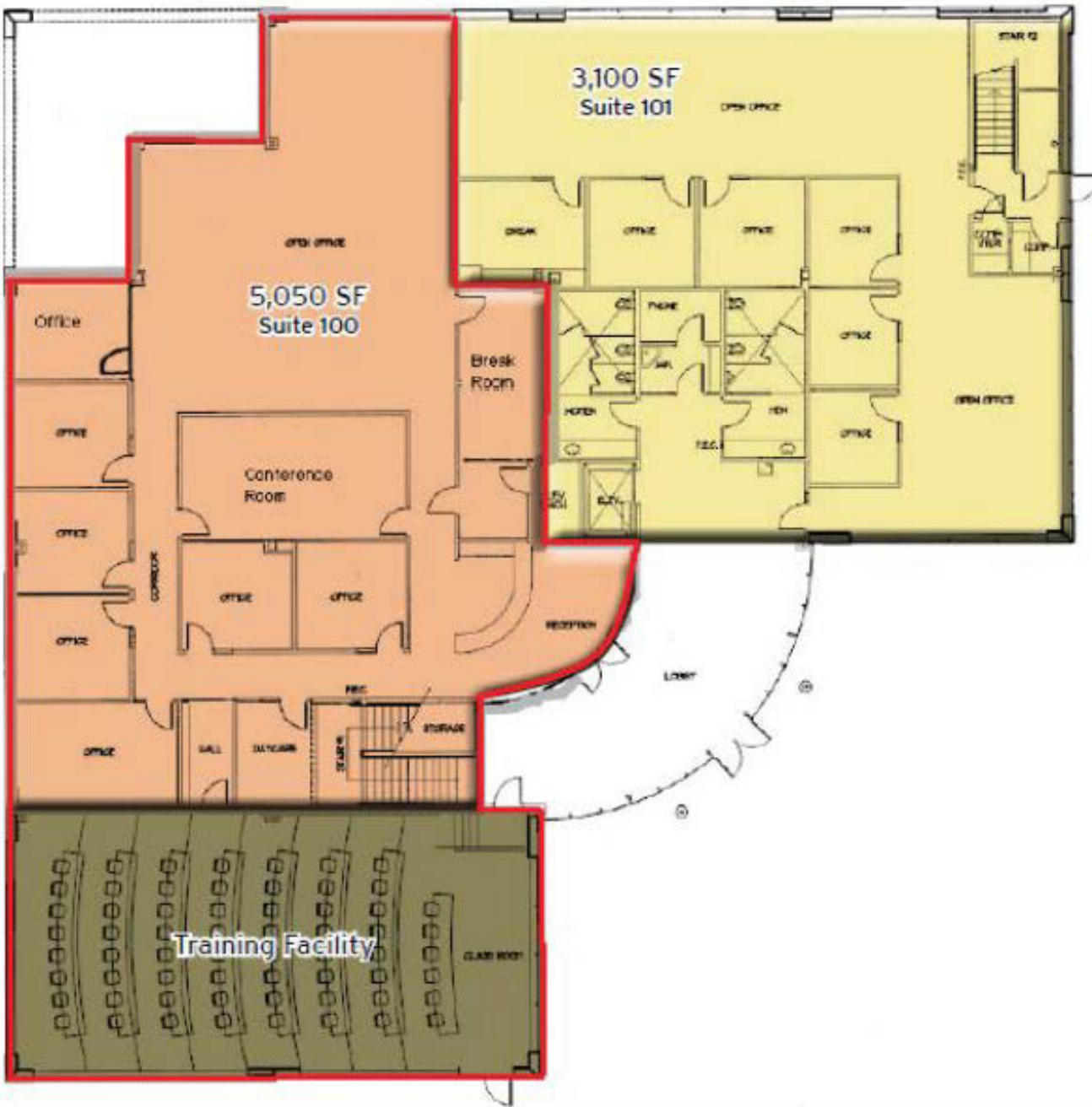

CODY BLACK

cody@summitutahcre.com

direct: 801.687.0094

office: 801.435.5005

[View Profile](#)

FULL SERVICE COMMERCIAL REAL ESTATE 1875 S State St. Suite 1000, P.O. Box 970432 ,Orem, UT 84097

This statement with the information it contains is given with the understanding that all negotiations relating to the purchase, renting or leasing of the property described above shall be conducted through this office.



CODY BLACK

cody@summitutahcre.com

direct: 801.687.0094

office: 801.435.5005

[View Profile](#)

FULL SERVICE COMMERCIAL REAL ESTATE 1875 S State St. Suite 1000, P.O. Box 970432 ,Orem, UT 84097

This statement with the information it contains is given with the understanding that all negotiations relating to the purchase, renting or leasing of the property described above shall be conducted through this office.