

# FOR SALE



INLAND  
EMPIRE

## ±36,144 SQ.FT. INDUSTRIAL BUILDING 444 ATHOL ST., SAN BERNARDINO, CA 92401



### PROPERTY FEATURES

**Building Size:** ±36,144 Sq.Ft

**Lot Size:** ±1.72 – Acres (±75,054 Sq.Ft.)

**APN:** 0136-122-43-0000

**Zoning:** Industrial Light (IL) per the City of San Bernardino, CA

### PROPERTY HIGHLIGHTS

- ±3,432sq.ft. Office Space
- ±18' Clear Height
- 3 – Dock High Doors
- 1 Interior Truck Well
- 5 – Ground Level Doors
- ±1,200 AMPS (verify)
- Paved Yard
- Great Access to I-215 Freeway and Minutes to I-10 & 210 Freeway

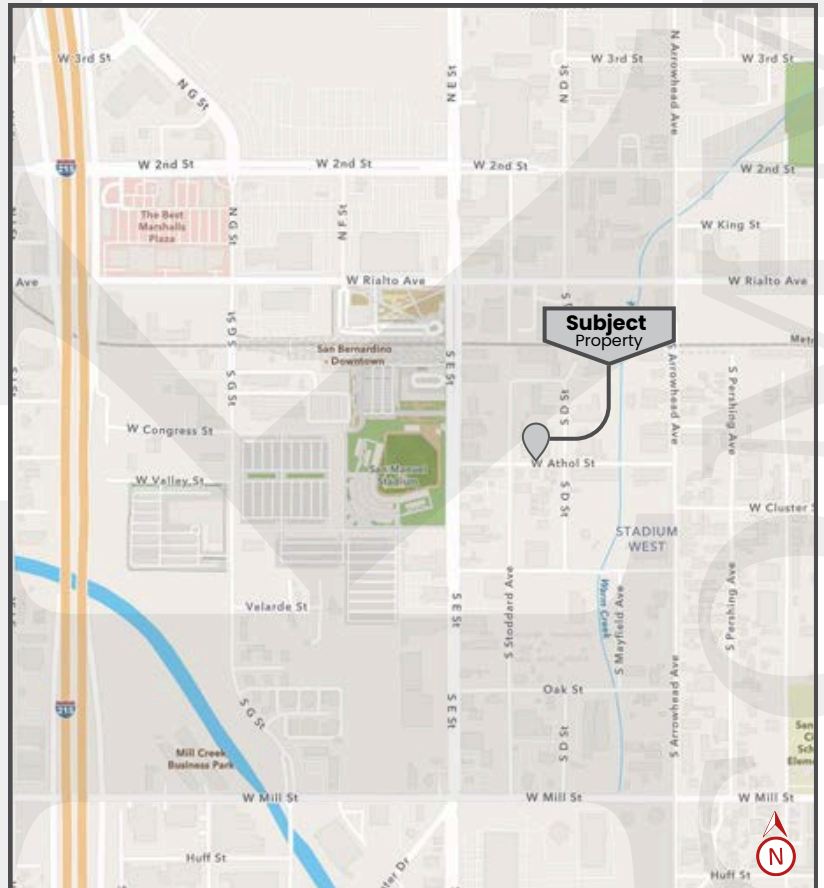



**FOR SALE**



**INLAND  
EMPIRE**

**±36,144 SQ.FT. INDUSTRIAL BUILDING**  
**444 ATHOL ST., SAN BERNARDINO, CA 92401**

**ADDITIONAL PICTURES**

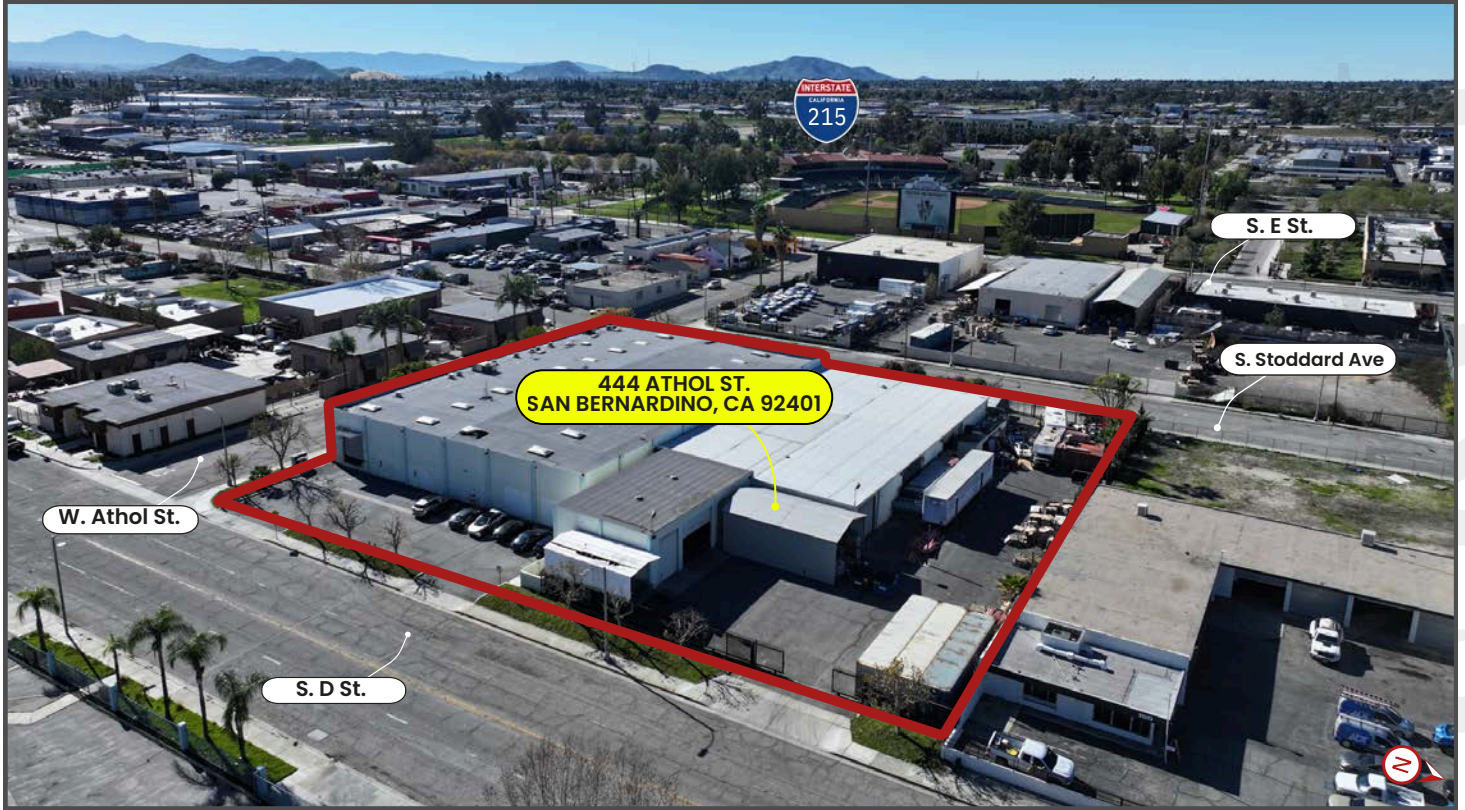

**FOR SALE**

**±36,144 SQ.FT. INDUSTRIAL BUILDING**

**444 ATHOL ST., SAN BERNARDINO, CA 92401**



**INLAND  
EMPIRE**



**Rene Ramos, Jr.**  
T(909) 980-6868  
Rene.Ramos@kwcommercial.com  
CaDRE Lic. #01836872

**Jacob B. Bernardy**  
T(909) 935-0935  
Jacob.Bernardy@kwcommercial.com  
CaDRE Lic. #02039512

**Robert D. Bagley III**  
T(909) 935-0938  
robert.bagley@kwcommercial.com  
CaDRE Lic. #02131874

**Daniel W. Richards**  
T(909) 243-7747 x 22  
Daniel.Richards@kwcommercial.com  
CaDRE Lic. #00803221



*WE OBTAINED THE INFORMATION ABOVE FROM SOURCES WE BELIEVE TO BE RELIABLE. HOWEVER, WE HAVE NOT VERIFIED ITS ACCURACY AND MAKE NO GUARANTEE, WARRANTY, OR REPRESENTATION ABOUT IT. IT IS SUBMITTED SUBJECT TO THE POSSIBILITY OF ERRORS, OMISSIONS, CHANGE OF PRICE, RENTAL OR OTHER CONDITIONS, PRIOR SALE, LEASE OR FINANCING, OR WITHDRAWAL WITHOUT NOTICE. WE INCLUDE PROJECTIONS, OPINIONS, ASSUMPTIONS OR ESTIMATES FOR EXAMPLE ONLY, AND THEY MAY NOT REPRESENT CURRENT OR FUTURE PERFORMANCE OF THE PROPERTY. YOU AND YOUR TAX AND LEGAL ADVISORS SHOULD CONDUCT YOUR OWN INVESTIGATION OF THE PROPERTY AND TRANSACTION.*

**KW COMMERCIAL- INLAND EMPIRE**

3595-1 Inland Empire Blvd.

Suite 1250

Ontario, CA 91764

**909.980.6868**

www.kwcie.com