

AVAILABLE FOR LEASE  
2,630± SF OFFICE BUILDING

1433 E. EL MONTE WAY  
DINUBA, CA

*For information, please contact:*

**JOHN AKERS**  
ZEEB COMMERCIAL REAL ESTATE  
t 559-625-2128  
john@zeebre.com  
CA RE Lic. #00871521

**MICHAEL R. PORTE**  
NEWMARK PEARSON COMMERCIAL  
t 559-972-2421  
mporte@pearsonrealty.com  
CA RE Lic. #01075873

**ZEEB**  
PEARSON COMMERCIAL

**NEWMARK**  
PEARSON COMMERCIAL

*Independently Owned and Operated* | Corporate License #00020875 | [zeebre.com](http://zeebre.com) | [newmarkpearson.com](http://newmarkpearson.com)

**OFFICE:** 3447 S. Demaree St., Visalia, CA 93277, t 559-625-2128

The distributor of this communication is performing acts for which a real estate license is required. The information contained herein has been obtained from sources deemed reliable but has not been verified and no guarantee, warranty or representation, either express or implied, is made with respect to such information. Terms of sale or lease and availability are subject to change or withdrawal without notice.



**1433 E. EL MONTE WAY**  
DINUBA, CA

**AVAILABLE FOR LEASE**  
OFFICE BUILDING

**Building Size:** 2,630± SF  
**Cross Streets:** Palm Drive  
**Property Type:** Professional Office Building  
**Year Built:** 1982  
**Zoning:** PO (*Professional Office*)  
**APN:** 014-243-014 (*Tulare County*)

#### PROPERTY DESCRIPTION

Free standing Professional Office Building in office park with onsite parking. Central location in Dinuba to serve clients from Dinuba and rural adjacent areas. Short distance from downtown and nearby shopping centers. Most recently used as a medical office. Building includes 5 private offices, large bull pen area with nice modular partitions creating more work stations. Also includes two front doors to provide multiple services offered from one suite.

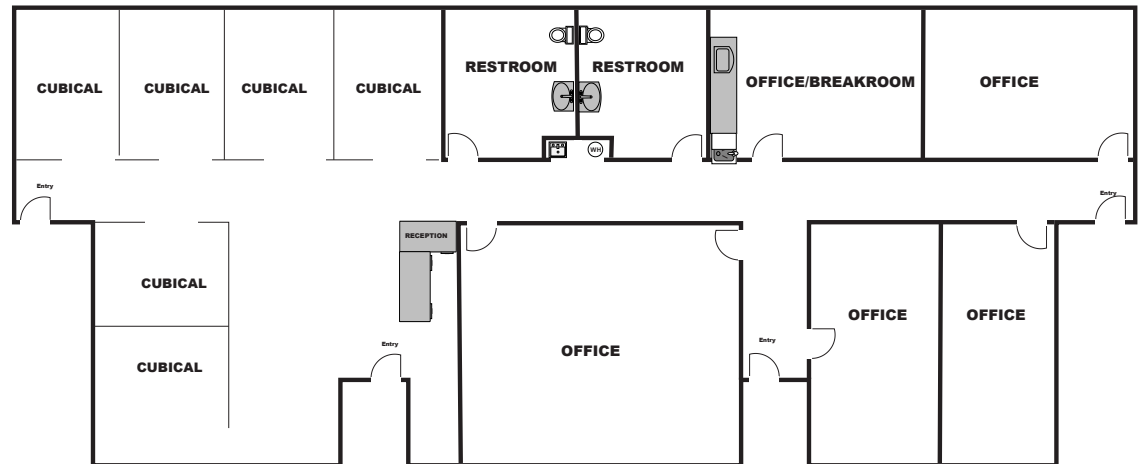

**\$3,698**  
MONTHLY



**Gross**  
LEASE RATE





**1433 E. EL MONTE WAY**  
DINUBA, CA

**PROPERTY**  
INTERIOR PHOTOS







*For information, please contact:*

**JOHN AKERS**  
ZEEB COMMERCIAL REAL ESTATE  
T 559-625-2128  
JOHN@ZEEBRE.COM  
CA RE Lic. #00871521

**MICHAEL R. PORTE**  
NEWMARK PEARSON COMMERCIAL  
T 559-972-2421  
MPORTE@PEARSONREALTY.COM  
CA RE Lic. #01075873

**ZEEB**  
PEARSON COMMERCIAL

**NEWMARK**  
PEARSON COMMERCIAL

*Independently Owned and Operated* | Corporate License #00020875 | [zeebre.com](http://zeebre.com) | [newmarkpearson.com](http://newmarkpearson.com)

OFFICE: 3447 S. Demaree St., Visalia, CA 93277, t 559-625-2128

The distributor of this communication is performing acts for which a real estate license is required. The information contained herein has been obtained from sources deemed reliable but has not been verified and no guarantee, warranty or representation, either express or implied, is made with respect to such information. Terms of sale or lease and availability are subject to change or withdrawal without notice.