

LAUREL STREET



SHEET NOTES

- 01 PROPERTY LINE
- 02 RELOCATE FDC AND TESTING CONNECTIONS. RE: PLUMBING AND CIVIL
- 03 BIKE RACKS. RE: CIVIL AND LANDSCAPE
- 04 ADA RAMP ACCESS TO PLAZA. RE: CIVIL AND LANDSCAPE
- 05 PLANTERS. RE: LANDSCAPE
- 06 AREA DRAINS. RE: CIVIL
- 07 EXISTING PLANTERS TO REMAIN
- 08 EXISTING BENCHES TO REMAIN
- 09 BOUNDARY OF PLAZA DEMOLITION. RE: P1-D1.101 AND LANDSCAPE
- 10 EXISTING MONUMENTAL SKYLIGHTS TO REMAIN
- 11 RETAINING WALLS. RE: CIVIL AND LANDSCAPE

WAMPOLD COMPANIES

SOUTH TOWER
451 Florida Street Baton Rouge LA 70801

Gensler

909 Fannin Street
Suite 200
Houston, TX 77010
United States
Tel 713.844.0000
Fax 713.844.0001

Lang Lighting Design, inc.
120 Knox Place
4645 N. Central Expressway
Dallas, TX 75205
Tel 214.760.0700

SLR International Corporation
6001 Savoy Drive
Suite 215
Houston, TX 77036
Tel 713.789.9400

Walter P Moore
1301 McKinney
Suite 1100
Houston, TX 77010
Tel 713.630.7300

Stantec Consulting Services, Inc.
1200 Brickyard Lane
Suite 400
Baton Rouge, LA 70802
Tel 225.215.5171

Cermak Peterka Petersen
2400 Midpoint Drive
Suite 150
Fort Collins, CO 80524
Tel 970.221.3371

MKT Consulting
1923 Washington Ave
Houston, TX 77007
Tel 832.628.1023

TBG
1333 West Loop South
Suite 1450
Houston, TX 77027
Tel 713.439.0027

AST Engineers
8417 Kelwood Avenue
Baton Rouge, LA 70806
Tel 225.926.5600

Building Leakage Investigation & Testing
8151 East Bay Blvd
Navarre, FL 32566
Tel 850.685.6023

Barbre Consulting, Inc.
322 Spring Hill Drive
Suite A500
The Woodlands, TX 77386
Tel 281.466.8020

GENERAL NOTES

Date	Description
05.08.2020	PHASE 1 - 50% DESIGN DEVELOPMENT
05.22.2020	PHASE 1 - 100% DESIGN DEVELOPMENT
06.19.2020	PHASE 1 - 50% CONSTRUCTION DOCUMENTATION
07.31.2020	PHASE 1 - ISSUE FOR PERMIT & PRICING
4 03.01.2021	PHASE 1 - ISSUE FOR CONSTRUCTION

Seal / Signature

Project Name
SOUTH TOWER

Project Number
02.8789.000

Description
ARCHITECTURAL SITE PLAN

Scale
1/16" = 1'-0" Ref North

P1-A0.001

KEY PLAN

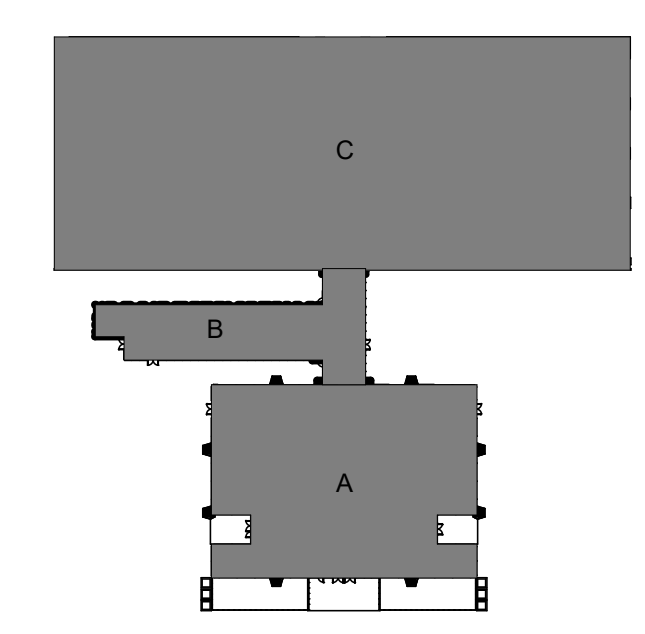

3/12/2021 7:14:23 PM BIM-360://002.8789.000 - Chase Tower Conversion/02.8789.000 - A.Chase_Tower_Conversion_0201.rvt