

Poplar Avenue

2847 Poplar Ave., Ste. 103 | Memphis, TN 38111

1,980± SF | Available

Medical Office for Sublease

Available

Monument
Signage



Colliers presents, for sublease, this mixed-use 1,980± square foot space at 2847 Poplar Avenue in Memphis, Tennessee. Anchored by Xfinity, the highly visible lot is at the corner of Humes and Poplar Avenue. This location offers exceptional visibility, monument signage, two access points and has 674 businesses with 70% white-collar workers within a one mile radius.

Colliers

VIEW ONLINE 

colliers.com/memphis

ED THOMAS, CCIM

VP Retail & Multifamily Services
901 312 4912
ed.thomas@colliers.com

ANDREW PHILLIPS, SIOR, CCIM

President, Brokerage Services | Principal
901 312 4916
andrew.phillips@colliers.com



Accelerating success.

Sublease



2847 POPLAR AVE., STE. 103 FLOORPLAN

- Exam rooms
- Offices/reception area
- Waiting room
- Storage
- Breakroom
- Restrooms
- Medical assistant station
- Medical lab
- Hallway

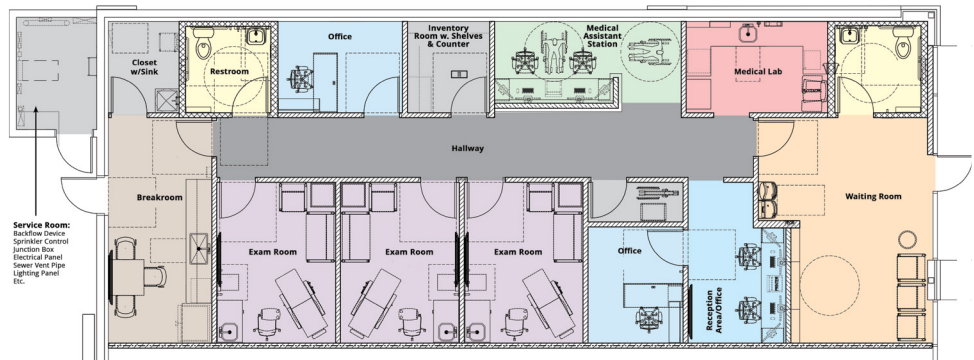

2023 DEMOGRAPHICS

Population
 1-mile: 10,712
 3-miles: 107,120
 5-miles: 233,394

Average HH Income
 1-mile: \$92,788
 3-miles: \$81,973
 5-miles: \$72,685

Households
 1-mile: 4,601
 3-miles: 48,101
 5-miles: 100,029

Total Businesses
 1-mile: 674
 3-miles: 3,962
 5-miles: 9,688

Daytime Population
 1-mile: 9,366
 3-miles: 63,031
 5-miles: 164,720

Total Employees
 1-mile: 7,801
 3-miles: 50,799
 5-miles: 167,249

PROPERTY FEATURES

- Downtown/Midtown submarket
- 1,980± SF
- 3 exam rooms
- 2 offices
- Waiting room/reception area
- Medical assistant station
- Medical lab
- CMU-1 zoning
- Monument signage
- Exceptional visibility
- Corner lot with traffic signal
- Anchored by Xfinity
- 36 parking spaces
- 2 access points



COLLIERS
 6363 Poplar Ave., Suite 220
 Memphis, Tn
 901 375 4800
colliers.com/memphis

Copyright © 2024 Colliers International. Information herein has been obtained from sources deemed reliable, however its accuracy cannot be guaranteed. The user is required to conduct their own due diligence and verification.