

FOR LEASE

Broadcast Court Industrial Complex

2375 Broadcast Court, Cocoa, FL 32922

PROPERTY FACTS

Building Area:	21,290 Sq. Ft.
Construction Type:	Enamel Steel & Masonry
Year Built:	1964
Traffic Count:	19,400 ADT
Roof:	Metal Roof
Zoning:	Industrial Light
Lease Type:	Modified Gross

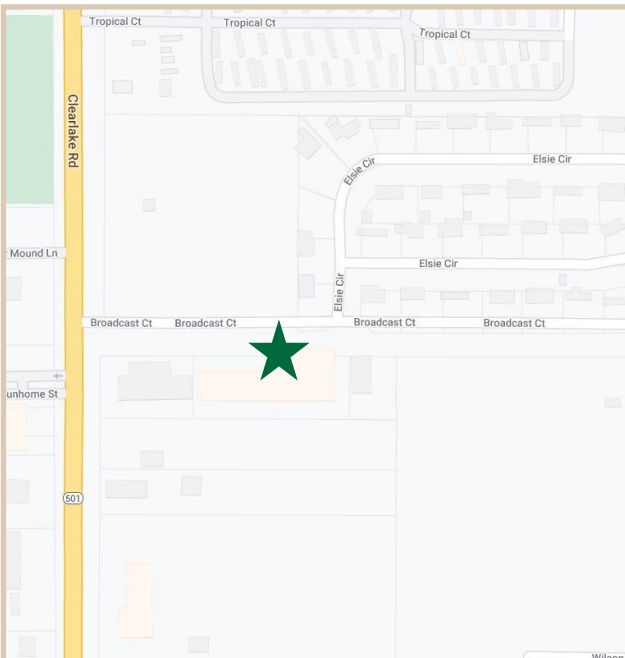

PROPERTY HIGHLIGHTS

Price	We have the best value for the price in this area.
Location	Conveniently located near 520 and 528, providing direct access to Orlando and densely populated beachside Communities. Directly south of Eastern State College, University of Central Florida, and Florida Solar Energy.
Frontage:	This Property has 324.7 feet of frontage.



CHARLES A. VON STEIN, INC.
*Commercial Property Management,
Sales & Leasing Specialists since 1963*
626 Old Dixie Highway SW
Vero Beach, FL 32962
www.vscrc.com

CONTACT INFO:

Brevard County:	321.725.1961
Indian River County:	772.778.4885
Fax:	772.778.4908
Leasing:	leasing@vscrc.com

ALL INFORMATION FURNISHED REGARDING PROPERTY FOR SALE, RENTAL OR FINANCING SOURCES DEEMED RELIABLE, BUT NO WARRANTY OR REPRESENTATION IS MADE AS TO THE ACCURACY THEREOF AND SAME IS SUBMITTED SUBJECT TO ERRORS, OMISSIONS, CHANGE OF PRICE, RENTAL OR OTHER CONDITIONS, PRIOR SALE, LEASING OR FINANCING OR WITHDRAWAL WITHOUT NOTICE.

Siteplan

Broadcast Court Industrial Complex

2375 Broadcast Court, Cocoa, FL 32922

Broadcast Court

Unit 101

Unit
121

Unit
116

Unit 111

Unit 106



CHARLES A. VON STEIN, INC.
*Commercial Property Management,
Sales & Leasing Specialists since 1963*
626 Old Dixie Highway SW
Vero Beach, FL 32962
www.vscore.com

CONTACT INFO:
Brevard County: 321.725.1961
Indian River County: 772.778.4885
Fax: 772.778.4908
Leasing: leasing@vscre.com

UNITS FOR LEASE

Broadcast Court Industrial Complex

2375 Broadcast Court, Cocoa, FL 32922

UNIT	SIZE	RATE	OVERHEAD DOORS		POWER			MAX. CEILING HEIGHT	% OFFICE SPACE	% HVAC	Overhead Door Height
			DRIVE IN	DOCK HEIGHT	A	V	Ph				
106	6,250 SF	\$7.00 PSF/YR	3	0				11"5"	0%	0%	10 Ft



CHARLES A. VON STEIN, INC.
Commercial Property Management,
Sales & Leasing Specialists since 1963
626 Old Dixie Highway SW

CONTACT INFO:
Brevard County: 321.725.1961
Indian River County: 772.778.4885

Floorplan

Broadcast Court Industrial Complex

2375 Broadcast Court, Cocoa, FL 32922

North

798 CLEARLAKE ROAD WAREHOUSE, LLC.

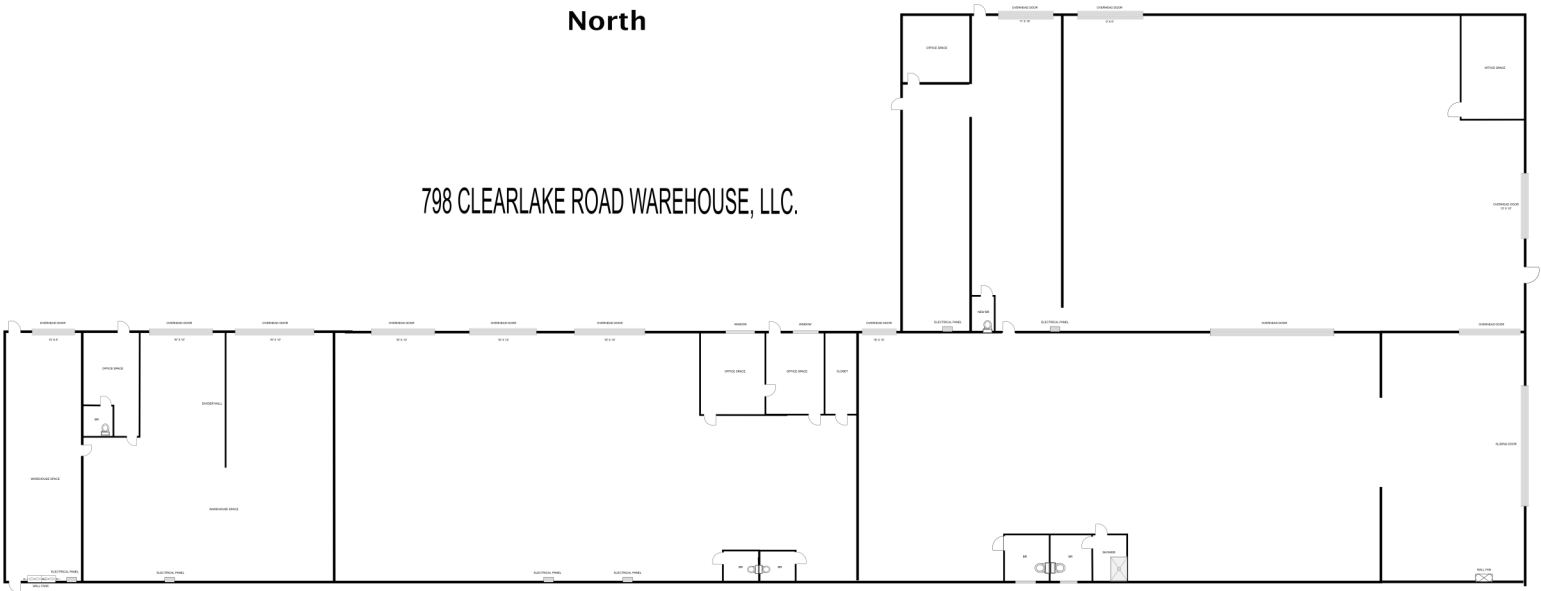

CHARLES A. VON STEIN, INC.
*Commercial Property Management,
Sales & Leasing Specialists since 1963*
626 Old Dixie Highway SW
Vero Beach, FL 32962
www.vscore.com

CONTACT INFO:
Brevard County: 321.725.1961
Indian River County: 772.778.4885
Fax: 772.778.4908
Leasing: leasing@vscre.com

Floorplan

Units 106

Broadcast Court Industrial Complex

2375 Broadcast Court, Cocoa, FL 32922

North

798 CLEARLAKE ROAD WAREHOUSE, LLC.

Unit 106

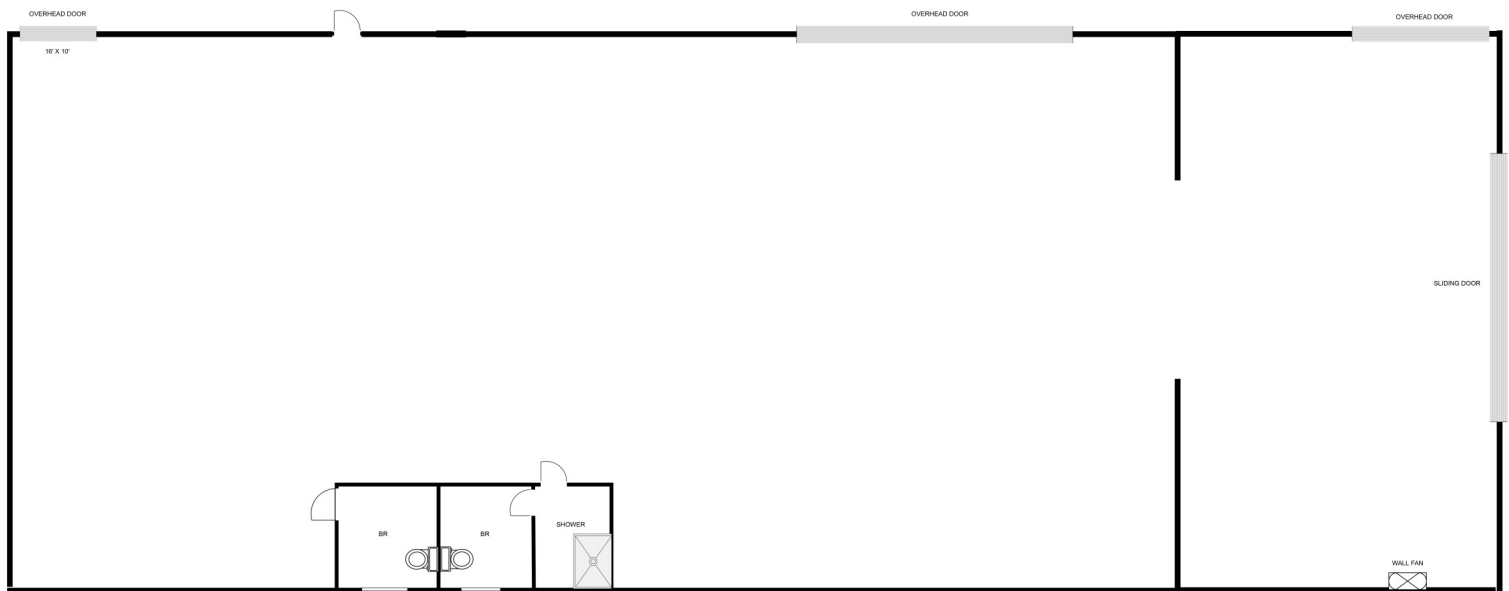

6,250 SF



CHARLES A. VON STEIN, INC.

*Commercial Property Management,
Sales & Leasing Specialists since 1963*
626 Old Dixie Highway SW
Vero Beach, FL 32962
www.vscrc.com

CONTACT INFO:

Brevard County:	321.725.1961
Indian River County:	772.778.4885
Fax:	772.778.4908
Leasing:	leasing@vscrc.com

ALL INFORMATION FURNISHED REGARDING PROPERTY FOR SALE, RENTAL OR FINANCING SOURCES DEEMED RELIABLE, BUT NO WARRANTY OR REPRESENTATION IS MADE AS TO THE ACCURACY THEREOF AND SAME IS SUBMITTED SUBJECT TO ERRORS, OMISSIONS, CHANGE OF PRICE, RENTAL OR OTHER CONDITIONS, PRIOR SALE, LEASING OR FINANCING OR WITHDRAWAL WITHOUT NOTICE.

Aerial

Broadcast Court Industrial Complex

2375 Broadcast Court, Cocoa, FL 32922



CHARLES A. VON STEIN, INC.
*Commercial Property Management,
Sales & Leasing Specialists since 1963*
626 Old Dixie Highway SW
Vero Beach, FL 32962
www.vscore.com

CONTACT INFO:

Brevard County:	321.725.1961
Indian River County:	772.778.4885
Fax:	772.778.4908
Leasing:	leasing@vscre.com

ALL INFORMATION FURNISHED REGARDING PROPERTY FOR SALE, RENTAL OR FINANCING SOURCES DEEMED RELIABLE, BUT NO WARRANTY OR REPRESENTATION IS MADE AS TO THE ACCURACY THEREOF AND SAME IS SUBMITTED SUBJECT TO ERRORS, OMISSIONS, CHANGE OF PRICE, RENTAL OR OTHER CONDITIONS, PRIOR SALE, LEASING OR FINANCING OR WITHDRAWAL WITHOUT NOTICE.

LOCATION MAPS

Broadcast Court Industrial Complex

2375 Broadcast Court, Cocoa, FL 32922

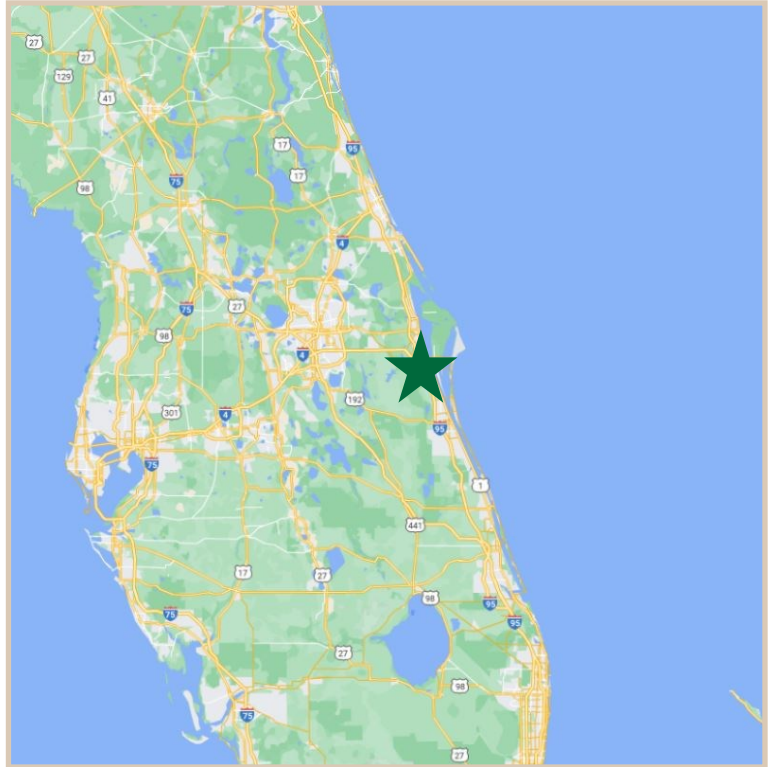
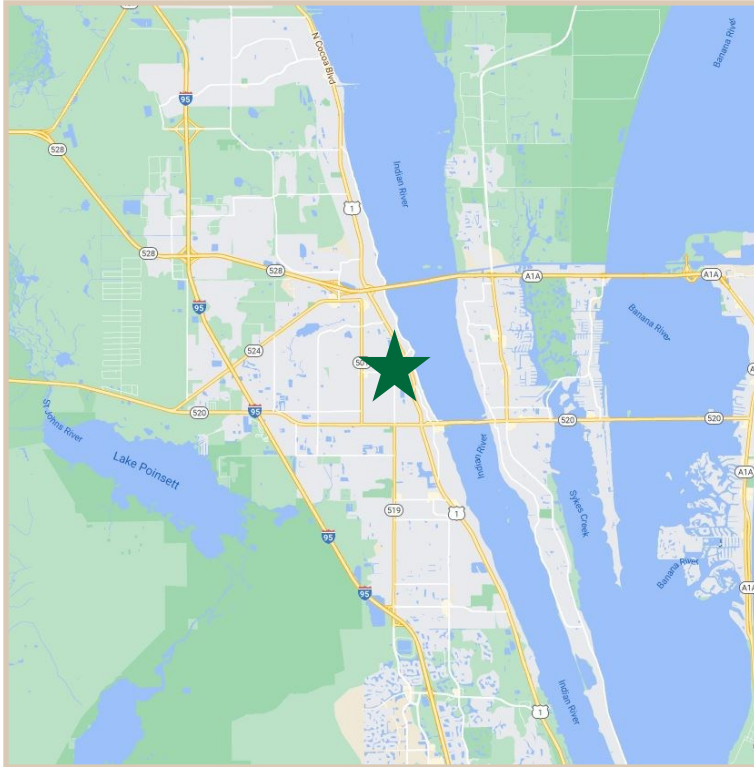
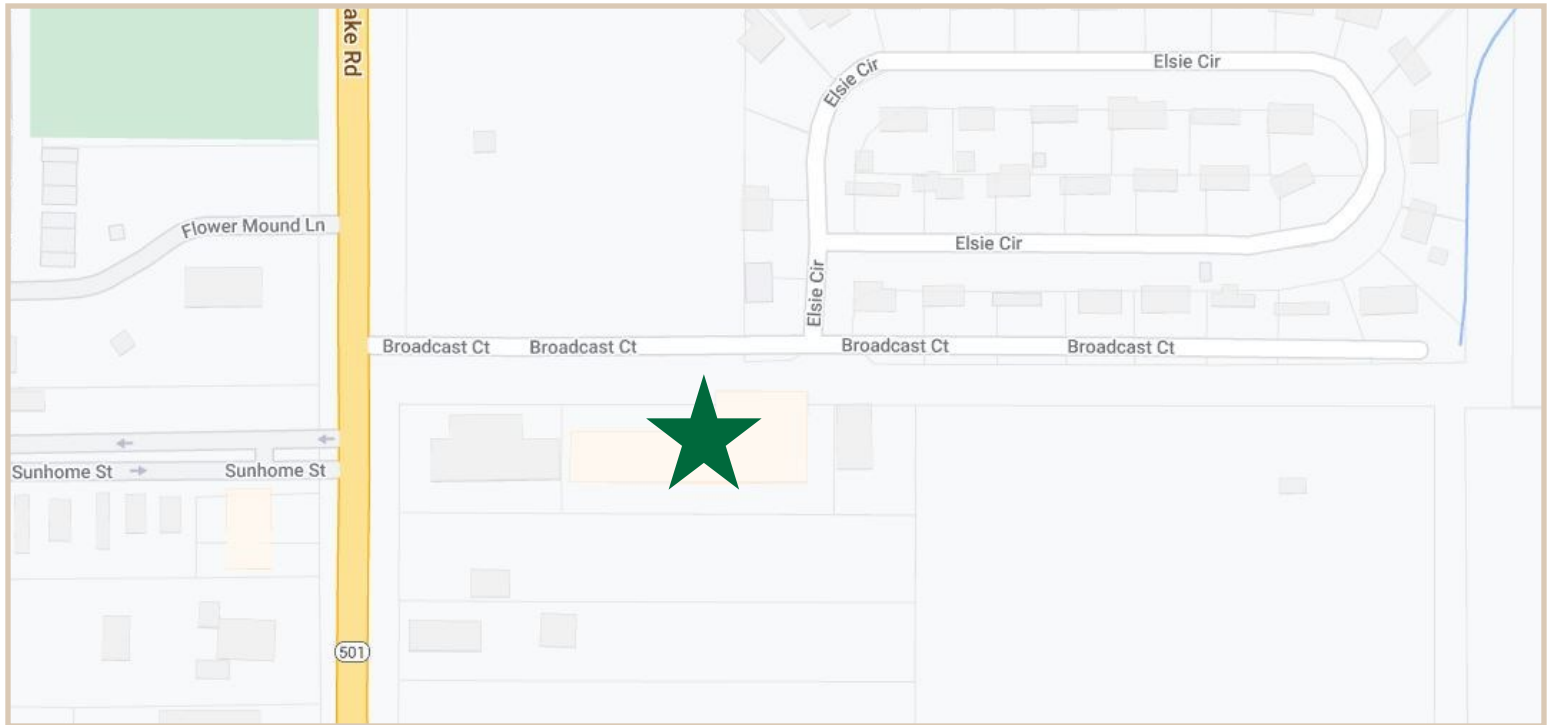

CHARLES A. VON STEIN, INC.
*Commercial Property Management,
Sales & Leasing Specialists since 1963*
626 Old Dixie Highway SW
Vero Beach, FL 32962
www.vscrc.com

CONTACT INFO:

Brevard County:	321.725.1961
Indian River County:	772.778.4885
Fax:	772.778.4908
Leasing:	leasing@vscrc.com

ADDITIONAL PHOTOS

Broadcast Court Industrial Complex

2375 Broadcast Court, Cocoa, FL 32922



CHARLES A. VON STEIN, INC.
*Commercial Property Management,
Sales & Leasing Specialists since 1963*
626 Old Dixie Highway SW
Vero Beach, FL 32962
www.vscrc.com

CONTACT INFO:

Brevard County:	321.725.1961
Indian River County:	772.778.4885
Fax:	772.778.4908
Leasing:	leasing@vscrc.com

ALL INFORMATION FURNISHED REGARDING PROPERTY FOR SALE, RENTAL OR FINANCING SOURCES DEEMED RELIABLE, BUT NO WARRANTY OR REPRESENTATION IS MADE AS TO THE ACCURACY THEREOF AND SAME IS SUBMITTED SUBJECT TO ERRORS, OMISSIONS, CHANGE OF PRICE, RENTAL OR OTHER CONDITIONS, PRIOR SALE, LEASING OR FINANCING OR WITHDRAWAL WITHOUT NOTICE.

ADDITIONAL PHOTOS

Broadcast Court Industrial Complex

2375 Broadcast Court, Cocoa, FL 32922



CHARLES A. VON STEIN, INC.
*Commercial Property Management,
Sales & Leasing Specialists since 1963*
626 Old Dixie Highway SW
Vero Beach, FL 32962
www.vscree.com

CONTACT INFO:

Brevard County:	321.725.1961
Indian River County:	772.778.4885
Fax:	772.778.4908
Leasing:	leasing@vscre.com

ALL INFORMATION FURNISHED REGARDING PROPERTY FOR SALE, RENTAL OR FINANCING SOURCES DEEMED RELIABLE, BUT NO WARRANTY OR REPRESENTATION IS MADE AS TO THE ACCURACY THEREOF AND SAME IS SUBMITTED SUBJECT TO ERRORS, OMISSIONS, CHANGE OF PRICE, RENTAL OR OTHER CONDITIONS, PRIOR SALE, LEASING OR FINANCING OR WITHDRAWAL WITHOUT NOTICE.