

## Greenwood Development Land - County Line and Five Points



### Property Highlights

This development location in Johnson County has excellent accessibility and is an area that is developing now. Preliminary meetings with the Greenwood planning staff recommend zoning as a PUD for a mixed-use development. Site A would be zoned as neighborhood commercial, and Site B as mixed-density residential. These suggestions are in line with the Greenwood Comprehensive Plan.

#### Site A Information

- 15.25 +/- acres
- Neighborhood Commercial
- 1,285' Road Frontage
- Utilities On-Site or Adjacent
- Excellent Access
- Developing Area

#### Site B Information

- 65.65 +/- acres
- Mixed-Density Residential
- 2,245' Road Frontage
- Utilities On-Site or Adjacent
- Excellent Access
- Developing Area

For More Information Call:

Randy Zentz  
[rzentz@commerciallinksgroup.com](mailto:rzentz@commerciallinksgroup.com)

Commercial Links, LLC  
 958 Bright Beam Court  
 Westfield, IN 46074

317.590.0447

[CommercialLinksGroup.com](http://CommercialLinksGroup.com)



# Commercial Links

## Greenwood Development Land - County Line and Five Points



This development location has excellent access from two major interchanges. To the south the intersection of Main and 65 and the north at County Line. Both of these corridors also allow for quick access to downtown Greenwood.

The area between County Line and Main to the east and southeast are all in process of development. This will provide infrastructure and opportunity for the Local Neighborhood and the Mixed-Density Residential areas. Utilities and drainage infrastructure are all moving forward now.

- Great location with excellent access
- 80.90 acres total. 15.25 Commercial, 65.65 Residential
- Large growth area in progress
- Incredible road frontage
- Utilities nearby/on property
- Commercial development opportunity
- Excellent Schools
- Located in City of Greenwood after annexation

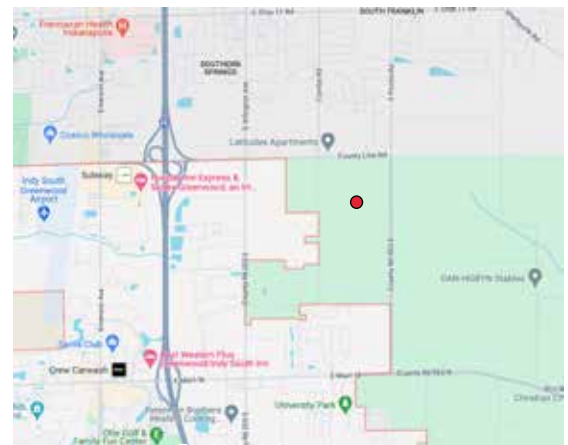

For More Information Call:

Randy Zentz  
rzentz@commerciallinksgroup.com

Commercial Links, LLC  
958 Bright Beam Court  
Westfield, IN 46074

317.590.0447

CommercialLinksGroup.com